

**SUBDIVISION REVIEW SHEET****CASE NO.:** C8-2016-0095.0A**P.C. DATE:** November 8, 2016**SUBDIVISION NAME:** Resubdivision of Lot 3F Austin Mall**AREA:** 12.84**LOT(S):** 2**OWNER/APPLICANT:** Austin Community College District (Richard M. Rhodes, PHD)**AGENT:** Bury Inc. (Craig M. Chonko)**ADDRESS OF SUBDIVISION:** 6401 Airport Blvd.**GRIDS:** K27**COUNTY:** Travis**WATERSHED:** Tannehill Branch**JURISDICTION:** Full-Purpose**EXISTING ZONING:** CS-MU-V-NP**MUD:** N/A**NEIGHBORHOOD PLAN:** Highland**PROPOSED LAND USE:** Public**VARIANCES:** None**SIDEWALKS:** Sidewalks will be provided on both sides of all internal streets and the subdivision side of boundary streets.**DEPARTMENT COMMENTS:** The request is for approval of the Resubdivision of Lot 3F Austin Mall. The proposed plat is a resubdivision of 1 lot into 2 lots composed of 12.84 acres.**STAFF RECOMMENDATION:** The staff recommends approval of the plat. This now meets all applicable State and City of Austin LDC requirements.**PLANNING COMMISSION ACTION:****CASE MANAGER:** David Wahlgren  
Email address: [david.wahlgren@austintexas.com](mailto:david.wahlgren@austintexas.com)**PHONE:** 974-6455

## SITE LOCATION MAP

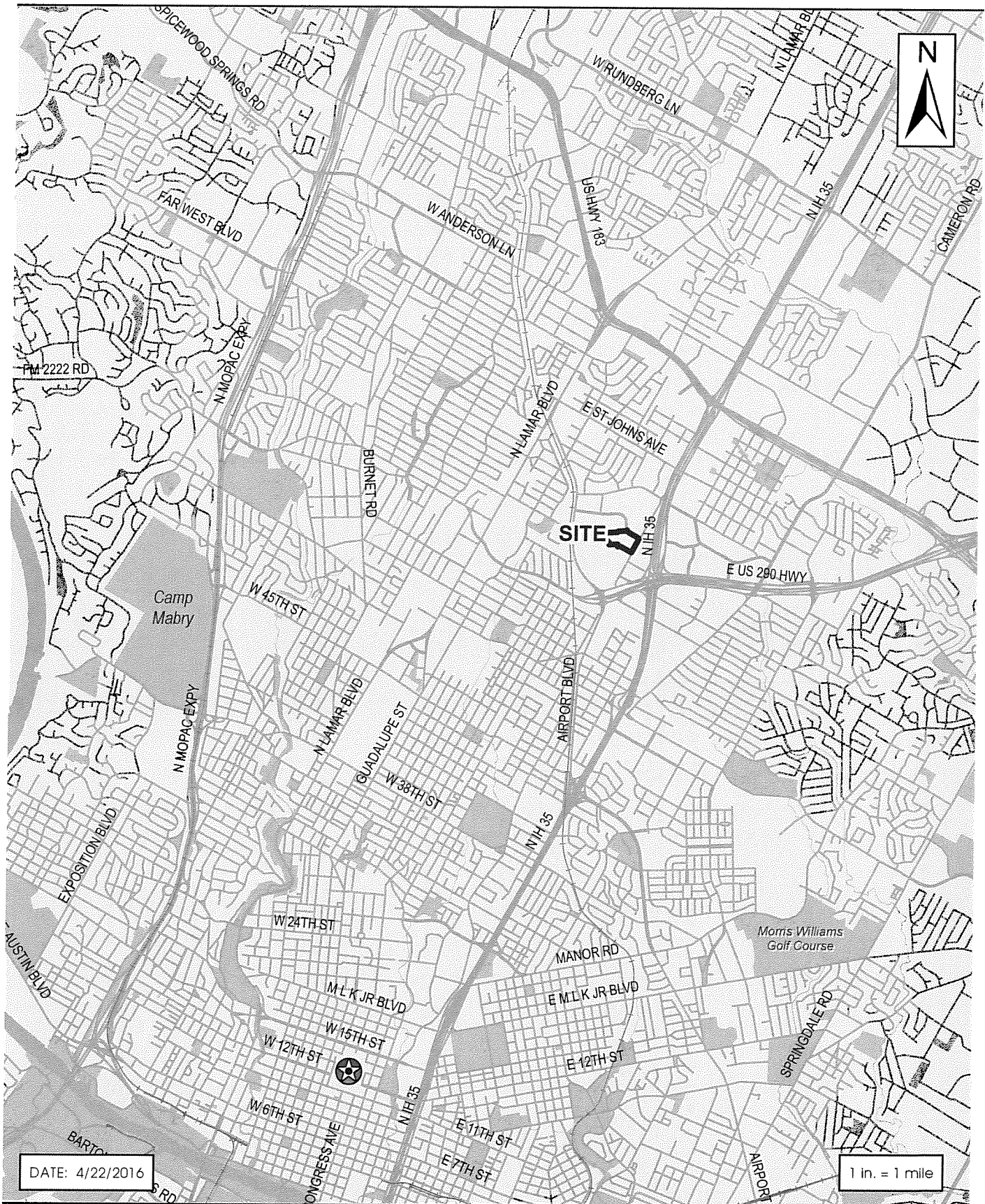

**HIGHLAND MALL - ACC**  
**LOT 3F RESUBDIVISION, AUSTIN, TEXAS**

PROJECT: 103017-10004



221 W. Sixth St., Suite 600,  
Austin, Texas 78701  
[www.stantec.com](http://www.stantec.com)

## RESUBDIVISION OF LOT 3F

A 2 LOT SUBDIVISION  
CONSISTING OF 12.839 ACRES



**Stantec**  
221 West Sixth Street, Suite 600  
Denver, CO 80202  
Tel: 303.733.7000  
Fax: 303.733.7001  
www.stantec.com

el. (512) 328-0011 Fax (512) 328-0322  
TBPE # F-6324 TBPLS # F-10194230.  
Copyright © 2016

C8-2016-0095.0A

VICINITY MAP  
N.T.S.

- 1/2" IRON ROD FOUND (UNLESS NOTED)
- 1/2" IRON ROD WITH "BURY" CAP SET
- IRON DRILL HOLE FOUND
- ⊗ "X" FOUND IN CONCRETE
- △ PK NAIL WITH "BURY" WASHER SET
- ▲ PK NAIL FOUND
- NO 60dPK NAIL FOUND

CUAVE TABLE			
NO.	LENGTH	MODUS	CHORD BEARING
C1	168.077	340.607	28.97207
C2	62.3027	40.007	54.8781467
C3	182.097	366.007	51.7753737
C4	255.087	110.007	30.911077
C5	42.457	145.007	69.846457
C6	39.887	145.007	107.7343747
C7	128.187	346.007	21.706747
C8	39.887	346.007	59.19736767
C9	127.437	346.007	55.19736767
C10	168.357	346.007	166.357
C11	56.637	346.007	56.637
C12	179.927	346.007	179.927
C13	240.347	346.007	240.347
C14	42.607	346.007	42.607
C15	39.887	346.007	39.887
C16	127.437	346.007	127.437

**BEARING BASIS NOTE:**  
THE BASIS OF BEARINGS IS REFERENCED TO THE TEXAS STATE PLANE COORDINATE SYSTEM, CENTRAL ZONE, NAD 83(93) BY UTILIZING THE CITY OF AUSTIN GPS CONTROL MONUMENTS AS FOLLOWS: K-26-1001, K-29-4001, K-27-4001, L-26-3001, K-27-5001, K-26-2001, K-27-1001 AND CB54.

Drawn by: KWA Approved by: JTB Project No.: R0103017-10004 File: H:\103017\004\103017004P13.dwg