

- 1
- 2
- 3
- 4
- 5
- 6
- 7
- 8
- 9
- 10
- 11
- 12
- 13
- 14
- 15
- 16
- 17
- 18
- 19
- 20
- 21
- 22
- 23
- 24
- 25
- 26
- 27
- 28
- 29
- 30
- 31
- 32
- 33
- 34
- 35
- 36
- 37
- 38
- 39

BE IT ORDAINED BY THE CITY COUNCIL OF THE CITY OF AUSTIN:

Lots 1-7, Block A, The Terraces at Scofield Ridge Subdivision, a subdivision in Travis County, Texas, as recorded in Document No. 200800240 of the Official Public Records of Travis County, Texas (the "Property"),

PART 2. The Property within the boundaries of the conditional overlay combining district established by this ordinance is subject to the following conditions:

- A. Vehicular access from the Property to FM 1325 (Burnet Road) is prohibited. All vehicular access to the Property shall be from other adjacent public streets or through other adjacent property.

Except as specifically restricted under this ordinance, the Property may be developed and used in accordance with the regulations established for the community commercial (GR) district and other applicable requirements of the City Code.

PART 3. This ordinance takes effect on _____, 2016.

PASSED AND APPROVED

_____, 2016 § _____
 § _____
 § _____
Steve Adler
Mayor

APPROVED: _____ **ATTEST:** _____
Anne L. Morgan Jannette S. Goodall
City Attorney City Clerk

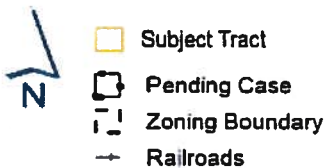
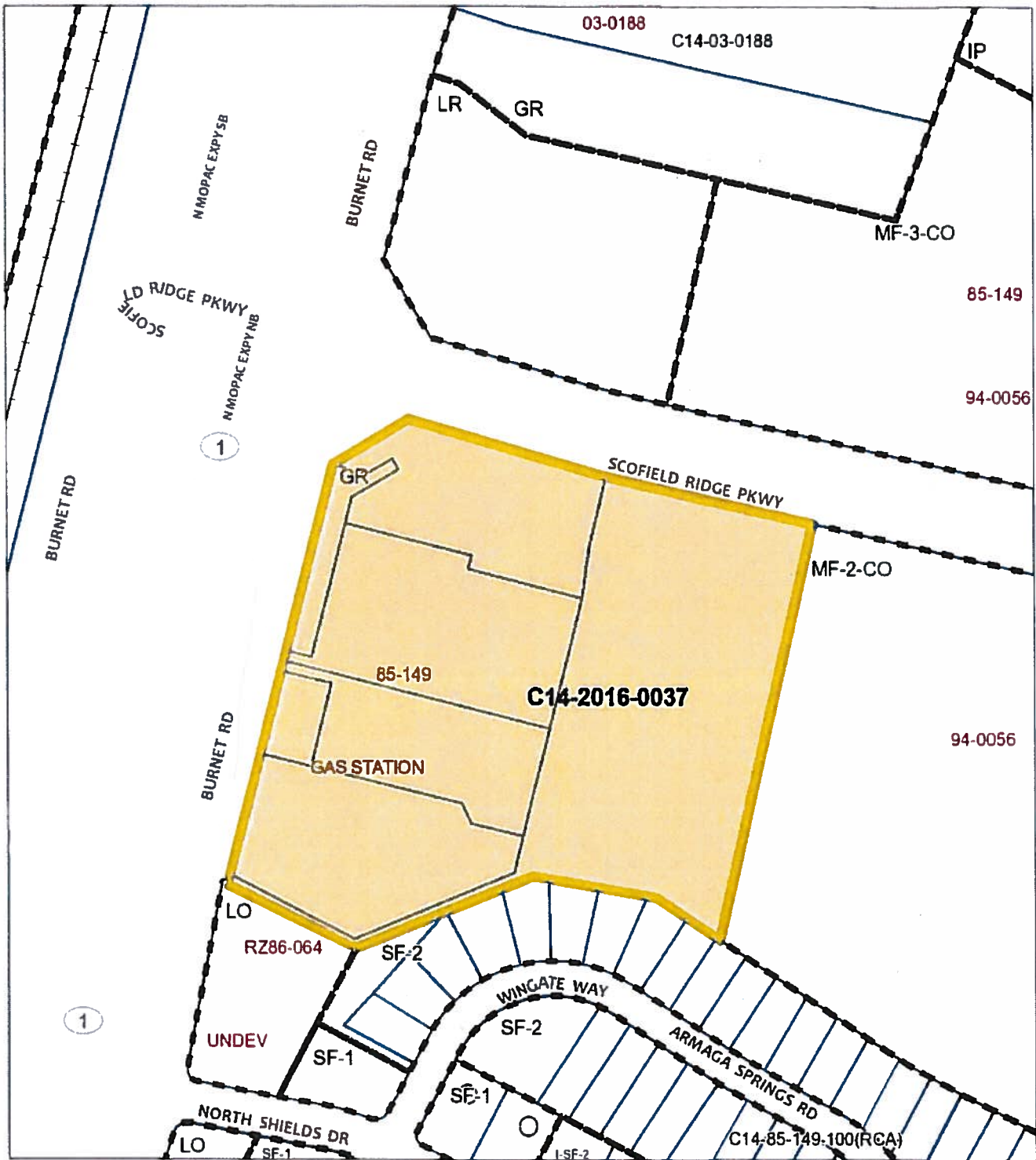

100 200 Feet

1" = 200'

ZONING

ZONING CASE#: C14-2016-0037

Exhibit A



This product is for informational purposes and may not have been prepared for or be suitable for legal, engineering, or surveying purposes. It does not represent an on-the-ground survey and represents only the approximate relative location of property boundaries.

This product has been produced by CTM for the sole purpose of geographic reference. No warranty is made by the City of Austin regarding specific accuracy or completeness.

Created 09/16/16