

**ORDINANCE NO. 20170831-084**

**AN ORDINANCE AMENDING ORDINANCE NO. 011213-041, WHICH ADOPTED THE CENTRAL EAST AUSTIN NEIGHBORHOOD PLAN AS AN ELEMENT OF THE IMAGINE AUSTIN COMPREHENSIVE PLAN, TO CHANGE THE LAND USE DESIGNATION ON THE FUTURE LAND USE MAP FOR PROPERTY LOCATED AT 1139 ½ POQUITO STREET.**

**BE IT ORDAINED BY THE CITY COUNCIL OF THE CITY OF AUSTIN:**

**PART 1.** Ordinance No. 011213-041 adopted the Central East Austin Neighborhood Plan as an element of the Imagine Austin Comprehensive Plan.

**PART 2.** Ordinance No. 011213-041 is amended to change the land use designation from single family to multifamily for the property located at 1139 ½ Poquito Street on the future land use map attached as **Exhibit "A"** and incorporated in this ordinance, and described in File NPA-2017-0009.01 at the Planning and Zoning Department.

**PART 3.** This ordinance takes effect on September 11, 2017.

**PASSED AND APPROVED**

\_\_\_\_\_, August 31, 2017

**APPROVED:**

  
Anne L. Morgan  
City Attorney

§  
§  
§

  
Steve Adler  
Mayor

**ATTEST:**

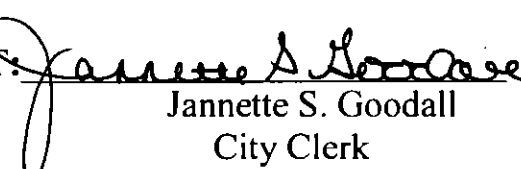
  
Jannette S. Goodall  
City Clerk

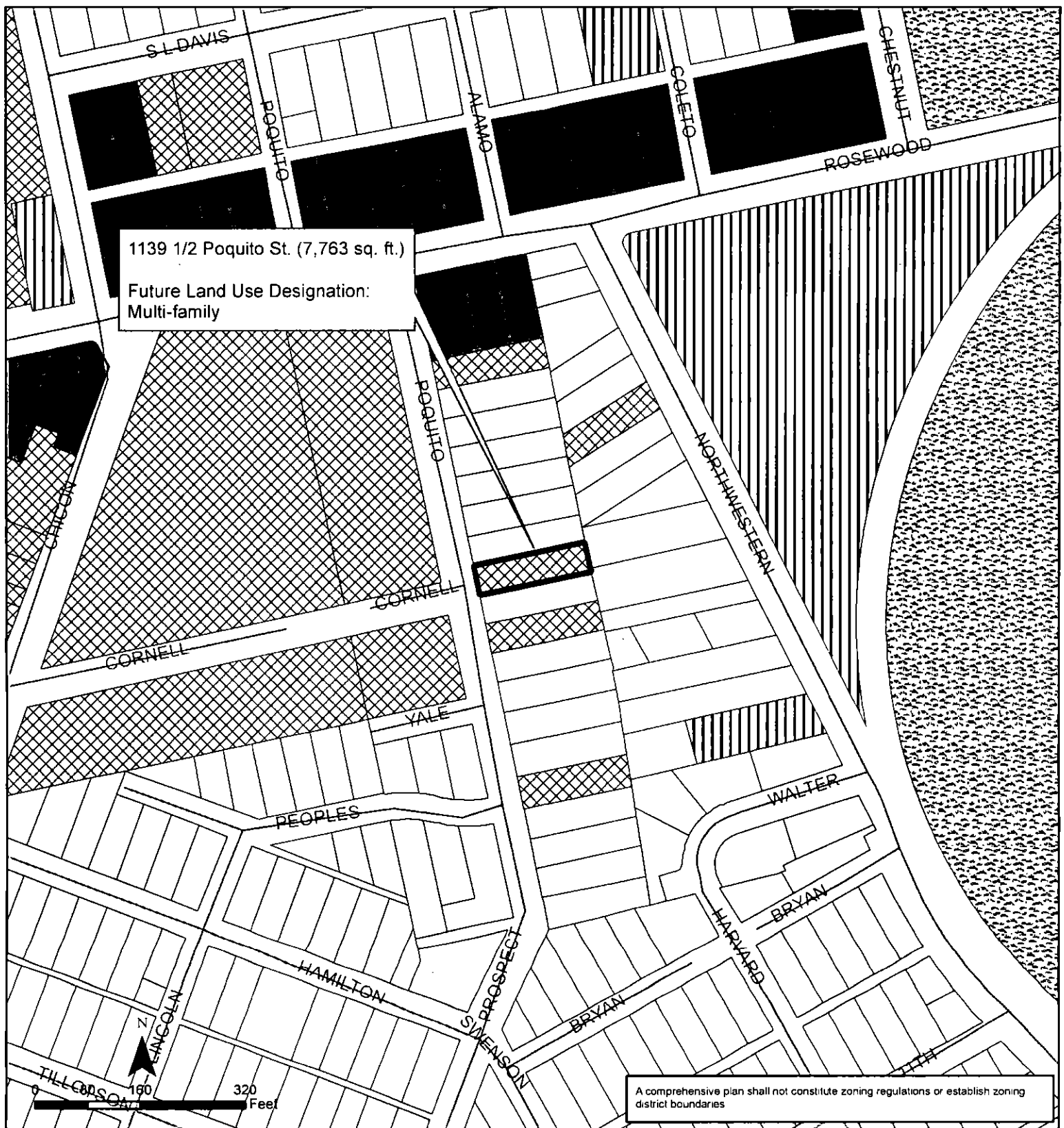

# **Exhibit A** **Central East Austin Neighborhood Planning Area** **Amendment NPA-2017-0009.01**

This product is for informational purposes and may not have been prepared for or be suitable for legal, engineering, or surveying purposes. It does not represent an on-the-ground survey and represents only the approximate relative location of property boundaries.

This product has been produced by the Planning and Development Review for the sole purpose of geographic reference. No warranty is made by the City of Austin regarding specific accuracy or completeness.

## **Future Land Use**

	Single-Family		Civic
	Higher-Density Single-Family		Recreation & Open Space
	Multi-Family		Transportation
	Mixed Use		Subject Property