

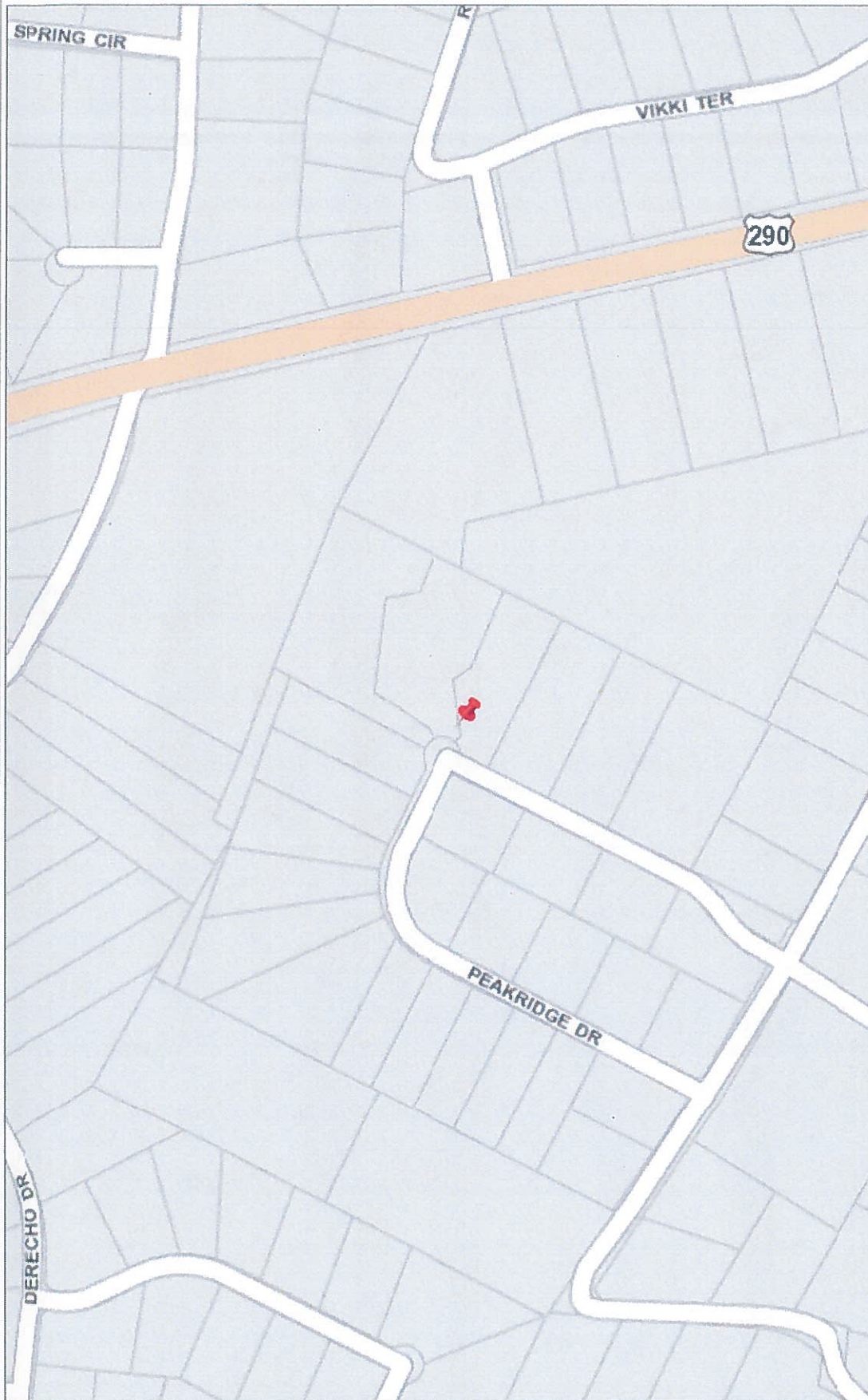







**SUBDIVISION REVIEW SHEET****CASE NO.:** C8J-2017-0223.0A**ZAP DATE:** October 3, 2017**SUBDIVISION NAME:** Sonteridge Estates Subdivision**AREA:** 10.134**LOT(S):** 9**OWNER/APPLICANT:** Flintrock Stoneride LLC**AGENT:** FNF CAD Services (Fred Fuentes)**ADDRESS OF SUBDIVISION:** 9820 Flintrock Circle**GRIDS:** WZ19**COUNTY:** Travis**WATERSHED:** Slaughter Creek**JURISDICTION:** 2-Mile ETJ**EXISTING ZONING:** N/A**MUD:** N/A**NEIGHBORHOOD PLAN:** N/A**PROPOSED LAND USE:** Single Family**ADMINISTRATIVE WAIVERS:****VARIANCES:** None**SIDEWALKS:** Sidewalks will be provided on both sides of all internal streets and the subdivision side of boundary streets.**DEPARTMENT COMMENTS:** The request is for approval of the Sonteridge Estates Subdivision Final Plat. The proposed plat is composed of 9 lots on 10.134 acres.**STAFF RECOMMENDATION:** The staff recommends disapproval of the plat. This plat does not meet all applicable State and City of Austin LDC requirements.**PLANNING COMMISSION / ZONING AND PLATTING ACTION:**



## Legend

-  Lot Lines
-  Streets
-  Building Footprints
-  Named Creeks
-  Lakes and Rivers
-  Parks
-  County