

## SUBDIVISION REVIEW SHEET

**CASE NO.:** C8J-2008-0048(R1)

**ZAP DATE:** April 25, 2018

**SUBDIVISION NAME:** Eastwood

**AREA:** 667.48

**LOT(S):** 2310

**OWNER/APPLICANT:** Cyclone Development, Inc (John S. Lloyd)

**AGENT:** Randall Jones & Associates Engineering Inc (Ashley S. Hanson, P.E.)

**ADDRESS OF SUBDIVISION:** FM 973 Road

**GRIDS:** T25

**COUNTY:** Travis

**WATERSHED:** Gilleland Creek

**JURISDICTION:** 2-Mile ETJ

**EXISTING ZONING:** N/A

**MUD:** N/A

**NEIGHBORHOOD PLAN:** N/A

**PROPOSED LAND USE:** Single Family

**ADMINISTRATIVE WAIVERS:**

**VARIANCES:** None

**SIDEWALKS:** Sidewalks will be provided on both sides of all internal streets and the subdivision side of boundary streets.

**DEPARTMENT COMMENTS:** The request is for approval of the Eastwood Preliminary Plan. The proposed plat is composed of 2310 lots on 667.48 acres.

**STAFF RECOMMENDATION:** The staff recommends disapproval of the plat. This plat does not meet all applicable State and City of Austin LDC requirements.

**PLANNING COMMISSION / ZONING AND PLATTING ACTION:**

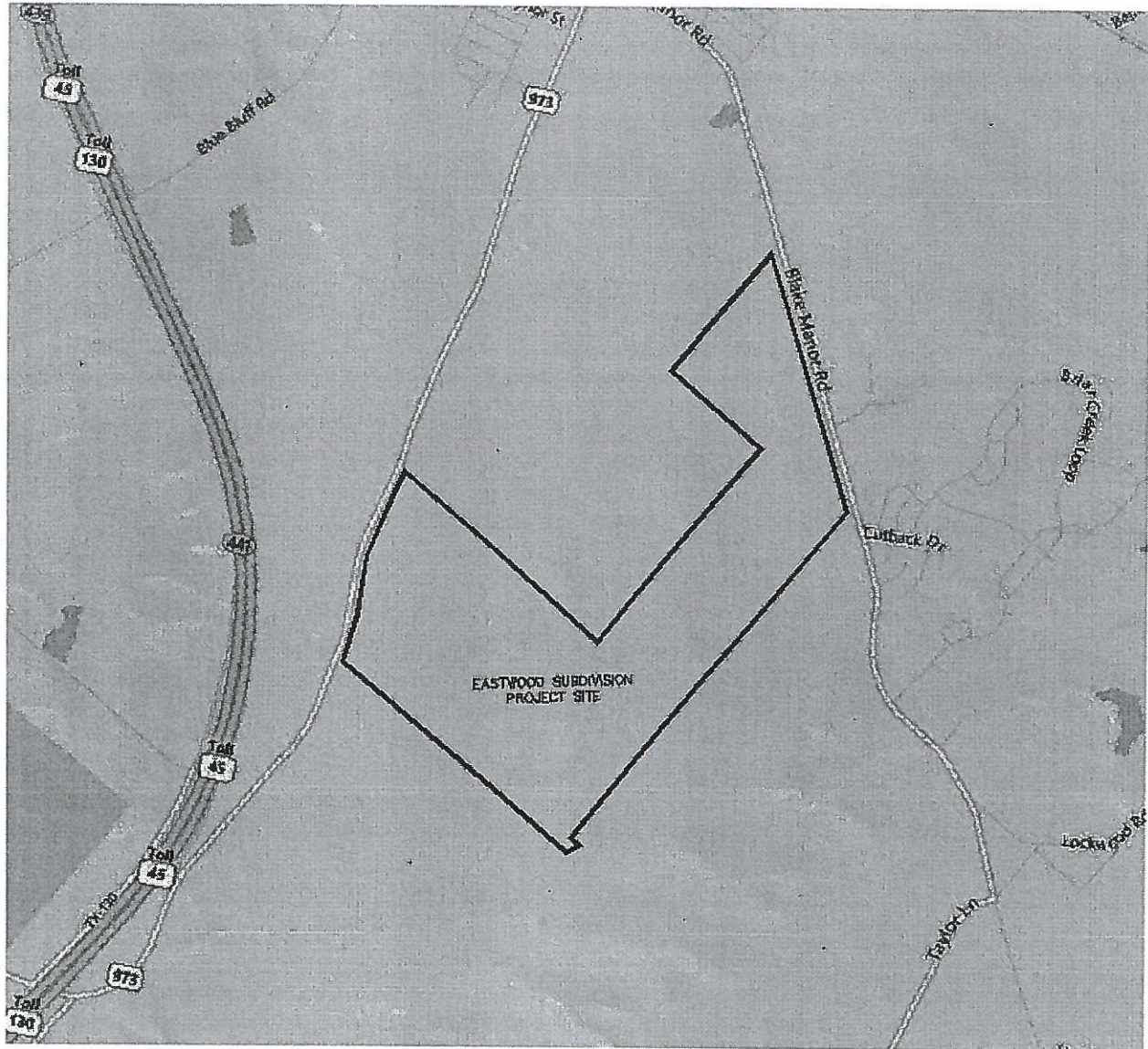

LOCATION MAP – EASTWOOD SUBDIVISION

ZAP 11924820