

SUBDIVISION REVIEW SHEET**CASE NO.:** C8J-2015-0134.4A**ZAP DATE:** June 19, 2018**SUBDIVISION NAME:** Preston Park Section 3**AREA:** 3.99**LOT(S):** 18**OWNER/APPLICANT:** Pulte Homes of Texas (Stephen Ashlock)**AGENT:** CSF Civil Group (Christine Potts)**ADDRESS OF SUBDIVISION:** 16258-1/2 Bratton Lane**DISTRICT NUMBER:** N/A**GRIDS:** MM39**COUNTY:** Travis**WATERSHED:** Gilleland Creek**JURISDICTION:** 2-Mile ETJ**EXISTING ZONING:** N/A**MUD:** N/A**NEIGHBORHOOD PLAN:** N/A**PROPOSED LAND USE:** Single Family**ADMINISTRATIVE WAIVERS:****VARIANCES:** None**SIDEWALKS:** Sidewalks will be provided on both sides of all internal streets and the subdivision side of boundary streets.**DEPARTMENT COMMENTS:** The request is for approval of the Preston Park Section 3. The proposed plat is composed of 18 lots on 3.99 acres.**STAFF RECOMMENDATION:** The staff recommends disapproval of the plat. This plat does not meet all applicable State and City of Austin LDC requirements.**PLANNING COMMISSION / ZONING AND PLATTING ACTION:**

Tracking

119544/20

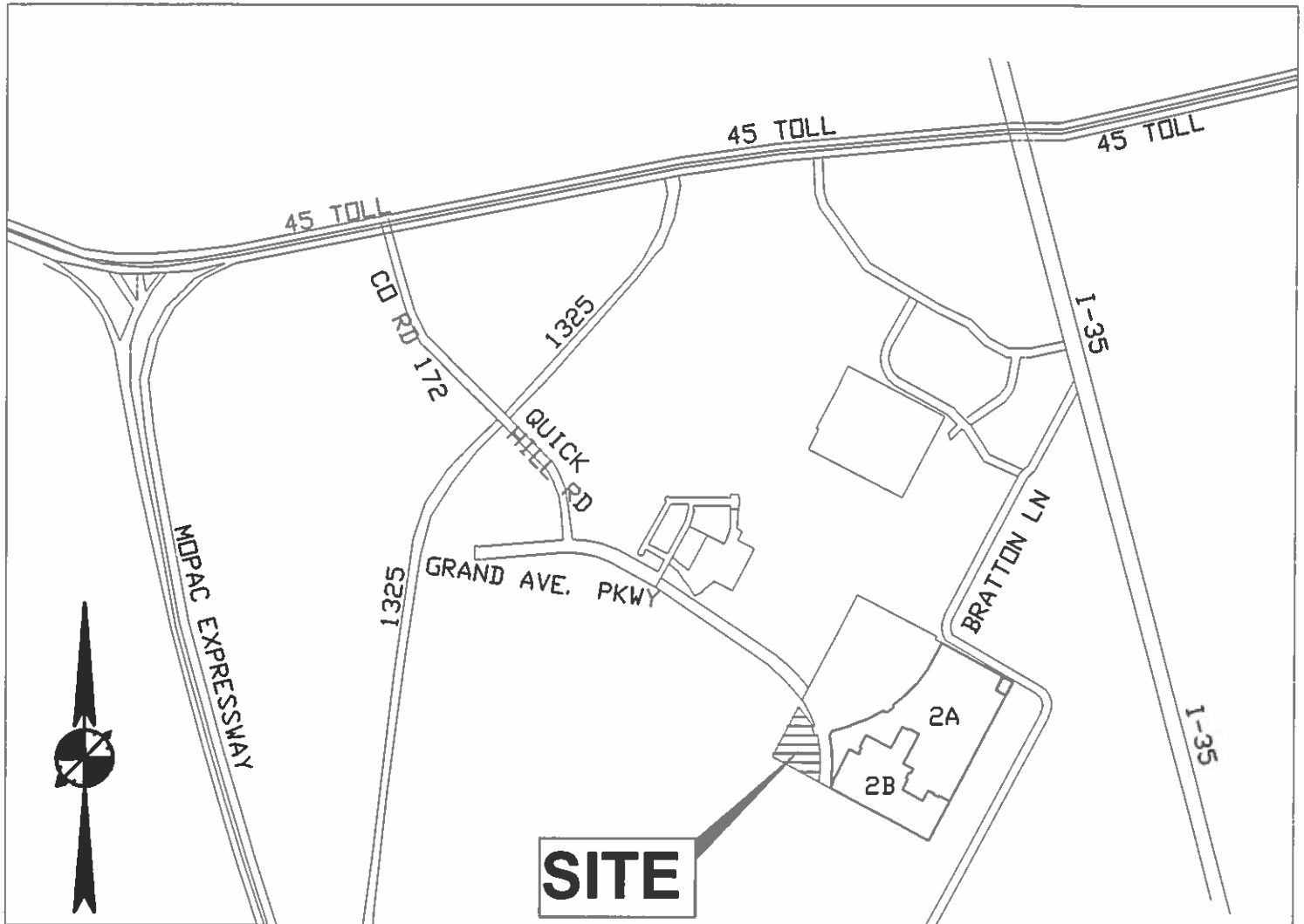

VICINITY MAP