

GREEN & BLUE

Design Character

While all alternatives accommodate pedestrians, vehicular traffic, and public space similarly, the “Green and Blue” alternative maximizes the visibility of vegetation and stormwater in Austin’s urban context. This character alternative reveals and celebrates the story of the watershed that flows through the center of Congress Avenue and connects the Capitol grounds to Lady Bird Lake by its use of streetscape materials and interpretative design.



ENVIRONMENT

SOCIAL EQUITY
MOBILITY

ECONOMICS
CULTURE & HISTORY

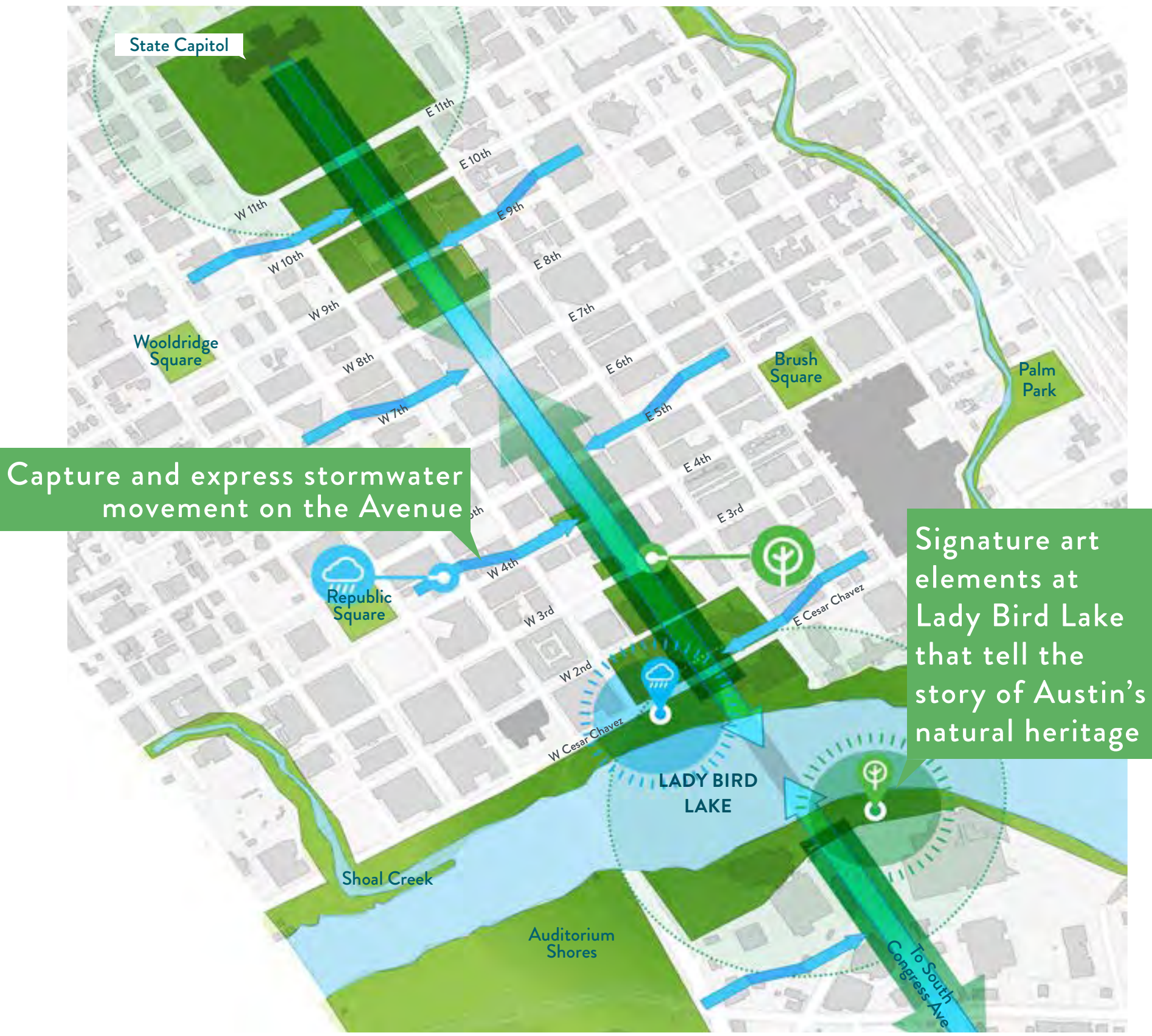

CONCEPT

PRECEDENTS



Raised planters provide ample seating and close interaction with native plants

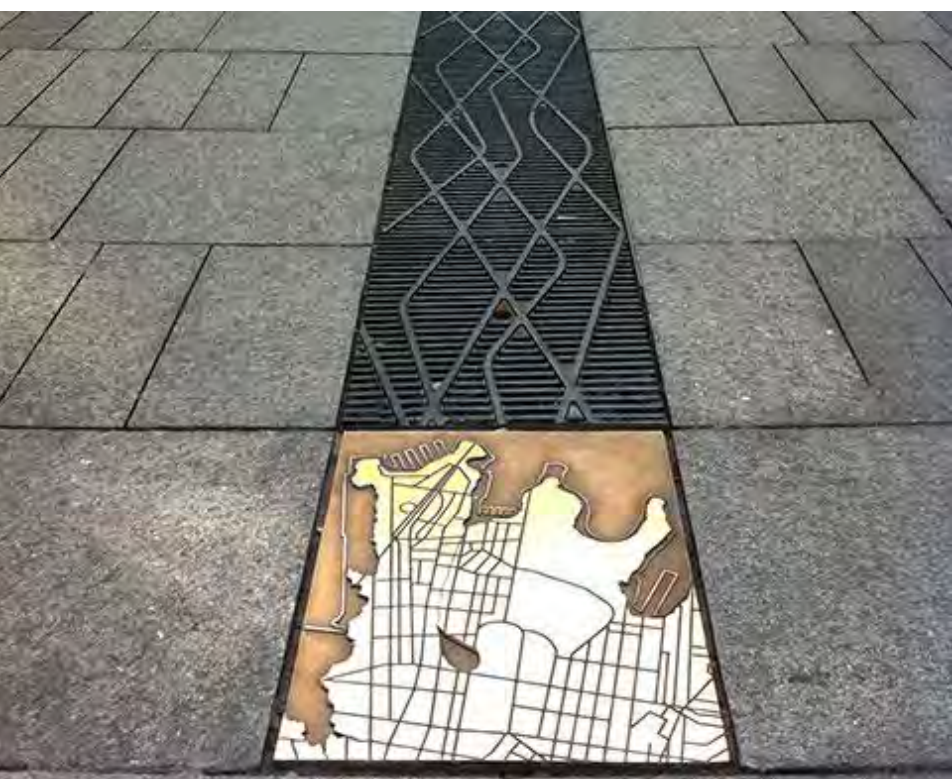

Water grates make water visible and create opportunities for interpretive markers



Plantings incorporated along blank facades to help cool buildings and the sidewalk



Layered planting while maintaining enough hardscape to support large gatherings

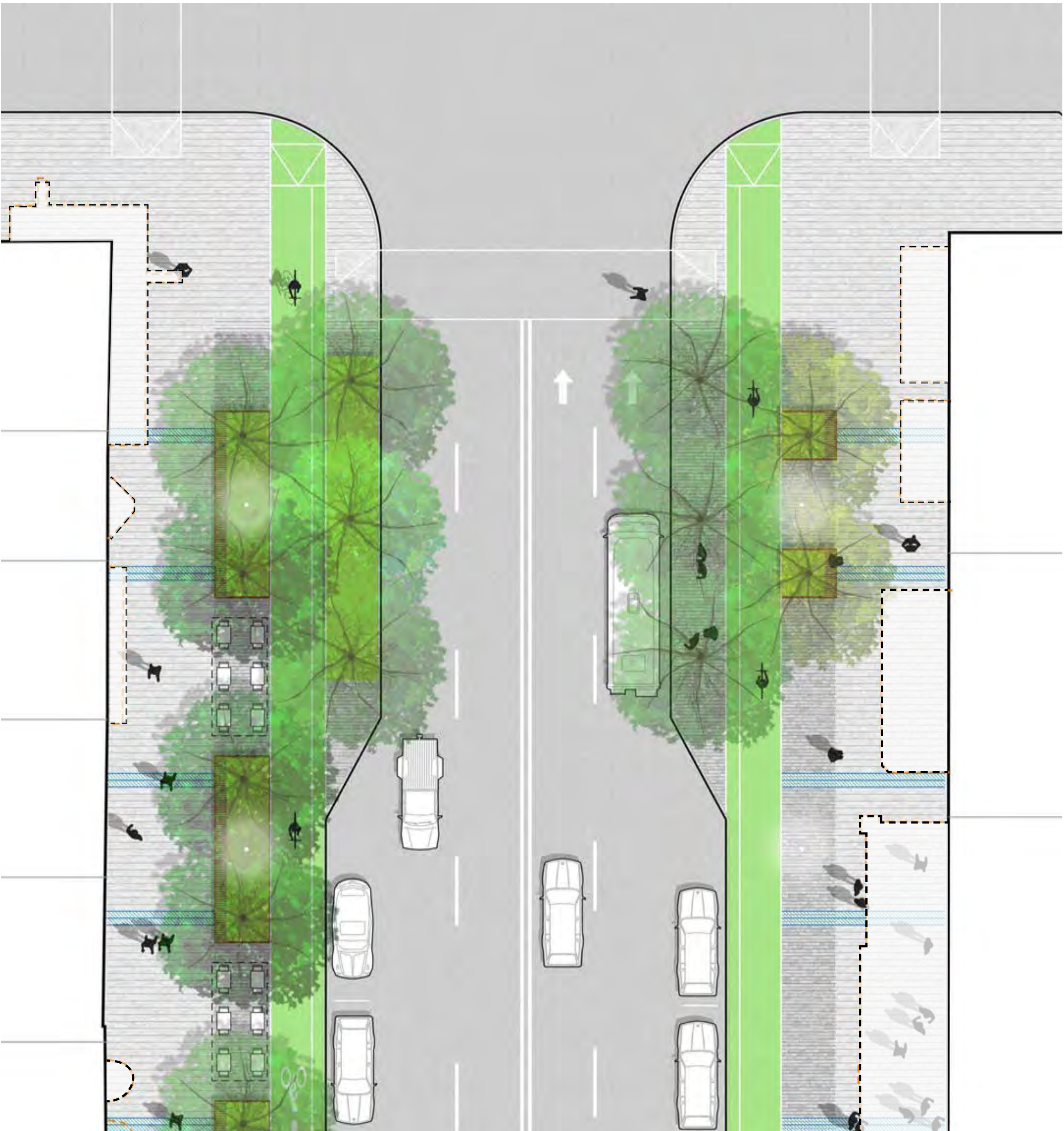

The plan includes canopy trees surrounded by native plants, with a zone for stormwater treatment under the sidewalk.

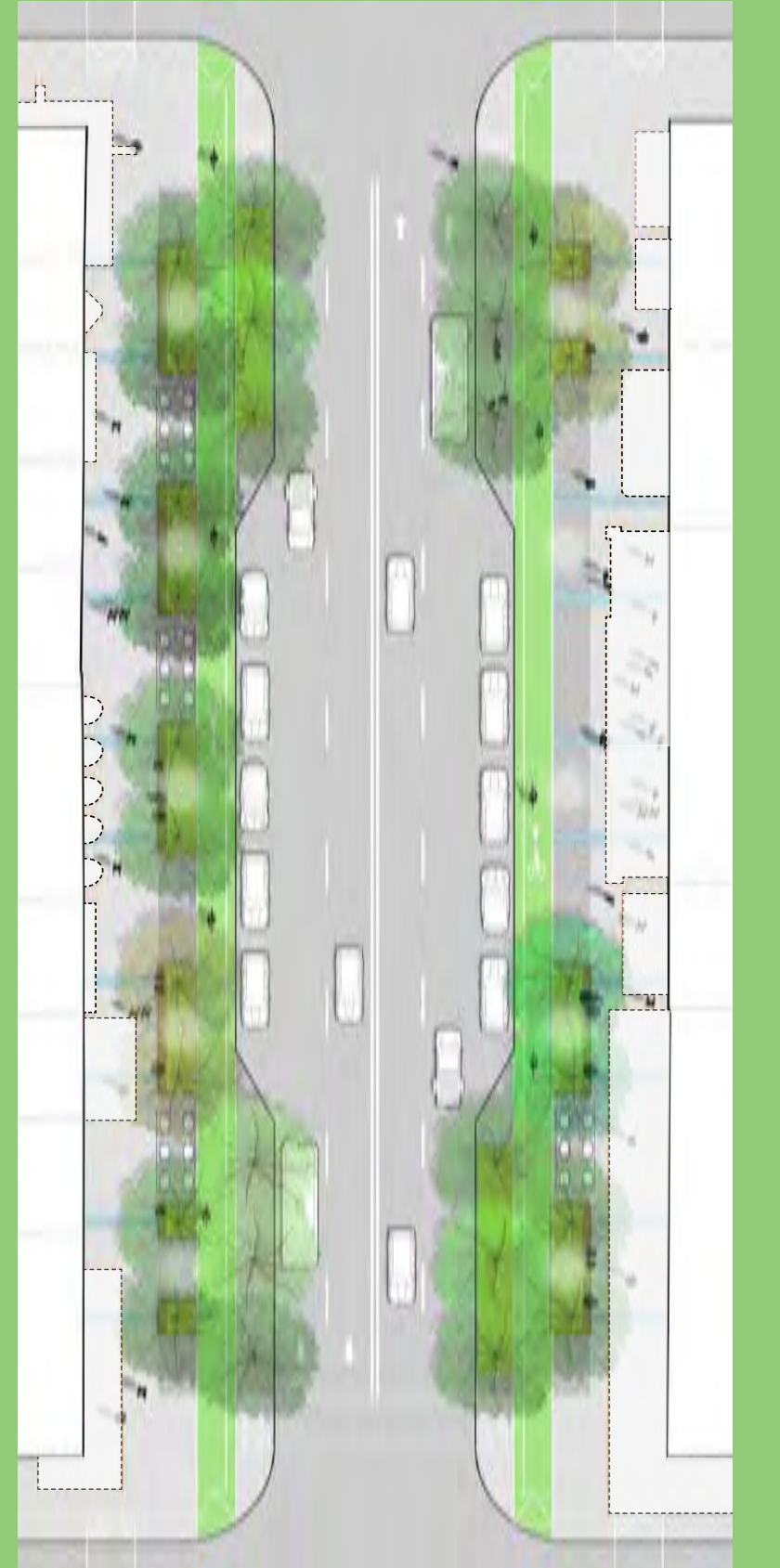

BRIDGE LANDINGS

The flow of rainwater through the city and into Lady Bird Lake is featured through a series of stormwater terraces and viewpoints that connect the street level with the trails along the edge of the Lake.

PRECEDENTS



Stormwater terraces



Deck at water's edge



Stormwater sculpture



Stormwater sculpture

NORTH BRIDGE LANDING - STORMWATER TERRACES



SOUTH BRIDGE LANDING - STORMWATER SCULPTURE



CAPITOL DISTRICT

Design Character

While all alternatives accommodate pedestrians, vehicular traffic, and public space similarly, the “Capitol District” alternative celebrates traditional materials around the Capitol grounds with subtle, elegant shifts in paving pattern and texture that delineate zones of the streetscape. This character alternative maximizes flush surface for large civic gatherings.



CULTURE & HISTORY

SOCIAL EQUITY

ECONOMICS

MOBILITY

ENVIRONMENT



CONCEPT

PRECEDENTS



Texas granite on the Capitol, with different block sizes and textures, inspires the paving



Interpretive information can be inscribed in the pavement



Subtle pattern and texture changes delineate different zones of the streetscape



Pervious pavers allow stormwater to infiltrate

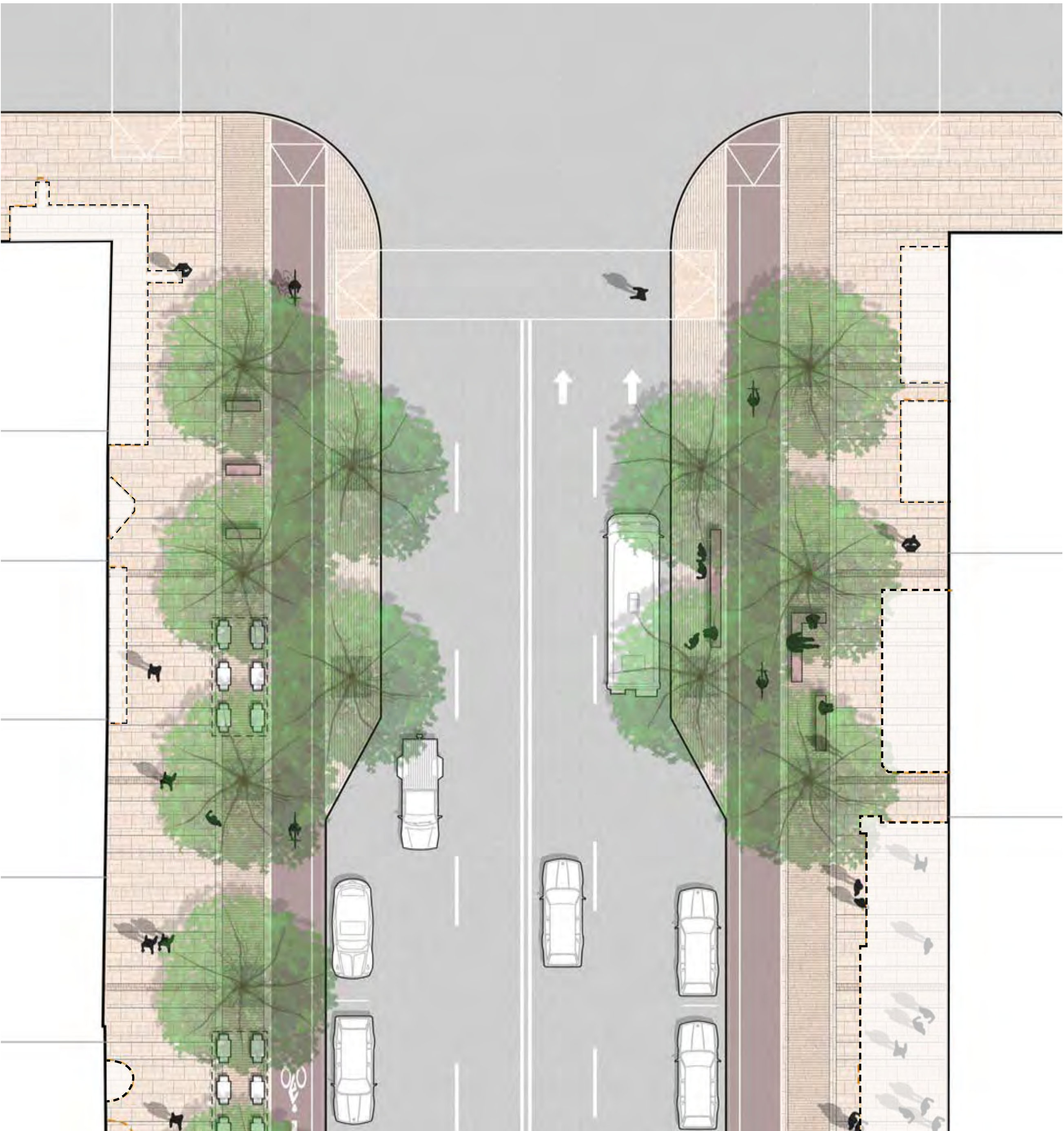

The elegant patterning of the streetscape draws inspiration from the architecture of the Texas Capitol building.

BRIDGE LANDINGS

Gracious seating terraces step down to the water on the north landing, allowing large civic gatherings. At the south landing, a formal plaza opens to views of Lady Bird Lake. Vertical sculptures mark the gateway on each side of the bridge.

PRECEDENTS



Grand ceremonial stairs



Accessible ramp along seating terraces



Bridge gateway elements



Bridge gateway elements

NORTH BRIDGE LANDING - GRAND STAIRS

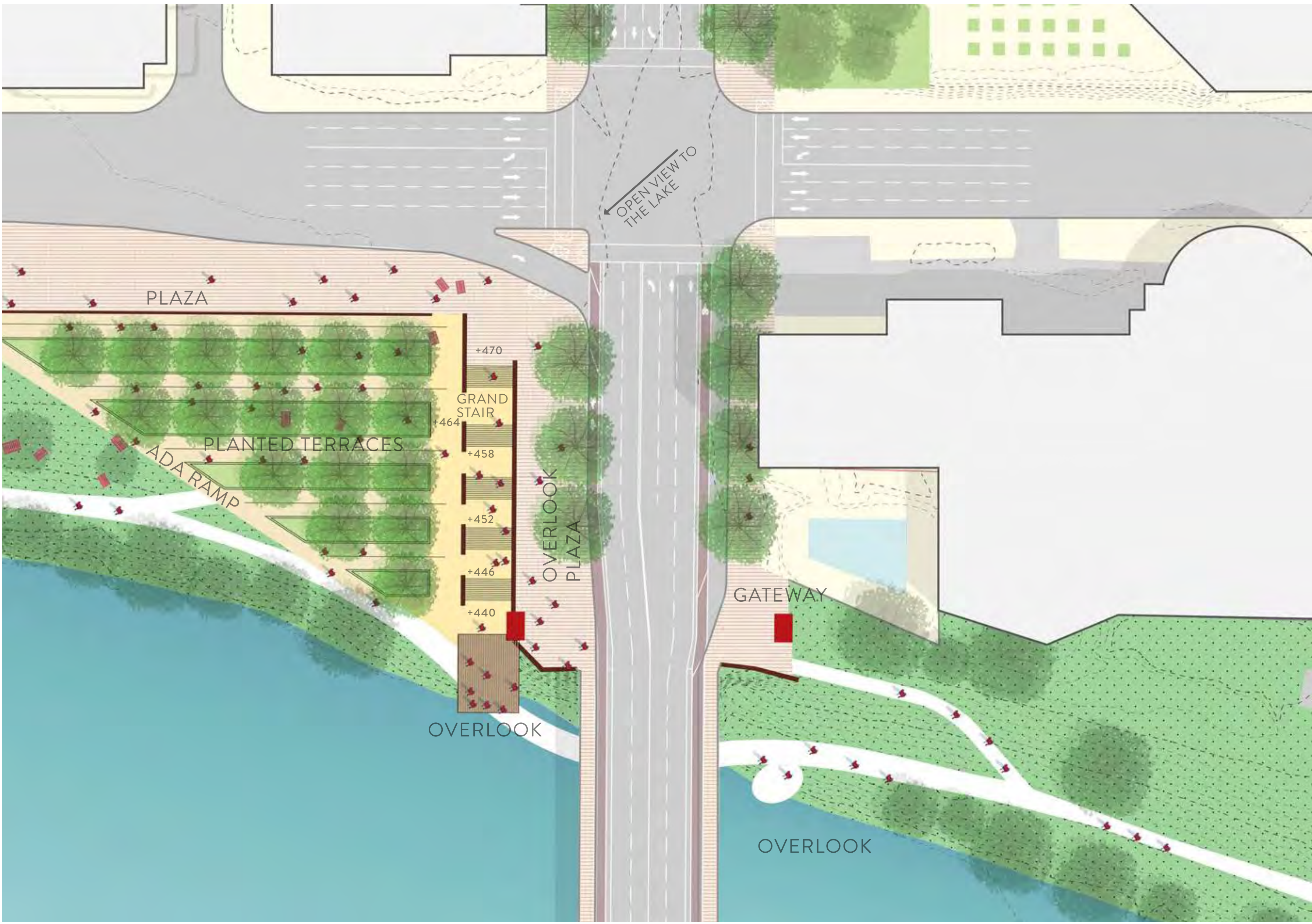

SOUTH BRIDGE LANDING - GRAND STAIRS



VIBRANT CROSSINGS

Design Character

While all alternatives accommodate pedestrians, vehicular traffic, and public space similarly, the “Vibrant Crossings” alternative celebrates the cultural vitality of Austin. Cross-streets that played important roles in the cultural history of Austin are accentuated with dynamic paving patterns, bright colors, and sculptural seating clusters.



SOCIAL EQUITY

CULTURE & HISTORY

ECONOMICS

MOBILITY

ENVIRONMENT

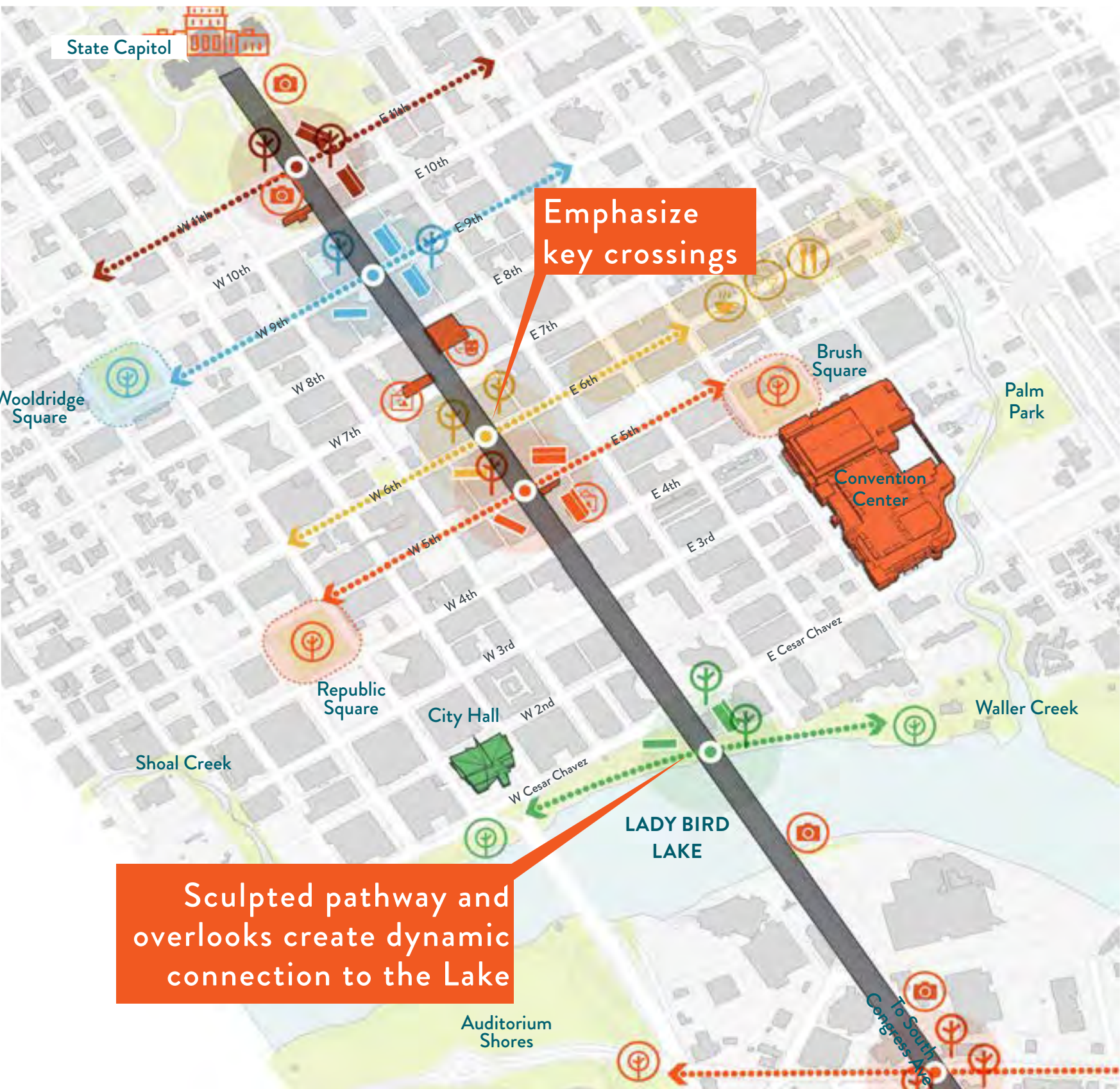

CONCEPT

PRECEDENTS



Sculptural benches with plantings create social seating clusters

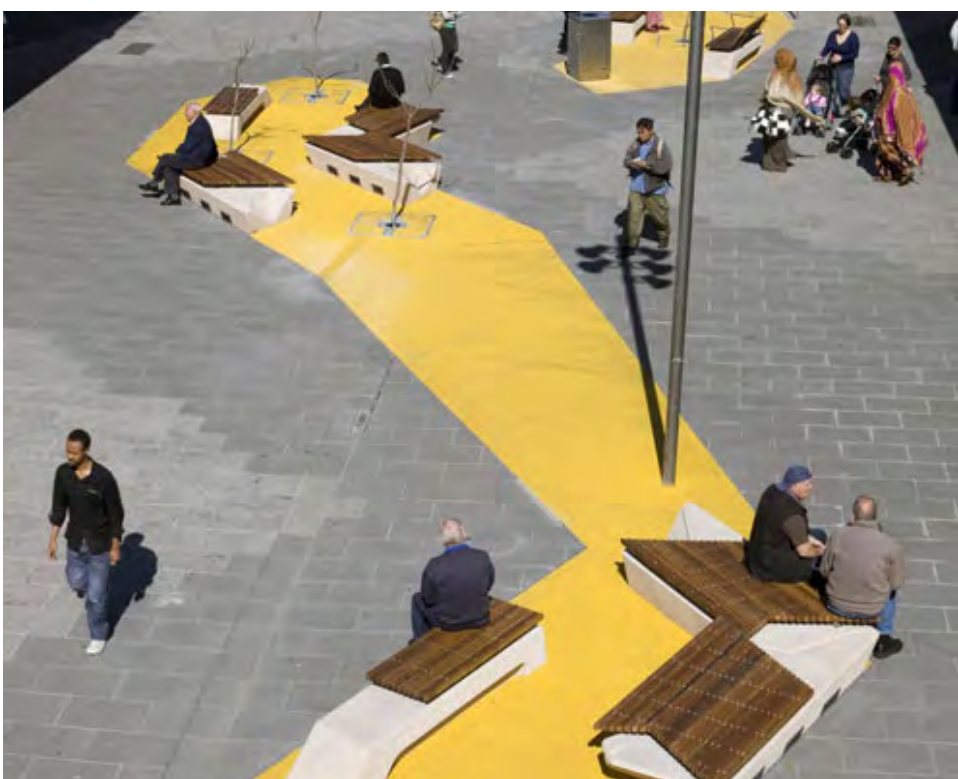

Dynamic paving helps to emphasize key crossings and corners



Color and graphics inspired by local murals and artists



Colorful furnishings give character

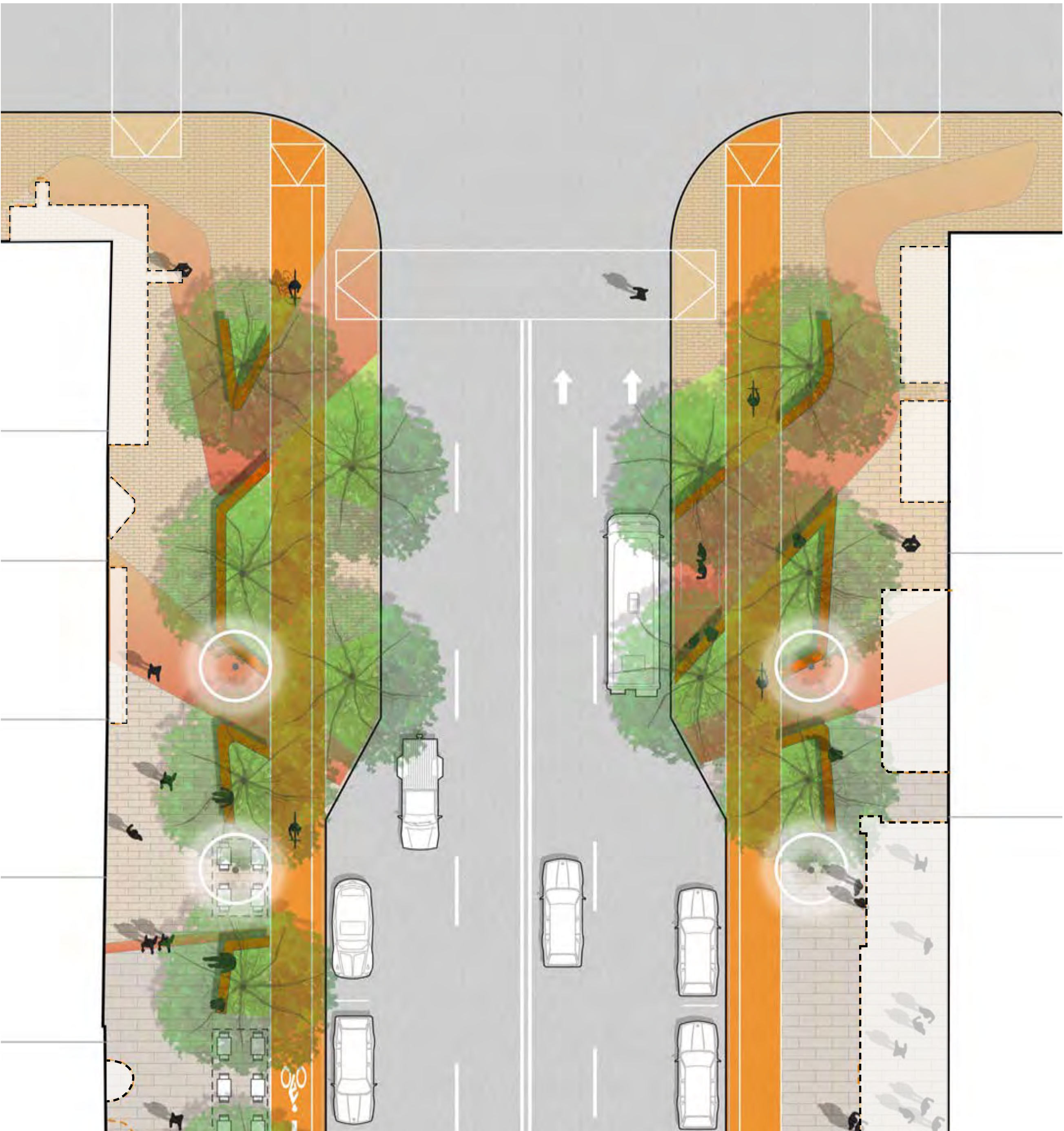

A dynamic streetscape has graphic paving and clusters of seating emphasizing crossings.

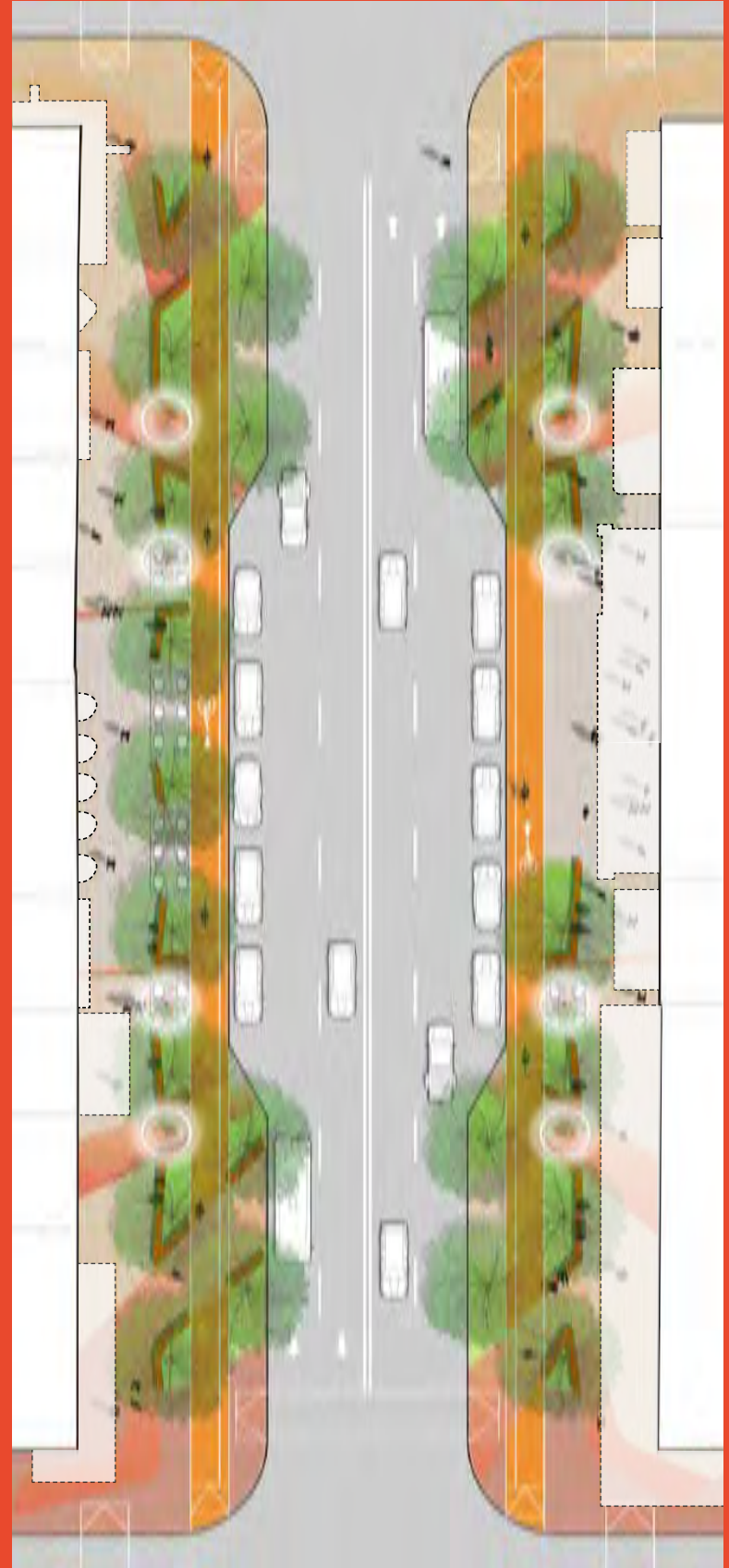

BRIDGE LANDINGS

The northern bridge landings use the same playful design language, creating a series of ramps and rooms for accessible connection and gathering. On the south bridge landing, a sculptural feature marks the gateway moment.

PRECEDENTS

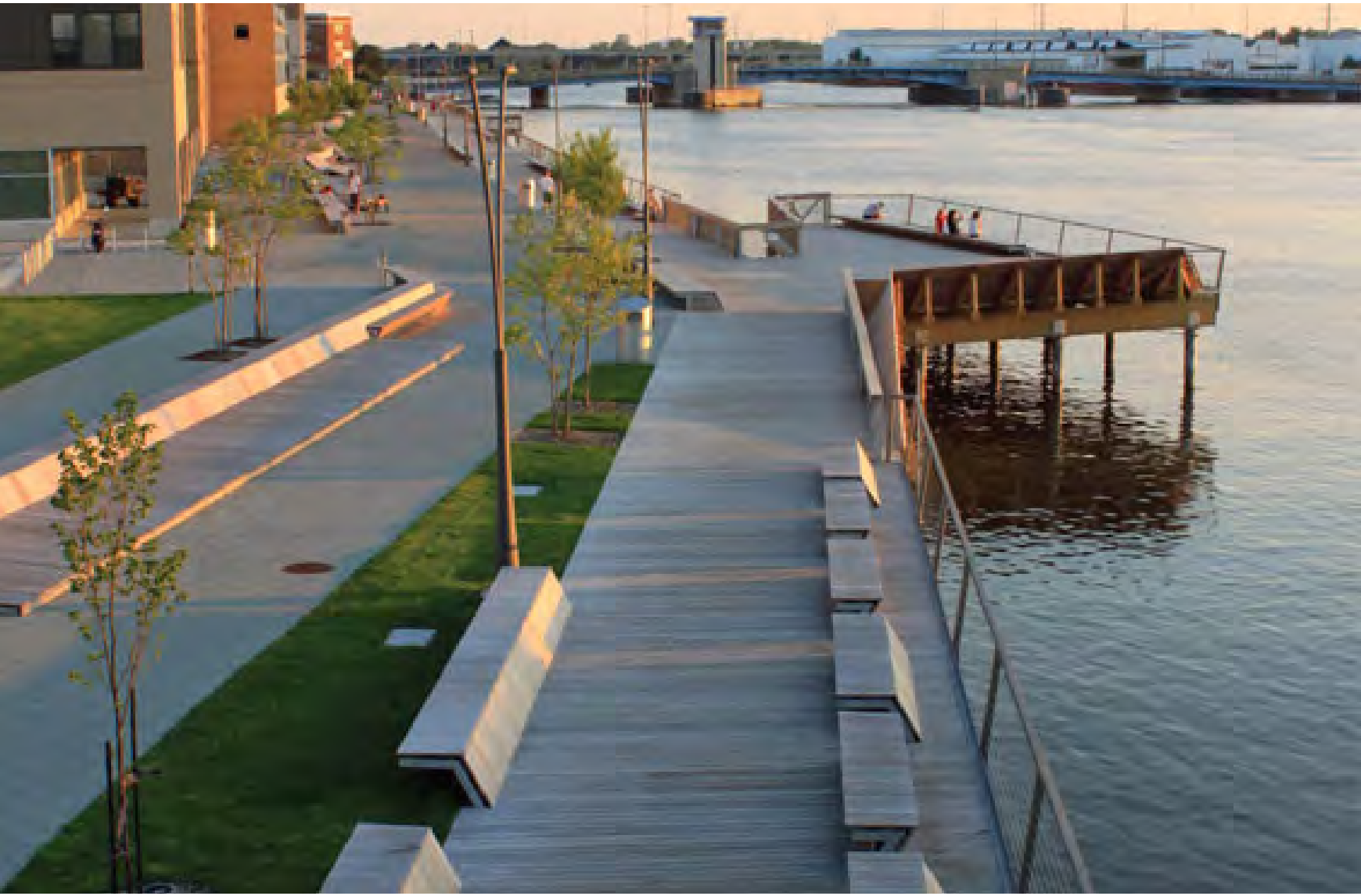

Deck overlooks



Ramps and Rooms

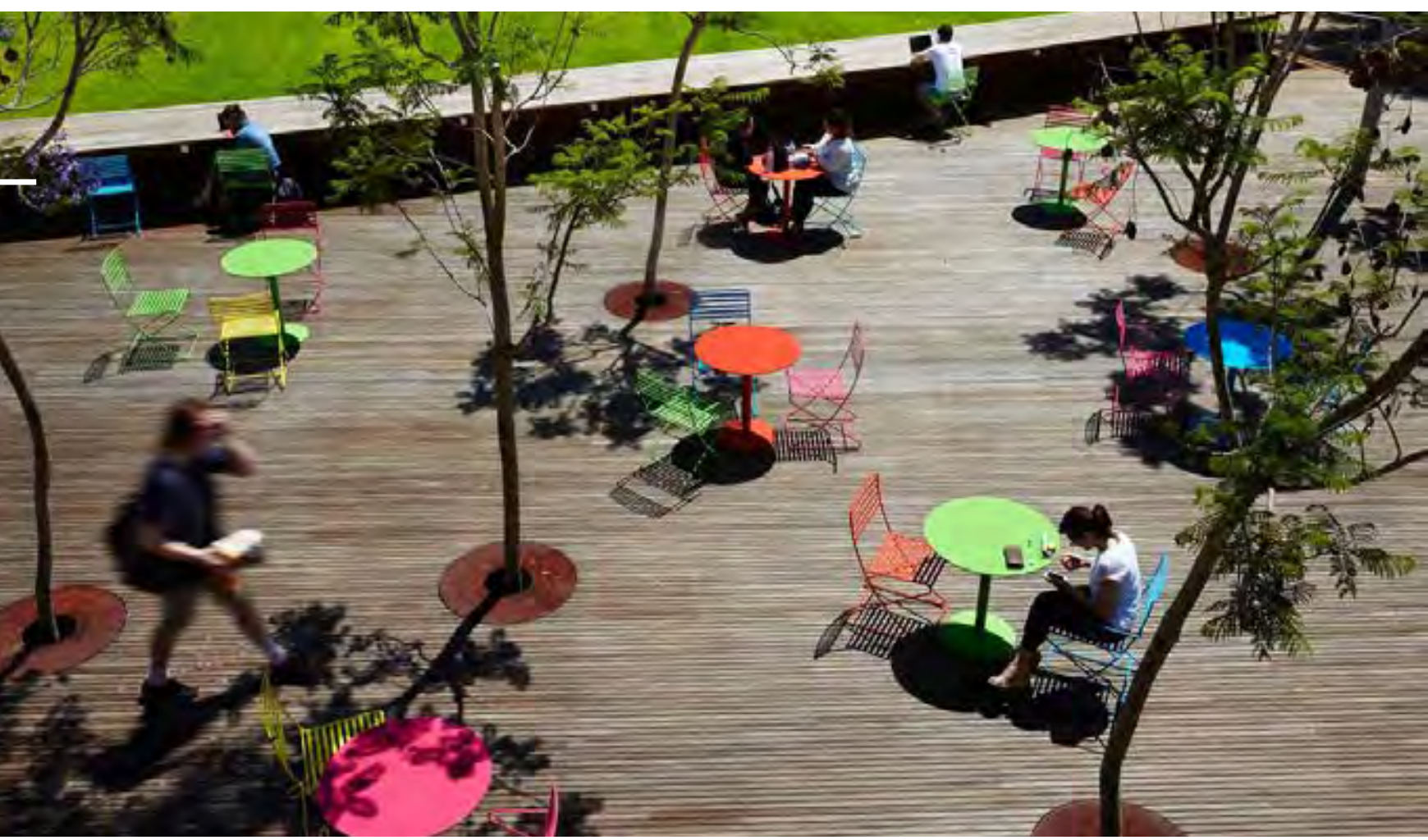

Decks with flexible seating



Dynamic sculptural elements

Station 6

Public Event 3: Imagine!

NORTH BRIDGE LANDING - RAMPS AND ROOMS

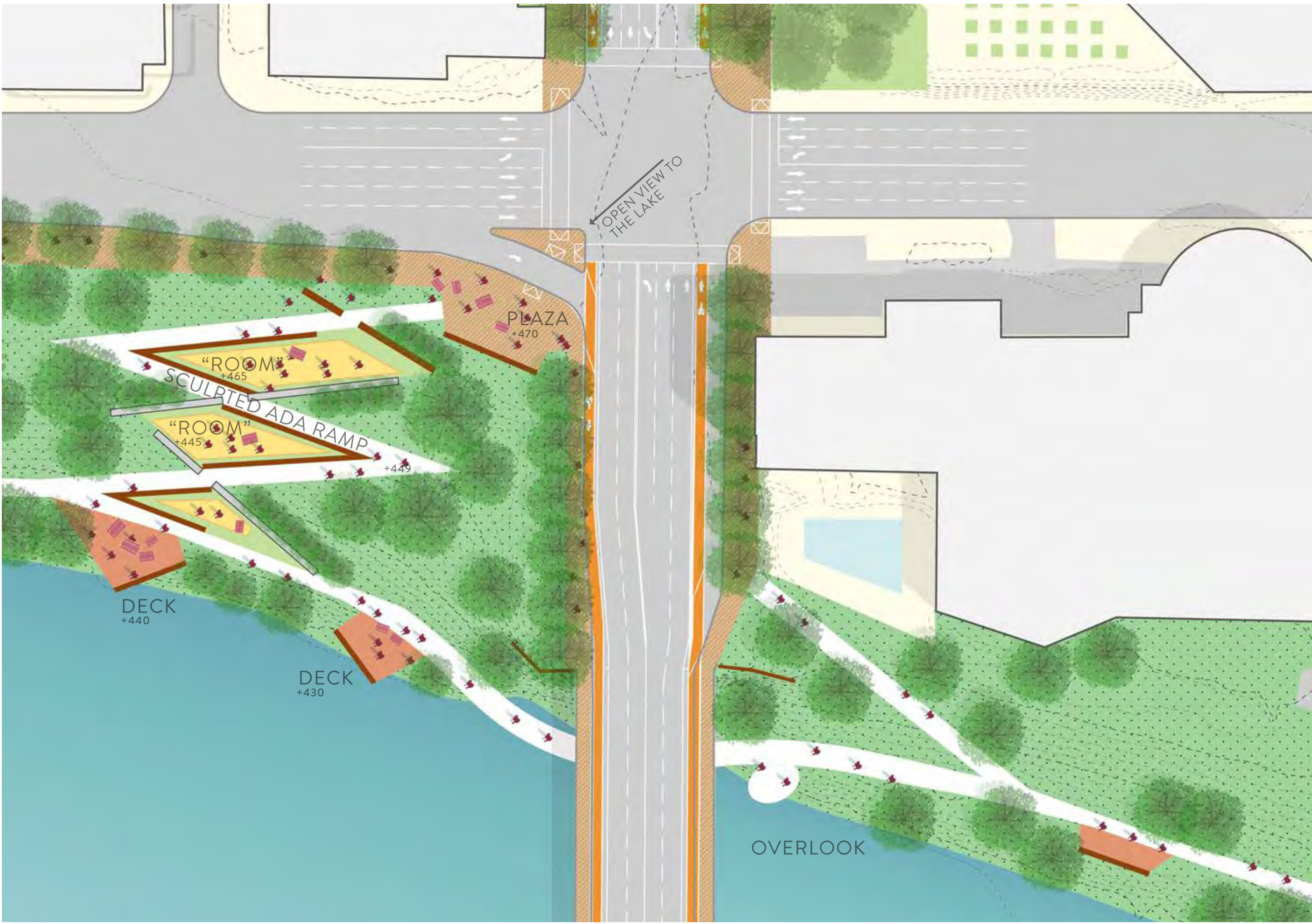

SOUTH BRIDGE LANDING - RAMPS AND ROOMS

