

**HISTORIC LANDMARK COMMISSION
MARCH 25, 2019
DEMOLITION AND RELOCATION PERMITS
HDP-2019-0121
5900 CAMERON ROAD**

PROPOSAL

Demolish seven church buildings constructed between 1956 and 1974.

ARCHITECTURE

The property was mostly developed around a central courtyard. See site map on p. 4 for building locations.

The Church Building (1956) is located at the middle of the property, facing Cameron Road. It is a two-story, rectangular-plan brick masonry building with a gable roof, 2:2 aluminum-sash windows, and minimal ornamentation (stone sills and quoining).

The Education Building (1962, addition in 1966) is located on the northeast side of the property. The 1962 building and 1966 addition comprise a one-story, rectangular-plan building with a flat roof, deep eaves, and brick wing walls separating bays with fixed aluminum-sash windows. Windows in the 1962 building are placed over terrazzo panels or vertical wood siding, while those in the 1966 addition are full-height.

The Sanctuary (1967) is a tall one-story building with a flat-topped gable roof, steeple, brick cladding at the front and vertical wood cladding at the rear, and brick colonnade walkways on both sides. The building fronts on Cameron Road and is connected to the Education Building with a low flat-roofed hyphen. This hyphen contains the primary entrance to the Sanctuary, paired fully glazed doors accessed from Clayton Lane.

The Classroom Building (1972) is located on the north edge of the property. It is a one-story rectangular-plan building with a flat roof, brick and vertical wood cladding, brick wing walls dividing inset structural bays, and fixed wood- or metal-sash windows. The Classroom Building is connected to the Education Building & Sanctuary by a covered walkway.

The Auditorium & Music Center (1974) is located at the west edge of the property. It is a double-height rectangular-plan building with a flat roof and concrete panel cladding with strong vertical divisions. Concrete awnings are located over paired fully glazed doors at entrances on the north, east, and west elevations.

A simple one-story wood-frame building constructed for use as classrooms is located between the Classroom Building and Auditorium & Music Center. It has a side-gabled roof, wood cladding, and 1:1 aluminum-sash windows.

The Annex is located at the south end of the property, separate from the other buildings. It is a one-story U-plan building with a cross-gabled roof, brick cladding, and aluminum-sash windows. Its construction date is unknown, as City permit records do not include a building permit.

RESEARCH

Windsor Park Baptist Church was formed in 1955 and completed its first building on the property, a church auditorium, in 1956. Most new construction expanded classroom space; four permanent buildings and one temporary building were dedicated to education between 1959 and 1972. The most prominent building on the property, a sanctuary at the corner of Cameron Road and Clayton Lane, was constructed in 1967. An Auditorium & Music Center was built in 1974.

Mt. Sinai Baptist Church moved onto the property in 1994.

STAFF COMMENTS

The property does not appear to meet the criteria for designation as a historic landmark.

Designation Criteria—Historic Landmark



- 1) At least four of the seven buildings are more than 50 years old. The construction date of the Annex is not known.
- 2) The buildings appear to retain a high degree of integrity, though their setting has changed as the property developed over time.
- 3) Properties must meet two significance criteria for landmark designation (City of Austin Land Development Code, Section 25-2-352). The property does not appear to meet two criteria.
 - a. **Architecture.** The Education Building (1962, 1966) is designed in the Mid-Century Modern style, with deep eaves supported by prominent beams, though Austin has many churches that provide examples of Mid-Century architecture in full complexes. Earl Dillard designed the original building, and there is at least one less crowded example of his Mid-Century Modern work (the Recreation Department/PARD offices). The other buildings do not appear to possess architectural distinction.
 - b. **Historical association.** Windsor Park Baptist Church constructed all buildings and occupied the site for nearly 40 years. There do not appear to be significant historical associations.
 - c. **Archaeology.** The property was not evaluated for its potential to yield significant data concerning the human history or prehistory of the region.
 - d. **Community value.** The property does not appear to have a unique location, physical characteristic, or significant feature that contributes to the character, image, or cultural identity of the city, a neighborhood, or a particular group. Newspaper records show some revivals at the Windsor Park Baptist Church, but the congregation does not appear to have been notably active in the community.
 - e. **Landscape feature.** The property is not a significant natural or designed landscape with artistic, aesthetic, cultural, or historical value to the city.

STAFF RECOMMENDATION

Approve the demolition application, subject to completion of a City of Austin Documentation Package, consisting of photographs of all elevations, a dimensioned sketch plan, and a narrative history, for archiving at the Austin History Center.

LOCATION MAP



-  SUBJECT TRACT
-  PENDING CASE
-  ZONING BOUNDARY

1" = 248'

NOTIFICATIONS

CASE#: HDP-2019-0121
LOCATION: 5900 Cameron Rd.

This product is for informational purposes and may not have been prepared for or be suitable for legal, engineering, or surveying purposes. It does not represent an on-the-ground survey and represents only the approximate relative location of property boundaries.

This product has been produced by CTM for the sole purpose of geographic reference. No warranty is made by the City of Austin regarding specific accuracy or completeness.



PROPERTY INFORMATION

Site Map

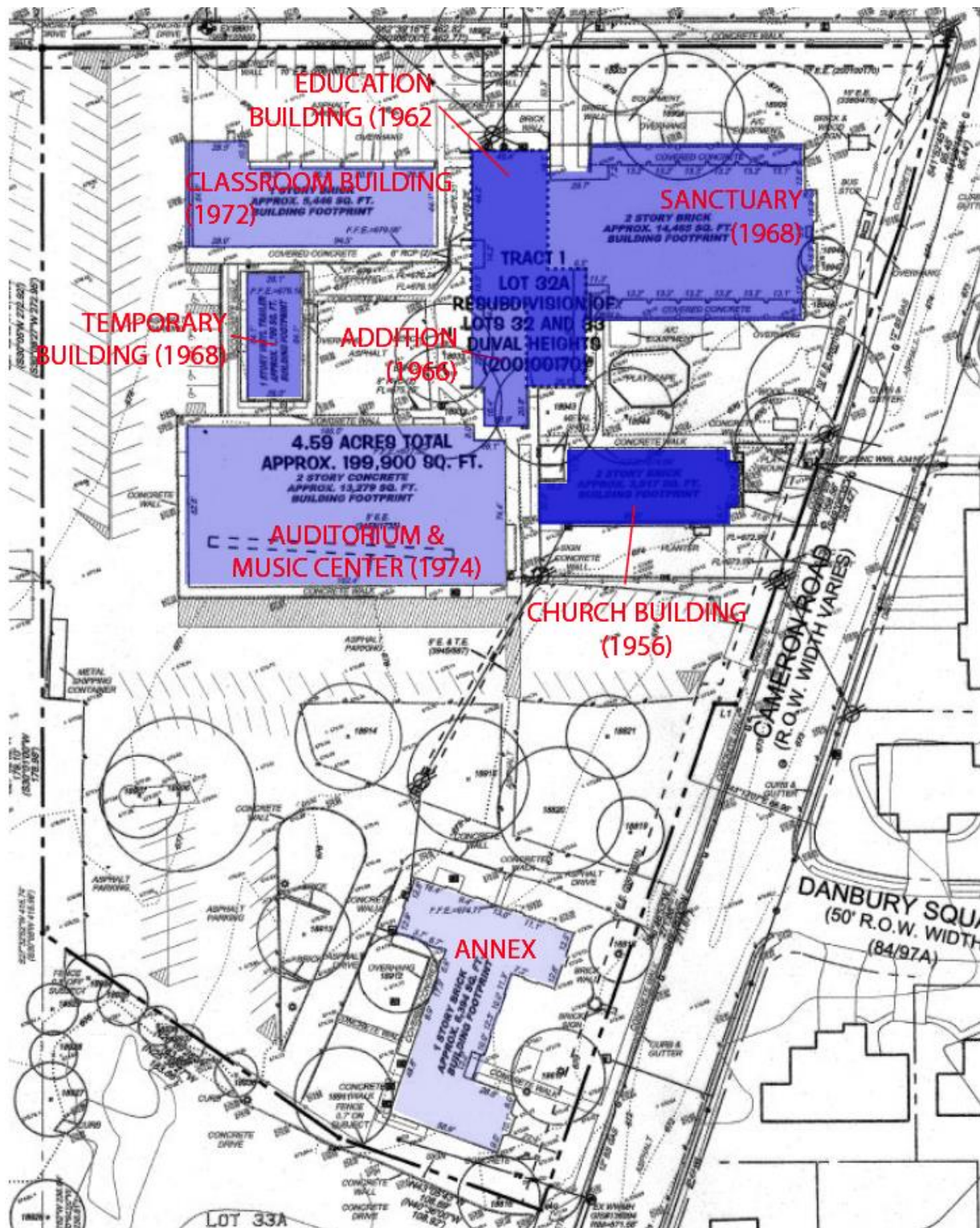

Photos

Photos provided by applicant.



Church Building (1956), from Cameron Road. The Auditorium & Music Center (1974) is visible in the rear.



Education Building (1962), looking north from playground (top) and south from Clayton Lane (bottom). The Sanctuary is in the background and the Classroom Building on the right.



Education Building (1966 addition), looking north from courtyard.



Sanctuary (1967), from Cameron Road.



Temporary Building (1968), looking northwest from courtyard. The Classroom Building is on the left and Auditorium & Music Center on the right.



Classroom Building (1972), looking northwest from courtyard (top) and south from parking lot (bottom). The Temporary Building is on the left.

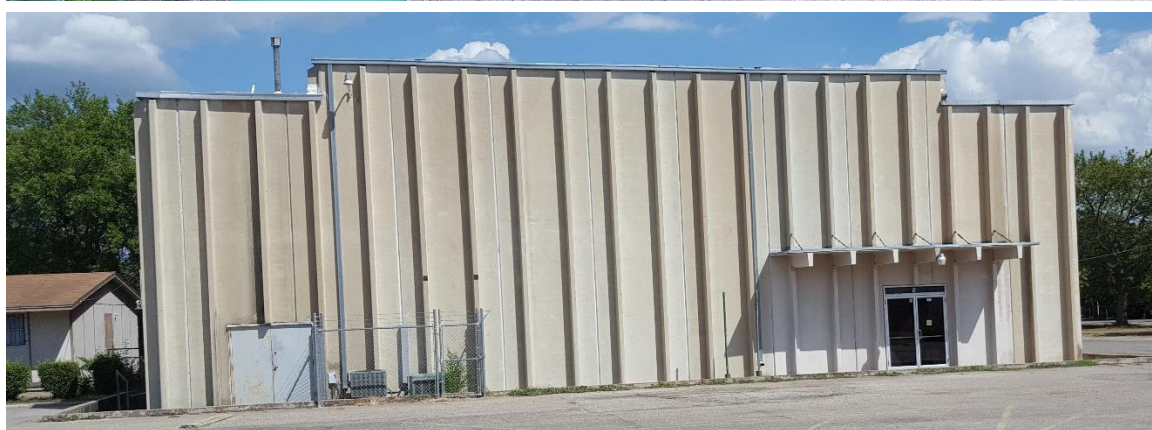
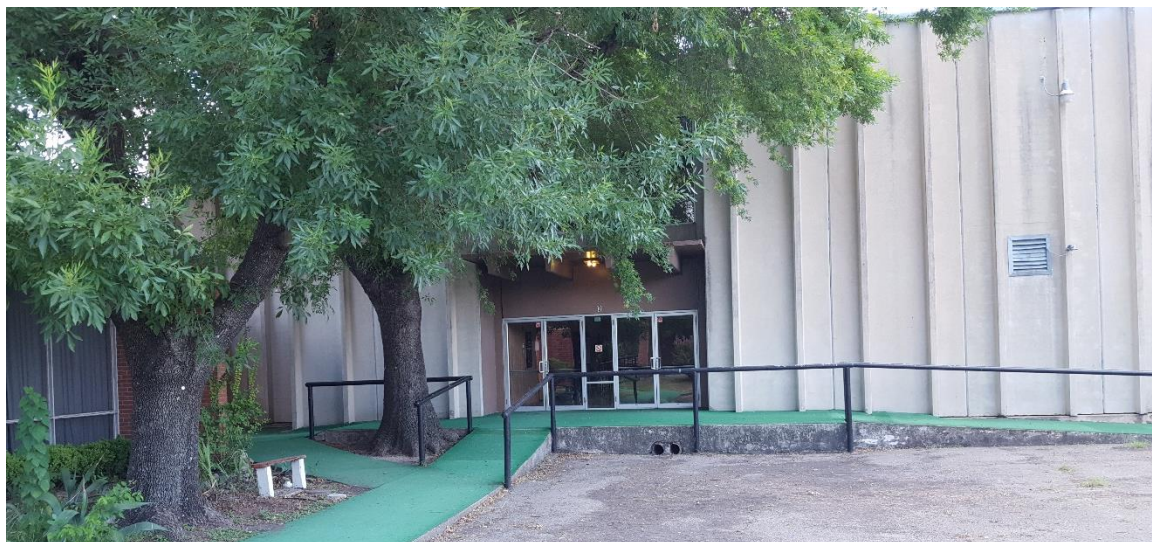

Auditorium & Music Center (1974), looking south from courtyard (top) and west from the rear parking lot (bottom).



Annex (date unknown), from Cameron Road.

Occupancy History

Completed by Historic Preservation Office staff
March 2019

1956-94 Windsor Park Baptist Church

1994- Mt. Sinai Baptist Church

Background Research

Windsor Park Baptist Church was formed in 1955. It began meeting at a temporary location at 5321 Cameron Road and simultaneously purchased three acres at 5900 Cameron Road. The congregation's first building on the property was a brick Church Building completed in 1956 at a cost of \$50,000; the first services were held there on Easter morning that year. A modern Sanctuary was constructed in 1967 for \$175,000.

Most of the changes on the property have been to expand classroom space. In 1959, a building was moved onto the lot from Bergstrom Air Force Base for Sunday school use; this building was demolished around 1966, according to site plans. In 1962, an Education Building was designed by Earl Dillard and constructed by A. W. Bryant for just under \$43,000.

In 1964, the church began offering a second worship service, indicating increased attendance. Improvements soon followed: An addition to the Education Building was constructed in 1966 for \$34,000 to hold additional classrooms. A second, very simple building with classroom space was constructed in 1968 for \$14,000. In 1972, a third separate Classroom Building was constructed for \$65,000.

The newest building on the property is an Auditorium and Music Center built in 1974 for \$300,000, an amount financed through bond sales. L. O. Bentley & Associates was the contractor.

Mt. Sinai Baptist Church moved onto the property in 1994, well after the historic period ended.

Earl Dillard designed the Education Building (1962). Dillard was a local architect active in the mid-1950s through the mid-1960s. He designed the Texas Industrial Loan Company Building (1955; now Star Bar), new offices for the Recreation Department (1958, now the Parks and Recreation Department), a bowling alley (1958), a credit union (1963), and a new auditorium for the Congress Avenue Baptist Church (1965-66).

New Baptist Church Begins

The Windsor Park Baptist Church, a new church, is beginning work in the Windsor Park area with the temporary meeting place being 5321 Cameron Road. Services will begin Sunday Nov. 20, with Sunday School at 9:45 a. m. and worship service at 11 a. m.

The pastor, W. T. Johnson, has revealed that three acres have been purchased for the future site of the church. The public is invited to all services.

"New Baptist Church begins," The Austin American, 11/20/1955.

New Auditorium Services Slated

The Windsor Park Baptist Church will hold its first service Easter morning in the newly completed auditorium at 5900 Cameron Road, the Rev. W. T. Johnson, pastor, has announced.

Services will include Sunday

School at 9:45 a. m., morning worship at 11 a. m., Baptist Training Union meeting, 6:30 p. m. and evening worship, 7:30 p. m.

"New auditorium services slated," The Austin Statesman, 3/30/1956.

Baptists Okay Sale of Bonds

WINDSOR PARK BAPTIST CHURCH, 5900 Cameron Rd., has approved a Master Plan of Finance to sell bonds for expansion of their facilities.

A steering committee has been announced and includes, Odus Crumley, general chairman; John Powell, vice chairman; Ken

Huff, publicity director; Scott Clay, prospect chairman; and Patsy Crumley, service committees.

Team managers are John Shirley, Bob Osborn, Ray Smith, Joe Mitchell, Tom Seago, Wayne Blacklock, Darrell Martin, Walter Davis, Bob Ramsey, Don Shults and Frank Miller.

Dr. Jack Smith is pastor.

"Baptists okay sale of bonds," The Austin Statesman, 10/13/1973.

Building Permits

Windsor Park Baptist Ch.		5900 Cameron Rd.
234	32	
Duval Hts.		
Br. Church Bldg.		
62549	1-5-56	\$50,000.00
Owner		6.

Building permit issued to Windsor Park Baptist Church for a brick church building, 1/5/1956.

Windsor Pk Baptist Ch		5900 Cameron Road
234	32	
Duval Hts.		
MOVE		
Building on lot & repair		
72111	3/12/59	4000.00
R. B. Carlow		4
W. on lot		S. on lot
FROM: BERGSTROM AFB Sunday School & Church Activity		
This building will not be used as a parochial or private school.		

Relocation permit issued to Windsor Park Baptist Church to move a building onto the property, 3/12/1959. It is likely that this was an L-shaped building roughly at the location of the Auditorium & Music Center; it is shown on other permit applications. The building was demolished around 1966.

Windsor Park Bapt. Church		5900 Cameron Rd.
234	32	-
Duval Heights		
Frame Educational Bldg.		
84849	8-2-62	42,954.00
A. W. Bryant		3
<p>EDUCATIONAL BLDG. 10 Paved off-street parking places provided. Corridor walls & Ceiling to be 1 hour Resistive Equipment room to be 2 hour Resistive</p>		

Building permit issued to Windsor Park Baptist Church for a wood-frame educational building, 8/2/1962.

<u>OWNER</u> Windsor Park Baptist Ch.		<u>ADDRESS</u> 5900 Cameron Road	
<u>PLAT</u> 234	<u>LOT</u>	32	<u>BLK</u> 0
<u>SUBDIVISION</u> Duval Hts.			
<u>OCCUPANCY</u> Church Classrooms			
<u>BLD PERMIT #</u> 101607	<u>DATE</u> 11-28-66	<u>OWNERS</u>	
		<u>ESTIMATE</u>	34,000.00
<u>CONTRACTOR</u> owner	<u>NO. OF FIXTURES</u>		see plans
<u>WATER TAP REC #</u>	<u>SEWER TAP REC #</u>		
<u>One Story Masonry Addition to Church Building</u>			
<u>2,494 sq.ft.</u>			

Building permit issued to Windsor Park Baptist Church for a wood-frame addition to the Education Building, 11/28/1966.

<u>OWNER</u> Windsor Park Baptist Church		<u>ADDRESS</u> 5900 Cameron Rd.	
<u>PLAT</u> 234	<u>LOT</u> 32	<u>BLK</u> --	
<u>SUBDIVISION</u> Duval Heights			
<u>OCCUPANCY</u> Classroom Bldg.			
<u>BLD PERMIT #</u> 106991	<u>DATE</u> 2-27-68	<u>OWNERS ESTIMATE</u>	\$14,000.00
<u>CONTRACTOR</u> Industrial Laminates Corp		<u>NO. OF FIXTURES</u>	--
<u>WATER TAP REC #</u> exist	<u>SEWER TAP REC #</u>	exist	
Frm. one story classroom bldg.		1792 sq. ft.	

Building permit issued to Windsor Park Baptist Church for a one-story wood-frame building to be used for classrooms, 2/27/1968.

<u>OWNER</u> Windsor Park Baptist Church		<u>ADDRESS</u> 5900 Cameron Rd.	
<u>PLAT</u> 234	<u>LOT</u> 32	<u>BLK</u> -	
<u>SUBDIVISION</u> Duval Hgts.			
<u>OCCUPANCY</u> classrooms			
<u>BLD PERMIT #</u> 107188	<u>DATE</u> 3-12-68	<u>OWNERS ESTIMATE</u>	\$2,500.00
<u>CONTRACTOR</u> owner		<u>NO. OF FIXTURES</u>	-
<u>WATER TAP REC #</u> -	<u>SEWER TAP REC #</u>	-	
remodel interior of exist church bldg.			

Building permit issued to Windsor Park Baptist Church for interior remodeling, likely to the Church Building or the Education Building, 3/12/1968.

OWNER	Windsor Park Baptist Church			ADDRESS	5900 Cameron Road		
PLAT	234	LOT	32	BLK	0		
SUBDIVISION	Duval Heights						
OCCUPANCY	Chruch Sanctrary						
BLD PERMIT #	102856	DATE	3-22-67	OWNERS	ESTIMATE 175,000		
CONTRACTOR	Star Field Constructors			NO. OF FIXTURES	see plans		
WATER TAP REC #				SEWER TAP REC #			
One Story Masonry Building •							
11,667 sq.ft.							

Building permit issued to Windsor Park Baptist Church for a one-story masonry building to be used as a church sanctuary, 3/22/1967.

OWNER	Windsor Park Bapt. Church			ADDRESS	5900 Cameron Road		
PLAT	234	LOT	32	BLK			
SUBDIVISION	Duval Hts.						
OCCUPANCY	Classrooms						
BLD PERMIT #	127282	DATE	1-24-72	OWNERS	ESTIMATE \$65,000.00		
CONTRACTOR	owner			NO. OF FIXTURES	see plans		
WATER TAP REC #	Exist			SEWER TAP REC #	Exist		
One story masonry ven and wood frm addn to exist							
comm bldg. 5781.2 sq.ft.							

Building permit issued to Windsor Park Baptist Church for a one-story masonry and wood-frame addition to be used as classrooms, 1/24/1972. This is most likely the Classroom Building.

OWNER	Windsor Park Bapt. Church			ADDRESS	5900 Cameron Road		
PLAT	234	LOT	32		BLK		
SUBDIVISION	Duval Hts.						
OCCUPANCY	Classrooms						
BLD PERMIT #	127282	DATE	1-24-72	OWNERS ESTIMATE	\$65,000.00		
CONTRACTOR	owner			NO. OF FIXTURES	see plans		
WATER TAP REC #	Exist			SEWER TAP REC #	Exist		
One story masonry ven and wood frm addn to exist							
comm bldg. 5781.2 sq.ft.							

Building permit issued to Windsor Park Baptist Church for a one- and two-story Auditorium and Music Center, 6/7/1974.

City records indicate that an addition was constructed in 1987 for "church & day school rooms." It is not clear what building received the addition.