

**ORDINANCE AMENDMENT REVIEW SHEET**

**Amendment:** University Neighborhood Overlay Height.

**Description:** Discuss and consider an ordinance amending Title 25 of the City Code to change allowable building height in the Outer West Campus Subdistrict of the University Neighborhood Overlay District.

**Proposed Language:** See attached draft ordinance.

**Summary of proposed code amendment**

- Amend the University Neighborhood Overlay Height District map (Outer West Campus subdistrict), to change the allowable height from 50 feet to 65 feet, for an area generally within the boundaries of W. 25th St, Leon St, W. 24th St, and Longview St (see map for exact location).

**Background:** Initiated by Planning Commission on 3/12/19

**Staff Recommendation:** Staff recommends the proposed code amendment.

**Board and Commission Actions:**

April 17, 2019: Recommended to Planning Commission by the Codes and Ordinance Joint Committee; vote 5-0 (Commissioners Kazi and Barrera-Ramirez absent) with additional direction for the property at 2408 Leon to enter into a restrictive covenant such that the project will comply with any revised affordability requirements of UNO, should they be adopted and codified in the future.

April 23, 2019: Scheduled to be heard and considered by Planning Commission.

**Council Action**

May 23, 2019: A public hearing has been scheduled.

**Ordinance Number:** NA

**City Staff:** Jerry Rusthoven      **Phone:** (512) 974-3207      **Email:** jerry.rusthoven@austintexas.gov

## COA Law Department

## University Neighborhood Overlay Height Districts

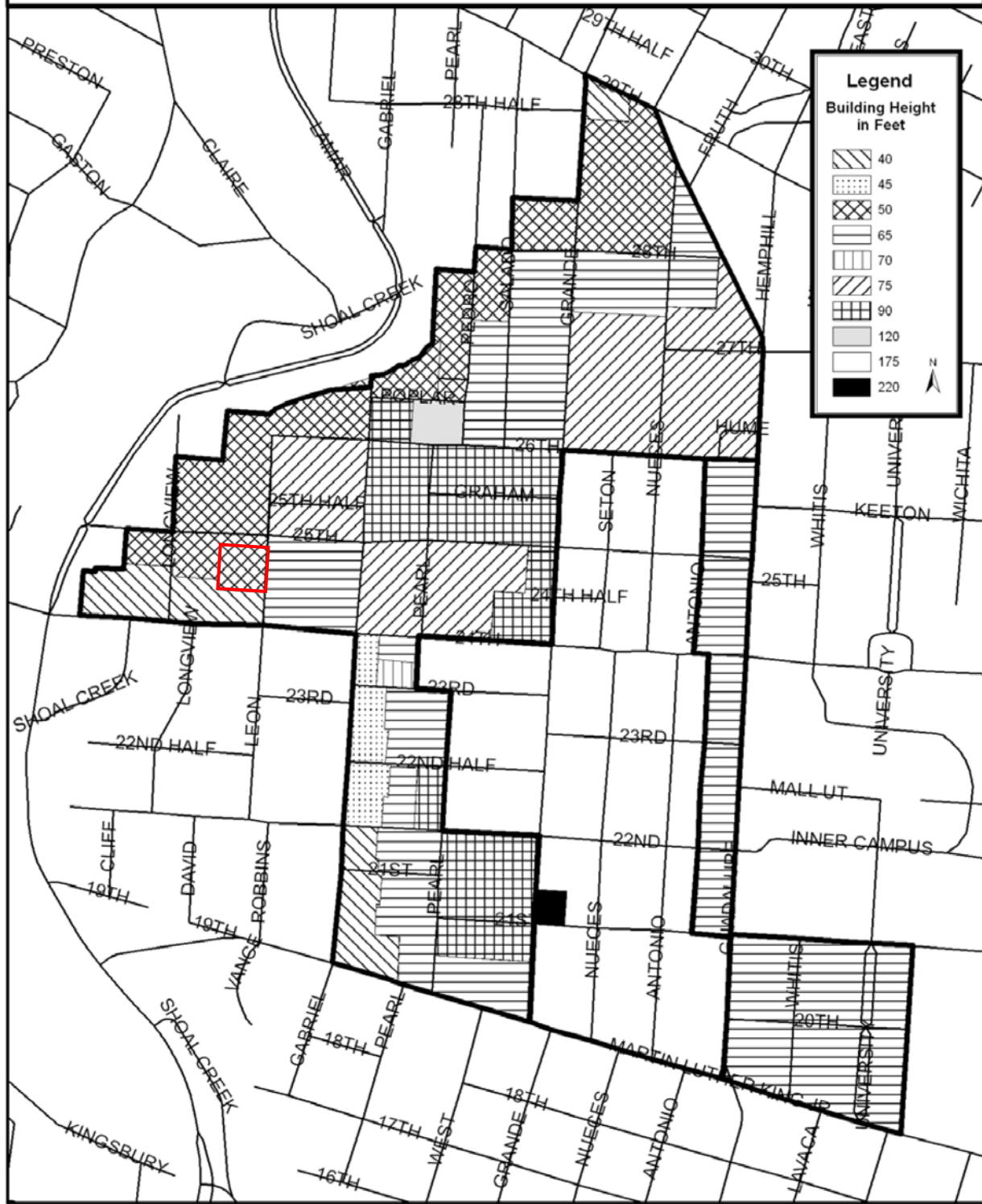

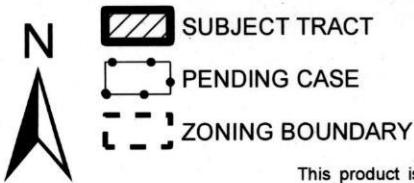

**Zoning Case**  
C14-2018-0112  
**EXHIBIT A**

**THIS MAP FOR  
ILLUSTRATIVE  
PURPOSES ONLY, TO  
SHOW SUBJECT AREA**



This product is for informational purposes and may not have been prepared for or be suitable for legal, engineering, or surveying purposes. It does not represent an on-the-ground survey and represents only the approximate relative location of property boundaries.

This product has been produced by CTM for the sole purpose of geographic reference. No warranty is made by the City of Austin regarding specific accuracy or completeness.

$$1'' = 200'$$