

SUBDIVISION REVIEW SHEET

CASE NO.: C8-2019-0056.0A

ZAP DATE: May 7, 2019

SUBDIVISION NAME: Westlake Heights

AREA: 2.25

LOT(S): 1

OWNER/APPLICANT: Hutson Land Planners (Charles Dunn)

AGENT: N/A

ADDRESS OF SUBDIVISION: 1608 Barclay Drive

GRIDS: E23

COUNTY: Travis

WATERSHED: Eanes Creek

JURISDICTION: Full-Purpose

EXISTING ZONING: SF-2

MUD: N/A

NEIGHBORHOOD PLAN: N/A

PROPOSED LAND USE: Single Family

ADMINISTRATIVE WAIVERS:

VARIANCES: None

SIDEWALKS: Sidewalks will be provided on both sides of all internal streets and the subdivision side of boundary streets.

DEPARTMENT COMMENTS: The request is for approval of the Westlake Heights Final Plat. The proposed plat is composed of 1 lot on 2.25 acres.

STAFF RECOMMENDATION: Staff recommends disapproval of the plat. This plat does not meet all applicable State and City of Austin LDC requirements.

PLANNING COMMISSION / ZONING AND PLATTING ACTION:

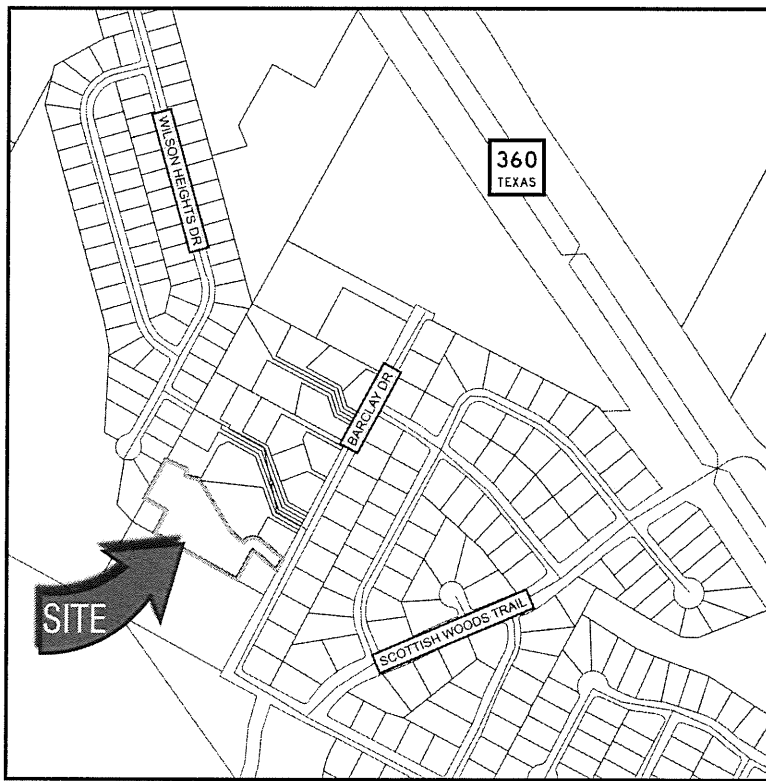

TR# 12175434

Legend

— Tract Boundary

Location Map

1608 Barclay Dr

SCALE: N.T.S.



Hutson Land Planners
Development Consultants, LLC