

**RULE NO.: R161-19.15**

**NOTICE OF PROPOSED RULE**

**POSTING DATE: July 9, 2019**

The Director of the Department of Austin Water proposes to adopt the following rule on or after August 10, 2019.

Comments on the proposed rule are requested from the public. Comments should be submitted to Mr. Eric Langhout, P.E.; Austin Water, 3907 S. Industrial Dr., Suite 236, Austin, Texas 78744, 512-972-0073, or via email at [Eric.Langhout@austintexas.gov](mailto:Eric.Langhout@austintexas.gov). To be considered, comments must be submitted before August 10, 2019, the 32nd day after the date this notice is posted. A summary of the written comments received will be included in the notice of rule adoption that must be posted for the rule to become effective.

An affordability impact statement regarding the proposed rule has been obtained and is available for inspection or copying at the address noted in the preceding paragraph.

**EFFECTIVE DATE OF PROPOSED RULE**

A rule proposed in this notice may not become effective before the effective date established by a separate notice of rule adoption. A notice of rule adoption may not be posted before August 10, 2019 (the 32nd day after the date of this notice) or not after September 17, 2019 (the 70th day after the date of this notice).

If a proposed rule is not adopted on or before September 17, 2019, it is automatically withdrawn and cannot be adopted without first posting a new notice of a proposed rule.

**TEXT OF PROPOSED RULE**

A copy of the complete text of the proposed rule is available for public inspection and copying at the following locations. Copies may be purchased at the following locations at a cost of ten cents per page:

Austin Water, located at 3907 S. Industrial Dr., Suite 236, Austin, Texas, 78744. See Mr. Eric Langhout, P.E. and:

Office of the City Clerk, City Hall, located at 301 West 2nd Street, Austin, Texas.

## **BRIEF EXPLANATION OF PROPOSED RULE**

R161-19.15: Proposed revision to the Standard Details 503 & 520

### **Rule 1 – Standard Details 503 & 520**

- Standard Detail 503S-7W – This Standard Detail is being deleted to transfer the applicable information to Standard Detail 520-AW-03.
- Standard Detail 520-AW-01B – This Standard Detail is being revised to move “Meter Box and Cover” out of “Materials to be installed by Plumbers”. It will also remove the option to mount ball valves vertically.
- Standard Detail 520-AW-03 – This Standard Detail is being created to remove the "locking lid" option. It will also change the reference from "SPL WW-622" to "SPL WW-145A", remove the concrete pad, include applicable information from Standard Detail 503S-7W, and discontinue Standard Detail 503S-7W.

## **AUTHORITY FOR ADOPTION OF PROPOSED RULE**

The authority and procedure for adoption of a rule to assist in the implementation, administration, or enforcement of a provision of the City Code is provided in Chapter 1-2 of the City Code. The authority to regulate construction requirements is established in Section 552.001 of the Texas Local Government Code and Title 15 of the City Code.

## CERTIFICATION BY CITY ATTORNEY

By signing this Notice of Proposed Rule R161-19.15, the City Attorney certifies the City Attorney has reviewed the rule and finds that adoption of the rule is a valid exercise of the Director's administrative authority.

### REVIEWED AND APPROVED

  
\_\_\_\_\_  
Greg Meszaros, Director  
Austin Waters

Date: \_\_\_\_\_

  
\_\_\_\_\_  
Anne L. Morgan  
City Attorney

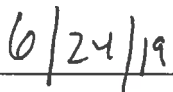
Date: \_\_\_\_\_

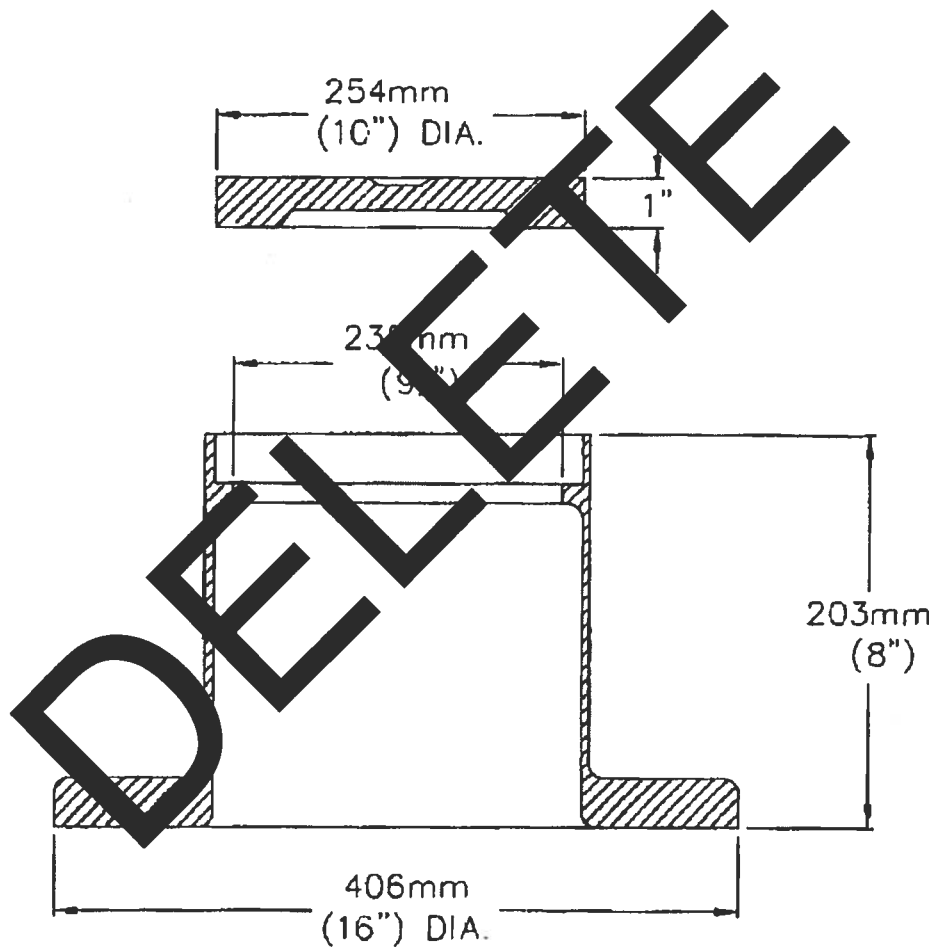
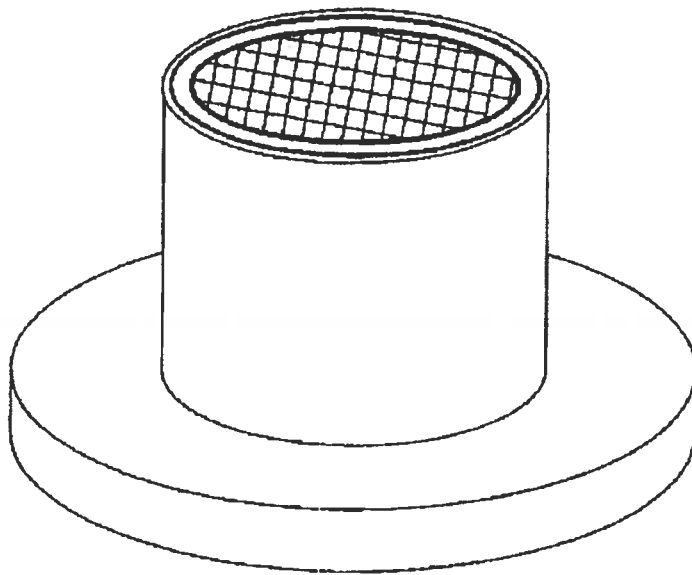

NOTES:

1. HEAVY DUTY.
2. SEE SPL WW-622 FOR MORE INFORMATION.

CITY OF AUSTIN  
AUSTIN WATER UTILITY

CLEANOUT RING AND COVER

*Kathi A. Flowers* 6/01/10  
ADOPTED

THE ARCHITECT/ENGINEER ASSUMES  
RESPONSIBILITY FOR APPROPRIATE USE  
OF THIS STANDARD.

STANDARD NO.  
503S-7W

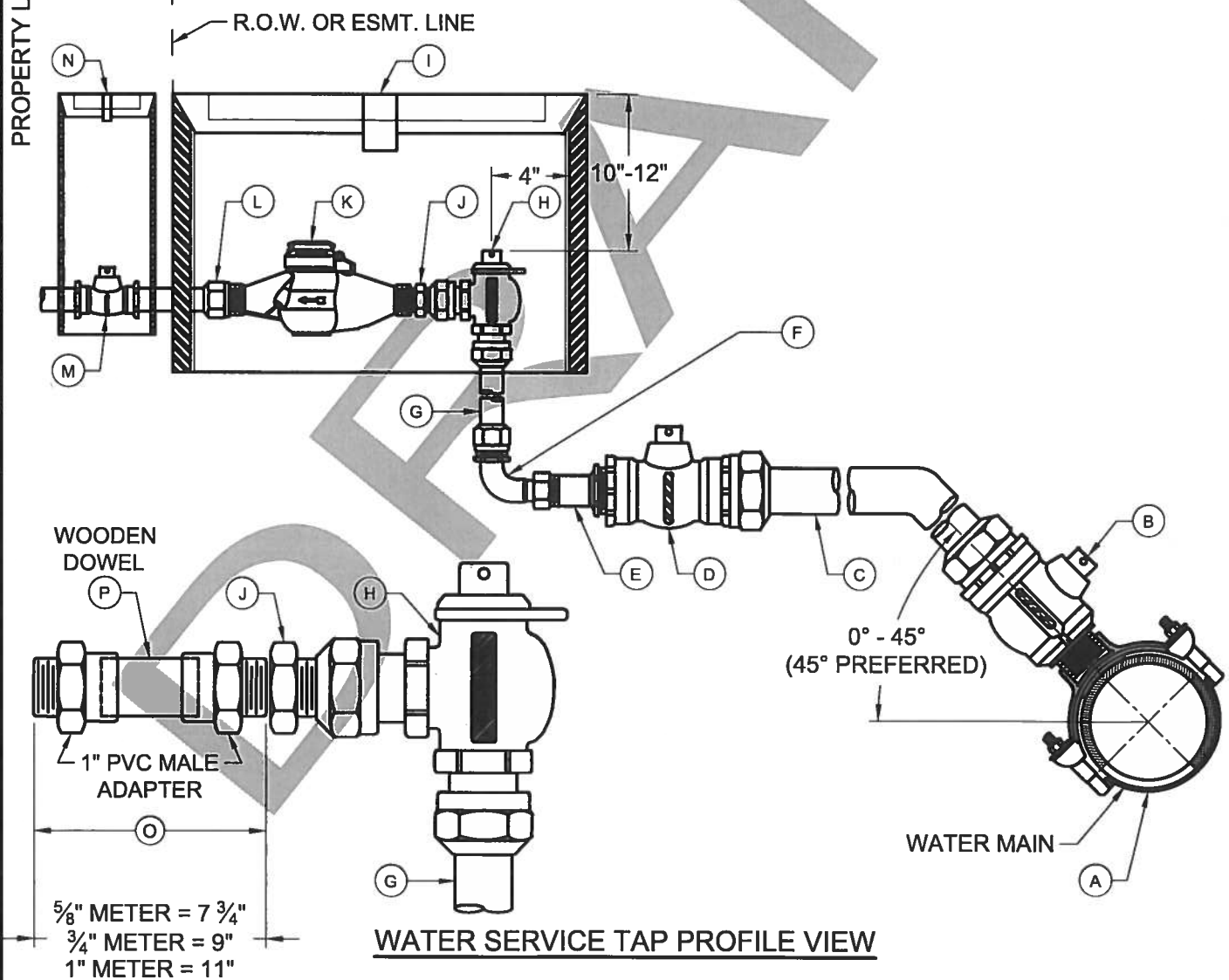
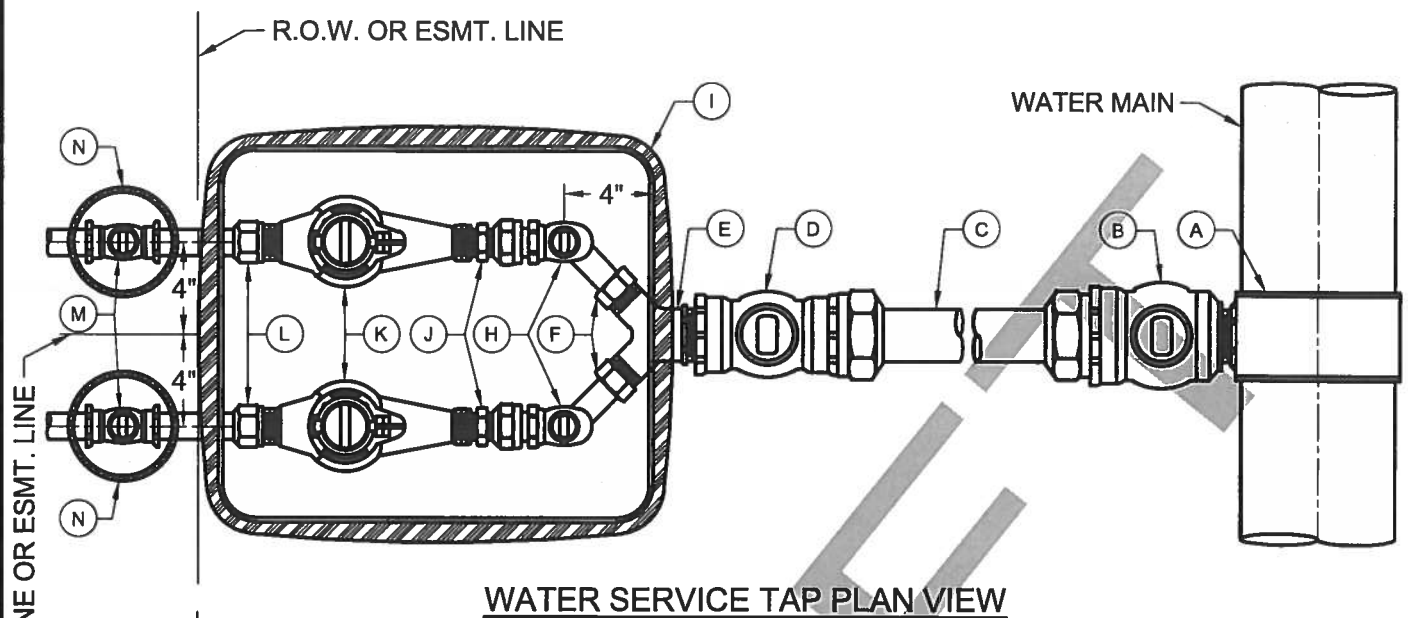

CITY OF AUSTIN AUSTIN WATER	WATER SERVICE & METER INSTALLATION - 1" & SMALLER METERS	
DRAFT	03/05/2019	STANDARD NO. 520-AW-01B 1 OF 2

THE ARCHITECT/ENGINEER ASSUMES  
RESPONSIBILITY FOR APPROPRIATE  
USE OF THIS STANDARD.

## MATERIALS LIST:

- A. 2" SERVICE CLAMP, SPL WW-264
- B. 2" CORPORATION STOP, SPL WW-68
- C. 2" HDPE WATER SERVICE TUBING, SPL WW-65
- D. 2" BALL VALVE, SPL WW-68
- E. SINGLE SERVICE: 2" MIP X 1" COPPER FLARE FITTING, SPL WW-68 OR  
DOUBLE SERVICE: 2" MIP X 1" COPPER FLARE WYE, SPL WW-68
- F. 1" SWIVEL NUT x 1" COMPRESSION 90° BEND, SPL WW-68
- G. 1" HDPE WATER SERVICE TUBING, SPL WW-65
- H. 1" ANGLE METER STOP, SPL WW-68
- I. METER BOX AND LID, SPL WW-145A;  
FOR DUAL 1" METERS: USE TWO SINGLE METER BOXES

## MATERIALS TO BE INSTALLED BY PLUMBER:

- J. BRASS METER BUSHING - SIZE AS NEEDED TO CONNECT ANGLE METER STOP TO METER
- K. WATER METER PURCHASED FROM AUSTIN WATER
- L. BRASS WATER METER COUPLING MALE IPT x SWIVEL COUPLING NUT:  
5/8" AND 3/4" METERS: 8 1/2" LONG x 3/4" DIA.  
1" METERS: 8 1/2" LONG x 1" DIA.
- M. PROPERTY OWNER'S CUT OFF VALVE, SPL WW-276
- N. PROPERTY OWNER'S CUT OFF VALVE BOX AND LID
- O. TEMPORARY METER SPACER (REQUIRED TO ASSURE METER WILL FIT APPROPRIATELY)
- P. 1" WOODEN DOWEL (SHOW ADDRESS ON DOWEL USING WATERPROOF MARKER)

## NOTES:

- 1. SERVICE CLAMP SHALL BE WRAPPED COMPLETELY WITH 8 MIL. POLYETHYLENE FILM, SPL WW-27D.
- 2. BRANCH CONNECTIONS AND ALL ANGLE METER STOPS MUST BE INSTALLED PRIOR TO ANY METER INSTALLATION.
- 3. TOP OF METER BOXES SHOULD BE 4" ABOVE GROUND.
- 4. PIPING AND TUBING IN STREET RIGHT-OF-WAY SHALL BE BEDDED IN GRANULAR MATERIALS AS REQUIRED BY SECTION 510.3 (14) OF THE CITY OF AUSTIN STANDARD SPECIFICATIONS; BACKFILL ABOVE GRANULAR BEDDING AS REQUIRED BY SECTION 510.3 (25).
- 5. METER BOX MUST BE BEHIND CURB NEXT TO PROPERTY LINE OR EASEMENT AND OUT OF VEHICULAR TRAFFIC AREA AND SIDEWALK.
- 6. BALL VALVE "D" SHALL NOT BE LOCATED UNDER SIDEWALK, CURB, OR PAVEMENT, AND NOT BE LOCATED MORE THAN 36" BELOW FINAL GRADE.
- 7. METER SIZES TO BE SHOWN ON PLANS.
- 8. METER BOX CUT OUTS SHALL NOT EXCEED TWO TIMES THE PIPE DIAMETER.
- 9. INSTALL METALLIC TRACER TAPE, SPL WW-597, MINIMUM 1' ABOVE TUBING FROM SERVICE CLAMP "A" TO BALL VALVE "D".
- 10. TUBING SHALL BE PLACED IN A STRAIGHT ALIGNMENT AND ALLOWED TO RELAX AND "SNAKE" LOOSELY IN THE TRENCH. TUBING BEHIND CURB AND GUTTER SHALL BE INSTALLED WITH A MINIMUM 2' DEPTH OF COVER.
- 11. 1" TUBING, WHEN BENT, SHALL HAVE A RADIUS NO SMALLER THAN 3'. 2" TUBING, WHEN BENT, SHALL HAVE A RADIUS NO SMALLER THAN 5'. BRASS FITTINGS SHALL NOT BE CONNECTED TO A BENT SECTION OF TUBING.
- 12. SOLID, TUBULAR STAINLESS STEEL INSERT STIFFENERS FOR HDPE TUBING SHALL BE USED AT ALL COMPRESSION FITTINGS. INSERT STIFFENERS SHALL BE FROM THE SAME MANUFACTURER AS THE COMPRESSION FITTING USED.
- 13. FOR RECLAIMED WATER SERVICES AND METERS, ALL RECLAIMED TUBING SHALL BE MANUFACTURED SOLID PURPLE, SPL WW-65A. ALL APPURTENANCES SHALL BE MANUFACTURED PURPLE IF AVAILABLE. ALL FITTINGS THAT ARE NOT AVAILABLE FROM THE MANUFACTURER IN PURPLE SHALL BE PAINTED PURPLE PER SPL WW-3C. ALL METER BOX LIDS SHALL BE PURPLE AND HAVE "RECLAIMED WATER" CAST INTO THEM, SPL WW-145A.

CITY OF AUSTIN AUSTIN WATER		WATER SERVICE & METER INSTALLATION - 1" & SMALLER METERS	
<div><div>DRAFT</div><div>03/05/2019</div></div>		THE ARCHITECT/ENGINEER ASSUMES RESPONSIBILITY FOR APPROPRIATE USE OF THIS STANDARD.	STANDARD NO. <b>520-AW-01B</b> 2 OF 2

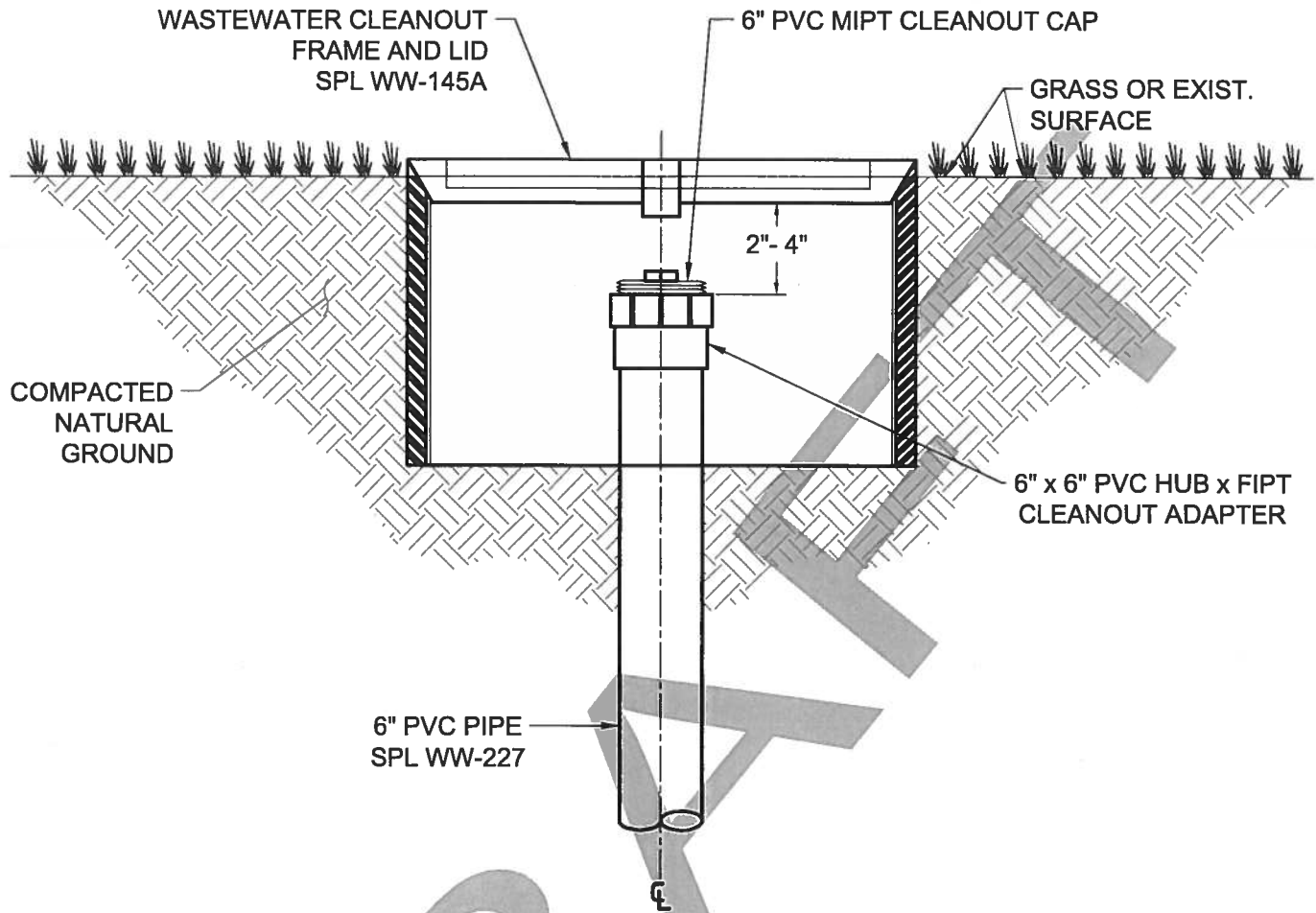

**NOTE:**

1. WASTEWATER CLEANOUT FRAME AND LID SHALL NOT BE PLACED IN PAVED AREAS, INCLUDING SIDEWALKS, DRIVEWAYS, OR PARKING LOTS, AND MUST BE LOCATED A MINIMUM OF 6" FROM ALL PAVED AREAS.

CITY OF AUSTIN AUSTIN WATER	WASTEWATER CLEANOUT FRAME AND LID	
<div style="display: flex; justify-content: space-between;"> <span>DRAFT</span> <span>03/04/2019</span> </div>	THE ARCHITECT/ENGINEER ASSUMES RESPONSIBILITY FOR APPROPRIATE USE OF THIS STANDARD.	STANDARD NO. <b>520-AW-03</b> 1 OF 1