

ZONING CHANGE REVIEW SHEET

CASE: C14-2019-0104 (Citadel at Tech Ridge) DISTRICT: 7

ADDRESS: 1127 Pearl Retreat Lane

ZONING FROM: DR

TO: MF-2

SITE AREA: 0.1355 acres (5,901 sq. ft.)

PROPERTY OWNER: Austin Citadel, LLC (David Howat)

AGENT: Alice Glasco Consulting (Alice Glasco)

CASE MANAGER: Sherri Sirwaitis (512-974-3057, sherri.sirwaitis@austintexas.gov)

STAFF RECOMMENDATION:

The staff's recommendation is to grant MF-2, Multifamily Residence-Low Density District, zoning.

ZONING AND PLATTING COMMISSION ACTION / RECOMMENDATION:
September 3, 2019

CITY COUNCIL ACTION:
October 3, 2019

ORDINANCE NUMBER:

ISSUES: N/A

CASE MANAGER COMMENTS:

The property under consideration is an undeveloped portion of land located on East Parmer Lane north of the intersection with Dessau Road. The tracts of land to the south and southwest are zoned MF-2. To the north, there is undeveloped land that is part of the Oertli PUD, a planned mixed-use development that is comprised of multifamily, office, retail and restaurant uses.

The applicant is requesting to rezone this 0.135 acre parcel to correct an error that left out this acreage in the original rezoning case, C14-2014-0179, for the 1.467 acre tract to the south. These properties have combined and are under development in conjunction with approximately 13 acres of designated multifamily area in the PUD to the north (Please see Applicant's Request Letter – Exhibit C).

The applicant agrees with the staff's recommendation.

BASIS OF RECOMMENDATION:

1. *The proposed zoning should be consistent with the purpose statement of the district sought.*

Multifamily Residence (Low Density) district is intended to accommodate multifamily use with a maximum density of up to 23 units per acre, depending on unit size. This district is appropriate for multifamily residential areas located near single-family neighborhoods, and in selected areas where low density multifamily use is desirable.

2. *The proposed zoning should promote consistency and orderly planning.*

The proposed MF-2 zoning is consistent with land use patterns in this area. There is MF-2 zoning to the south and southeast and PUD zoning that permits multifamily, office and commercial uses to the north.

3. *The proposed zoning should allow for a reasonable use of the property.*

The current DR zoning will not allow for the redevelopment of the property. The rezoning of this small 0.135 acre parcel will permit the applicant to combine this property with the tracts of land to the north and south to develop new housing options.

EXISTING ZONING AND LAND USES:

| | ZONING | LAND USES |
|--------------|----------------|---------------------------------------|
| <i>Site</i> | DR | Undeveloped |
| <i>North</i> | PUD | Undeveloped, Multifamily (Bexley) |
| <i>South</i> | MF-2 | Undeveloped |
| <i>East</i> | MF-2 | Undeveloped |
| <i>West</i> | DR, SF-2, SF-4 | Undeveloped, Single-Family Residences |

NEIGHBORHOOD PLANNING AREA: N/ATIA: Not RequiredWATERSHED: Walnut Creek WatershedNEIGHBORHOOD ORGANIZATIONS:

Austin Neighborhoods Council
 Bike Austin
 Copperfield Neighborhood Organization
 Friends of Austin Neighborhoods
 Harris Ridge Phase IV
 Homeless Neighborhood Association
 Neighborhood Empowerment Foundation
 North Growth Corridor Alliance
 Pflugerville Independent School District
 SELTEXAS
 Sierra Club, Austin Regional Group
 Techridge Neighbors
 Yager Planner Area

SCHOOLS: Pflugerville I.S.D.

Copperfield Elementary School
 Provan Opportunity Center
 Connally High School

CASE HISTORIES:

| NUMBER | REQUEST | COMMISSION | CITY COUNCIL |
|--|------------|---|---|
| C14-2014-0179 (Copperfield IV: 1312 ½ E. Parmer Lane) | DR to MF-2 | 12/16/14: To grant MF-2 zoning by consent (6-0); P. Seeger-1 st , S. Compton-2 nd . | 2/12/15: Approved MF-2 zoning on all 3 readings |

| | | | |
|--|------------------------------------|---|---|
| C14-2017-0225 (Parmer Place: 1600-1622 E. Parmer Lane | DR, SF-2-CO to MF-2 and GR | 4/01/08: Approved staff's recommendation of MF-2 & GR district zoning with conditions by consent (6-0, T. Rabago, J. Martinez-absent); K. Jackson-1 st , J. Shieh-2 nd . | 8/08/08: Approved MF-2 zoning for Tract 1 and GR zoning for Tract 2, with conditions (read into the record that the traffic impact analysis recommendation by staff for the signalization improvements at Dessau Lane should not be 100%, but only 68.8 %) (7-0); 1 st reading 6/05/08: Approved MF-2 zoning for Tract 1 and GR zoning for Tract 2 by consent (6-0, J. Kim- off the dais); 2 nd /3 rd readings |
| C814-2008-0146 (Oertli PUD: 12422 Dessau Road) | DR, SF-2 to PUD | 1/20/09: Approved staff rec. for PUD zoning by consent (4-0) | 2/26/09: Approved PUD zoning with conditions (6-0); 1 st reading 4/02/09: Approved PUD zoning with conditions (7-0); 2 nd /3 rd readings |
| C14-05-0124 | I-RR to GR | 1/09/07: Approved GR-CO zoning, with following conditions: 1) a 4,137 vehicle trip per day limit and 2) the developer will pay for limited purpose median openings which will be limited to south bound on Dessau Road (6-0, B. Baker, J. Martinez, S. Hale-absent); J. Pinnelli-1 st , C. Hammond-2 nd . | 11/08/07: Approved GR-CO zoning on 1 st reading by consent, with direction to review TIA as it is submitted now with the median break suggestion that Public Works has reviewed (7-0); B. Dunkerley-1 st , S. Cole- 2 nd . |
| C14-05-0065.SH | I-RR to MF-2 | 7/05/05: Approved staff's recommendation for MF-2-CO district zoning with the conditional overlay limiting the site to 2,000 vehicle trips per day, requiring the dedication of 70 feet of right-of- way from the existing/future centerline of Dessau Road in accordance with the Transportation Plan, and limiting development on the site to a maximum of 248 residential units (7-1, B. Baker- Nay, M. Whaley-Absent) | 8/18/05: Approved ZAP recommendation of MF-2-CO (7-0); 1 st reading 8/25/05: Approved MF-2-CO with conditions by consent (7-0); 2 nd /3 rd readings |
| C14-04-0056 | I-RR to SF-2, SF-6, MF-3, CS | 11/02/04: Approved staff's recommendation of SF-2-CO, SF-6, MF-3, LR, LR-MU, GR, GR-MU zoning by consent (9-0) | 12/16/04: Granted SF-2-CO, SF-6, MF-3, LR-MU, GR and GR-MU (7-0); all 3 readings |
| C14-04-0127 | GR-CO to GR | 10/19/04: Approved staff's recommendation of GR-CO zoning by consent (9-0). The CO prohibits Adult Oriented Business uses. In | 11/18/04: Granted GR-CO (7-0); all 3 readings |

| | | | |
|-------------|----------|--|--|
| | | addition, the public RC encompasses the TIA recommendations. | |
| C14-03-0001 | DR to LO | 1/28/03: Approved staff's recommendation of LO-CO zoning, w/2,000 trip limit (8-0, J. Donisi-absent) | 2/27/03: Granted LO-CO on all 3 (6-0, Goodman-out of room) |

RELATED CASES: C14-2014-0179 (Previous Zoning Case)
SP-2017-0241C (Site Plan Case)

OTHER STAFF COMMENTS:

Comprehensive Planning

This zoning case is located on the east side of East Parmer Lane, on a 0.135 acre parcel, which is part of a larger site comprising 14.874 acres. The larger site contains a multi-building apartment complex, while the smaller parcel is used as green space. The property is not located within the boundaries of an area with an adopted neighborhood plan. Surrounding land uses include a multi-building apartment complex, Oertli Park and single family subdivisions to the north; to the south is a multi-building apartment complex, several restaurants and retail uses; to the east is a single family subdivision; and to the west are several single family subdivisions. The larger parcel was rezoned in late 2014 for a multi-family apartment complex, but the subject property was accidentally left out of the field notes of the property. The proposal is to rezone the smaller property, which is used as open space for the apartment complex, for zoning consistency.

Connectivity

The Walkscore for this site is **22/10, Car Dependent**, meaning almost errands require a car. Bike lanes are located along Pearl Retreat Drive, but not along this section of Parmer Lane. Parmer Lane has public sidewalks located on both sides of the street, while Pearl Retreat Drive has public sidewalks located on just one side of the street. The mobility and connectivity options in the area are fair.

Imagine Austin

The Imagine Austin Growth Concept Map, found in the Imagine Austin Comprehensive Plan (IACP), identifies this portion of E. Parmer Lane as being located along an **Activity Corridor**. **Activity Corridors** are intended to allow people to reside, work, and access services without traveling far distances. Based on the predominance of residential uses in the area, including numerous multifamily properties and the property being located along an Activity Corridor, the proposal appears to support the Imagine Austin Comprehensive Plan.

Environmental

The site is not located over the Edwards Aquifer Recharge Zone. The site is in the Walnut Creek Watershed of the Colorado River Basin, which is classified as a Suburban Watershed

by Chapter 25-8 of the City's Land Development Code. The site is in the Desired Development Zone.

Under current watershed regulations, development or redevelopment on this site will be subject to the following impervious cover limits:

| <i>Development Classification</i> | <i>% of Gross Site Area</i> | <i>% of Gross Site Area with Transfers</i> |
|--|-----------------------------|--|
| Single-Family (minimum lot size 5750 sq. ft.) | 50% | 60% |
| Other Single-Family or Duplex | 55% | 60% |
| Multifamily | 60% | 70% |
| Commercial | 80% | 90% |

According to floodplain maps there is no floodplain within or adjacent to the project location.

Standard landscaping and tree protection will be required in accordance with LDC 25-2 and 25-8 for all development and/or redevelopment.

At this time, site specific information is unavailable regarding vegetation, areas of steep slope, or other environmental features such as bluffs, springs, canyon rimrock, caves, sinkholes, and wetlands.

Under current watershed regulations, development or redevelopment requires water quality control with increased capture volume and control of the 2-year storm on site.

At this time, no information has been provided as to whether this property has any ls that preempt current water quality or Code requirements.

Transportation

Additional right-of-way maybe required at the time of subdivision and/or site plan. A traffic impact analysis was not required for this case because the traffic generated by the proposed zoning does not exceed the threshold of 2,000 vehicle trips per day. [LDC 25-6-113]. The adjacent street characteristics table is provided below:

| Name | ROW | Pavement | Classification | Sidewalks | Bicycle Route | Capital Metro (within ¼ mile) |
|-------------|------------|-----------------|-----------------------|------------------|----------------------|--------------------------------------|
| Parmer lane | 200' | 4 lanes divided | ASMP Level 4 | Yes | Yes | No |

Austin Water Utility

FYI: The landowner intends to serve the site with City of Austin water and wastewater utilities. The landowner, at own expense, will be responsible for providing any water and wastewater utility improvements, offsite main extensions, water or wastewater easements, utility relocations and or abandonments required by the proposed land use. Depending on the development plans submitted, water and or wastewater service extension requests may be required. Water and wastewater utility plans must be reviewed and approved by Austin Water for compliance with City criteria and suitability for operation and maintenance. All water and wastewater construction must be inspected by the City of Austin. The landowner must pay the City inspection fee with the utility construction. The landowner must pay the tap and impact fees once the landowner makes an application for Austin Water utility tap permits.

INDEX OF EXHIBITS TO FOLLOW

- A: Zoning Map
- B. Aerial Map
- C. Applicant's Request Letter

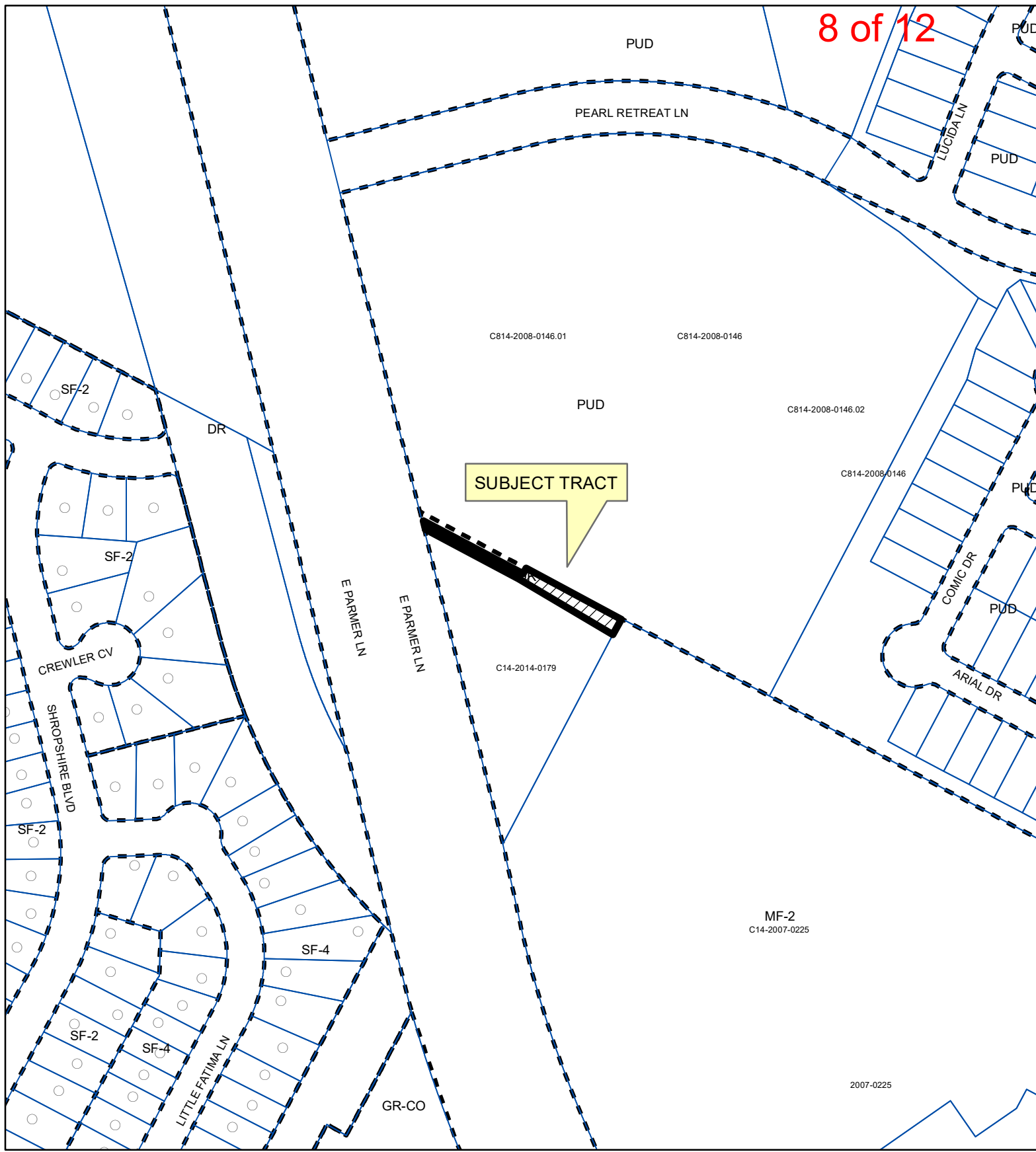

ZONING

ZONING CASE#: C14-2019-0104



- SUBJECT TRACT
- PENDING CASE
- ZONING BOUNDARY

1" = 200'

This product is for informational purposes and may not have been prepared for or be suitable for legal, engineering, or surveying purposes. It does not represent an on-the-ground survey and represents only the approximate relative location of property boundaries.





This product has been produced by CTM for the sole purpose of geographic reference. No warranty is made by the City of Austin regarding specific accuracy or completeness.



Created: 8/5/2019



1" = 400'

-  SUBJECT TRACT
-  ZONING BOUNDARY
-  PENDING CASE
-  CREEK BUFFER

CITADEL AT TECHRIDGE

ZONING CASE#: C14-2019-0104
 LOCATION: 1127 PEARL RETREAT LANE
 SUBJECT AREA: .1355 ACRES
 GRID: N33
 MANAGER: Sherri Sirwaitis



This map has been produced by the Communications Technology Management Dept. on behalf of the Planning Development Review Dept. for the sole purpose of geographic reference. No warranty is made.

ALICE GLASCO CONSULTING

alice@agconsultingcompany.com* Tel. 512-231-8110

July 24, 2019

Mr. Greg Guernsey, Director
Planning and Zoning Department
505 Barton Spring Road, Suite 500
Austin, Texas 78704

RE: 1127 Pearl Retreat Lane Rezoning

Dear Greg:

I represent Austin Citadel, LLC, the owner of 1127 Pearl Retreat Lane in a request to re-zone a 0.1355 - acre tract (5,901 sq. ft.) from DR Development Reserve, to MF-2, Multifamily Residence Low Density District.

The subject tract is part of a larger site (comprising 14.8741 acres) – zoned PUD and MF-2 - with an approved site plan (SP-2017-0241C) for 308 apartments. In 2014, the previous property owner assumed that the subject tract was zoned MF-2 as part of zoning case number C14-2014-0179 (ordinance # 20150212-080). However, when the current owner (Austin Citadel, LLC) requested a zoning verification letter from the City of Austin in 2018, they found out that a portion of the site is still zoned DR, Development Reserve(see attached zoning map). After researching the zoning history of the property, it became apparent that the subject tract was inadvertently omitted from the field notes that were submitted for case number C14-2014-0179.

The approved multifamily project is currently under construction. The attached, approved site plan, shows the subject DR-zoned tract - it is highlighted in yellow within the clouded area, which is open space. The purpose of our rezoning request from DR to MF-2 is because the property owner's financial lender has requested that the entire property have appropriate zoning - one that allows multifamily development – and DR does not.

Please let me know if you have any questions or need additional information.

Sincerely,



Alice Glasco, President
Alice Glasco Consulting

Cc: David Howat, VP of Development – Austin Citadel, LLC
Sherri Sirwaitis, Zoning Planner – City of Austin, Texas

Property Profile



Legend

- Jurisdiction**
- FULL PURPOSE
 - LIMITED PURPOSE
 - EXTRATERRITORIAL JURISDICTION
 - 2 MILE ETJ AGRICULTURAL AGR
 - OTHER CITY LIMITS
 - OTHER CITIES ETJ
- Zoning**
- Single Family (SF)
 - Multi-family (MF)
 - LA, RR
 - Mobile Home (MH)
 - Commercial (CH, CS, GR, LR, L)
 - Office (GO, LO, NO)
 - Industrial (IP, LI, MI, PDA, RD, WL)
 - CBD, DMU
 - TND, TOD, NBG, ERC
 - PUD
 - AG, DR
 - AV, P, UNZ
 - County/Missing Value

Notes



This product is for informational purposes and may not have been prepared for or be suitable for legal, engineering, or surveying purposes. It does not represent an on-the-ground survey. This product has been produced by the City of Austin for the sole purpose of geographic reference. No warranty is made by the City of Austin regarding specific accuracy or completeness.

**Know what's below.
Call before you dig.**

[illegible]

NOTICE

THE UNDERTAKERS ASSUME NO RESPONSIBILITY FOR THE CONSTRUCTION OF ANY STRUCTURE OR WORKMANSHIP. THE CONTRACTOR SHALL BE RESPONSIBLE FOR OBTAINING ALL NECESSARY PERMITS AND FOR OBTAINING ALL REQUIRED INSURANCE. THE CONTRACTOR SHALL BE RESPONSIBLE FOR OBTAINING ALL REQUIRED PERMITS AND FOR OBTAINING ALL REQUIRED INSURANCE.

FOR LOCATION OF ALL UTILITIES, AT LEAST 72 HOURS PRIOR TO COMMENCEMENT OF CONSTRUCTION.

CALIFORNIA:

SITE PLAN APPROVAL SENT 11 of 13
 173 maps 50 2017-2018 applications sent 10/29/2017
 property re locations in 1117 1117 1117

REPLACEMENT SHEET

THE UNIVERSITY OF CHICAGO

| | | | |
|--|--|--|--|
| | | | |
|--|--|--|--|

1-800-451-1111



0

1998

[illegible]

201 200 199 198 197 196 195 194 193 192 191 190 189 188 187 186 185 184 183 182 181 180 179 178 177 176 175 174 173 172 171 170 169 168 167 166 165 164 163 162 161 160 159 158 157 156 155 154 153 152 151 150 149 148 147 146 145 144 143 142 141 140 139 138 137 136 135 134 133 132 131 130 129 128 127 126 125 124 123 122 121 120 119 118 117 116 115 114 113 112 111 110 109 108 107 106 105 104 103 102 101 100 99 98 97 96 95 94 93 92 91 90 89 88 87 86 85 84 83 82 81 80 79 78 77 76 75 74 73 72 71 70 69 68 67 66 65 64 63 62 61 60 59 58 57 56 55 54 53 52 51 50 49 48 47 46 45 44 43 42 41 40 39 38 37 36 35 34 33 32 31 30 29 28 27 26 25 24 23 22 21 20 19 18 17 16 15 14 13 12 11 10 9 8 7 6 5 4 3 2 1

APPROVED
MAR 1 1968
AUSTIN FIRE DEPARTMENT

| | |
|---|---|
| A | CABLE AND CABLES, TYP. |
| B | PRELIMINARY MATERIAL, TYP. |
| C | RENTALS, TYP. |
| D | TYPE B BROADCAST |
| E | AUTOMATIC ACCESS CABLE, RETRIEVABLE ADDITIONAL, PLANS FOR ADDITIONAL |
| F | FOR RECORDS AND CABLE, THROUGHT PLANS, 1115-17 (TYPICAL OF 3) |
| G | CABLES, 5' BROADCAST |
| H | RECORDS OF CABLES, BROADCAST PLANS FOR CABLE, 1115-17 |
| I | RECORDS, BROADCAST, 1115-17 PLANS, 1115-17 (TYPICAL OF 3) |
| J | RECORDS AND LOCATION |
| K | INSTALL PRICE FOR CABLE, 1115-17 |

| | |
|----|-----------------|
| G1 | GRADE SUBJECT 1 |
| G2 | GRADE SUBJECT 2 |
| G3 | GRADE SUBJECT 3 |
| G4 | GRADE SUBJECT 4 |
| G5 | GRADE SUBJECT 5 |
| G6 | GRADE SUBJECT 6 |

Fig. 6 ESR spectra obtained at different temperatures during irradiation of polyethylene.