

The Randerson-Lundell Building

701 East Sixth Street
Austin, TX 78701

Historic Review Application Document
8/26/2019

The Randerson-Lundell Building Overview:

- Built in 1896. "Groceries, feed and wagon yard owned and operated by merchant Cornelius Randerson
- Constructed out of load bearing limestone masonry and "Austin Common" brick.
- 1898 - Randerson sold the building in to Claus Lundell
- 1910 - Second floor added
- 1918 - Rented out as apartments
- 1922 - Operated as Meat Market
- 1958 - Cage Meat Company
- 1965 - Texas State Building and Construction Trades Council offices

Proposed Alterations:

- Remodel interior for new office tenant
- Roof deck addition
- Replace existing exterior stair, extend to roof deck
- Lower Basement floor level by 2 - 3ft
- Remove loading dock and create courtyard at basement level
- Add windows on East side of building at basement level
- Replace metal doors at rear of building with full lite doors.
- Expand existing opening at loading dock and add a custom steel window

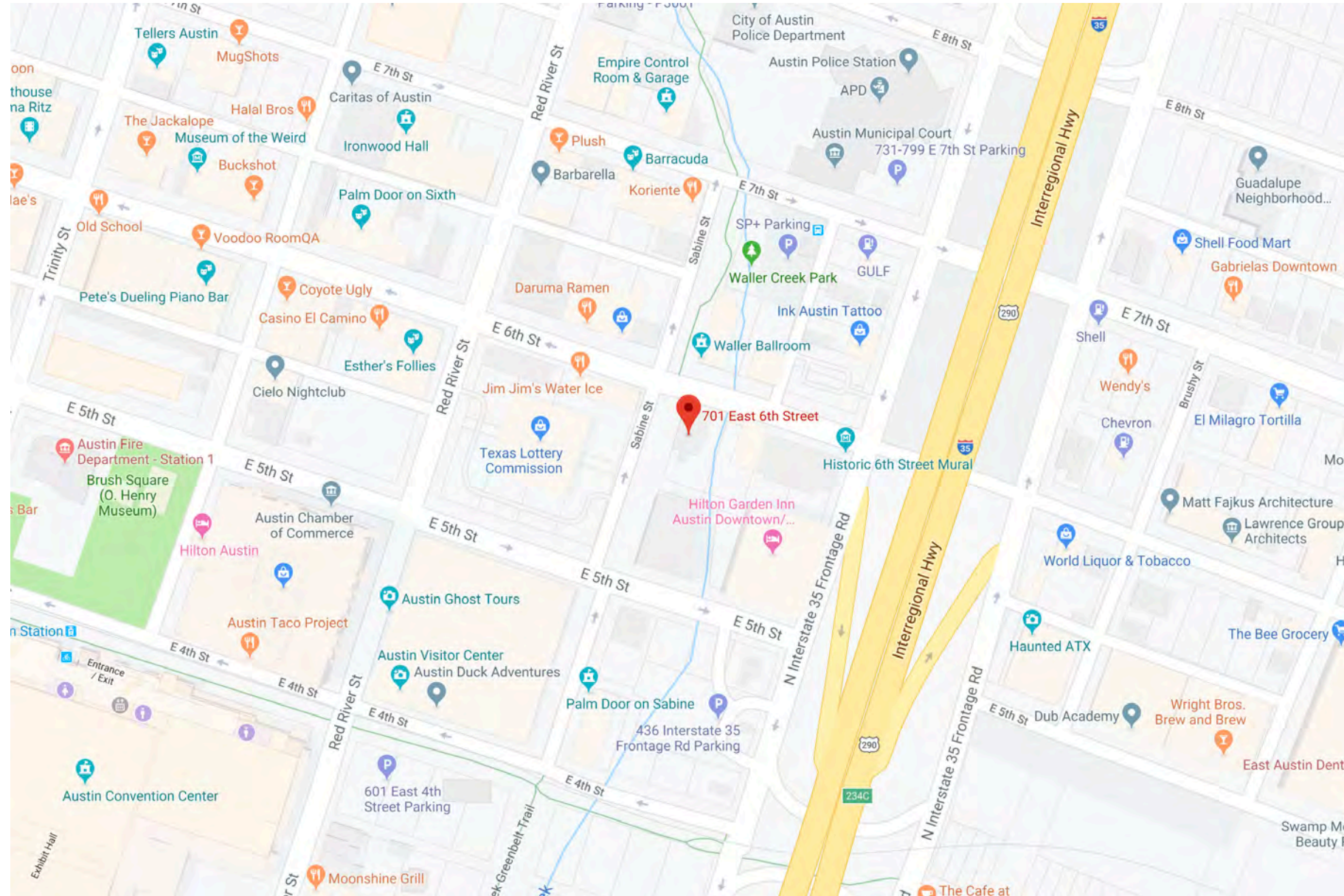





1306 rosewood avenue. austin tx. 78702
t 512.374.0288 e info@chiocodesign.com
www.chiocodesign.com

IMAGE 2
Existing exterior view from E. 6th and Sabine



1306 rosewood avenue. austin tx. 78702
t 512.374.0288 e info@chiocodesign.com
www.chiocodesign.com

IMAGE 3
Proposed exterior view from E. 6th looking SW



1306 rosewood avenue. austin tx. 78702
t 512.374.0288 e info@chiocodesign.com
www.chiocodesign.com

IMAGE 4
Existing exterior view from E. 6th looking SW



IMAGE 5
Proposed exterior view from E. 6th looking North









DETAIL 6a
Detail of existing window on east side of building



DETAIL 7a
Detail of existing doors on the south side of building



DETAIL 7b
Detail of existing door at loading dock



DETAIL 8a
Detail of existing door on west side of building

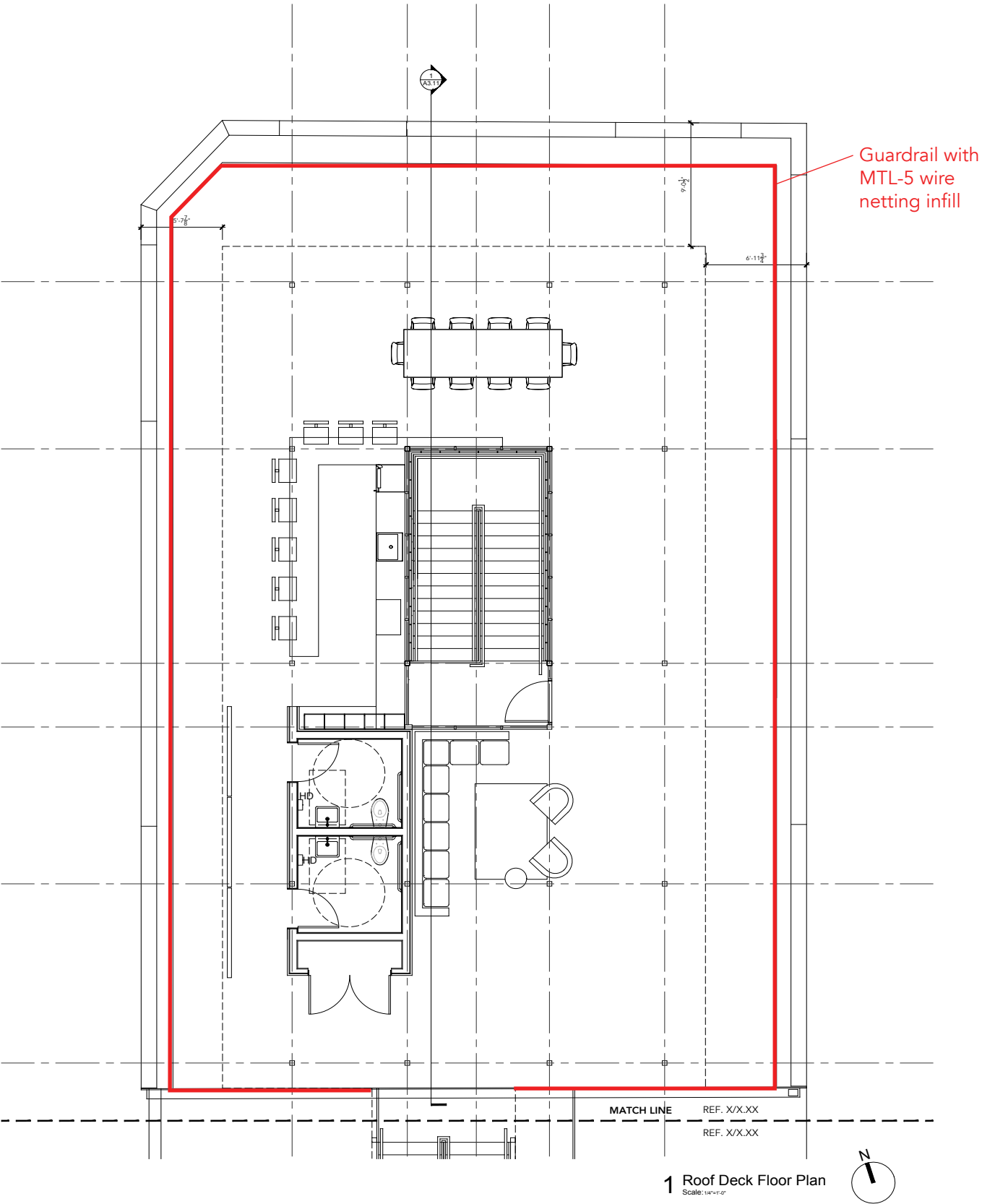

MTL-5 Stainless Steel Wire Netting detail example



MTL-5 Stainless Steel Wire Netting example