

SUBDIVISION REVIEW SHEET

CASE NO.: C8-2018-0166.0A.SH**P.C. DATE:** November 12, 2019**SUBDIVISION NAME:** Govalle Terrace**AREA:** 5.2373 acres**LOT(S):** 2**OWNER/APPLICANT:** Govalle Terrace Partners, LP
(Cesar Chavez Foundation - Paul Park)**AGENT:** Big Red Dog
(Amir Namakforoosh, P.E.)**ADDRESS OF SUBDIVISION:** 5225 Jain Ln.**GRIDS:** L/M-21/22**COUNTY:** Travis**WATERSHED:** Boggy Creek**JURISDICTION:** Full Purpose**EXISTING ZONING:** PUD-NP & SF-3-NP**DISTRICT:** 3**NEIGHBORHOOD PLAN:** Johnston/Govalle Terrace Combined (Govalle Terrace)**PROPOSED LAND USE:** Multi-Family Residential; Parkland**SIDEWALKS:** Sidewalks will be provided along Jain Lane.**DEPARTMENT COMMENTS:** The request is for approval of the final plat (previously unplatted) namely, Govalle Terrace. The proposed plat is composed of 2 lots on 5.2373 acres.**STAFF RECOMMENDATION:** The staff recommends approval of the final plat. This plat meets all applicable City of Austin and State Local Government code requirements.**PLANNING COMMISSION ACTION:****CASE MANAGER:** Sylvia Limon
E-mail: Sylvia.limon@austintexas.gov**PHONE:** 512-974-2767

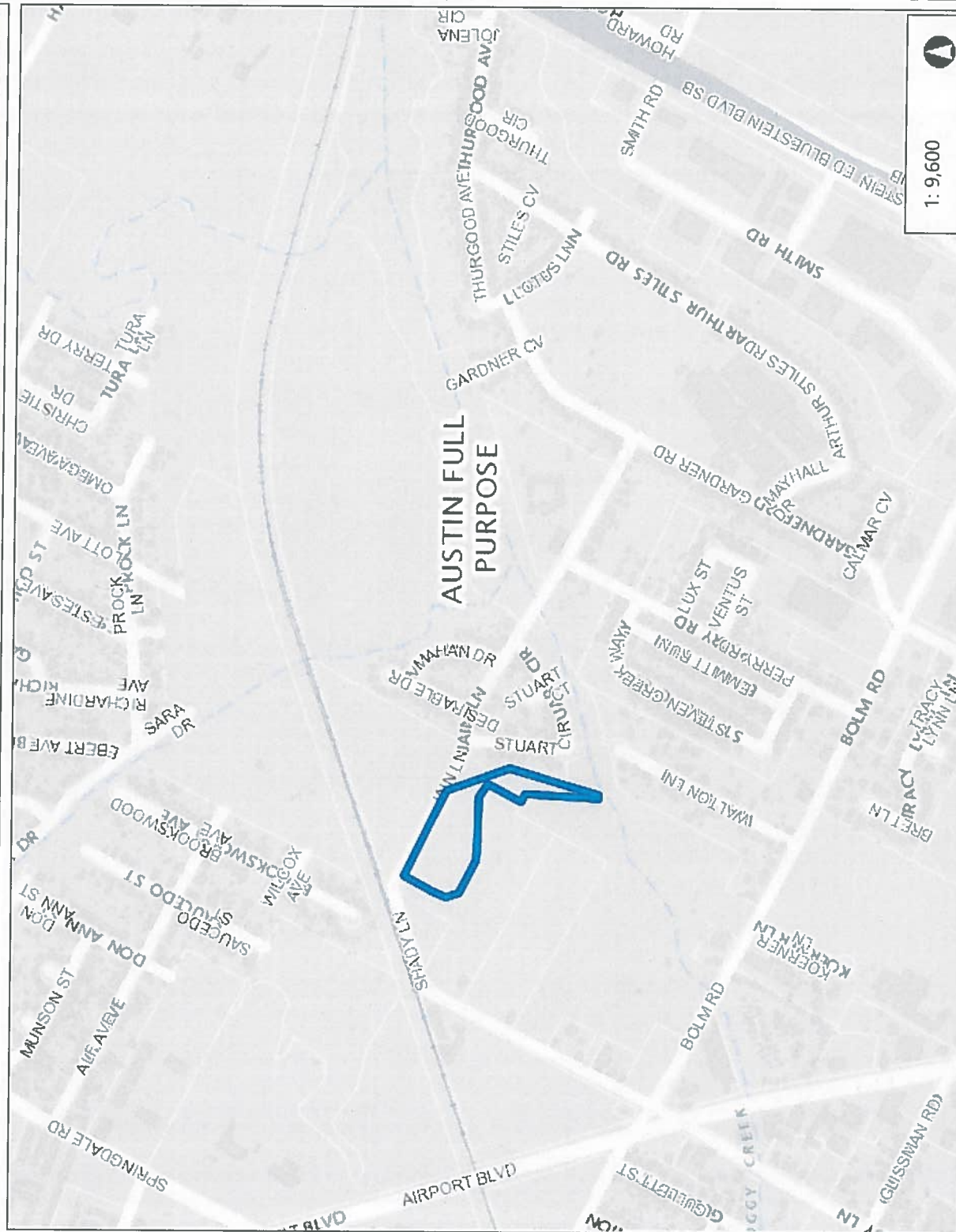

Property Profile



NAD_1983_StatePlane_Texas_Central_FIPS_4203_Feet

Date Printed

Legend

- Street Labels
- Jurisdiction
 - FULL PURPOSE
 - LIMITED PURPOSE
 - EXTRATERRITORIAL JURISDICTION
 - 2 MILE ETJ AGRICULTURAL AGR
 - OTHER CITY LIMITS
 - OTHER CITIES ETJ
- Jurisdiction
 - FULL PURPOSE
 - LIMITED PURPOSE
 - EXTRATERRITORIAL JURISDICTION
 - 2 MILE ETJ AGRICULTURAL AGR
 - OTHER CITY LIMITS
 - OTHER CITIES ETJ

Notes

08-2018-0166, 6A.5H

This product is for informational purposes and may not have been prepared for or be suitable for legal, engineering, or surveying purposes. It does not represent an on-the-ground survey. This product has been produced by the City of Austin for the sole purpose of geographic reference. No warranty is made by the City of Austin regarding specific accuracy or completeness.

