

SUBDIVISION REVIEW SHEET**CASE NO.:** C8-2018-0122.2A**ZAP DATE:** April 21, 2020**SUBDIVISION NAME:** East Village Phase 5**AREA:** 14.33 acres**LOTS:** 91 lots**APPLICANT:** RH Pioneer North LLC (Gordon Reger)**AGENT:** LJA Engineering, (Walter Hoysa)**ADDRESS OF SUBDIVISION:** 3407 E Howard Lane**GRIDS:** MQ32**COUNTY:** Travis**WATERSHED:** Harris Branch**JURISDICTION:** Full Purpose**EXISTING ZONING:** PUD**DISTRICT:** 1**LAND USE:** Residential**SIDEWALKS:** Sidewalks will be constructed along all internal streets and the E Howard Lane frontage.**DEPARTMENT COMMENTS:** This request is for the East Village phase 5 final plat, comprised of 91 lots on 14.33 acres. There will be 90 residential lots and one cemetery lot. The proposed lots comply with the Pioneer Crossing PUD requirements for use, lot width and lot size.**STAFF RECOMMENDATION:** The final plat meets all applicable State and City of Austin Land Development Code requirements and staff recommends approval.**ZONING AND PLATTING COMMISSION ACTION:****CASE MANAGER:** Steve Hopkins**PHONE:** 512-974-3175**E-mail:** steve.hopkins@austintexas.gov

Legal Description:
EASTVILLAGE Single Family
Phase 5 Final Plat Doc. no. _____

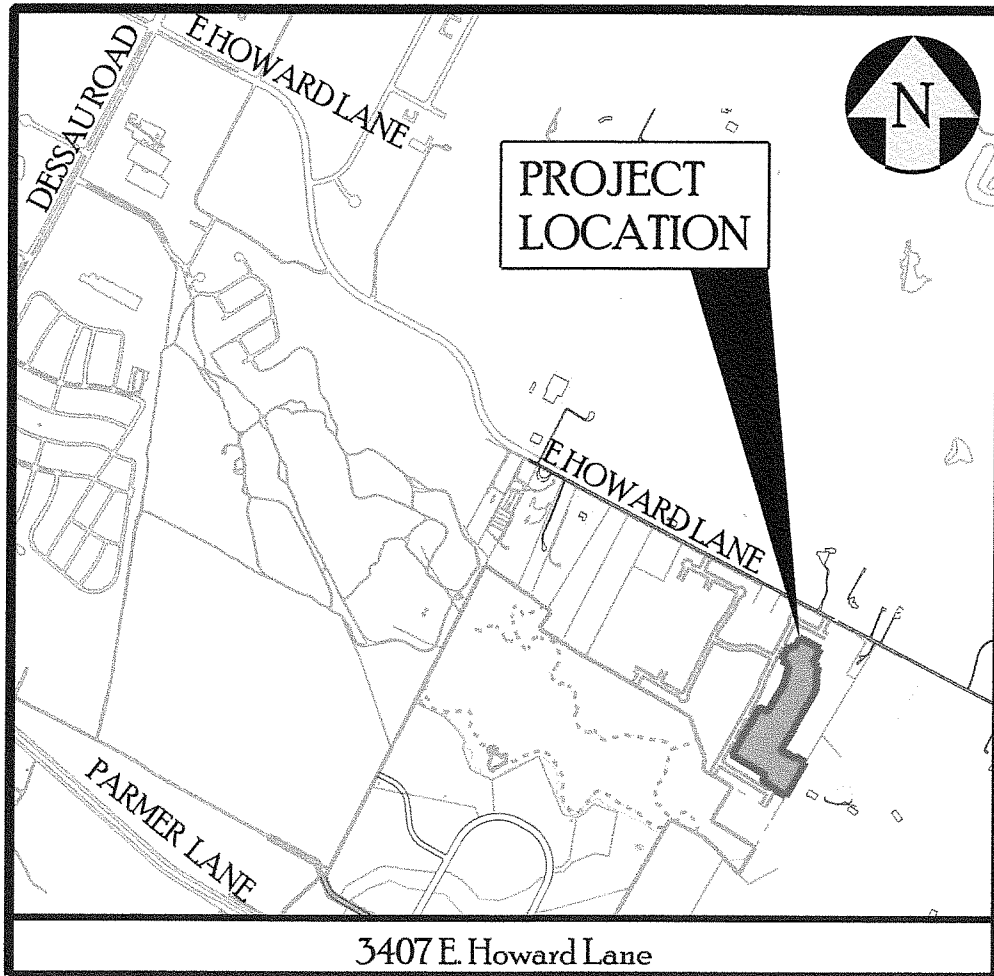

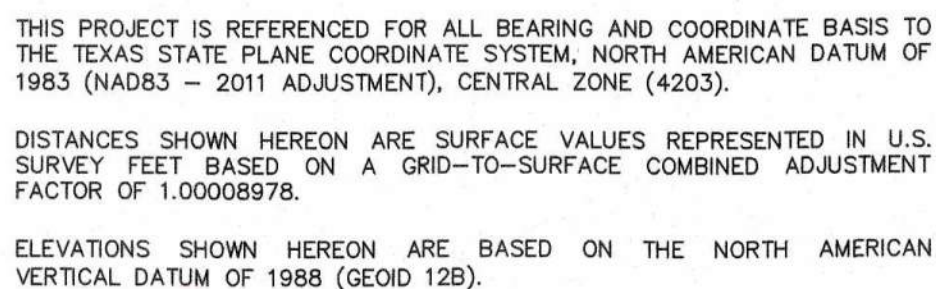

	LEGEND
●	1/2" REBAR FOUND (OR AS NOTED)
◎	1/2" REBAR WITH CAP STAMPED "LANDESIGN" FOUND (OR AS NOTED)
○	1/2" REBAR WITH CAP STAMPED "LANDESIGN" SET
▲	NAIL FOUND (60D, OR AS NOTED)
✱	COTTON SPINDLE FOUND
⊗	FENCE CORNER POST FOUND
△	CALCULATED POINT NOT SET
O.R.T.C.T.	OFFICIAL RECORDS OF TRAVIS COUNTY, TEXAS
O.F.T.C.T.	OFFICIAL PUBLIC RECORDS OF TRAVIS COUNTY, TEXAS
D.R.T.C.T.	DEED RECORDS OF TRAVIS COUNTY, TEXAS
P.R.T.C.T.	PLAT RECORDS OF TRAVIS COUNTY, TEXAS
R.O.W.	RIGHT-OF-WAY
P.U.E.	PUBLIC UTILITY EASEMENT
D.E.	DRAINAGE EASEMENT
WQE	WATER QUALITY EASEMENT
P.A.E.	PUBLIC ACCESS EASEMENT
E.T.E.	ELECTRIC/TELEPHONE EASEMENT
	SIDEWALK

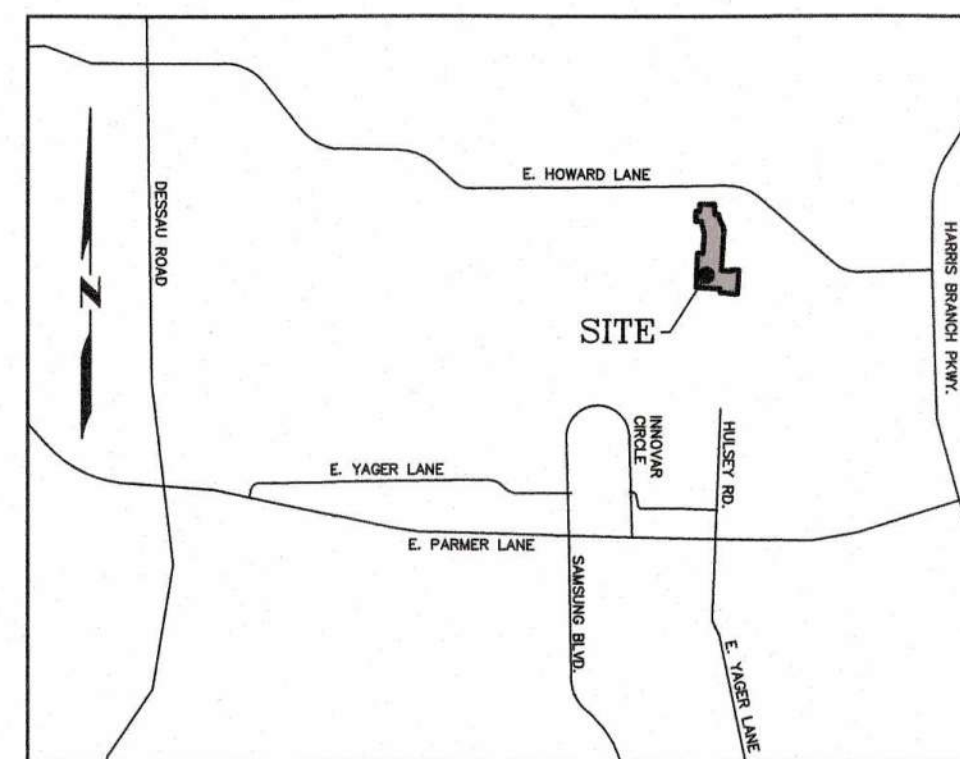
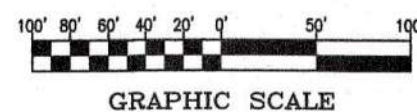
VICINITY MAP
(NOT TO SCALE)

LAND USE SUMMARY: EASTVILLE SINGLE FAMILY PHASE V, FINAL PLAN		
TOTAL ACREAGE:		14.33 ACRES
RESIDENTIAL LOTS		90 LOTS
OTHER LOTS:		1 LOTS
NUMBER OF BLOCKS:		6 BLOCKS
CEMETERY LOT	1 LOTS	(0.30 OF ONE ACRE)
COBALT LANE	(56' R.O.W.)	322 L.F.
PEARL LIGHT ROAD	(56' R.O.W.)	415 L.F.
PELL ROAD	(56' R.O.W.)	553 L.F.
ORCHARD GROVE LANE	(56' R.O.W.)	554 L.F.
OXFORD VINEYARD LANE	(56' R.O.W.)	371 L.F.
SUBMITTAL DATE:		
APPLICATION SUBMITTAL DATE:		2019
PREPARATION DATE:		2019

Line Table			
Line #	Direction		Length
L1	S62° 52' 48"E		7.00'
L2	S27° 05' 33"W		56.00'
L3	S62° 52' 48"E		61.58'
L4	S16° 37' 09"W		79.67'
L5	S03° 17' 15"W		51.65'
L6	S00° 48' 21"E		56.78'
L7	S04° 26' 28"W		49.18'
L8	S22° 56' 05"W		52.17'
L9	N30° 50' 28"E		21.65'
L10	N30° 50' 28"E		11.00'
L11	N30° 50' 28"E		65.00'
L12	N59° 09' 32"W		5.00'
L13	N59° 09' 32"W		3.58'
L14	N27° 07' 12"E		21.22'
L15	N62° 54' 27"W		97.60'
L16	S62° 52' 48"E		65.00'
L17	S62° 52' 48"E		37.34'
L18	N59° 09' 32"W		100.00'
L19	S30° 50' 28"W		120.00'
L20	N27° 07' 12"E		114.98'
L21	N30° 50' 28"E		95.00'
L22	S17° 11' 02"W		20.58'
L23	S59° 09' 32"E		34.61'
L24	S30° 50' 28"W		115.00'
L25	S30° 50' 28"W		115.00'

Curve Table					
Curve #	Radius	Length	Delta	Chord Bearing	Chord
C1	15.00'	25.53'	97°31'51"	N68° 21' 17"E	22.56'
C2	558.00'	172.02'	17°39'46"	N10° 45' 29"E	171.34'
C3	328.00'	165.53'	28°54'52"	N16° 23' 02"E	163.77'
C4	15.00'	23.56'	90°00'00"	N14° 09' 32"W	21.21'
C5	15.00'	23.56'	90°00'00"	S75° 50' 28"W	21.21'
C6	272.00'	137.27'	28°54'52"	S16° 23' 02"W	135.81'
C7	614.00'	200.36'	18°41'50"	S11° 16' 31"W	199.48'
C8	15.00'	21.86'	83°30'13"	S21° 07' 41"E	19.98'
C9	15.00'	23.56'	90°00'00"	S75° 50' 28"W	21.21'
C10	15.00'	23.56'	90°00'00"	S14° 09' 32"E	21.21'
C11	558.00'	63.97'	6°34'07"	S16° 18' 18"W	63.94'
C12	558.00'	49.29'	5°03'39"	S10° 29' 25"W	49.27'
C13	558.00'	49.28'	5°03'36"	S05° 25' 48"W	49.26'
C14	558.00'	9.48'	0°58'23"	S02° 24' 48"W	9.48'
C15	328.00'	33.82'	5°54'30"	N04° 52' 51"E	33.81'
C16	328.00'	37.72'	6°35'22"	N11° 07' 46"E	37.70'
C17	328.00'	37.72'	6°35'22"	N17° 43' 08"E	37.70'
C18	328.00'	42.44'	7°24'51"	N24° 43' 14"E	42.41'
C19	328.00'	13.82'	2°24'48"	N29° 38' 04"E	13.81'
C20	272.00'	48.08'	10°07'40"	N25° 46' 38"E	48.02'
C21	272.00'	73.52'	15°29'10"	N12° 58' 13"E	73.29'
C22	272.00'	15.67'	3°18'02"	N03° 34' 37"E	15.67'
C23	614.00'	37.28'	3°28'44"	S03° 39' 58"W	37.27'
C24	614.00'	41.65'	3°53'12"	S07° 20' 56"W	41.64'
C25	614.00'	41.65'	3°53'12"	S11° 14' 08"W	41.64'
C26	614.00'	41.59'	3°52'52"	S15° 07' 10"W	41.58'
C27	614.00'	38.19'	3°33'50"	S18° 50' 31"W	38.18'

BENCHMARK				
Point #	Northing	Easting	Elevation	Raw Description
62	10115563.20	3153474.00	666.05	CP PK LSI WASH
63	10115657.53	3153502.82	666.19	CP NLS PK
64	10116101.65	3152631.67	647.99	CP NLS PK

PROJECT NAME: PIONEER CROSSING		DATE	REVISIONS
DATE: 07/08/19	SCALE: 1" = 100'	01/22/20	REVISED PER COA COMMENTS
DRAWING FILE PATH: L:\JAV17-030 PIONEER CROSSING\DWG\SEASTVILLAGE PH 5.DWG			
FIELDNOTE FILE PATH:			
			N/A
RPLS: TST	TECH: HAS	PARTYCHIEF: N/A	
CHECKED BY: TST	ENG: BROOK: N/A		

DRAWING NAME:
EASTVILLAGE PH 5

SHEET
01 of 02

C8-2018-0122.2A

DRAWING PATH: I:\A17-030 PIONEER CROSSING\DWGS\EASTVILLAGE PH 5 DWG SHEET PLOT SIZE: ARCH FULL BLEED C (18.00 X 24.00 INCHES) LAST SAVED: 2/24/2020 8:58 AM PLOT DATE: 2/24/2020 9:00 AM

C8-2018-0122.2A