

HISTORIC LANDMARK COMMISSION
PERMITS IN NATIONAL REGISTER HISTORIC DISTRICTS
OCTOBER 26, 2020
HR 2020-145916
1801 MOHLE DRIVE
OLD WEST AUSTIN NATIONAL REGISTER HISTORIC DISTRICT

PROPOSAL

Construct a new house.

PROJECT SPECIFICATIONS

Construct a single-story house. The proposed house has a cross-gabled roof with shallow eaves, painted brick veneer, wood siding, a partial-width porch and carport supported by wood columns, and a metal roof. Its single and paired aluminum-clad wood windows have 2, 4, and 6 lights. Painted wood shutters accent the main elevation's windows, and the front door is flanked by divided sidelights. Rear and side elevations feature a screened porch and tapered brick chimney.

STANDARDS FOR REVIEW

The Secretary of the Interior's Standards for Rehabilitation are used to evaluate new construction projects in National Register historic districts. Applicable standards include:

9. New additions, exterior alterations, or related new construction shall not destroy historic materials that characterize the property. The new work shall be differentiated from the old and shall be compatible with the massing, size, scale, and architectural features to protect the historic integrity of the property and its environment.

The proposed house is differentiated from the historic structures elsewhere on the block by its use of modern window materials and lighting patterns, its metal roof, and its painted brick exterior. Its massing, size, scale, and architectural features are compatible with the historic district's character.

10. New additions and adjacent or related new construction shall be undertaken in such a manner that if removed in the future, the essential form and integrity of the historic property and its environment would be unimpaired.

If the proposed house were removed in the future, the integrity of the district would be unimpaired.

STAFF COMMENTS

Demolition of the existing residence was approved by the Historic Landmark Commission in June, 2020.

STAFF RECOMMENDATION

Comment on the plans.

LOCATION MAP

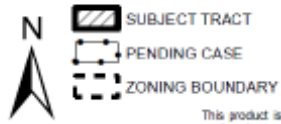

1" = 169'

NOTIFICATIONS

CASE#: HR 20-145916
LOCATION: 1801 MOHLE DRIVE

This product is for informational purposes and may not have been prepared for or be suitable for legal, engineering, or surveying purposes. It does not represent an on-the-ground survey and represents only the approximate relative location of property boundaries.

This product has been produced by CTM for the sole purpose of geographic reference. No warranty is made by the City of Austin regarding specific accuracy or completeness.



Photos

Source: Google Street View, 2019. Mohle Drive looking east and west. Original house with flag at far right in top image; offscreen to left in bottom.