



## MEMORANDUM

\*\*\*\*\*

TO: Nadia Barrera-Ramirez, Chair  
Members of the Zoning and Platting Commission

FROM: Wendy Rhoades  
Housing and Planning Department

DATE: September 15, 2021



RE: **C14-2021-0122 – Rees Tract**

\*\*\*\*\*

The Staff requests a postponement of the above-referenced zoning case to October 5, 2021 in order to continue discussions with the Owner and Agent about development considerations for this uniquely situated tract.

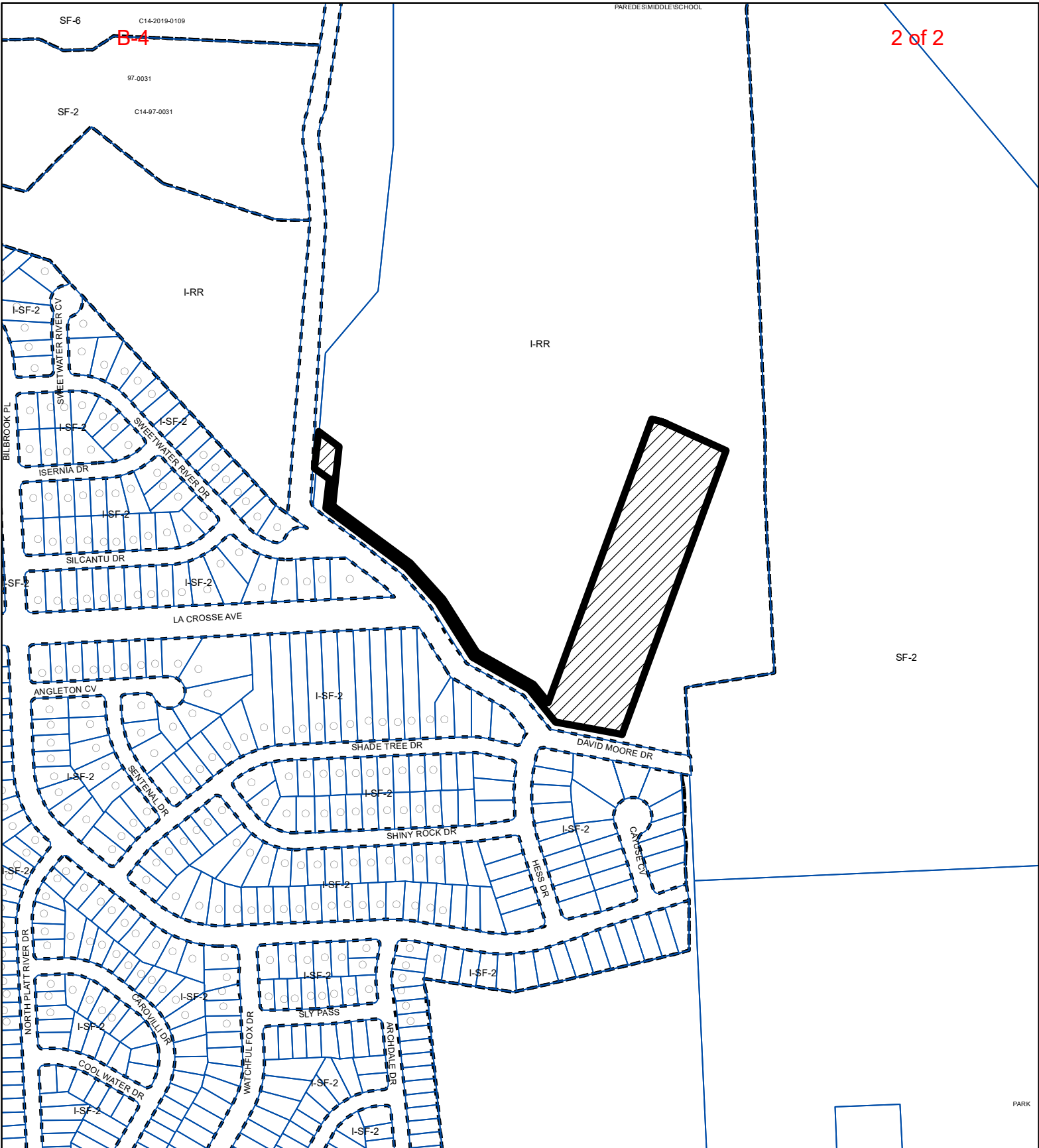
Attachment: Map of Property



-  SUBJECT TRACT
-  PENDING CASE
-  ZONING BOUNDARY

**ZONING**

**Exhibit A**

**ZONING CASE#: C14-2021-0122**

1" = 400'

This product is for informational purposes and may not have been prepared for or be suitable for legal, engineering, or surveying purposes. It does not represent an on-the-ground survey and represents only the approximate relative location of property boundaries.

This product has been produced by the Housing and Planning Department for the sole purpose of geographic reference. No warranty is made by the City of Austin regarding specific accuracy or



**Created: 7/27/2021**