



# City of Austin

## Housing and Planning Department

P.O. Box 1088, Austin, TX 78767 -1088

(512) 974-3100 ♦ Fax (512) 974-3112 ♦ [www.cityofaustin.org/housing](http://www.cityofaustin.org/housing)

### MEMORANDUM

**TO:** Todd W. Shaw, Chair &  
Planning Commission Members

**FROM:** Maureen Meredith, Senior Planner, Inclusive Planning Division  
Heather Chaffin, Senior Planner, Current Planning Division  
Housing and Planning Department

**DATE:** April 19, 2022

**RE:** **NPA-2021-0015.03** \_6603 Regiene Road  
**C14-2021-0158** \_6603 Regiene Road

Staff requests a postponement of the above-referenced cases from the April 26, 2022 Planning Commission hearing to the **May 10, 2022 hearing** date to allow additional time to review the applications.

This postponement request was made in a timely manner and meets the Planning Commission's policy.

Attachments: Plan Amendment Map  
Zoning Map

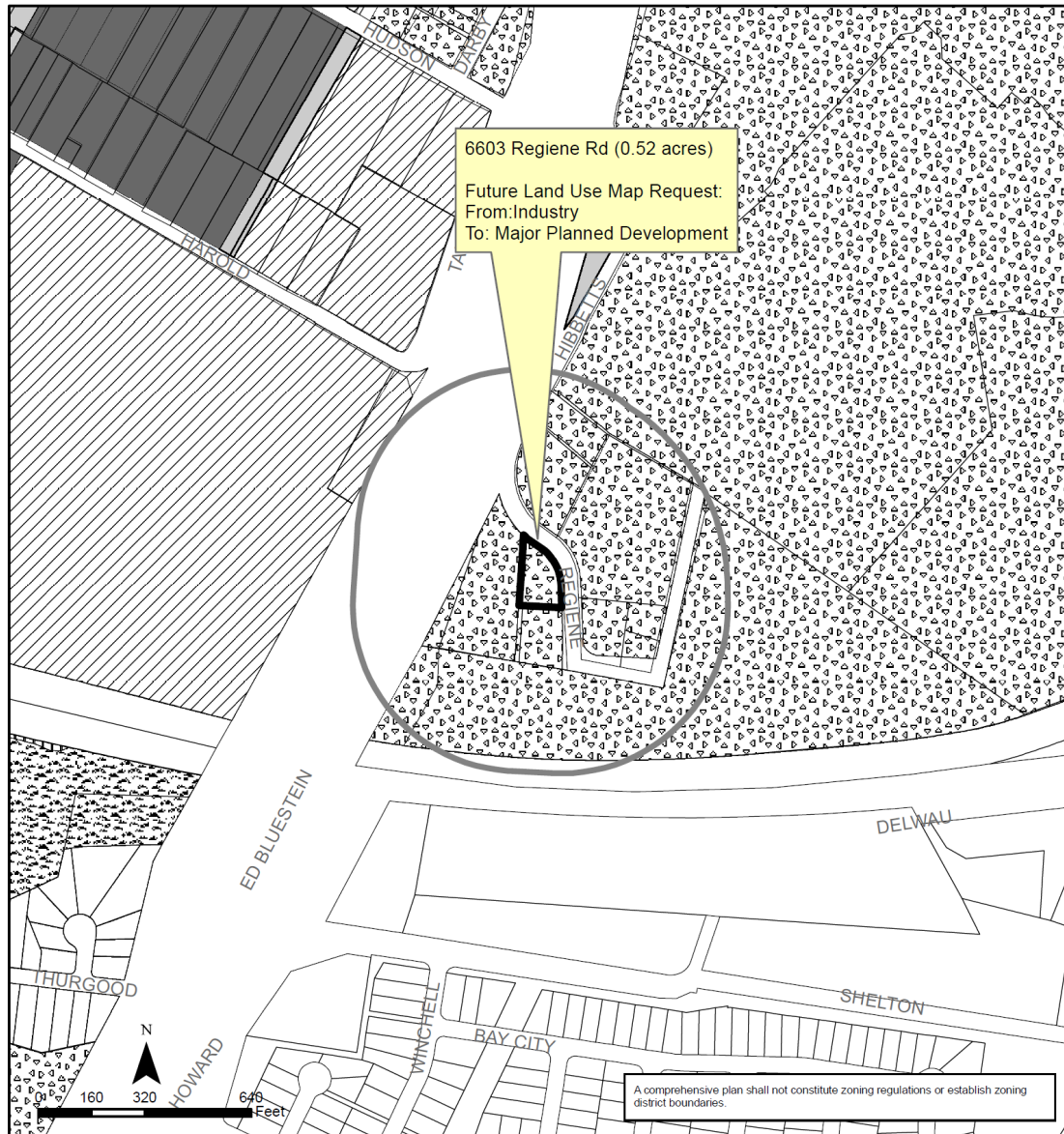

### East MLK Combined (MLK-183) Neighborhood Planning Area NPA-2021-0015.03

This product is for informational purposes and may not have been prepared for or be suitable for legal, engineering, or surveying purposes. It does not represent an on-the-ground survey and represents only the approximate relative location of property boundaries.

This product has been produced by the Housing and Planning Department for the sole purpose of geographic reference. No warranty is made by the City of Austin regarding specific accuracy or completeness.





City of Austin  
Housing and Planning Department  
Created on 12/21/2021, by: MeeksS

#### Future Land Use

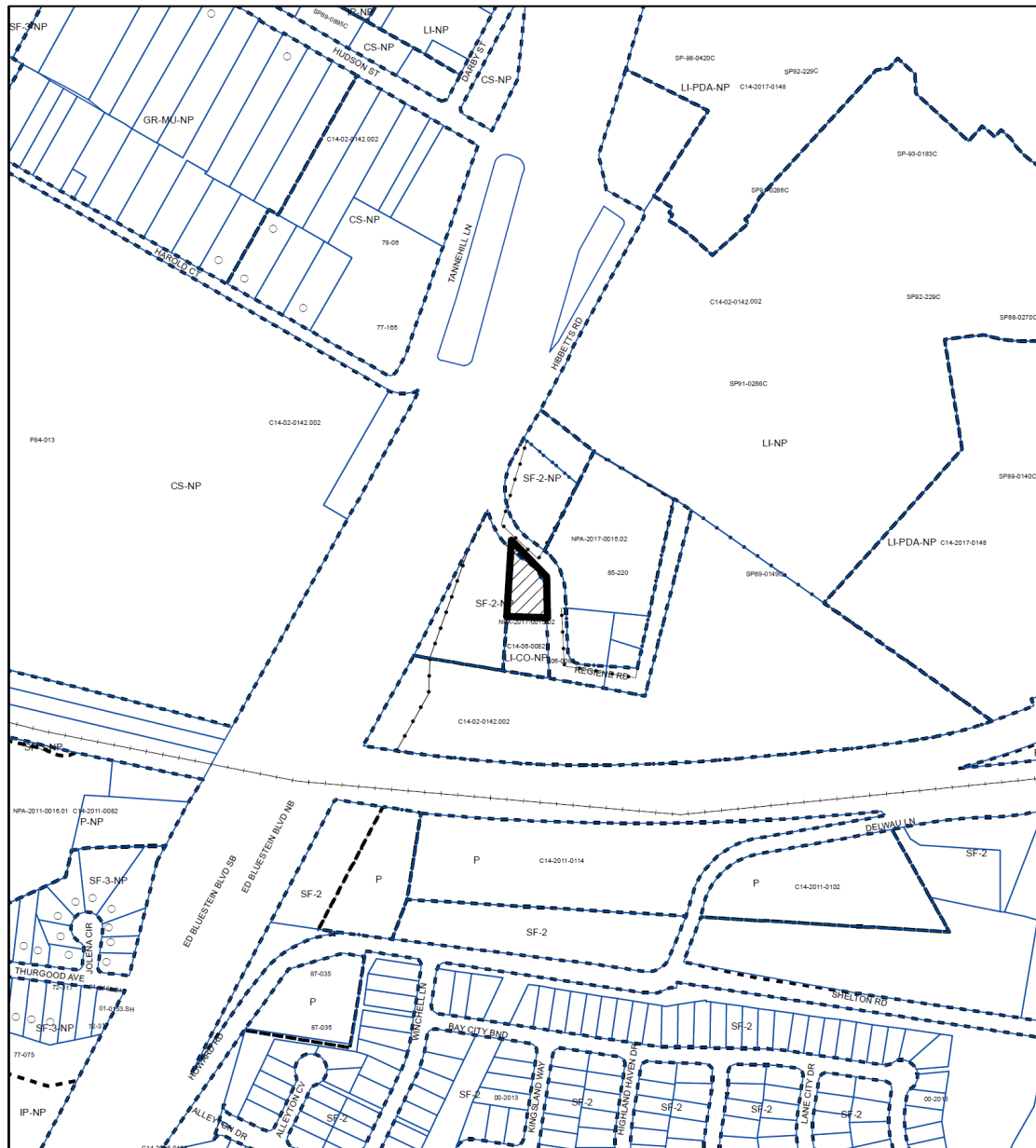
	Subject Tract		Mixed Use
	500 ft. notif. boundary		Recreation & Open Space
	Civic		Single-Family
	Commercial		Transportation
	Industry		

$$1'' = 400'$$

 SUBJECT TRACT  
 PENDING CASE  
 ZONING BOUNDARY

## ZONING

ZONING CASE#: C14-2021-0158

This product is for informational purposes and may not have been prepared for or be suitable for legal, engineering, or surveying purposes. It does not represent an on-the-ground survey and represents only the approximate relative location of property boundaries.

This product has been produced by the Housing and Planning Department for the sole purpose of geographic reference. No warranty is made by the City of Austin regarding specific accuracy or



**Created: 9/22/2021**