



City of Austin

Housing and Planning Department

P.O. Box 1088, Austin, TX 78767 -1088

(512) 974-3100 ♦ Fax (512) 974-3112 ♦ www.cityofaustin.org/housing

MEMORANDUM

TO: Todd W. Shaw, Chair &
Planning Commission Members

FROM: Maureen Meredith, Senior Planner, Inclusive Planning Division
Heather Chaffin, Senior Planner, Current Planning Division
Housing and Planning Department

DATE: May 17, 2022

RE: **NPA-2021-0021.02** _1406-1506 Parker Lane
C14-2021-0139 _1406-1506 Parker Lane

The staff requests a postponement of the above-referenced cases from the May 24, 2022 Planning Commission hearing date to the **July 12, 2022** hearing date to allow additional time for the applicant to work on the property's drainage issue.

This postponement request was made in a timely manner and meets the Planning Commission's policy.

Attachments: Plan Amendment Map
Zoning Map

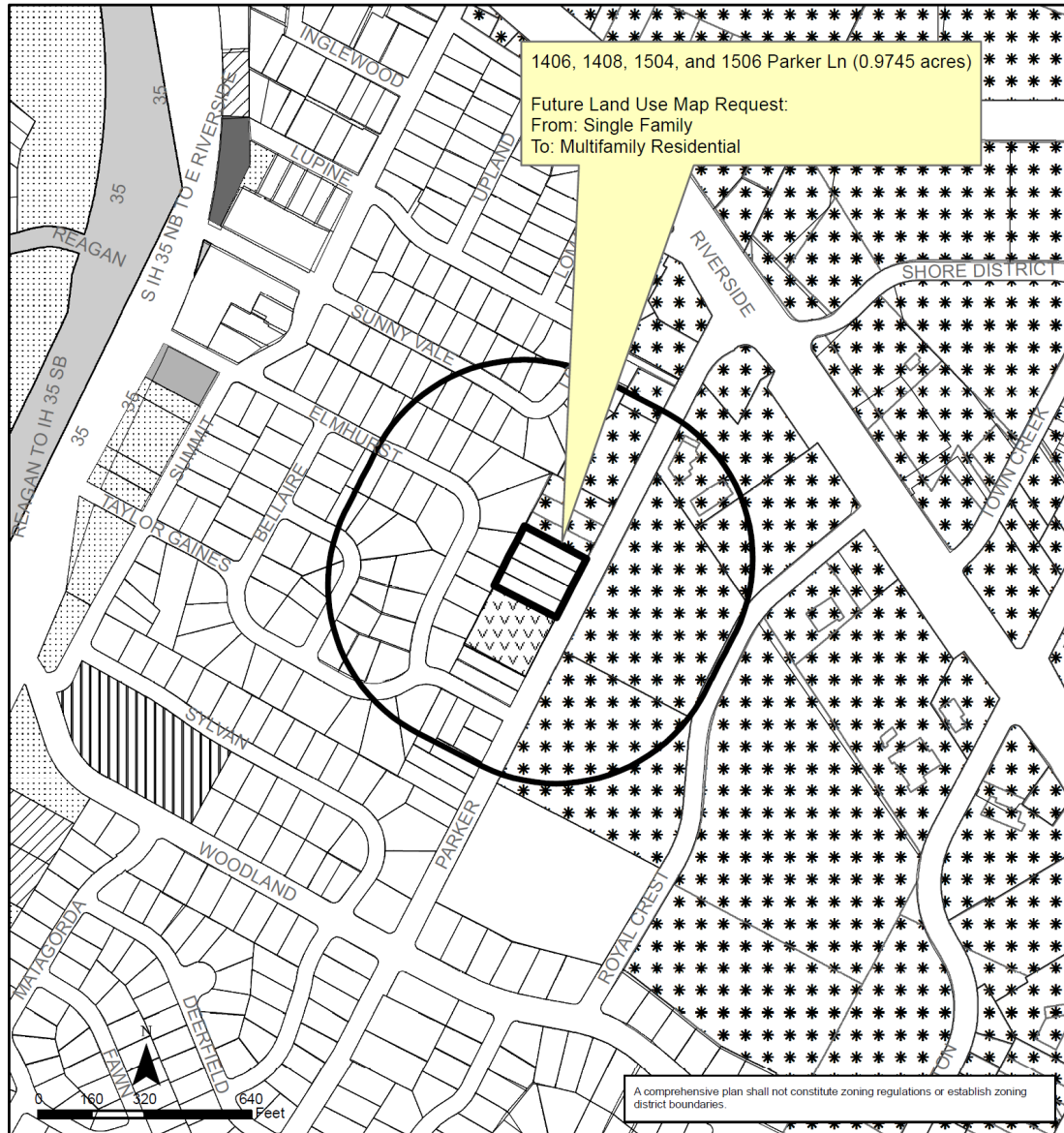

East Riverside/Oltorf Combined (Riverside) Neighborhood Planning Area NPA-2021-0021.02

This product is for informational purposes and may not have been prepared for or be suitable for legal, engineering, or surveying purposes. It does not represent an on-the-ground survey and represents only the approximate relative location of property boundaries.

This product has been produced by the Housing and Planning Department for the sole purpose of geographic reference. No warranty is made by the City of Austin regarding specific accuracy or completeness.





City of Austin
Housing and Planning Department
Created on 8/4/2021, by: MeeksS

Future Land Use

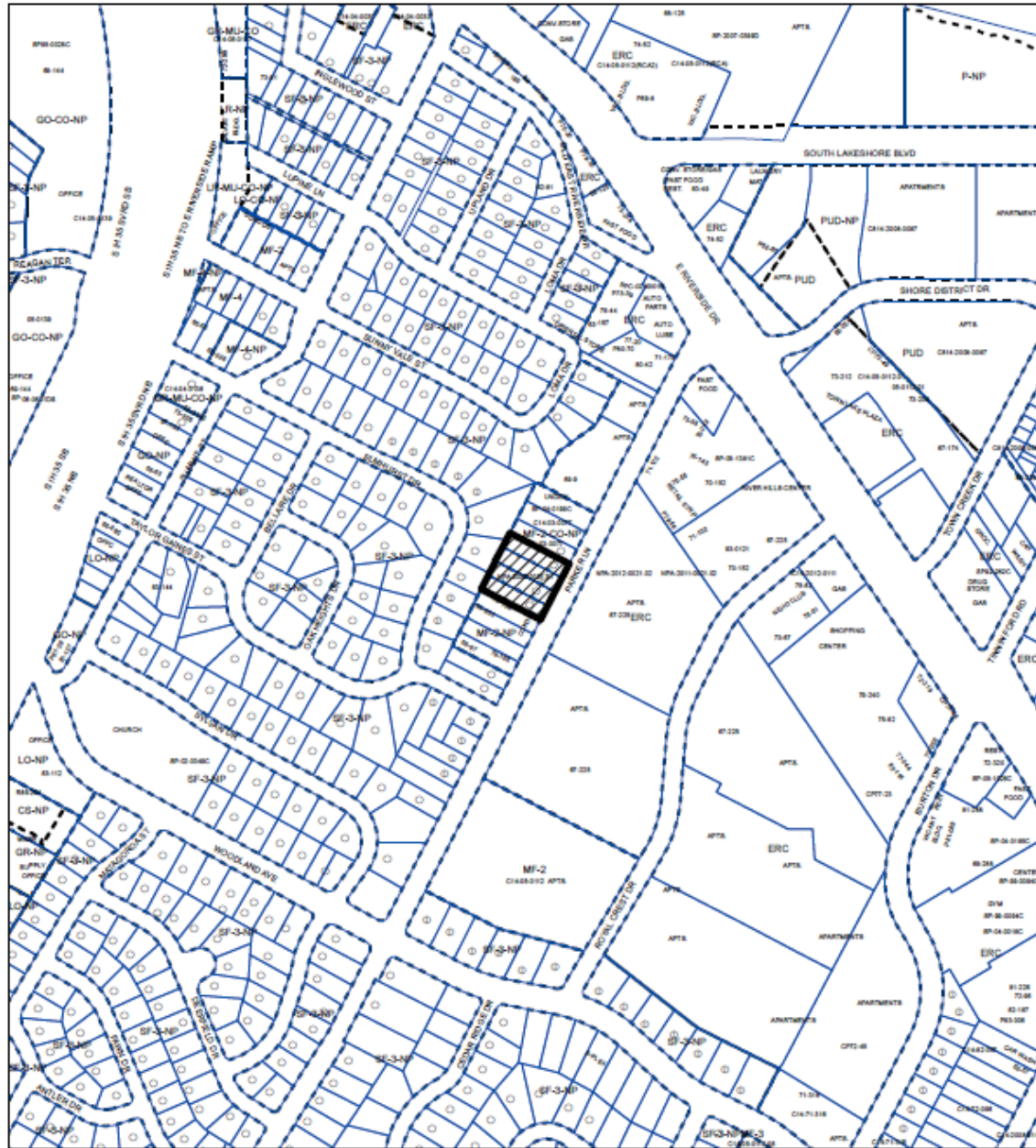
	Subject Tract		Mixed Use
	500 ft. notif. boundary		Mixed Use/Office
	Civic		Office
	Commercial		Single-Family
	Excluded from FLUM		Specific Regulating District
	Higher-Density Single-Family		Transportation



1" = 400'

-  SUBJECT TRACT
-  PENDING CASE
-  ZONING BOUNDARY

ZONING

ZONING CASE#: C14-2021-0139

This product is for informational purposes and may not have been prepared for or be suitable for legal, engineering, or surveying purposes. It does not represent an on-the-ground survey and represents only the approximate relative location of property boundaries.

This product has been produced by the Housing and Planning Department for the sole purpose of geographic reference. No warranty is made by the City of Austin regarding specific accuracy or



Created: 9/7/2021