



**Annexation - Conduct Public Hearing
CITY OF AUSTIN
RECOMMENDATION FOR COUNCIL ACTION**

AGENDA ITEM NO.: 42
AGENDA DATE: Thu 10/07/2004
PAGE: 1 of 1

SUBJECT: Conduct a public hearing for the full purpose annexation of the Parmer / US 290 East ROW Area (approximately 17.6 acres of Parmer Lane ROW in Travis County north of the intersection of Parmer Lane and US Highway 290 East).

AMOUNT & SOURCE OF FUNDING: N/A

FISCAL NOTE: N/A

REQUESTING Transportation, Planning **DIRECTOR'S**
DEPARTMENT: and Sustainability **AUTHORIZATION:** Austan Librach

FOR MORE INFORMATION CONTACT: Ben Luckens, 974-2695; Virginia Collier, 974-2022;
Sylvia Arzola, 974-6448

PRIOR COUNCIL ACTION: Public hearing set on 9/2/04



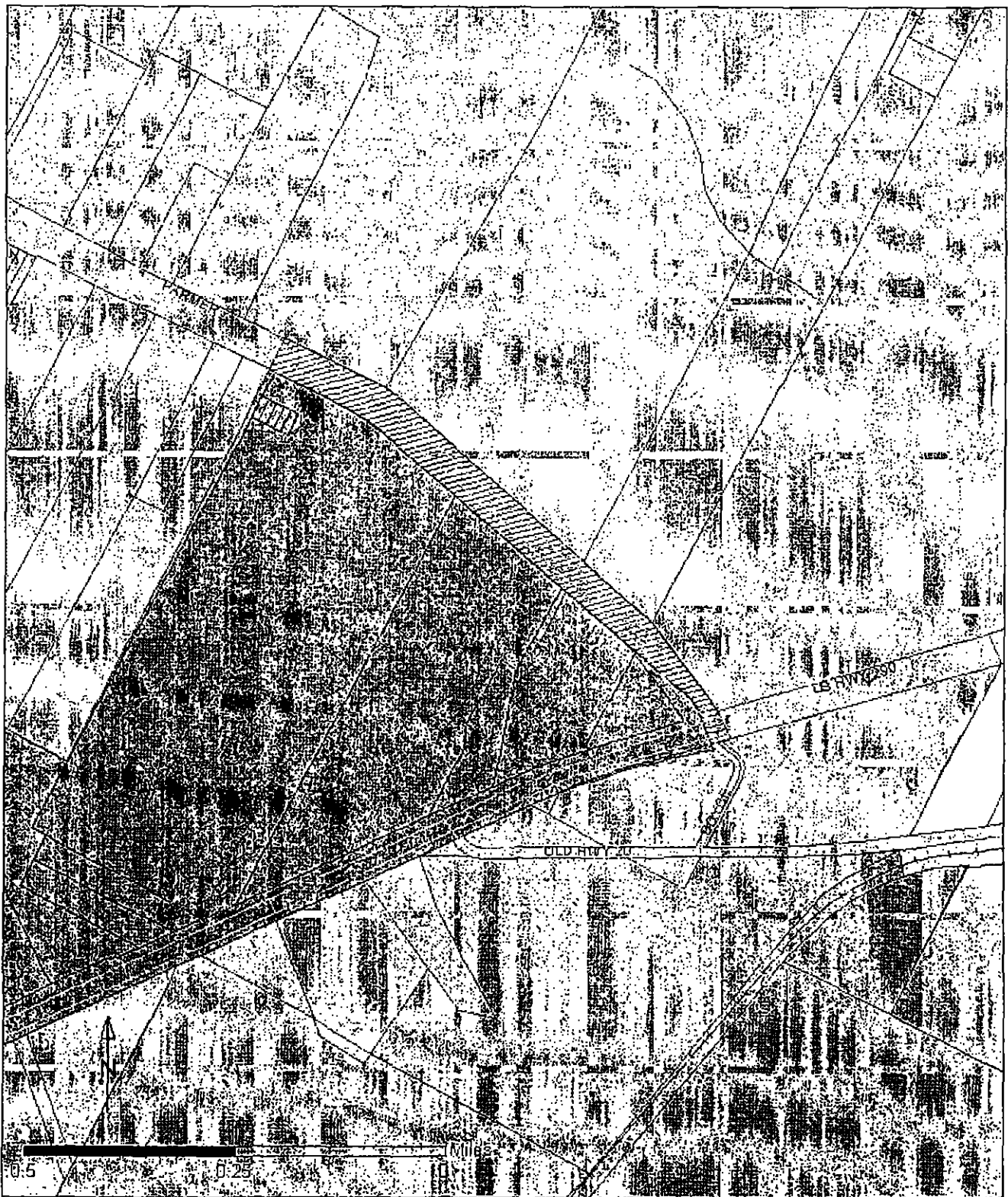

BOARD AND COMMISSION ACTION: N/A

The Parmer / US 290 East ROW area (approximately 17.6 acres) is located in Travis County and includes approximately seven tenths of a mile of Parmer Lane ROW north of the intersection of Parmer Lane and US Highway 290 East. The southbound lanes of Parmer Lane at the intersection of Parmer Lane and US Highway 290 East are currently in city limit due to the realignment of Parmer Lane and this annexation will bring the northbound lanes into the city limit.



Parmer / US 290 E

City of Austin
 Transportation, Planning & Sustainability Dept
 June 11, 2004

-  Proposed Annexation Area
-  City of Austin Full Purpose
-  City of Austin Limited Purpose
-  City of Austin ETJ