



**RCA
CITY OF AUSTIN
RECOMMENDATION FOR COUNCIL ACTION**

**AGENDA ITEM NO.: 21
AGENDA DATE: Thu 09/29/2005
PAGE: 1 of 1**

SUBJECT: Approve resolution to authorize negotiation and execution of the sale to the STATE OF TEXAS of a drainage easement of 0.071 acres of land in the Thomas Anderson Survey No. 17, Travis County, Texas and being a part of that 0.104 acre tract of land conveyed to the City by Deed recorded in Volume 9073, Page 740 of the Deed Records of Travis County, Texas, in an amount not to exceed \$6,012.90.

AMOUNT & SOURCE OF FUNDING: N/A

FISCAL NOTE: A fiscal note is not required.

REQUESTING Public Works
DEPARTMENT:

**DIRECTOR'S
AUTHORIZATION:** Sondra Creighton

FOR MORE INFORMATION CONTACT: Lauraine Rizer, 974-7078; Laura Bohl, 974-7064

PRIOR COUNCIL ACTION: N/A

BOARD AND COMMISSION ACTION: N/A

PURCHASING: N/A

MBE / WBE: N/A

Texas Department of Transportation is improving US Highway 290 from RM 1826 to Brodie Lane. In connection with that improvement project, they have made an offer to purchase an easement across City of Austin property at an appraised value of \$6,681 less ten percent (10%) being the City of Austin's share in accordance with the Supplemental Contractual Agreement with the Texas Department of Transportation dated June 27, 1986.

The property was purchased in Volume 9073, Page 740, Travis County Deed Records, is used by Austin Water Utility and is known as Oak Hill Pump Station #2.

RESOLUTION NO.

BE IT RESOLVED BY THE CITY COUNCIL OF THE CITY OF AUSTIN:

The City authorizes the negotiation and execution of the sale of 0.071 acres of land as shown on the Thomas Anderson Survey No. 17, Travis County, Texas and further described in Exhibit A (Oak Hill Lift Station), to the State of Texas (Texas Department of Transportation) for a drainage easement in an amount not to exceed \$6,681.

ADOPTED: _____, 2005

ATTEST: _____
Shirley A. Brown
City Clerk

612

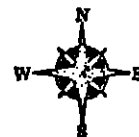

CONTINUED ON MAP 582

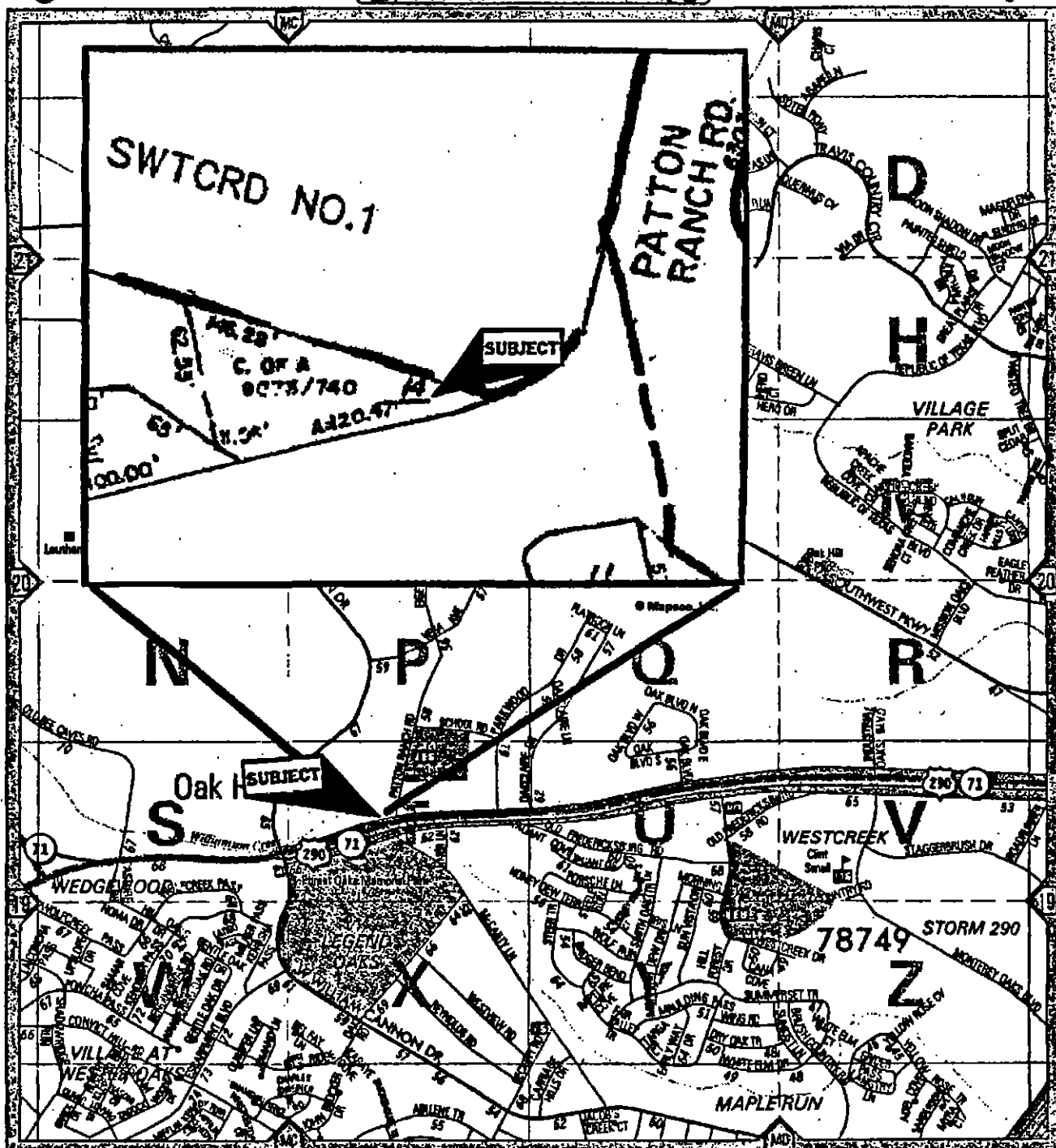

CONTINUED ON MAP 581

CONTINUED ON MAP 583

CONTINUED ON MAP 584



COPYRIGHT 1993, 2003 by MAPSCO INC. - ALL RIGHTS RESERVED



RESOLUTION NO.

BE IT RESOLVED BY THE CITY COUNCIL OF THE CITY OF AUSTIN:

The City authorizes the negotiation and execution of the sale of 0.071 acres of land as shown on the Thomas Anderson Survey No. 17, Travis County, Texas and further described in Exhibit A (Oak Hill Lift Station), to the State of Texas (Texas Department of Transportation) for a drainage easement in an amount not to exceed \$6,681, less ten percent (10%) being the City of Austin's share in accordance with the Supplemental Contractual Agreement with the Texas Department of Transportation dated June 27, 1986.

ADOPTED: _____, 2005

ATTEST: _____
Shirley A. Brown
City Clerk

LINE	BEARING	LENGTH
L1	N74°19'37"W	40.07'
L2	N14°45'26"W	18.48'
L3	N38°05'41"W	12.37'

APPROX CENTERLINE OF WILLIAMSON CREEK

CITY OF AUSTIN
ELECTRIC EASEMENT
VOL. 10205, PG. 458
AERIAL ESM 1.0' ALONG PERIMETER IS
30' SURFACE ESM 1.0' LEAVING A

CITY OF AUSTIN
DRAINAGE EASEMENT
& UV EASEMENT
VOL. 10646, PG. 461

MOTOROLA INC.
42.882 AC.
VOL. 12342, PG. 1603

RDV LINE / MOTOROLA DEED

KAF DEVELOPMENT CO.
TRACT 3
REMAINDER OF 1.377 AC.
VOL. 11590, PG. 1957
T.C.D.R.

THOMAS ANDERSON SURVEY
NO. 17

KAF DEVELOPMENT CO.
TRACT 1
LOTS 1-11 NORTH OF US 290
VOL. 11590, PG. 1957

KAF DEVELOPMENT CO.
TRACT 4 0.118 AC
VOL. 11590, PG. 1957

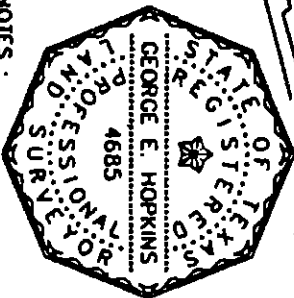

GEORGE E. HOPKINS
REGISTERED PROFESSIONAL LAND SURVEYOR
NO. 4685, STATE OF TEXAS

George E. Hopkins 9/14/03

I HEREBY CERTIFY THAT THIS SKETCH AND
ACCOMPANYING FIELDNOTE DESCRIPTION REPRESENT
THE RESULTS OF A RIGHT OF WAY SURVEY MADE
ON THE GROUND UNDER MY DIRECTION AND
SUPERVISION AND IS TRUE AND CORRECT.

- NOTES:
1. THIS SURVEY PREPARED WITHOUT THE BENEFIT OF A TITLE REPORT.
 2. BEARINGS ARE BASED ON THE TEXAS STATE PLANE COORDINATE SYSTEM - CENTRAL ZONE
 3. IMPROVEMENTS SHOWN HEREON ARE BASED ON AERIAL MAPPING PROVIDED BY TXDOT
 4. THIS SKETCH IS ACCOMPANIED BY A PROPERTY DESCRIPTION OF EVEN DATE

LEGEND

- TYPE 1 CONCRETE MONUMENT
- TYPE 2 MONUMENT FOUND
- TYPE 3 MONUMENT SET
- CORNER SET - ROW ROD WITH ALUMINUM CAP UNLESS NOTED
- ROW ROD FOUND - SIZE NOTED
- ROW PIPE FOUND - SIZE NOTED
- NAI FOUND - SIZE / TYPE NO
- FENCE CORNER POST FOUND
- CALCULATED POINT
- PROPERTY LINE
- CENTER LINE
- RECORD INFORMATION
- P.O.B. - POINT OF BEGINNING
- P.O.C. - POINT OF COMMENCING
- P.O.R. - POINT OF REFERENCE
- D.C. - DRAINAGE EASEMENT
- P.U.E. - PUBLIC UTILITY EASEMENT
- T.C.D.R. - TRAIL RECORDS OF TRAVEL CODE
- P.L.R. - PLAT RECORDS OF TRAVEL CODE

SHEET 3 OF 3

C.S.C. DRAWING

DISTRICT	RIGHT OF WAY SKETCH SHOWING PROPERTY OF:	CITY OF AUSTIN	SUR
14			1
ACCOUNT NO.			
8014-1-74	CSJ NO 0115 - 08 - 039		JLL
	US 290		

PARCEL NO. 145 E ROW TAKING: 0.071 A

CSGI
SURVEILLING
CORPORATION
INCORPORATED
1948
10-15 2017-2020