

ORDINANCE NO. 041202-48

AN ORDINANCE AMENDING ORDINANCE NO. 040826-56, ADOPTING THE CENTRAL AUSTIN COMBINED NEIGHBORHOOD PLAN AS AN ELEMENT OF THE AUSTIN TOMORROW COMPREHENSIVE PLAN, TO ESTABLISH A LAND USE DESIGNATION ON THE FUTURE LAND USE MAP FOR THE PROPERTY LOCATED AT 1007 WEST 22ND STREET AND 1919 ROBBINS PLACE.

BE IT ORDAINED BY THE CITY COUNCIL OF THE CITY OF AUSTIN:

PART 1. Ordinance No. 040826-56 adopted the Central Austin Combined Neighborhood Plan as an element of the Austin Tomorrow Comprehensive Plan.

PART 2. Ordinance No. 040826-56 is amended to establish land use designations on the future land use map attached as Exhibit "A" and incorporated in this ordinance, for properties located at:

<u>Tract</u>	<u>Address</u>	<u>Land Use Designation</u>
Tract 34	1007 West 22 nd Street	Multi-Family
Tract 35	1919 Robbins Place	Multi-Family

PART 3. This ordinance takes effect on December 13, 2004.

PASSED AND APPROVED

December 2, 2004

§
§
§

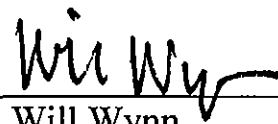

Will Wynn

Mayor

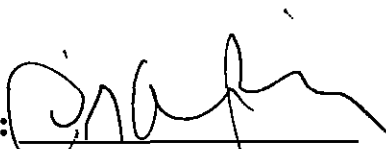
APPROVED: 

David Allan Smith
City Attorney

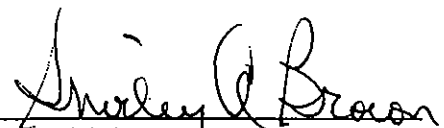
ATTEST: 

Shirley A. Brown
City Clerk

Central Austin Combined Neighborhood Planning Area: Future Land Use Map Amendment December 2, 2004

NPA-04-0019.06

(For properties that were excepted from the plan at the time of adoption)

A comprehensive plan shall not
constitute zoning regulations or
establish zoning district boundaries.

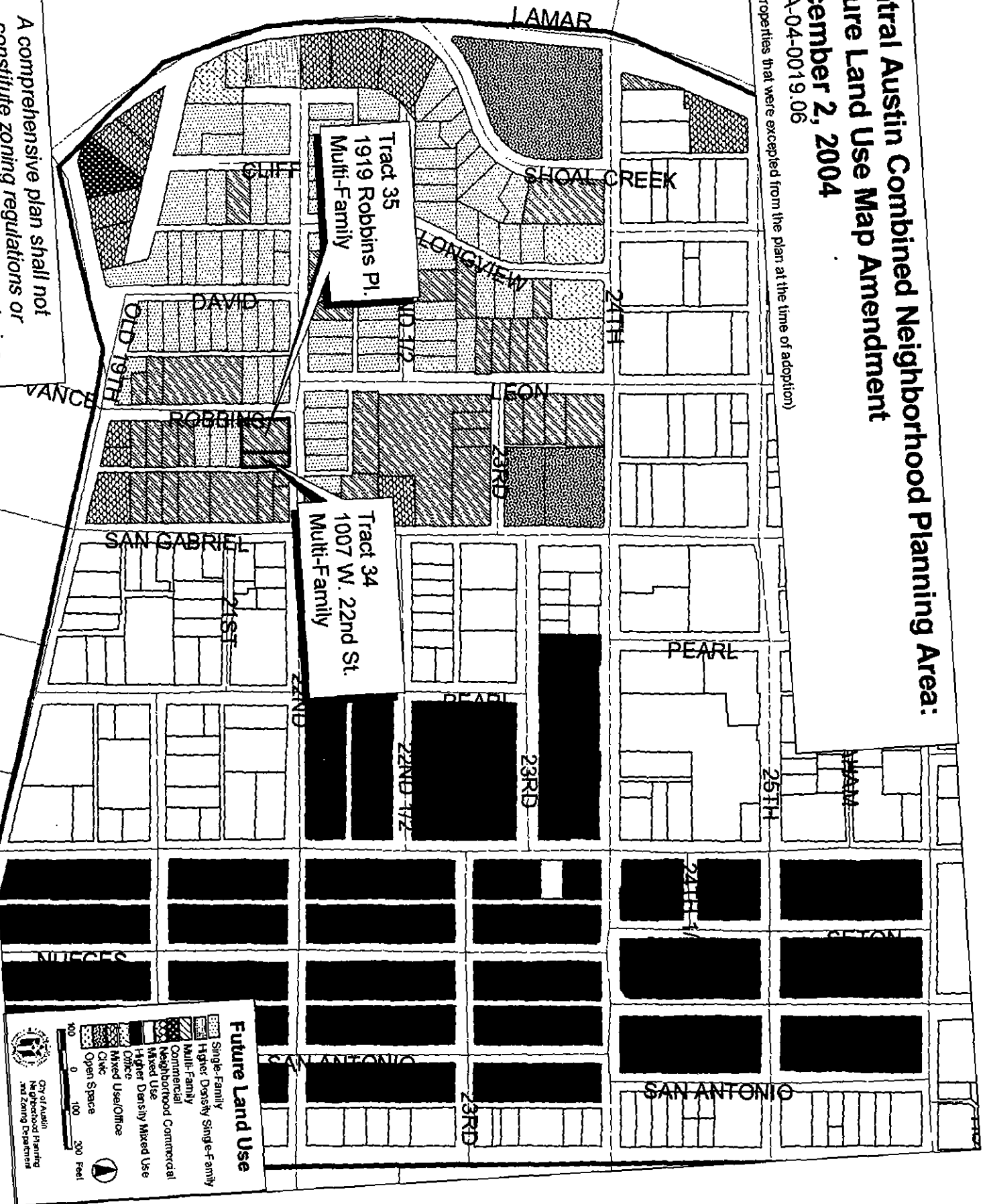

Future Land Use

- Single-Family
- Higher Density Single-Family
- Multi-Family
- Commercial
- Higher Density Commercial
- Mixed Use
- Office
- Mixed Use/Office
- Open Space



City of Austin
Neighborhood Planning
and Zoning Department