

**RESOLUTION NO. 040506-22**

**BE IT RESOLVED BY THE CITY COUNCIL OF THE CITY OF AUSTIN:**

The City Council hereby consents to the annexation by River Place Municipal Utility District ("MUD") of that certain tract of approximately one acre located in the proposed Watersedge Subdivision at the end of Big Valley Drive as more particularly shown on **EXHIBIT A** attached hereto, subject to the following conditions:

1. all development within the annexed tract will comply with current City of Austin regulations;
2. save and except for Item No. 1 above, all development within the annexed tract will comply with all requirements of the Agreement Concerning Creation and Operation of River Place MUD, as amended;
3. the property owner must agree not to pursue district bond reimbursement for off-site or internal subdivision water, sewer or drainage infrastructure required to develop the annexed tract;
4. the property owner must submit to the MUD and the City for review and approval a proposed revision of the MUD Land Plan to incorporate the annexed tract within the MUD Land Plan in accordance with Article V of the Consent Agreement;

5. prior to annexation by the MUD, the property owner must file a restrictive covenant acceptable in form and content to the Director of the City's Department of Transportation Planning and Sustainability incorporating the requirements described in Item Numbers 1 through 3 above and indicating that no building permit shall issue for construction on the annexed tract unless and until the property owner is in compliance with Items 1 through 3 above;

6. the City's consent to the proposed annexation shall be effective upon completion of the amendment to the MUD Land Plan described in Item No. 4 above.

**ADOPTED:** May 6, 2004

**ATTEST:**

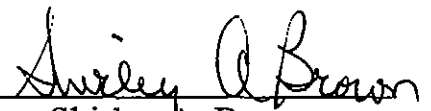
  
Shirley A. Brown  
City Clerk

M\GC\GLA\Final Res 2004\4997 River Place MUD annexation\John Tresnick\bjl

# Proposed Annexation into River Place MUD

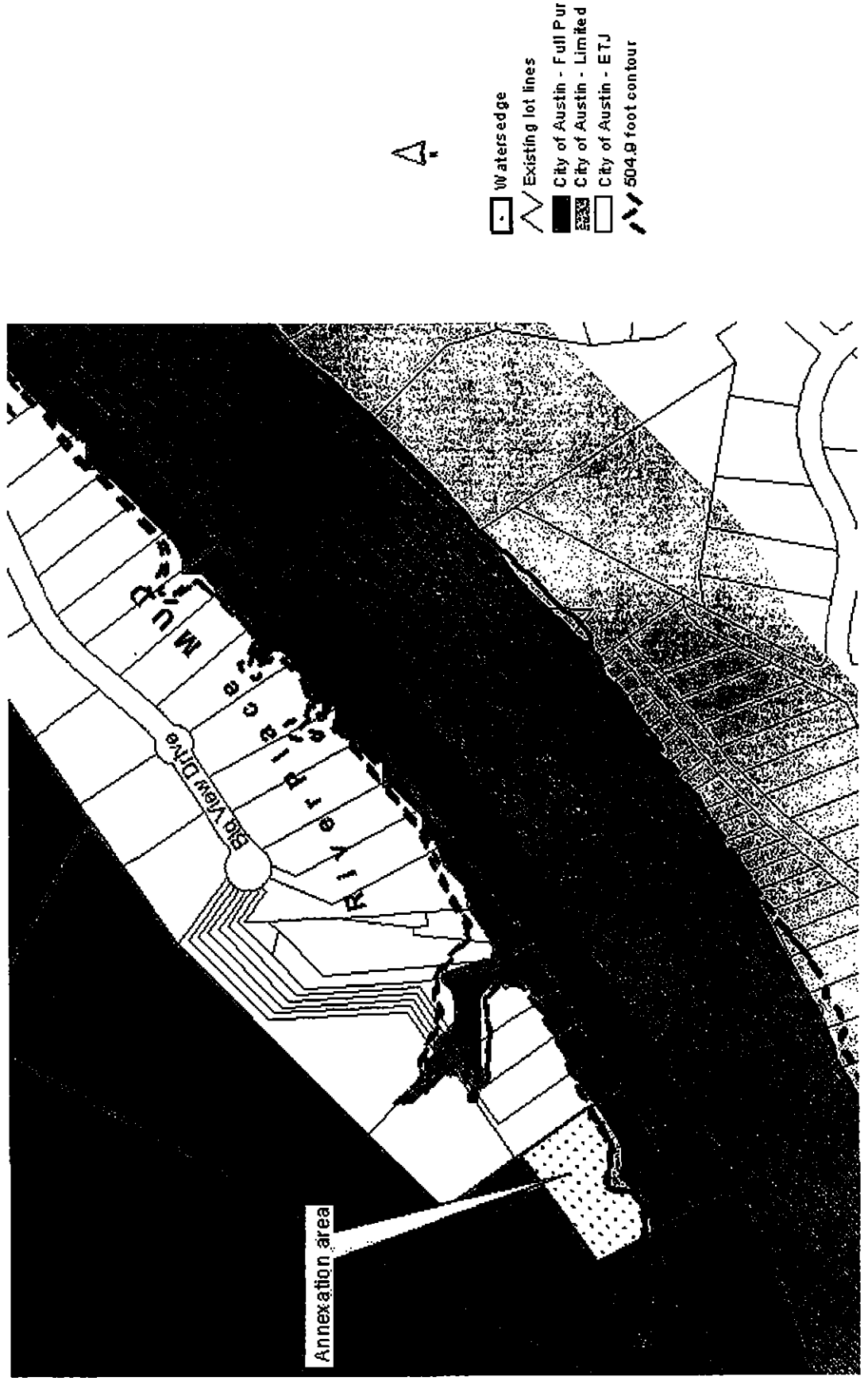

# Proposed Annexation into River Place MUD

