

**ORDINANCE NO. 20060608-093**

**AN ORDINANCE REZONING AND CHANGING THE ZONING MAP FOR THE PROPERTY LOCATED AT 6130 U.S. HIGHWAY 290 WEST FROM DEVELOPMENT RESERVE (DR) DISTRICT TO COMMUNITY COMMERCIAL-CONDITIONAL OVERLAY (GR-CO) COMBINING DISTRICT.**

**BE IT ORDAINED BY THE CITY COUNCIL OF THE CITY OF AUSTIN:**

**PART 1.** The zoning map established by Section 25-2-191 of the City Code is amended to change the base district from development reserve (DR) district to community commercial-conditional overlay (GR-CO) combining district on the property described in Zoning Case No. C14-06-0058, on file at the Neighborhood Planning and Zoning Department, as follows:

Lot 2, Oak Park Subdivision Section 4, a subdivision in the City of Austin, Travis County, Texas, according to the map or plat of record in Plat Book 36, Page 15, of the Plat Records of Travis County, Texas (the "Property"),

locally known as 6130 U.S. Highway 290 West, in the City of Austin, Travis County, Texas, and generally identified in the map attached as Exhibit "A".

**PART 2.** The Property within the boundaries of the conditional overlay combining district established by this ordinance is subject to the following conditions:

A site plan or building permit for the Property may not be approved, released, or issued, if the completed development or uses of the Property, considered cumulatively with all existing or previously authorized development and uses, generate traffic that exceeds 2,000 trips per day.

Except as specifically restricted under this ordinance, the Property may be developed and used in accordance with the regulations established for the community commercial (GR) base district and other applicable requirements of the City Code.

**PART 3.** This ordinance takes effect on June 19, 2006.

**PASSED AND APPROVED**

\_\_\_\_\_, June 8 \_\_\_\_\_, 2006

§  
§  
§

\_\_\_\_\_  
Will Wynn  
Mayor

**APPROVED:**

\_\_\_\_\_  
David Allan Smith  
City Attorney

**ATTEST:**

\_\_\_\_\_  
Shirley A. Gentry  
City Clerk

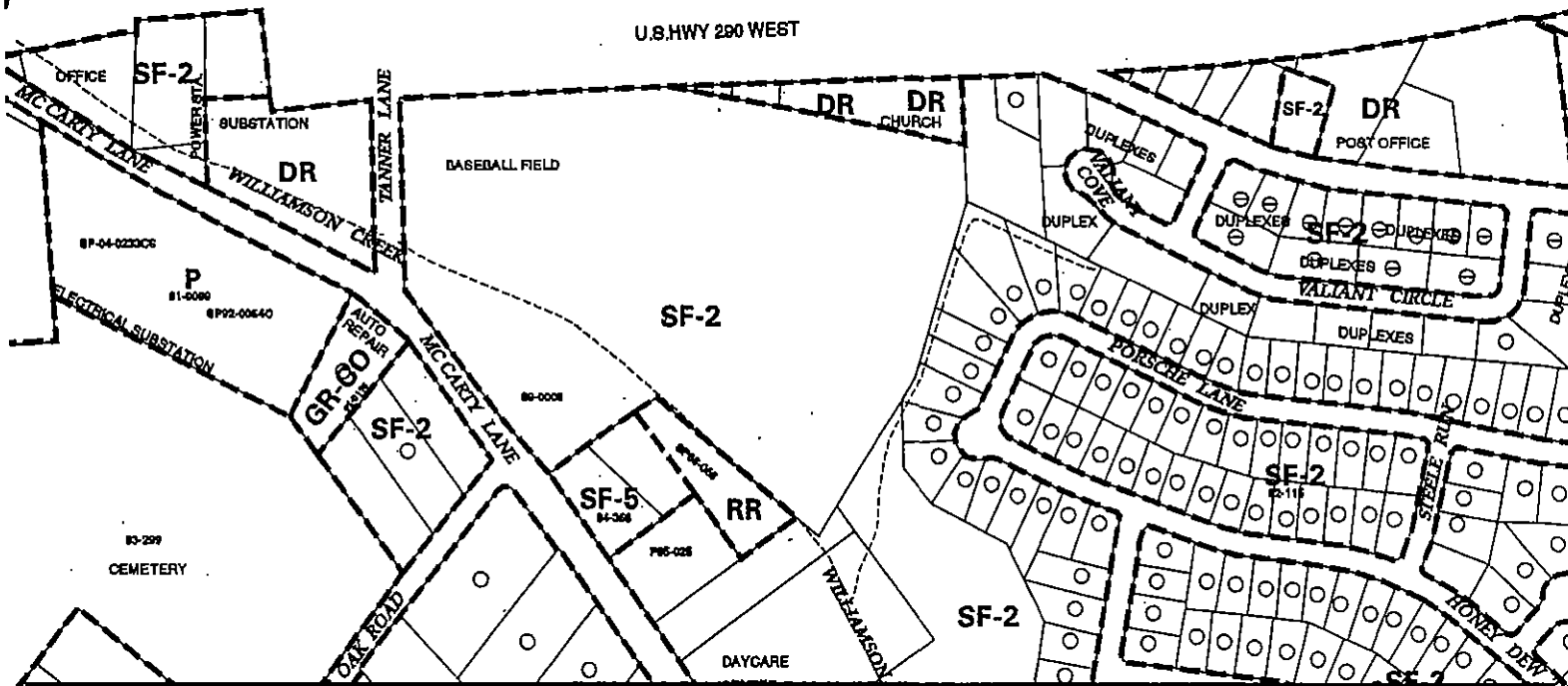
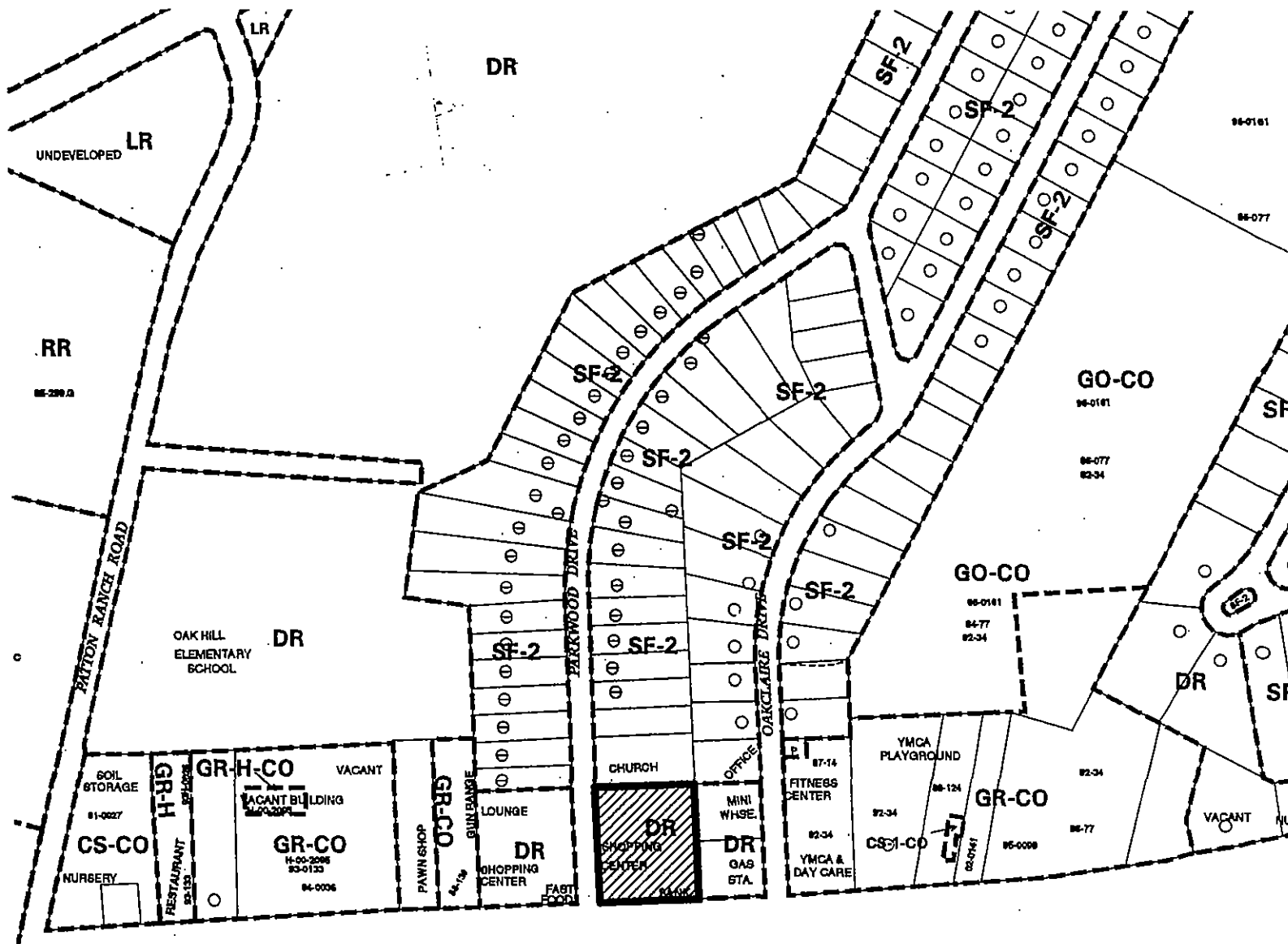

 1" = 400'	SUBJECT TRACT		<b>ZONING EXHIBIT A</b>  CASE #: C14-06-0058 ADDRESS: 6130 US HWY 290 WEST SUBJECT AREA (acres): 1.770	DATE: 06-04  INTLS: SM	CITY GRID REFERENCE NUMBER  C19
	PENDING CASE				
	ZONING BOUNDARY				
	CASE MGR: R. HEIL				