



**Annexation - Conduct Public Hearing
CITY OF AUSTIN
RECOMMENDATION FOR COUNCIL ACTION**

**AGENDA ITEM NO.: 56
AGENDA DATE: Thu 03/09/2006
PAGE: 1 of 1**

SUBJECT: Conduct a public hearing for the full purpose annexation of the Northeast Middle School Area (Approximately 74 acres located in Travis County west of Johnny Morris Road west of the intersection of Johnny Morris Road and Breezy Hill Road).

AMOUNT & SOURCE OF FUNDING: N/A

FISCAL NOTE: N/A

REQUESTING Neighborhood Planning **DIRECTOR'S**
DEPARTMENT: and Zoning **AUTHORIZATION:** Greg Guemsey

FOR MORE INFORMATION CONTACT: Virginia Collier, 974-2022; Jackie Chuter, 974-2613;
Sylvia Arzola, 974-6448

PRIOR COUNCIL ACTION: 2/9/06 - Set public hearings.

BOARD AND COMMISSION ACTION: N/A

The Northeast Middle School Area (approximately 74 acres) is located in Travis County west of Johnny Morris Road, west of the intersection of Johnny Morris Road and Breezy Hill Drive. The area is adjacent to the full purpose city limit on the north, west and south sides and is currently undeveloped. Austin Independent School District (AISD) owns land within this area and has requested that the City of Austin annex their property.

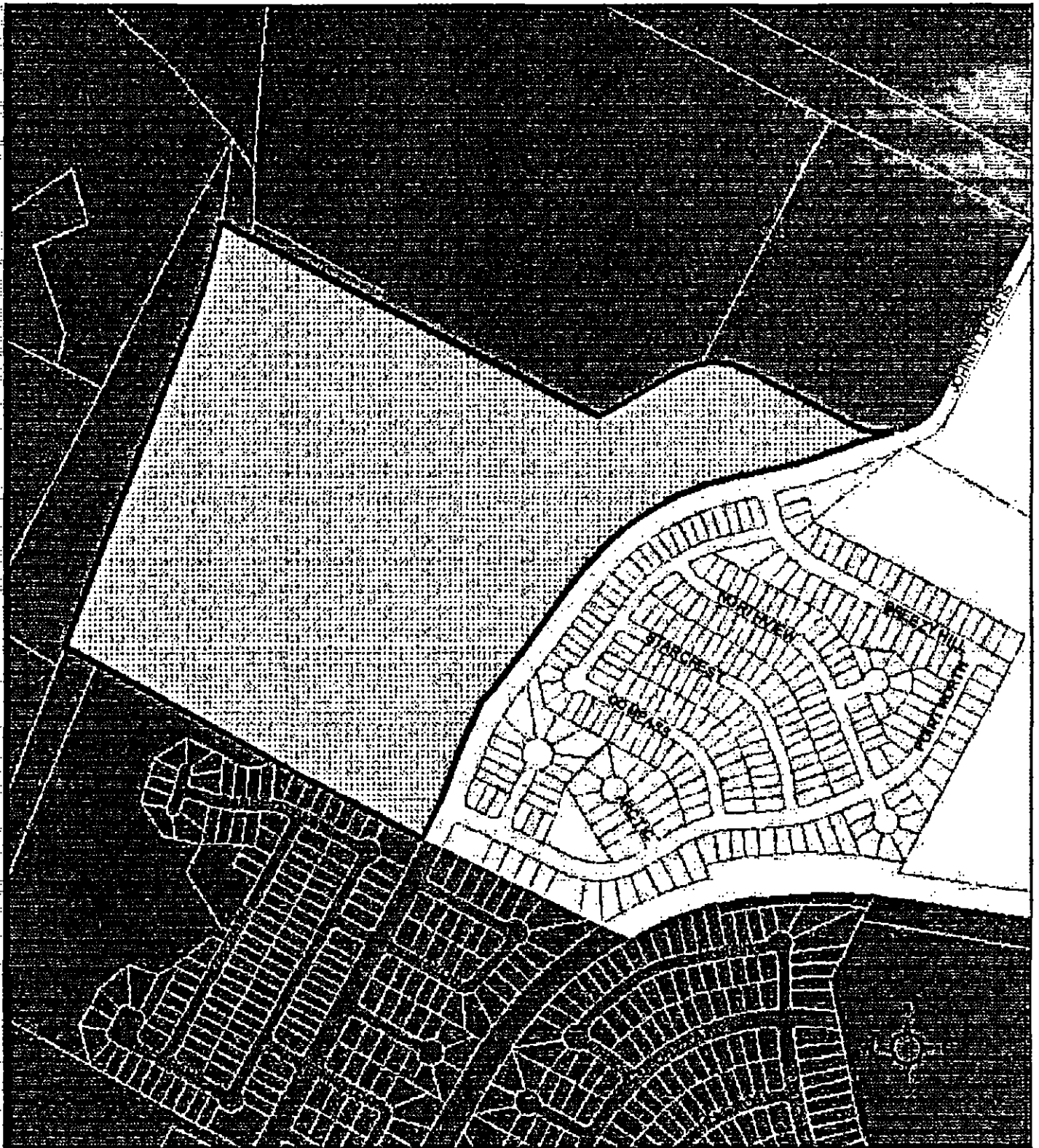

Northeast Middle School Proposed Annexation Area



City of Austin
Neighborhood Planning & Zoning Department
January 17, 2008

This map has been produced by the City of Austin Neighborhood Planning & Zoning Department for general planning purposes only and is not warranted for any other use. No warranty is made by the City regarding its accuracy or completeness.

Legend

- ANNEXATION AREA
- FULL PURPOSE
- LIMITED PURPOSE
- ETJ

- OTHER CITY
- OTHER CITY'S ETJ