

RESOLUTION NO. 20060831-016

BE IT RESOLVED BY THE CITY COUNCIL OF THE CITY OF AUSTIN:

Council authorizes the negotiation and execution of a 25 year lease with Greg and Karen Biehle for the use of approximately 2,384 square feet of City-owned land located at 35th and Mills Avenue, as shown on Exhibit A, for the purpose of off-site parking.

ADOPTED: August 31, 2006

ATTEST:

Shirley A. Gentry
City Clerk

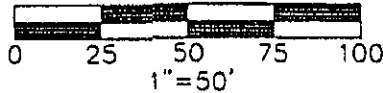
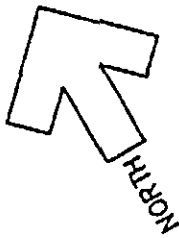

LEGEND

- 1/2" IRON ROD FOUND
 - 1" SQUARE BOLT FOUND
 - △ CALCULATED POINT
 - () RECORD INFORMATION
 - ▲ MAG NAIL FOUND
- T.C.D.R. TRAVIS COUNTY DEED RECORDS
T.C.P.R. TRAVIS COUNTY PLAT RECORDS

LINE TABLE

No.	Bearing	Distance
L1	N80°45'04"W	30.07'
L2	N54°32'10"W	20.08'
L3	N60°44'42"W	20.00'
L4	S16°11'45"W	6.90'
L5	S15°51'50"W	6.85'
L6	S13°51'55"E	7.01'
L7	N59°05'20"E	31.19'

WEST 34TH STREET (RIGHT-OF-WAY VARIES)

CURVE TABLE

No.	Delta	Radius	Arc Length	Chord Length	Chord Bearing
C1	12°50'41"	142.28	31.90	31.83	S40°11'25"E
C2	54°37'49"	142.28	135.66	130.58	S06°23'39"E
(C2)		142.28		130.58	
C3	24°59'57"	272.44	118.87	117.93	S08°25'21"W
(C3)	25°00'	272.44	118.87	117.93	
C4	123°04'44"	29.97	64.38	52.70	S57°31'20"W
(C4)	123°25'	29.97	64.56	52.78	
C5	09°22'16"	142.28	23.27	23.24	S29°01'26"E

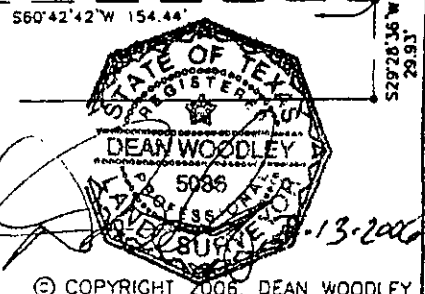

© COPYRIGHT 2006, DEAN WOODLEY

CLIENT: LIVE OAK GROUP
FIELD BOOK: 80, PAGE: 65
DRAWN BY: D.W.
PROJECT NO.: 208-04-01
DATE: 7-13-06
FILE: 2080401-PARKING2.DWG

SKETCH TO ACCOMPANY FIELD NOTES

2,384 SQUARE FEET AREA OUT OF
0.500 ACRE CITY OF AUSTIN TRACT
AS RECORDED IN VOLUME 610, PAGE 524
TRAVIS COUNTY, TEXAS



LIVE OAK
SURVEYING
12421 WYCLIFF LANE
AUSTIN, TX 78727-5220
(512) 837-1018

EXHIBIT A