



United States  
Environmental Protection  
Agency

# GREENING THE SOUTH CENTRAL WATERFRONT

## AUSTIN, TEXAS



Smart Growth  
GREENING  
AMERICA'S CAPITALS

Office of Sustainable Communities  
Smart Growth Program



# **GREENING THE SOUTH CENTRAL WATERFRONT**

## **EPA CHARRETTE WRAP UP**

**6:30-6:45 PM** ARRIVAL - ICE CREAM & SMALL CREATURES

**6:45-7:00 PM** INTRODUCTIONS

**7:00-7:30 PM** CHARRETTE RECAP & DESIGN UPDATES

**7:30-7:45 PM** EPA PROJECT TEAM - NEXT STEPS

**7:45-8:00 PM** SOUTH CENTRAL WATERFRONT PLANNING - NEXT STEPS



# EPA PROJECT SCOPE:

## 5 KEY STUDY LOCATIONS

- 1** SOUTH CONGRESS AVE
- 2** STATESMAN OPEN SPACE
- 3** LINEAR PARK & GREEN STREET
- 4** BARTON SPRINGS RD
- 5** BOULDIN CREEK

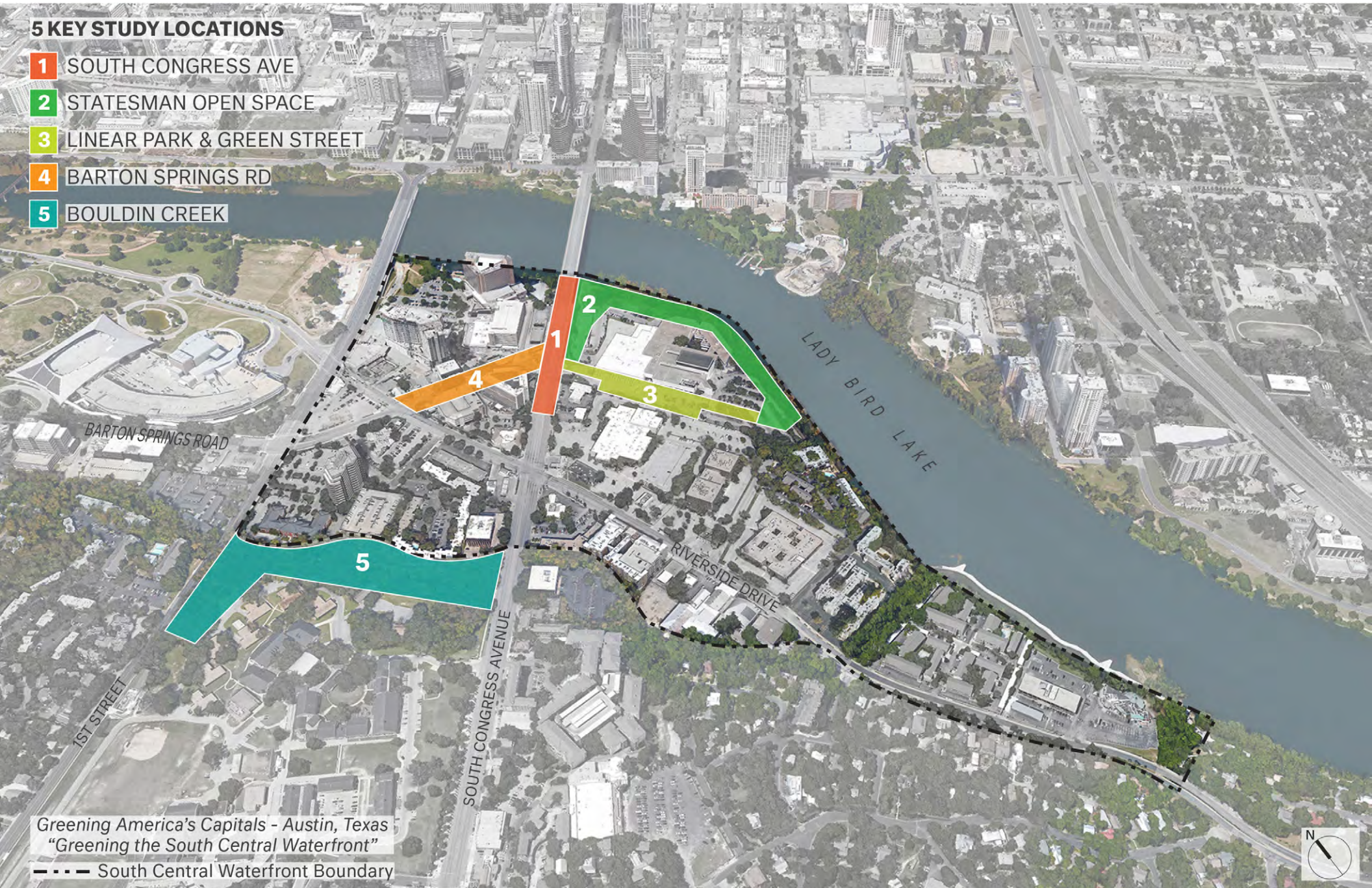











# EPA PROJECT GOALS:

## 1.) HUMANIZE SOUTH CONGRESS AVENUE

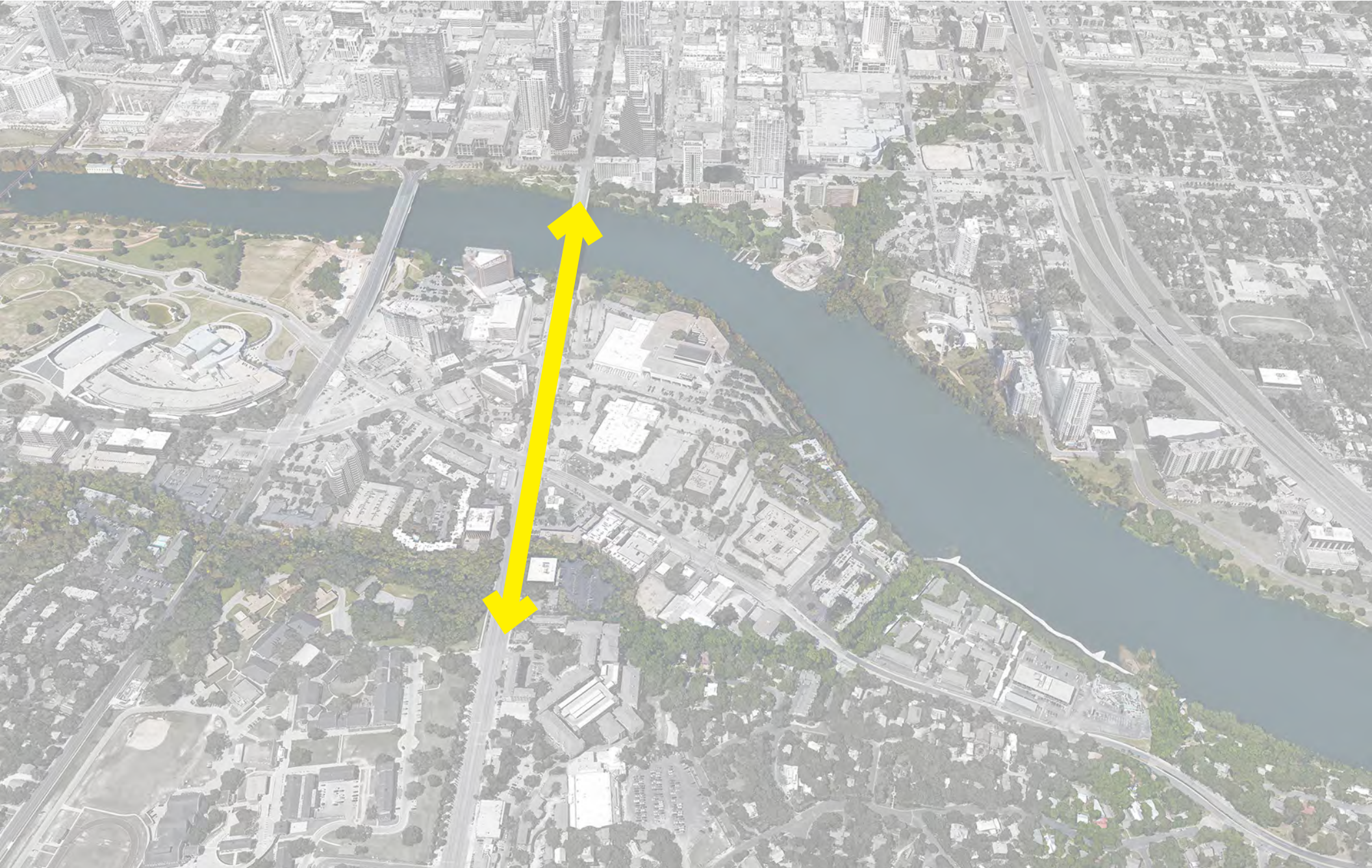



# EPA PROJECT GOALS:

## 2.) CONNECT ADJACENT NEIGHBORHOODS

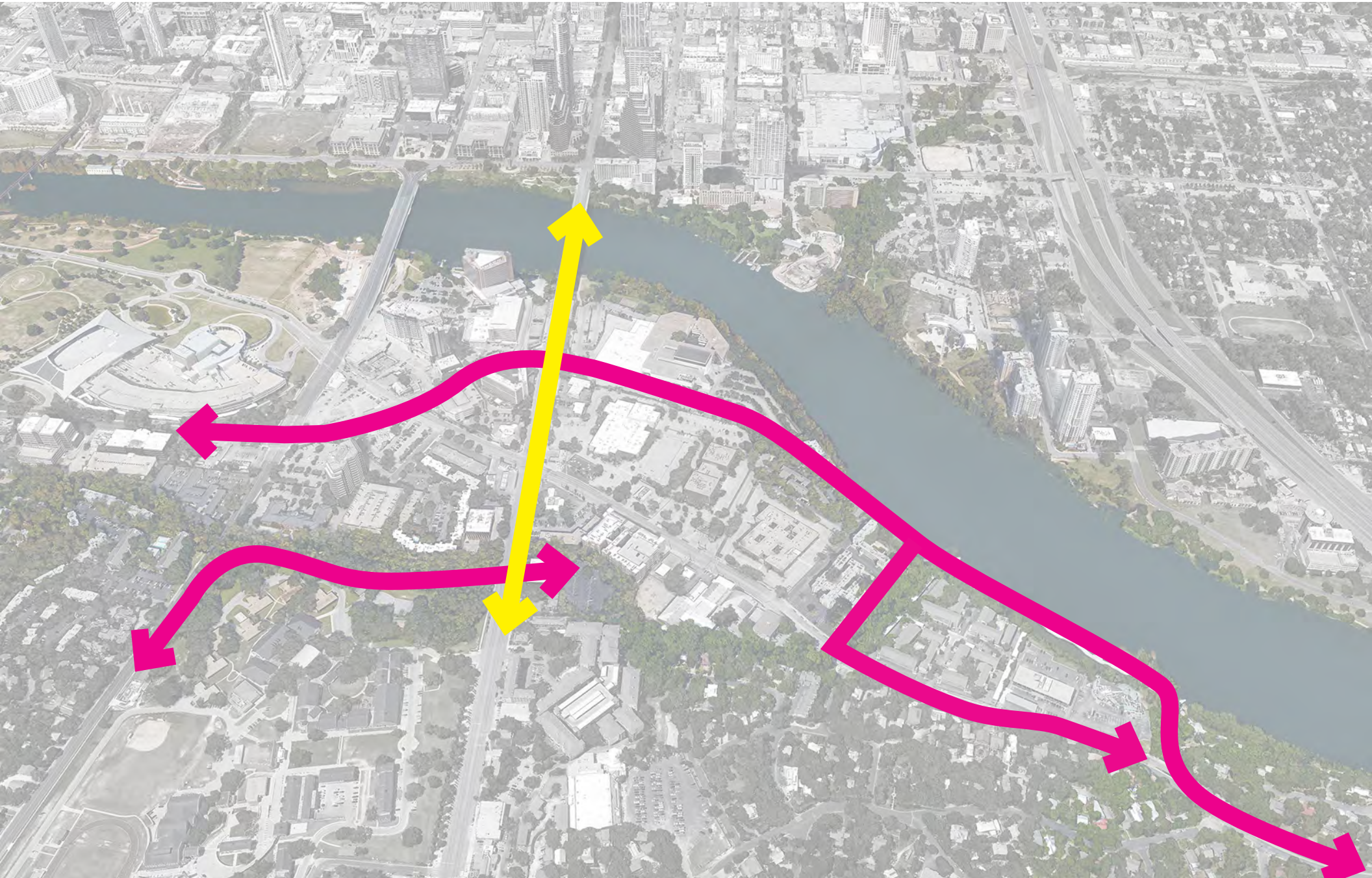



# EPA PROJECT GOALS:

## 3.) CREATE A GATEWAY TO SOUTH CONGRESS

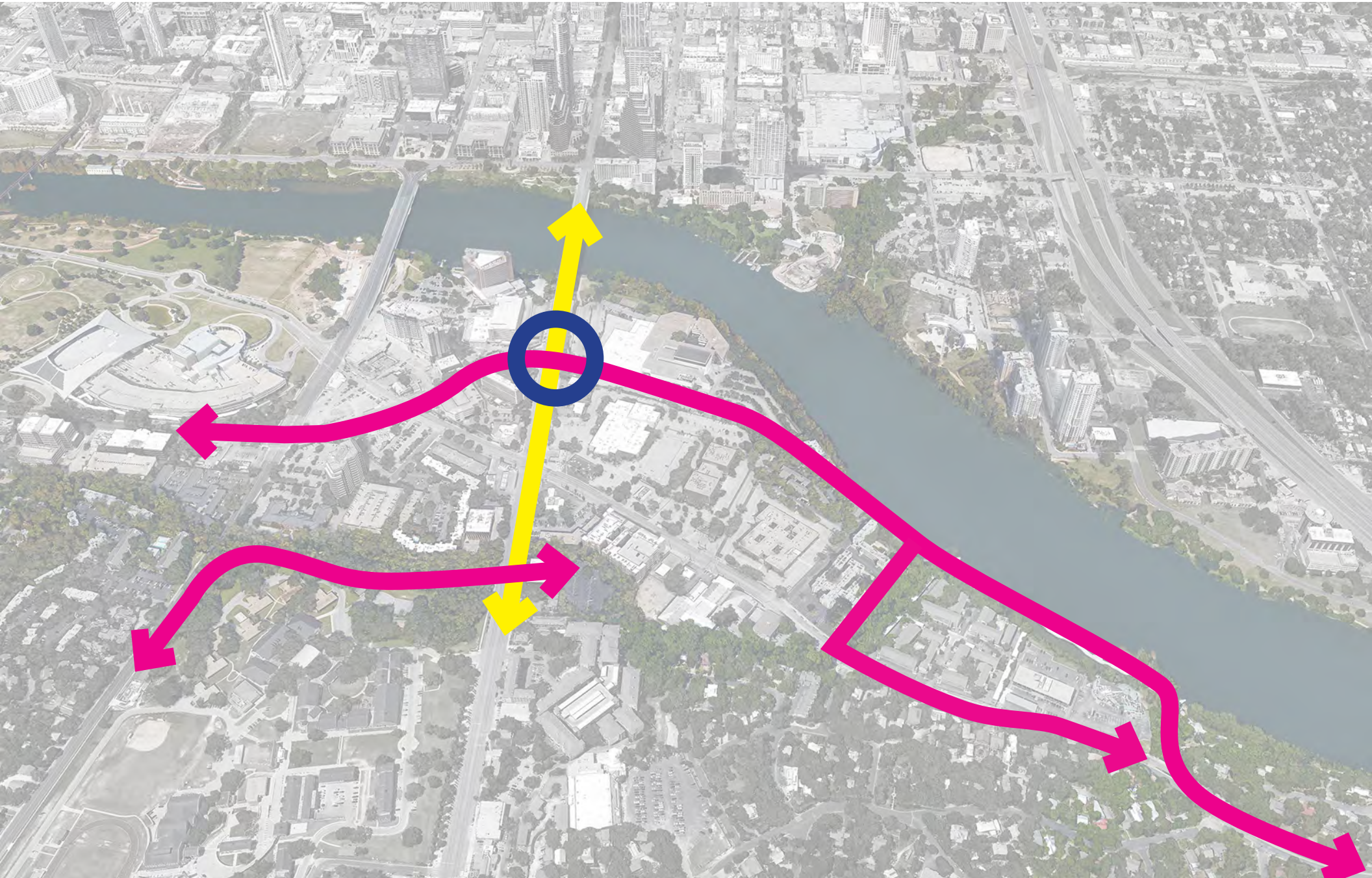



# EPA PROJECT GOALS:

## 4.) ENHANCE WATERFRONT ACCESS

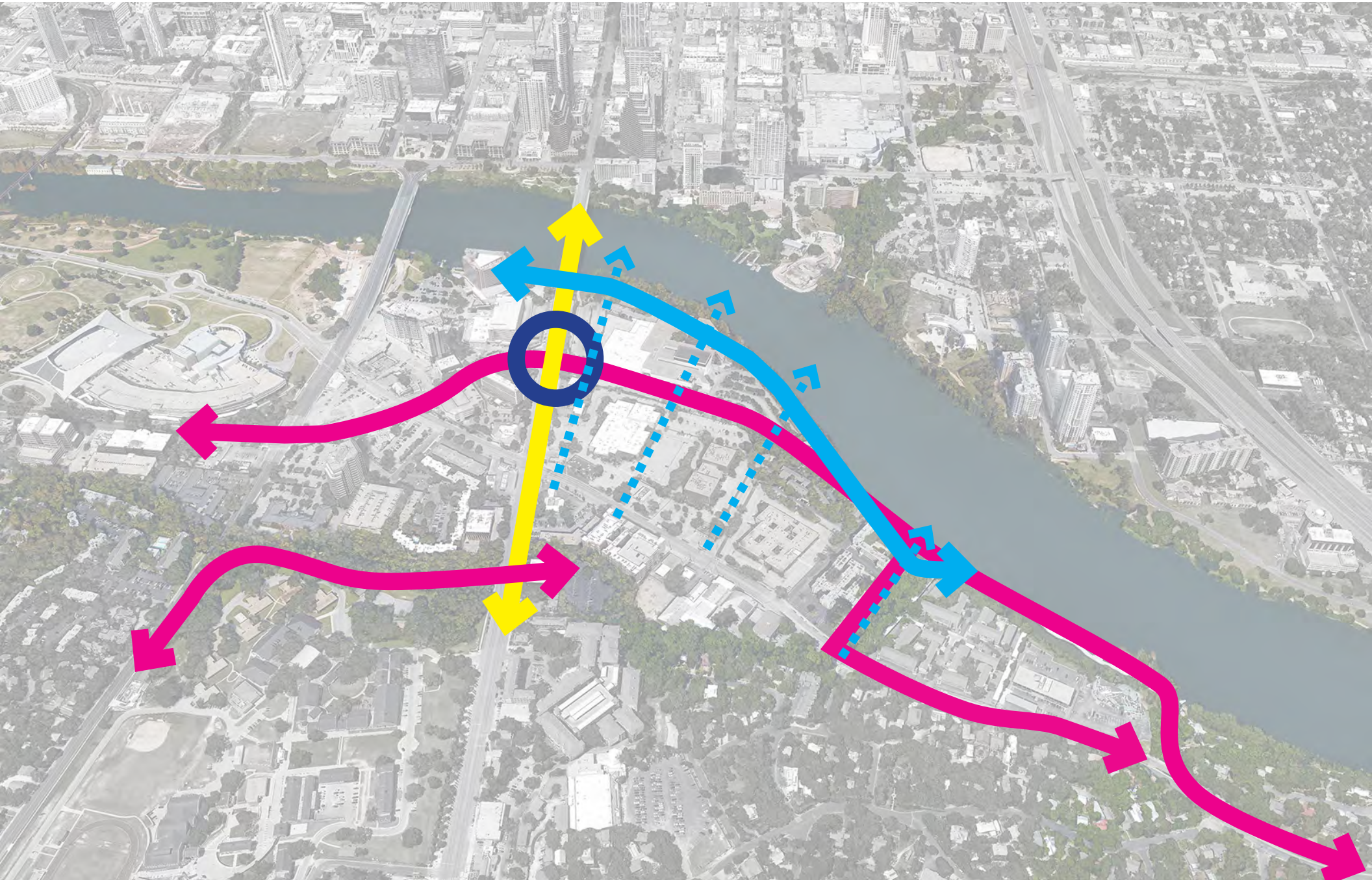



# EPA PROJECT GOALS:

## 5.) IMPROVE WATER QUALITY & THE PUBLIC REALM

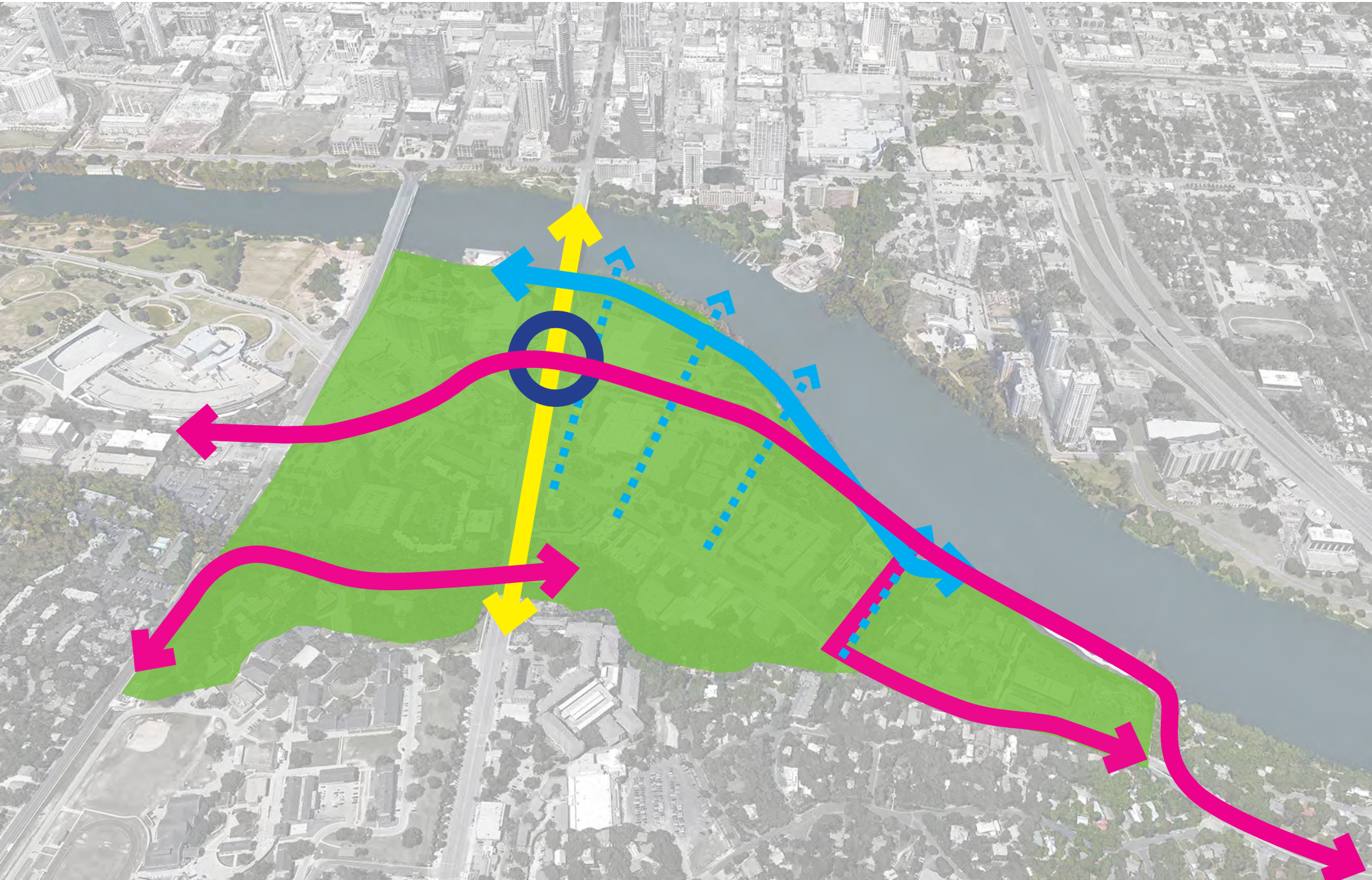



## OPTION 1



## OPTION 2





# STAKE HOLDERS





# PUBLIC MEETING





# FOCUS GROUPS





# EPA PROJECT SCOPE:

## 5 KEY STUDY LOCATIONS

- 1 SOUTH CONGRESS AVE
- 2 STATESMAN OPEN SPACE
- 3 LINEAR PARK AND GREEN STREET
- 4 BARTON SPRINGS RD
- 5 BOULDIN CREEK

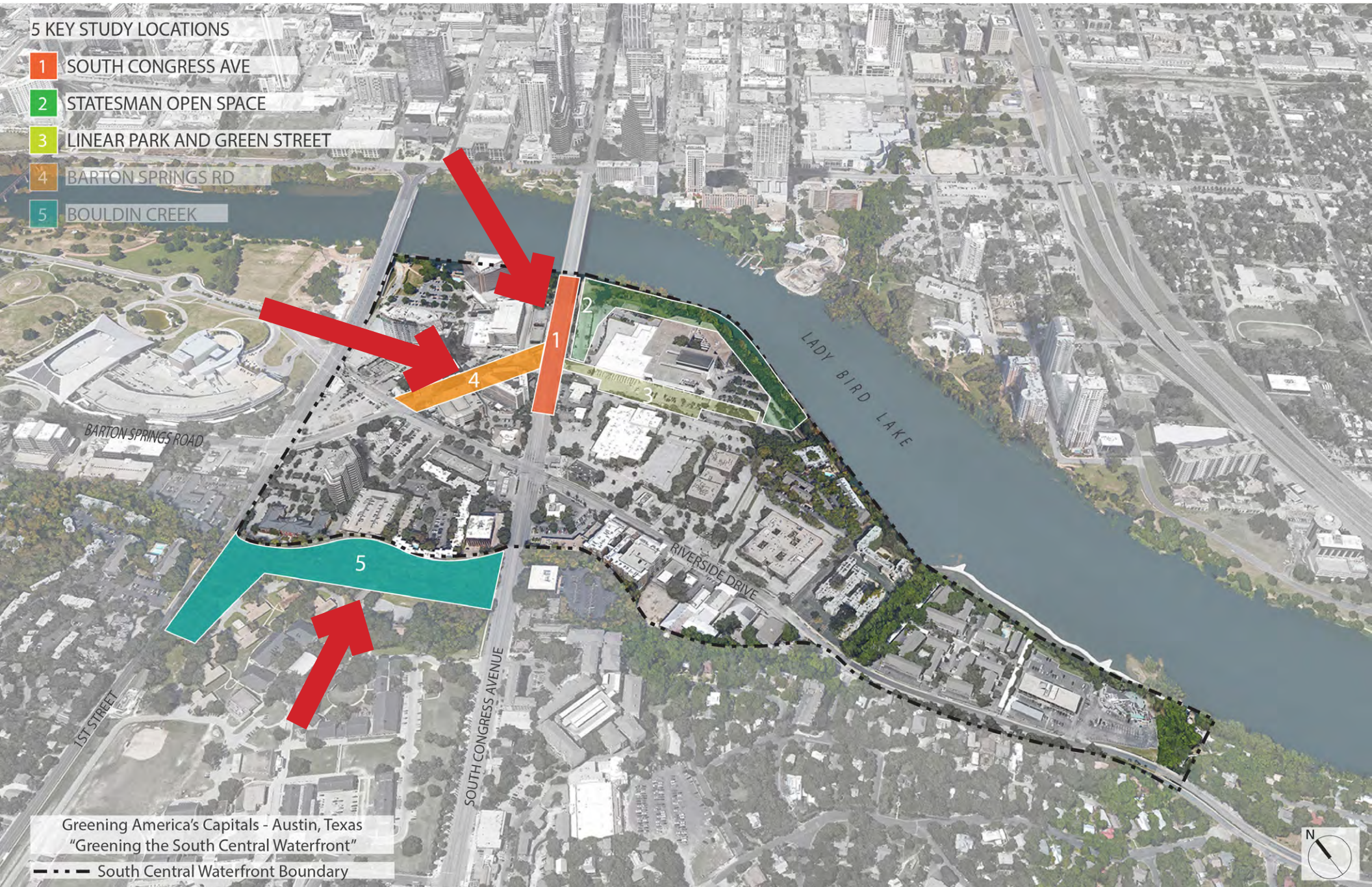



# 1 Bouldin Creek Trail



## Option 1:

- Large Integrated Stormwater Treatment Garden
- Canopy Walk from Congress Avenue to TSD
- Limited Public Access to TSD Campus



## Option 2:

- Centralized Stormwater Treatment Areas
- Bridge to Haywood Avenue
- Small Public Picnic Areas along Trail



# CHANNELIZED BOGGY CREEK





# 1 Bouldin Creek Trail





## COMMENTS



- Concept Plan Summary**
- Large Integrated Stormwater Treatment Garden
  - Canopy Walk from Congress Avenue to Texas School for the Deaf (TSD) Campus
  - Limited Public Access to TSD Campus



- Concept Plan Summary**
- Centralized Stormwater Treatment Areas
  - Bridge to Haywood Avenue
  - Small Public Picnic Areas along Trail



### Inspirational Images



### Inspirational Images





# COMMENTS

- Decentralize the Stormwater Gardens
- Include Bridge AND Canopy Walk
- Verify Rim Rock at East End of Creek
- Provide Crosswalks at S. Congress + 1st Street
- Add South Spur to Trail at 1st Street

## Concept Plan Summary

- Large Integrated Stormwater Treatment Garden
- Canopy Walk from Congress to School for the Deaf (TSD) Campus
- Limited Public Access to TSD Campus

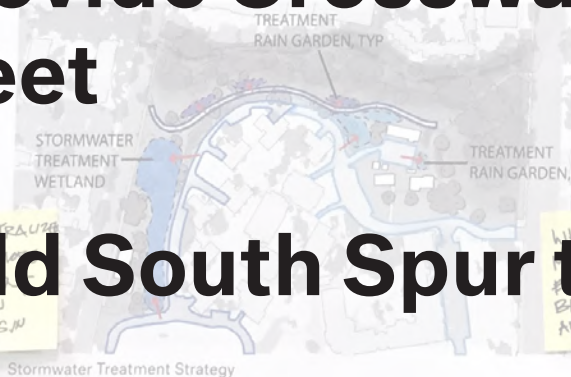

## Concept Plan Summary

- Centralized Stormwater Treatment Areas
- Bridge to Haywood Avenue
- Small Public Picnic Areas along Trail



## Inspirational Images



## Inspirational Images





# 1 Bouldin Creek Trail





## ① Bouldin Creek Trail

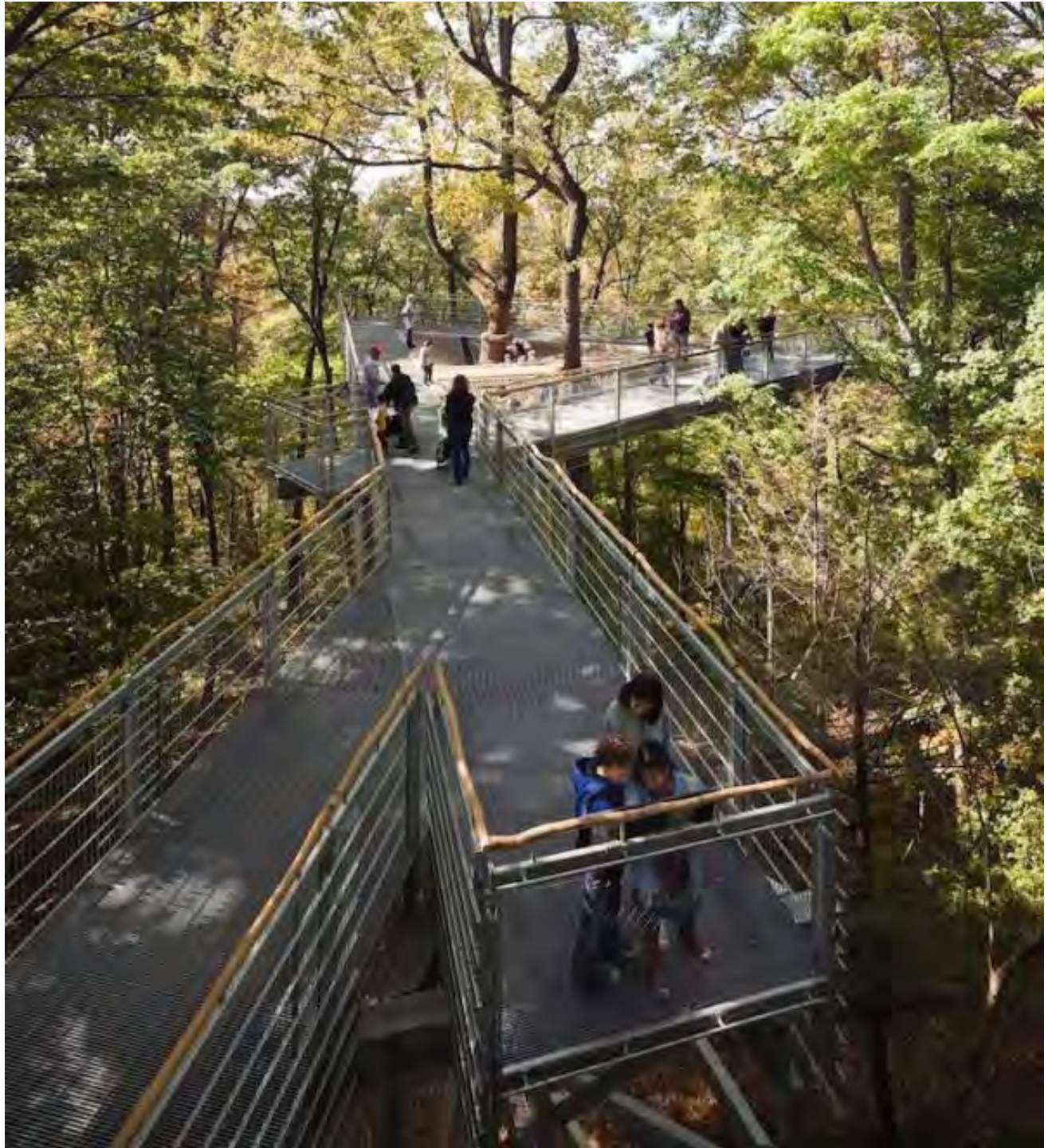



## 1 Bouldin Creek Trail





## 2 Barton Springs Road

### Option 1:

- Two 10' Lanes North Bound, One 10' lane South Bound
- Two Left Turn Lanes onto Congress Avenue
- Wider Sidewalk on East Side
- Parking Inboard of Bike Lane



### Option 2:

- One 10' Lane North Bound, One 10' Lane South Bound
- One Left Turn Lane onto Congress Avenue
- Both Sidewalks Wider
- Street Parking Protects Bike Lane





## ② Barton Springs Road









# COMMENTS

Option 1



- Prioritize North Side for Public Realm

- Encourage Infill Development with Active Ground Floor Uses

- Use Tactical Urbanism to Test Closure of Free Right Turn

- Work with Property Owners to Remove Drive at East End of Street

- 2 Lanes with Continuous Turn Lane



Concept Section

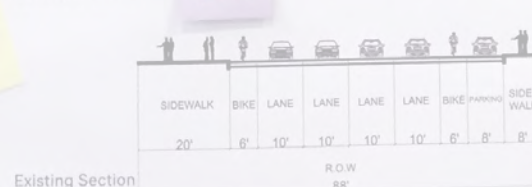

Existing Section

Must explore + address traffic problems & how reduction of # lanes will affect traffic.

Look at bicycle safety as part of options, esp. Congress

ACCESSIBILITY

Reduction of lanes feasible?

more mid-block feet-crossing beams?

lane by sidewalk?

"Right of Way"

TALK ABOUT CONNECTIONS TO ADJACENT NEIGHBORHOODS





## 2 Barton Springs Road





## 2 Barton Springs Road

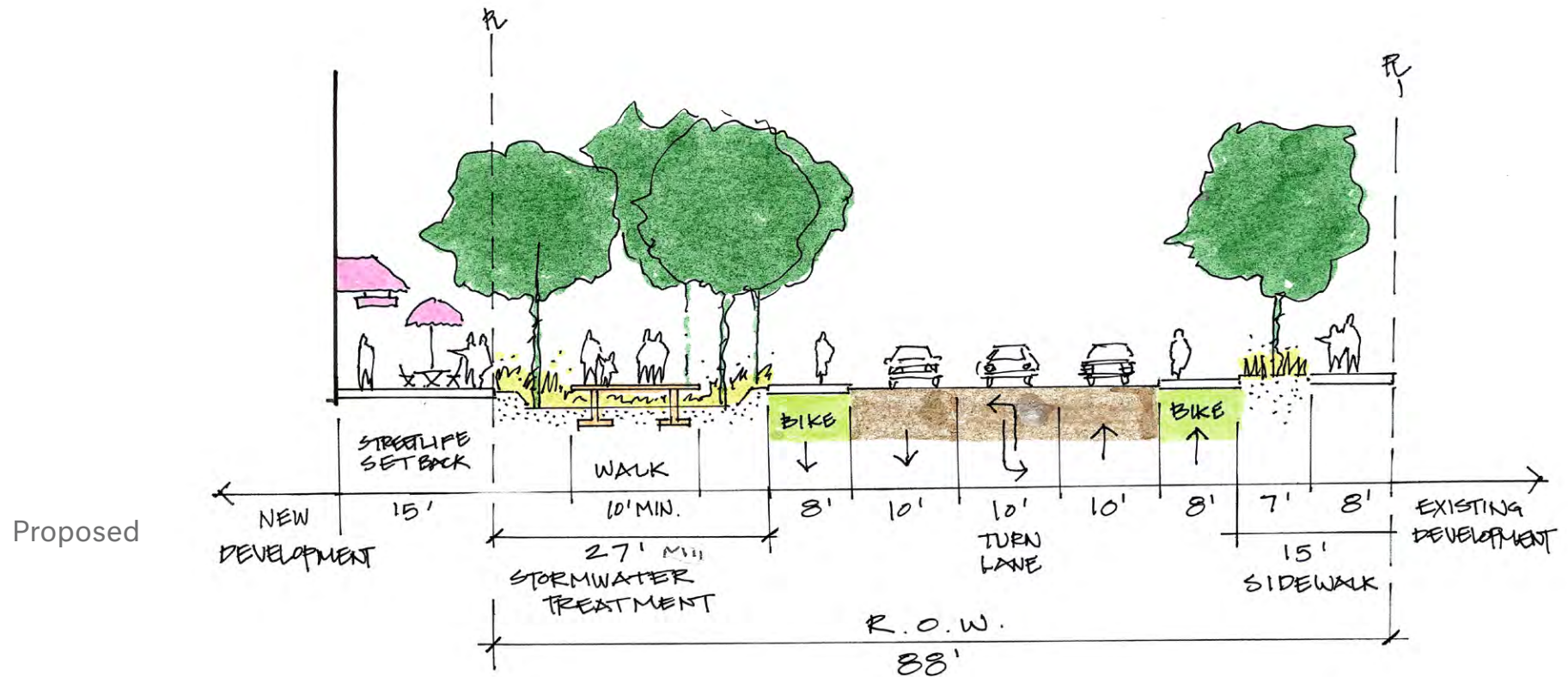
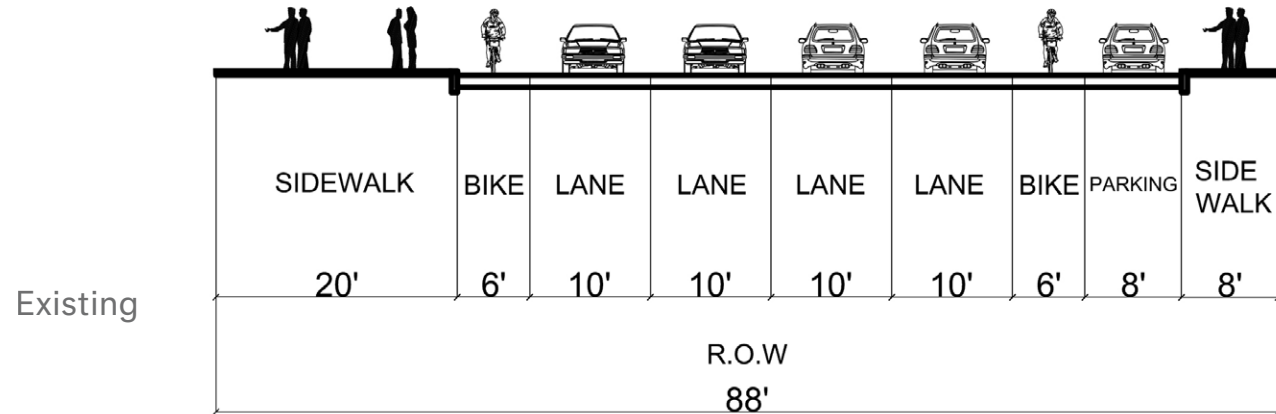



## ② Barton Springs Road





## 2 Barton Springs Mews





## 2 Barton Springs Mews





# SOUTH CONGRESS - BSR TACTICAL URBANISM





# SOUTH CONGRESS - BSR TACTICAL URBANISM





# SOUTH CONGRESS - BSR TACTICAL URBANISM





### 3 South Congress Avenue



Option 1:

- Three 10' Lanes South Bound, One 10' Turn Lane, Two 10' North Bound Lanes
- Wide Stormwater Treatment Rain Gardens on West Sidewalk



Option 2:

- Two 10' Lanes South Bound, One 10' Turn Lane, Two 10' North Bound Lanes
- 12' Stormwater Treatment Median
- Mid-Block Pedestrian Passageways



### 3 South Congress Avenue





# COMMENTS

Option 1



PROTECT BAT HABITATS  
LIGHTS & NOISE NEED CANOPY FOR BAT

Concept Section

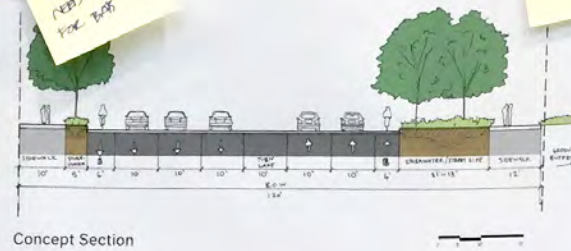

Concept Plan Summary

- Three 10' Lanes South Bound, One 10' Turn Lane, Two 10' North Bound Lanes
- Wide Stormwater Treatment Rain Gardens on West Sidelwalk



Stormwater Treatment Strategy

Inspirational Images



Street Life/Planning Zone on Arsonal Street



Sidewalk Rain Garden

Option 2



Concept Section

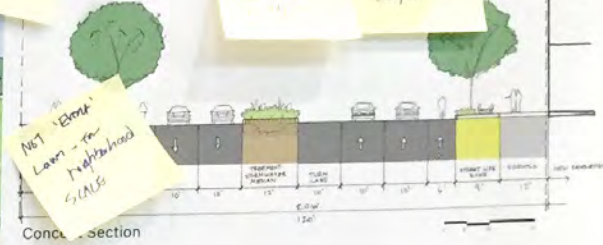

Concept Plan Summary

- Two 10' Lanes South Bound, One 10' Turn Lane, Two 10' North Bound Lanes
- 12' Stormwater Treatment Median
- Mid-Block Pedestrian Passageways



Stormwater Treatment Strategy

Inspirational Images



Sidewalk Street Cafe with Shade Canopy



Street Life Zone

|             |              |           |      |      |           |      |      |           |             |              |
|-------------|--------------|-----------|------|------|-----------|------|------|-----------|-------------|--------------|
| GREEN SPACE | 5' SIDE WALK | CURB LANE | LANE | LANE | TURN LANE | LANE | LANE | TURN LANE | GREEN SPACE | 5' SIDE WALK |
| 10'         | 5'           | 12'       | 11'  | 11'  | 8'        | 11'  | 11'  | 26'       | 9'          | 6'           |
| R.O.W 120'  |              |           |      |      |           |      |      |           |             |              |

Existing Section



Key Map



# COMMENTS

- Leave Street Open for Transit Corridor Potential (No Medians)
- Provide Trail Access on West side of Bridge
- Coordinate Utilities to Ensure Space for Street Trees
- Protect the Bike Lanes
- Preserve Eclectic Character (Threshold vs. Gateway)
- Add More Mid-Block Crossings
- Make a Mid Block Connection to the Crockett Parcel
- Create an Urban Forest and Ecological District

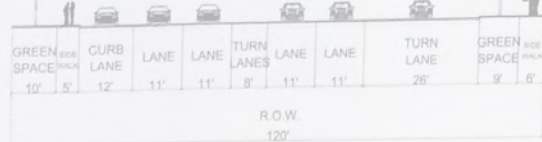

Existing Section

Key Map



# DIAGRAM - EPISODIC - Break Down Sense of Time

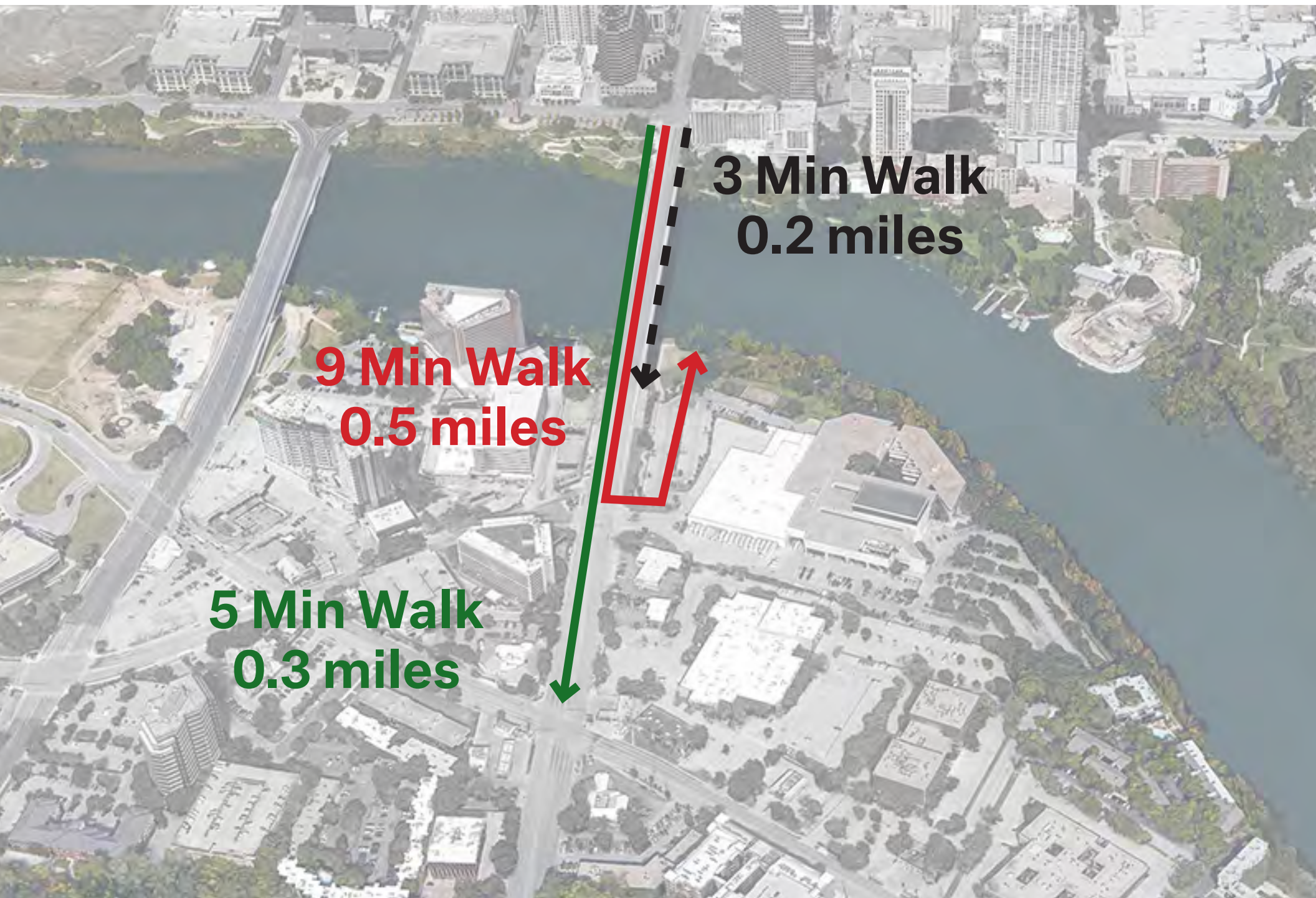



# THRESHOLD - ENTERING A GREEN DISTRICT







The Long Center for the Performing Arts  
W. Riverside Rd.  
Back to Map

melbourne.jpg

Image capture: Apr 2015 © 2015 Google Terms Privacy Send feedback

Show all downloads

Desktop 100% 11:55 AM 9/3/2015



168 S Congress Ave

Austin, Texas

Street View - Apr 2015

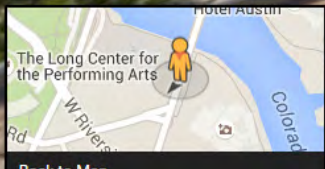

Google

TEXAS ORIGINAL CRAFT VODKA



www.google.com/maps/@30.2595812,-97.74598,3a,75y,185.31h,86.8t/data=!3m6!1e1!3m4!1sDRfg\_jjOgC2phA51HoQoTQ!2e0!7i13312!8i6656



Colorado

Google

Image capture: Apr 2015 © 2015 Google Terms Pr

Show

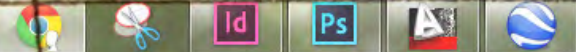

Desktop

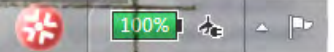



306 S Congress Ave

Austin, Texas

Street View - Apr 2015







g



### 3 South Congress Avenue

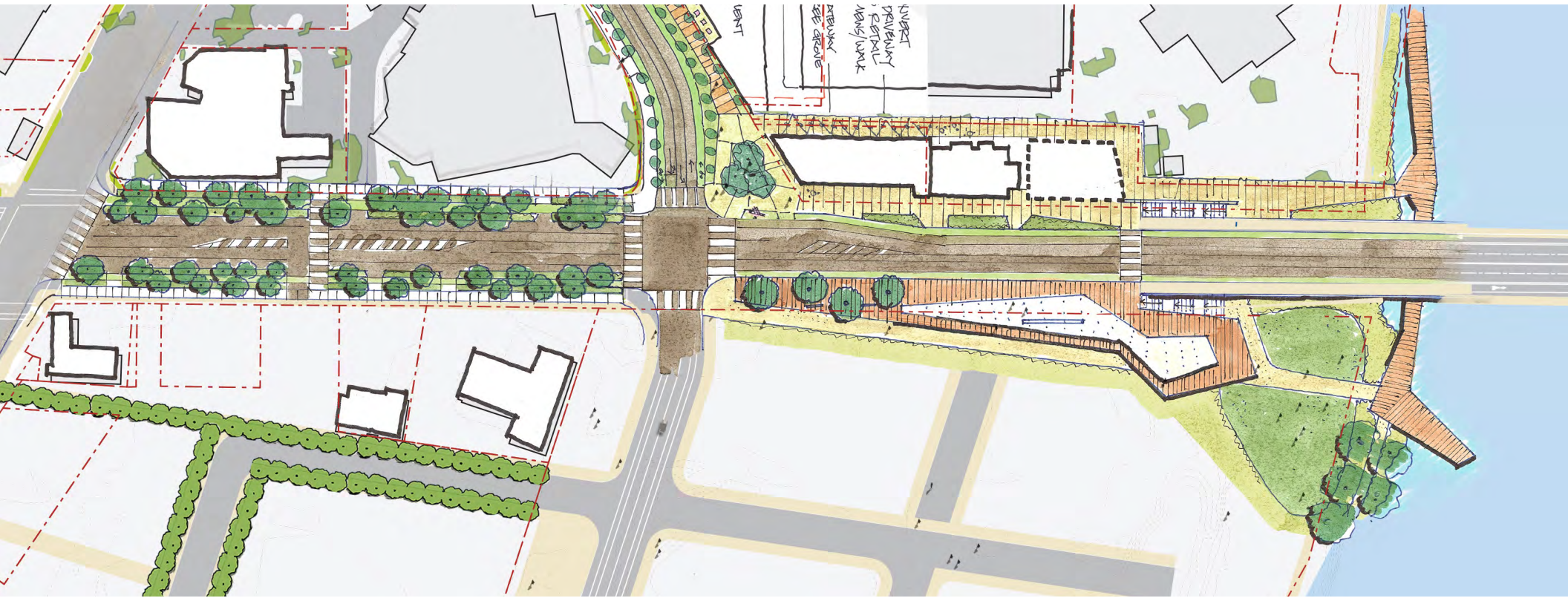



# 3 South Congress Avenue

Existing

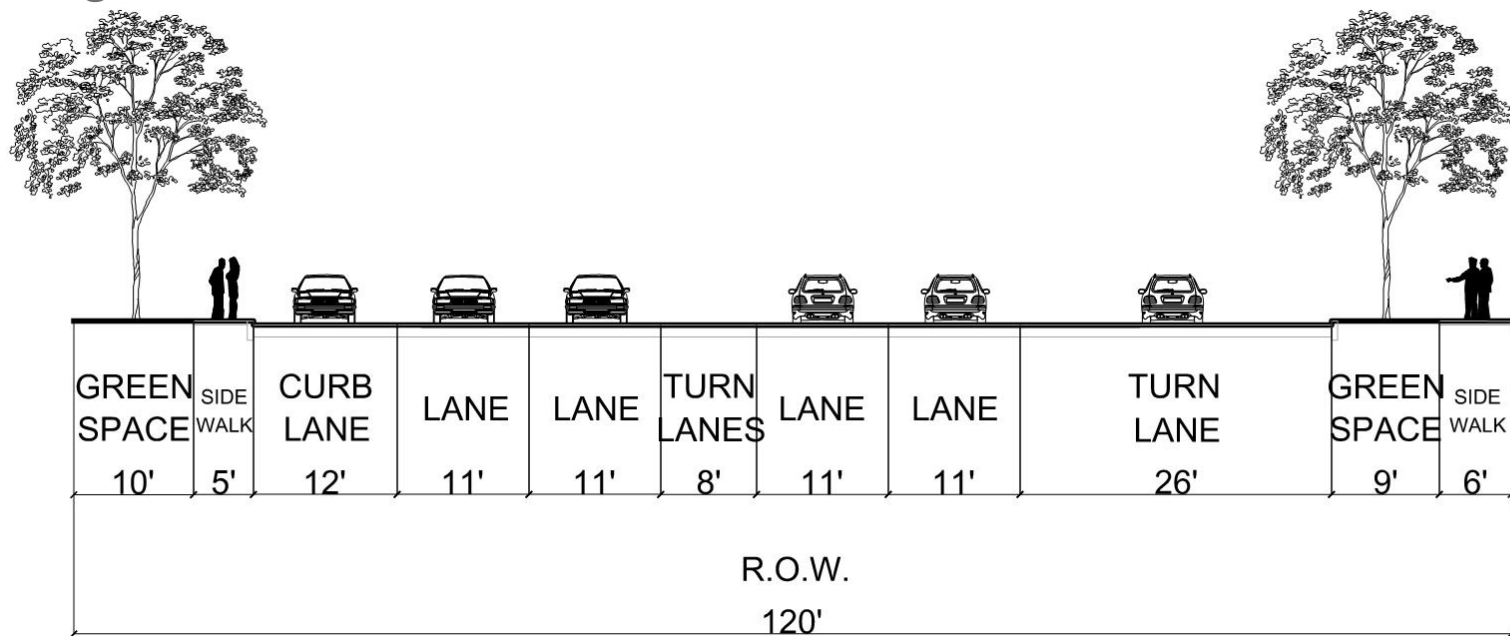

Typical Proposed

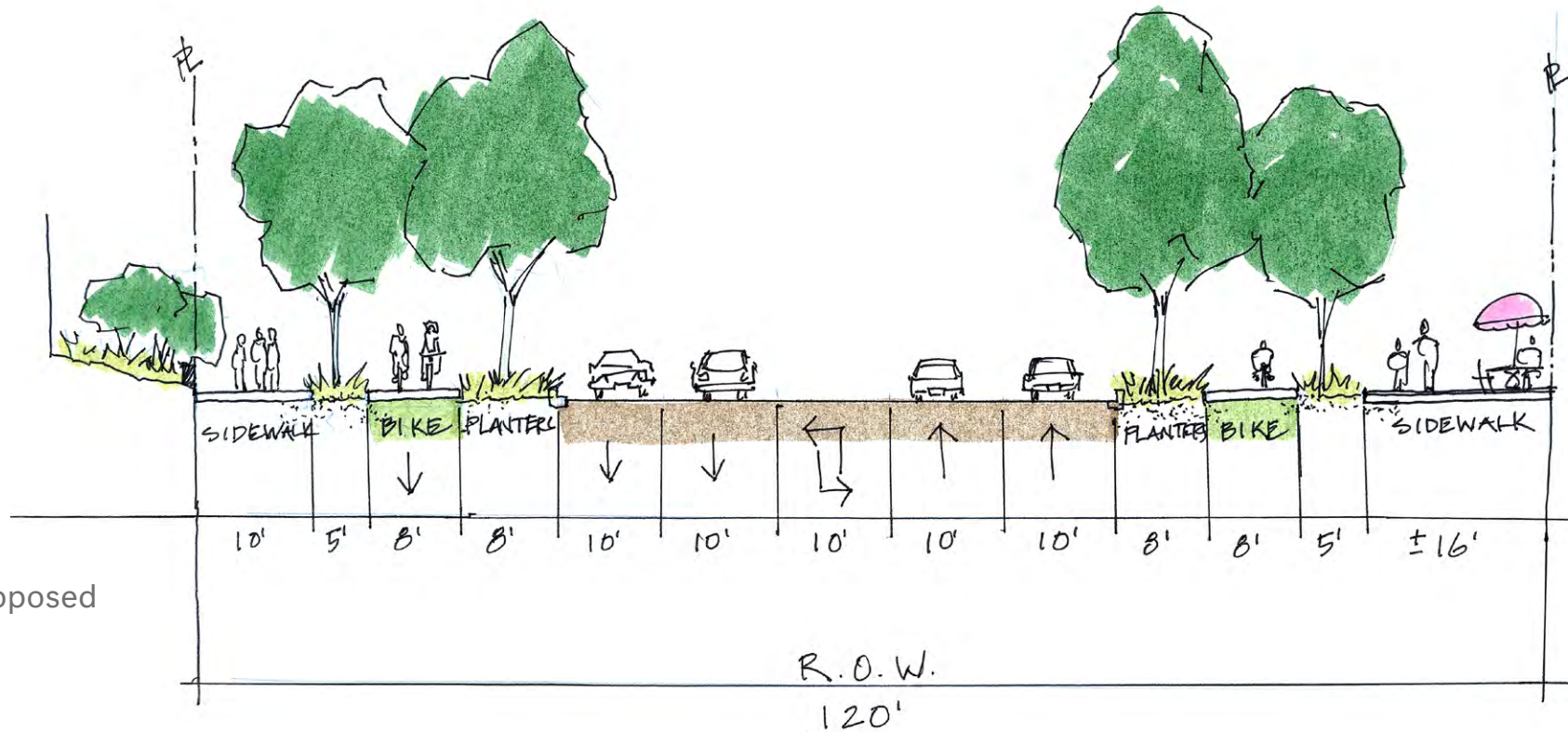



### 3 South Congress Avenue at Barton Springs Road

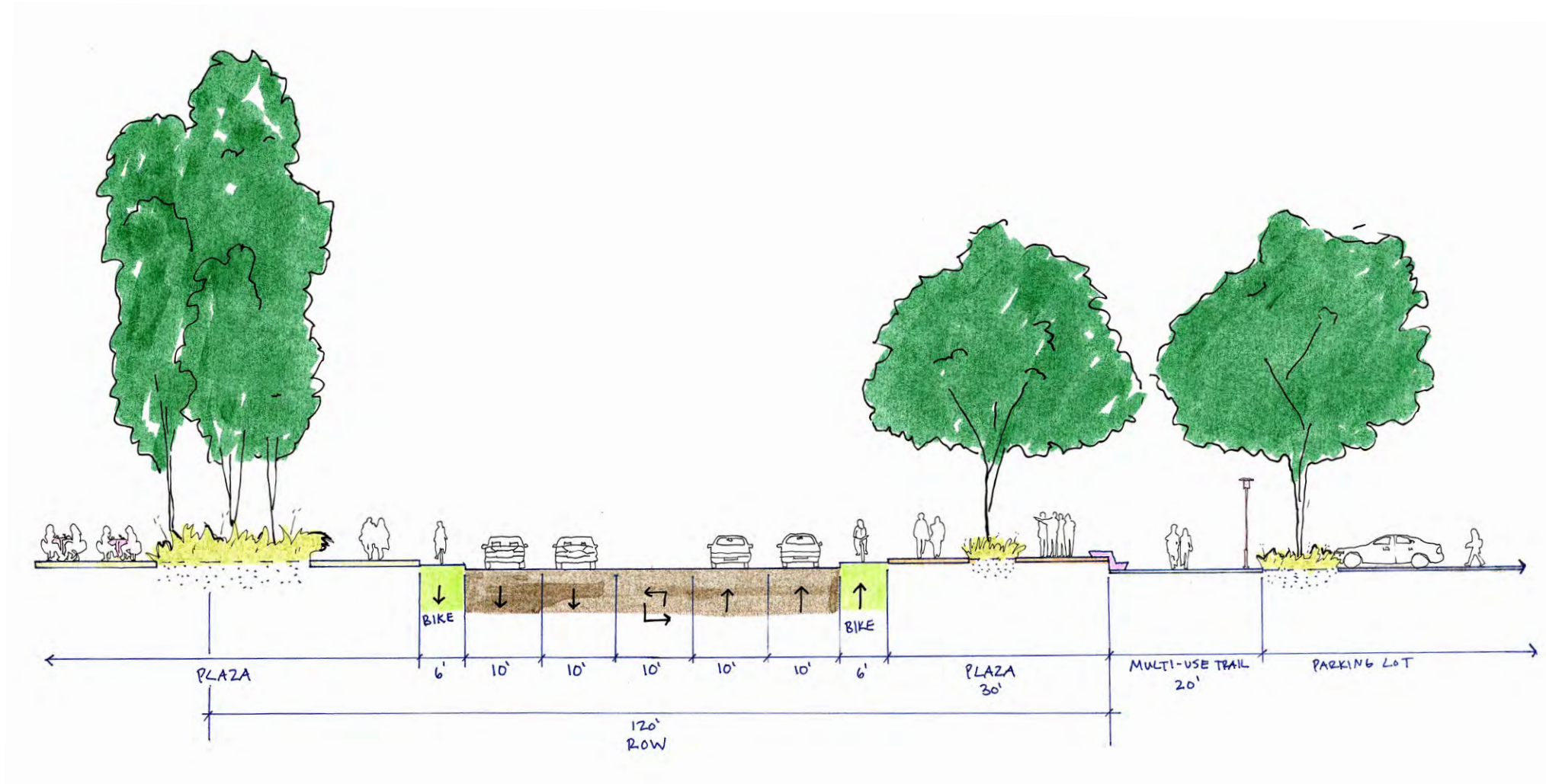

Proposed



### 3 South Congress Avenue at Ann Richards Bridge Overlook

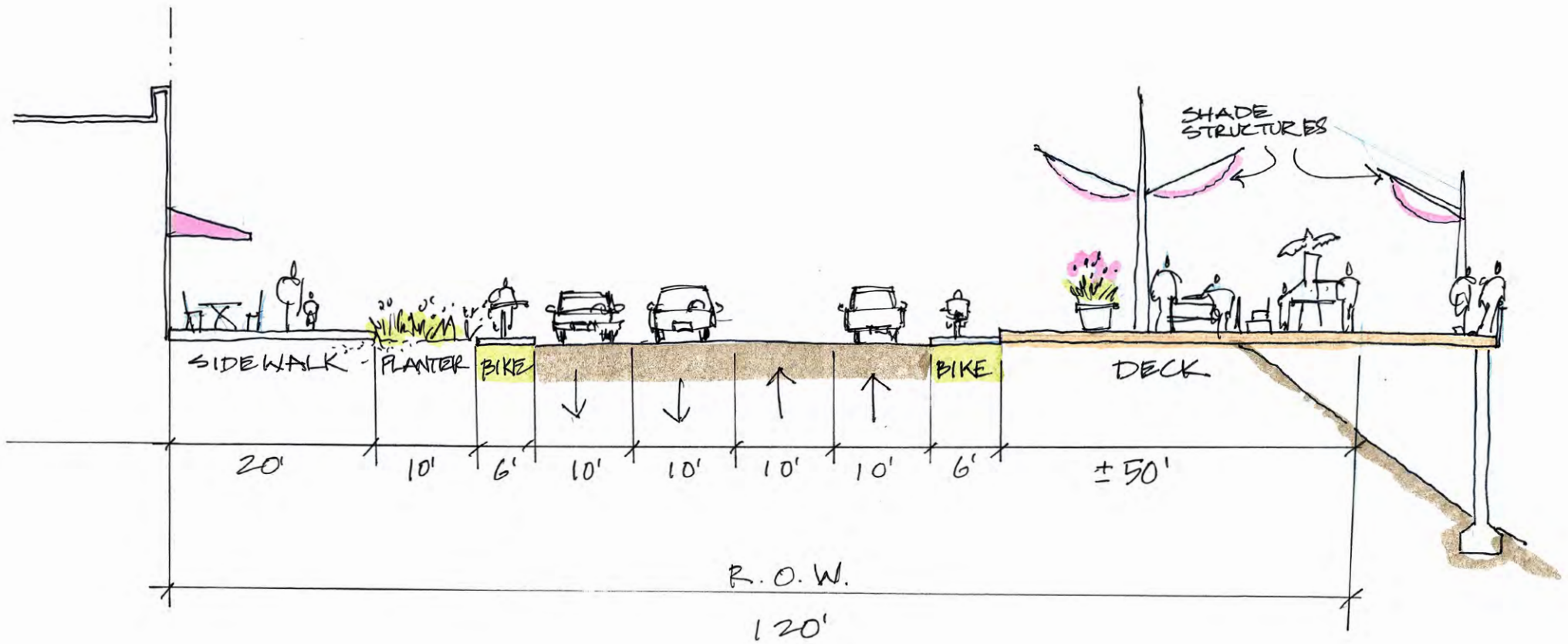

Proposed



### ③ South Congress Avenue





### 3 South Congress Avenue





### 3 South Congress Avenue





### 3 South Congress Avenue





## 4 Statesman Open Space

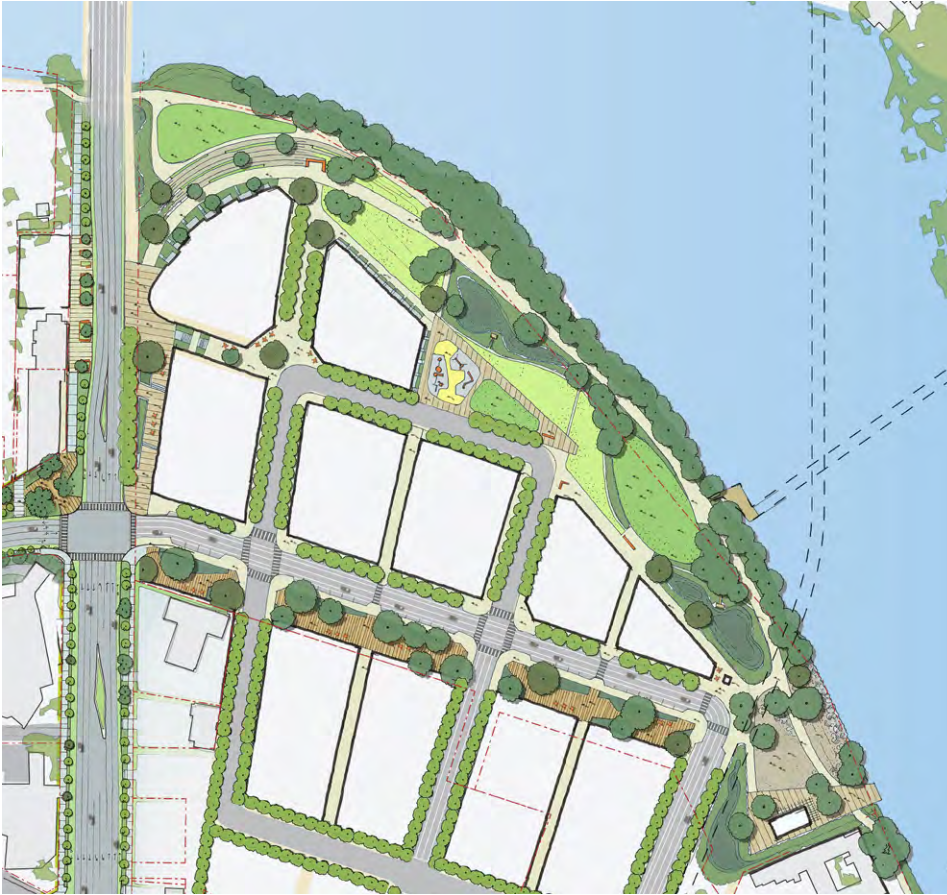

Option 1:

- Create Flush Condition at Congress Avenue
- Community Program Spaces Integrated into Waterfront Park
- Subtle Connection to Proposed Pontoon Bridge
- Large Beach & Park Pavilion
- Residential Facing Waterfront Park



Option 2:

- Retains Existing Grade Change
- Passive Program Spaces
- Strong Connection to Proposed Pontoon Bridge
- Large Connected Stormwater Biofiltration Pond
- Retail/Commercial Facing the Waterfront Park



## ④ Statesman Open Space





## ④ Statesman Open Space





## ④ Statesman Open Space





Option 1



## Concept Plan Summary

- Create Flush Condition at Congress Avenue
- Community Program Spaces Integrated into Waterfront Park
- Subtle Connection to Proposed Pontoon Bridge
- Large Beach & Park Pavilion
- Residential Facing Waterfront Park

## Stormwater Treatment Strategy



Option 2



## Concept Plan Summary

- Retains Existing Grade Change
- Passive Program Spaces
- Strong Connection to Proposed Pontoon Bridge
- Large Connected Stormwater Biofiltration Pond
- Retail/Commercial Facing the Waterfront Park

Incorporate incubator retail/restaurant in commercial spaces along waterfront park i.e. Fort Bend

could also be outdoor stalls

Civic anchor

Turning ramp here

Concept Section

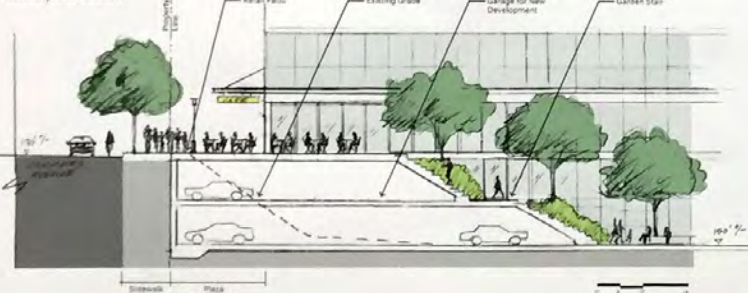

Smart use of space for parking a la Lyon, FR

Concept Section

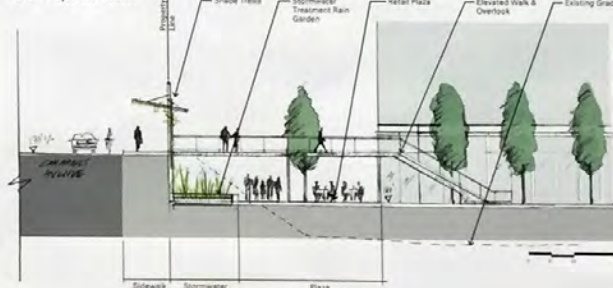

Like the separation of functions here

Inspirational Images



Inspirational Images





# COMMENTS

Option 1

- Fill Abutment to Create Flush Plaza

- Provide Unique Waterfront Compatible Retail at Top of Bank

- Green Amphitheater with Visual Openness

- Create an Interim Bat Overlook- Temporary/Hybrid

- Verify Scale of Multi-Use Trail.

- Provide Intimate Spaces

- Preserve Tree Canopy. Clear Bat "Swoop Zone"

- Provide Controlled Water Access Points

- Opportunity for Unique, Dynamic Waterfront Experience

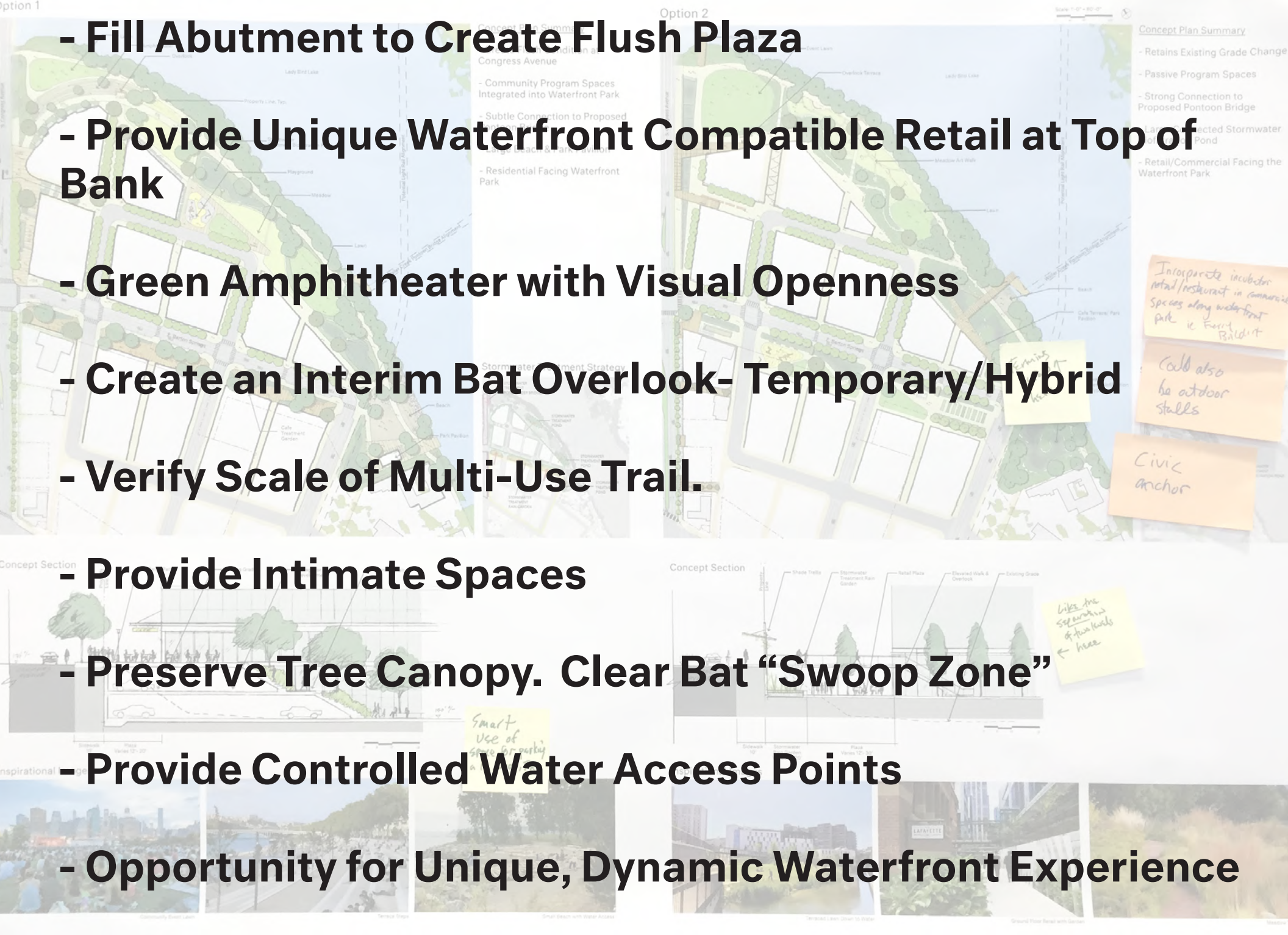



# DYNAMIC WATERFRONT GRADIENT





## 4 Statesman Open Space





## 4 Statesman Open Space VISION

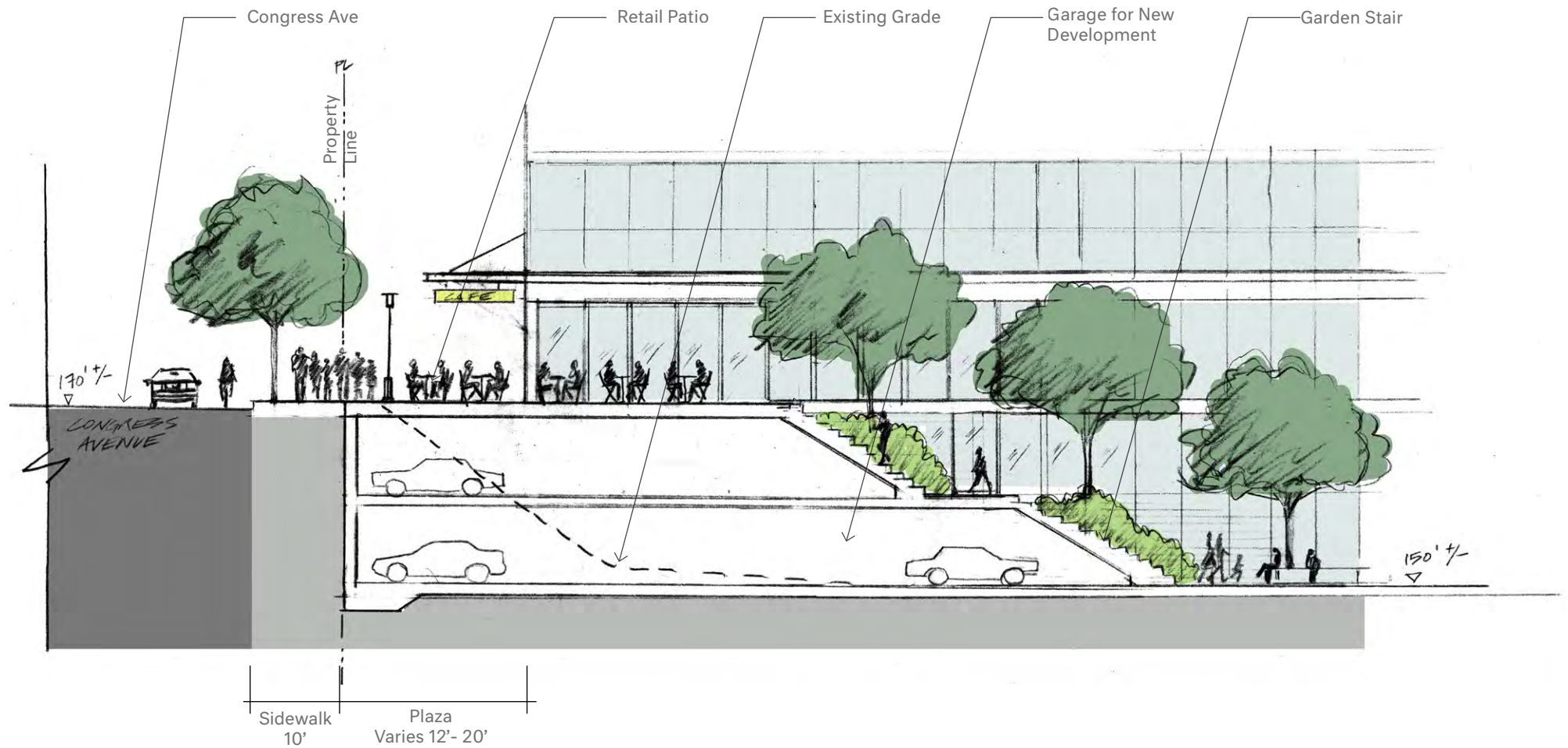



## 4 Statesman Open Space INTERIM STRATEGY

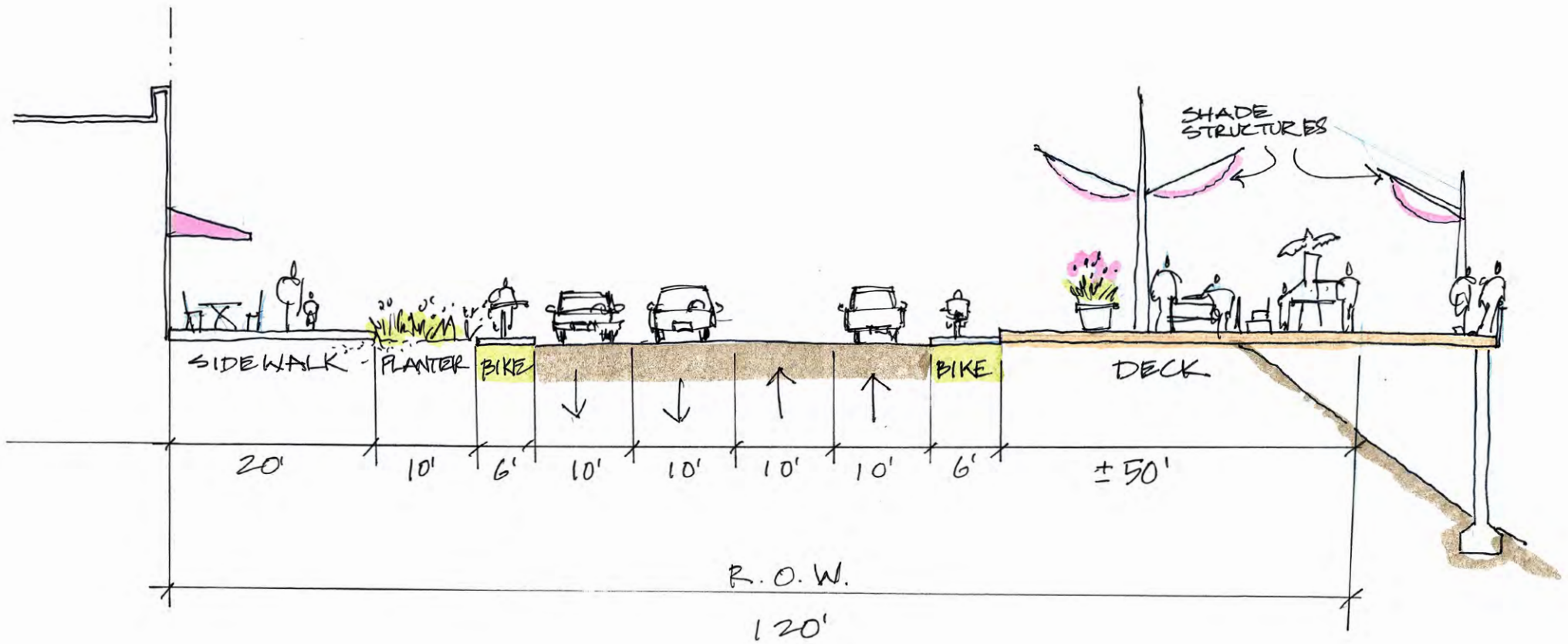



## 4 Statesman Open Space





## 4 Statesman Open Space





## 4 Statesman Open Space





## 4 Statesman Open Space





## 5 Barton Springs Road (East)



Option 1:

- Large Stormwater Treatment Cooling Garden. Unique Character
- Retail/Commercial Patio Spaces

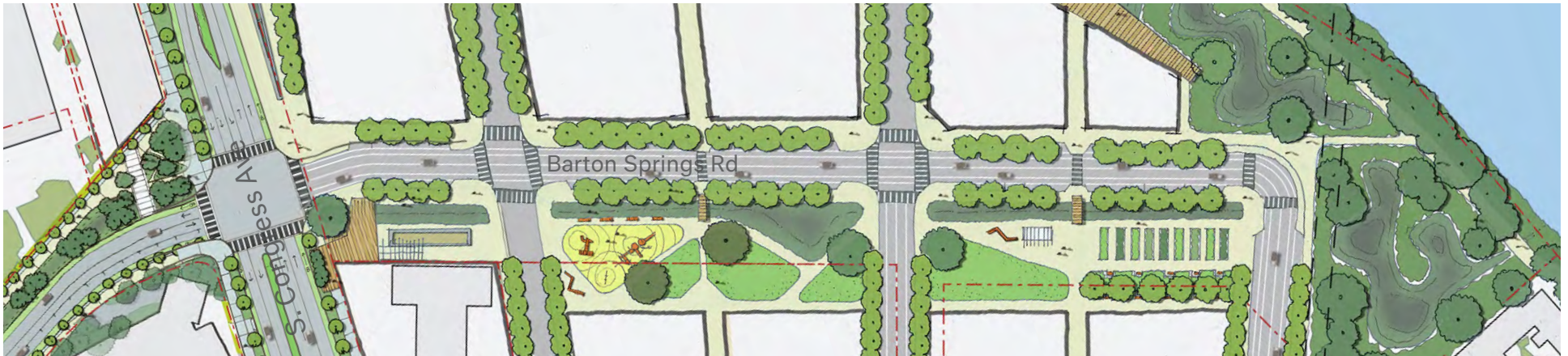

Option 2:

- Community Park with Neighborhood Serving Program
- Adjacent Residential Uses



## 5 Barton Springs Road (East)





# Barton Springs Road East

# COMMENTS

Option 1



## Stormwater Treatment Strategy



## Concept Plan Summary

- Large Stormwater Treatment Cooling Garden. Unique Character
- Retail/Commercial Patio Spaces

WATERFRONT EDGE

## Inspirational Images



Option 2



## Stormwater Treatment Strategy



## Concept Plan Summary

- Community Park with Neighborhood Serving Program
- Adjacent Residential Uses

## Inspirational Images





# COMMENTS

- Coordinate Phasing with Parcel Owners
- Create a Retail Gradient from Congress to Waterfront
- Coordinate Waller Creek Pontoon Bridge--Shift South
- Make Linear Park a Civic Square
- Design Civic Square to be Flexible and to be an Area of Refuge
- Maximize Local Character. Support Local Businesses. Include Incubator Spaces.
- Design a Flexible Roadway to allow for Festivals, Markets, and Day-to-Day Needs
- Explore Shared Streets Concepts



## 5 Barton Springs Road (East)





## 5 Barton Springs Road (East) TOWN SQUARE





5 Barton Springs Road (East)

