

A

APPENDIX A: PLANT LIST

This Plant Material List is intended to provide a broad range of choices to create a healthy, vibrant and diverse landscape palette. This list is not meant to be exclusive; 80 percent of the plantings in the Mueller community should be selected from this list. However, the list should also be periodically reviewed and updated, not to limit, but rather expand, the potential range of suitable choices.

This plant list incorporates all plant materials recommended in the City of Austin “Preferred Plant List” and the Grow Green Native and Adapted Landscape Plants Guide (August 2003), with the exception of certain invasive species. Plants noted with an asterisk (*) are included in the Grow Green Native and Adapted Landscape Plants. Grow Green is a partnership between the City of Austin Watershed Protection and Development Review Department and the Texas Cooperative Extension, in cooperation with local nurseries. Their guide to native and adapted landscape plants was created to help one choose plants that will thrive in the Austin environment and aid in preserving water and water quality. The guide includes information such as physical characteristics, water and light requirements, and more, for each plant. It is available free of charge at many area nurseries (see www.growgreen.org for additional information).



Southern Live Oak (Quercus virginiana)



Lacebark Elm (Ulmus parvifolia)



Shumard Oak (Quercus shumardii)



Crape Myrtle (Lagerstroma var.)



Cedar Elm (Ulmus crassifolia)



American Sweetgum (Liquidambar styraciflua)

Major Street Trees



Pecan (Carya illinoensis)

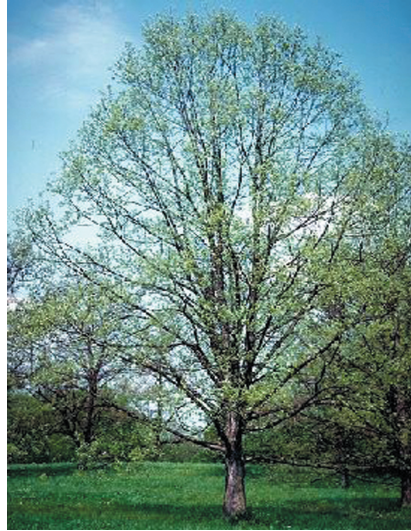

Chinguapin Oak (Quercus muhlenbergii)



Bur Oak (Quercus macrocarpa)



Texas Red Oak (Quercus texana)

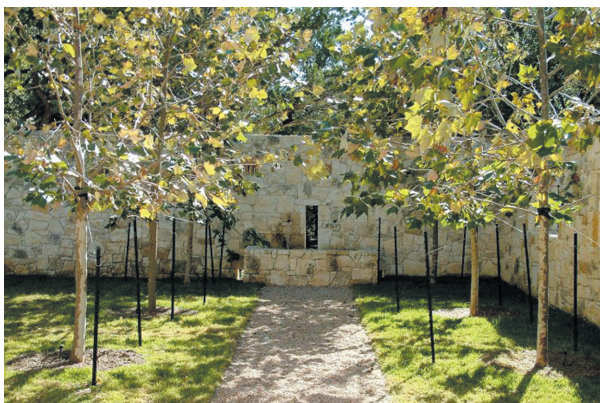

Mexican Sycamore (Platanus texana)



Texas Redbud (Cercis canadensis var. texensis)

Other Potential Street Trees

| Botanical Name | Common Name | Ht. x Spd. | Min. Size | Drought Tolerant | Native | Comments |
|----------------------------------|----------------------|------------|-----------|------------------|--------|--------------------------------|
| Deciduous Trees | | | | | | |
| Acacia farnesiana | Huisache | 20' x 20' | 8' ht. | yes | yes | |
| Acer grandidentatum* | Bigtooth Maple | 30' x 20' | 2" cal. | yes | yes | |
| Acer palmatum | Japanese Maple | 15' x 10' | 6' ht. | no | no | Specimen or container use only |
| Aesculus pavia* | Red Buckeye | 10' x 20' | 8' ht. | yes | yes | |
| Bauhinia congesta* | Anacacho Orchid Tree | 6' x 12' | 8' ht. | yes | no | |
| Carya illinoensis* | Pecan | 50' x 50' | 2" cal. | yes | yes | |
| Cercis canadensis var. mexicana* | Mexican Redbud | 20' x 15' | 8' ht. | yes | yes | |
| Cercis canadensis var. texensis* | Texas Redbud | 20' x 15' | 8' ht. | yes | yes | |
| Chilopsis linearis* | Desert Willow | 20' x 15' | 8' ht. | yes | yes | |
| Cornus drummondii* | Roughleaf Dogwood | 20' x 15' | 8' ht. | yes | yes | |
| Cotinus obovatus* | Smoke Tree | 12' x 8' | 8' ht. | yes | yes | |
| Diospyros texana* | Texas Persimmon | 15' x 10' | 8' ht. | yes | yes | |
| Fraxinus cuspidata | Fragrant Ash | 10' x 15' | 8' ht. | yes | yes | |
| Fraxinus texensis* | Texas Ash | 50' x 40' | 2" cal. | yes | yes | |
| Ilex decidua* | Possumhaw Holly | 20' x 12' | 8' ht. | yes | yes | |
| Juglans major | Arizona Walnut | 40' x 50' | 8' ht. | yes | yes | |
| Juglans microcarpa | Little Walnut | 20' x 30' | 8' ht. | yes | yes | |
| Juglans nigra | Eastern Walnut | 70' x 80' | 8' ht. | yes | yes | |
| Lagerstroemia indica* | Crape Myrtle | 25' x 15' | 8' ht. | yes | no | |
| Leucaena retusa* | Goldenball Leadtree | 20' x 15' | 8' ht. | yes | yes | |
| Liquidambar styraciflua | Sweet Gum | 40' x 25' | 2" cal. | yes | yes | |

*Green Grow Native and Adapted Landscape Plants

| Botanical Name | Common Name | Ht. x Spd. | Min. Size | Drought Tolerant | Native | Comments |
|-------------------------------------|-------------------------|------------|-----------|------------------|--------|--------------------------------|
| Magnolia soulangiana | Saucer Magnolia | 30' x 25' | 8' ht. | no | no | Ornamental accent use only |
| Parkinsonia aculeata* | Retama | 25' x 20' | 8' ht. | yes | yes | |
| Pistacia texana* | Texas Pistache | 20' x 15' | 12' ht. | yes | yes | |
| Platanus occidentalis var. glabrata | Texas Sycamore | 70' x 40' | 2" cal. | yes | yes | |
| Platanus texana | Mexican Sycamore | 60' x 40' | 2" cal. | yes | yes | |
| Prosopis glandulosa* | Honey Mesquite | 25' x 30' | 8' ht. | yes | yes | |
| Prunus mexicana* | Mexican Plum | 20' x 15' | 8' ht. | yes | yes | |
| Prunus persica | Flowering Peach | 15' x 10' | 8' ht. | yes | no | Ornamental accent use only |
| Prunus serotina var. eximia* | Escarpment Black Cherry | 20' x 30' | 8' ht. | yes | yes | |
| Quercus glaucooides / laceyi* | Lacey Oak | 20' x 40' | 2" cal. | yes | yes | |
| Quercus macrocarpa* | Bur Oak | 75' x 50' | 2" cal. | yes | yes | |
| Quercus marilandica | Blackjack Oak | 50' x 60' | 2" cal. | yes | yes | |
| Quercus muhlenbergii* | Chinquapin Oak | 60' x 30' | 2" cal. | yes | yes | |
| Quercus polymorpha* | Mexican White Oak | 40' x 30' | 2" cal. | yes | yes | |
| Quercus shumardii* | Shumard Oak | 60' x 40' | 3" cal. | yes | yes | |
| Quercus sinuata | Durand Oak | 50' x 70' | 2" cal. | yes | yes | |
| Quercus sinuata brevifolia | Shin Oak | 30' x 35' | 2" cal. | yes | yes | |
| Quercus stellata | Post Oak | 50' x 75' | 2" cal. | yes | yes | |
| Quercus texana* | Texas Red Oak | 25' x 15' | 3" cal. | yes | yes | |
| Rhamnus caroliniana* | Carolina Buckthorn | 20' x 15' | 8' ht. | yes | yes | |
| Rhus copallina / lanceolata* | Flameleaf Sumac | 15' x 20' | 8' ht. | yes | yes | |
| Salix babylonica | Weeping Willow | 30' x 25' | 2" cal. | no | no | Park wetland and pond use only |

*Green Grow Native and Adapted Landscape Plants

| Botanical Name | Common Name | Ht. x Spd. | Min. Size | Drought Tolerant | Native | Comments |
|--------------------------|------------------------|------------|-----------|------------------|--------|--|
| Salix nigra | Black Willow | 50' x 40' | 2" cal. | no | yes | Park wetland and pond use only |
| Sapindus drummondii* | Soapberry | 30' x 25' | 8' ht. | yes | yes | |
| Sophora affinis* | Eve's Necklace | 20' x 30' | 8' ht. | yes | yes | |
| Taxodium distichum* | Bald Cypress | 75' x 50' | 2" cal. | yes | yes | Dutch Elm Disease resistant cultivars only |
| Taxodium mucronatum* | Montezuma Cypress | 75' x 50' | 2" cal. | yes | yes | |
| Ulmus americana | American Elm | 60' x 40' | 2" cal. | no | yes | |
| Ulmus crassifolia* | Cedar Elm | 50' x 35' | 2" cal. | yes | yes | |
| Ulmus parvifolia* | Chinese / Lacebark Elm | 30' x 20' | 2" cal. | yes | no | |
| Ulmus parvifolia 'Drake' | Drake Elm | 30' x 20' | 2" cal. | yes | no | |
| Ungnadia speciosa* | Mexican Buckeye | 20' x 15' | 8' ht. | yes | yes | |

Evergreen Trees

| | | | | | |
|----------------------------------|---------------------|-----------|---------|-----|-----|
| Arbutus texana | Texas Madrone | 25' x 30' | 6' ht. | yes | yes |
| Cedrus deodara | Deodar Cedar | 30' x 15' | 12' ht. | yes | no |
| Cupressus arizonica* | Arizona Cypress | 30' x 20' | 8' ht. | yes | yes |
| Cupressus sempervirens | Italian Cypress | 25' x 10' | 8' ht. | yes | no |
| Eriobotrya japonica | Loquat | 15' x 10' | 6' ht. | no | no |
| Ilex vomitoria* | Yaupon Holly | 20' x 12' | 8' ht. | yes | yes |
| Juniperus chinensis 'Blue Point' | Blue Point Juniper | 15' x 5' | 4' ht. | yes | no |
| Myrica cerifera* | Southern Wax Myrtle | 10' x 8' | 6' ht. | yes | yes |
| Pinus eldarica | Afghan Pine | 50' x 25' | 8' ht. | yes | no |
| Pinus pinea | Italian Stone Pine | 80' x 40' | 8' ht. | yes | no |

*Green Grow Native and Adapted Landscape Plants

| Botanical Name | Common Name | Ht. x Spd. | Min. Size | Drought Tolerant | Native | Comments |
|---|------------------------|------------|-----------|------------------|--------|--------------------------------|
| <i>Pinus thunbergii</i> | Japanese Black Pine | 50' x 25' | 8' ht. | yes | no | |
| <i>Prunus caroliniana</i> * | Cherry Laurel | 25' x 15' | 6' ht. | yes | yes | |
| <i>Quercus fusiformis</i> * | Escarpment Live Oak | 50' x 50' | 2" cal. | yes | yes | |
| <i>Quercus virginiana</i> * | Southern Live Oak | 50' x 50' | 3" cal. | yes | yes | |
| <i>Sophora secundiflora</i> * | Texas Mountain Laurel | 20' x 10' | 6' ht. | yes | yes | |
| Evergreen Shrubs | | | | | | |
| <i>Abelia grandiflora</i> * | Glossy Abelia | 6' x 6' | 4' o.c. | yes | no | |
| <i>Abelia grandiflora</i> , dwarf varieties | Dwarf Abelia | 3' x 3' | 3' o.c. | yes | no | 'Edward Goucher', 'Sherwoodii' |
| <i>Agave</i> spp.* | Agave | 4' x 6' | 5' o.c. | yes | yes | |
| <i>Artemisia</i> x 'Powis Castle'* | Powis Castle Artemisia | 1' x 4' | 3' o.c. | yes | no | |
| <i>Berberis trifoliata</i> * | Agarita | 4' x 4' | 3' o.c. | yes | yes | |
| <i>Cotoneaster glaucophylla</i> * | Grayleaf Cotoneaster | 3' x 5' | 3' o.c. | yes | no | |
| <i>Cotoneaster</i> spp.* | Cotoneaster | 3' x 5' | 3' o.c. | yes | no | |
| <i>Cycas revoluta</i> | King Sago | 6' x 4' | 5' o.c. | no | no | Specimen or container use only |
| <i>Dasyilirion texana</i> * | Texas Sotol | 4' x 4' | 4' o.c. | yes | yes | |
| <i>Dietes bicolor</i> * | Yellow Fortnight Iris | 3' x 3' | 3' o.c. | yes | no | |
| <i>Elaeagnus pungens</i> * | Elaeagnus | 15' x 8' | 5' o.c. | yes | no | |
| <i>Fatsia japonica</i> | Fatsia | 4' x 4' | 3' o.c. | no | no | Specimen or container use only |
| <i>Feijoa sellowiana</i> | Pineapple Guava | 6' x 6' | 5' o.c. | yes | no | |
| <i>Hesperaloe parviflora</i> * | Red Yucca | 4' x 4' | 3' o.c. | yes | yes | |
| <i>Ilex cornuta</i> 'Burfordii'* | Burford Holly | 8' x 5' | 5' o.c. | yes | no | |

*Green Grow Native and Adapted Landscape Plants

| Botanical Name | Common Name | Ht. x Spd. | Min. Size | Drought Tolerant | Native | Comments |
|---------------------------------------|-------------------------------|------------|-----------|------------------|--------|--|
| Ilex cornuta 'Burfordii Nana' | Dwarf Burford Holly | 6' x 4' | 3' o.c. | yes | no | |
| Ilex cornuta 'Rotunda Nana' * | Dwarf Chinese Holly | 4' x 3' | 3' o.c. | yes | no | |
| Ilex vomitoria 'Nana'* | Dwarf Yaupon | 2' x 2' | 2' o.c. | yes | no | |
| Jasminum floridum | Florida Jasmine | 3' x 4' | 4' o.c. | yes | no | |
| Jasminum mesnyi* | Primrose Jasmine | 8' x 8' | 5' o.c. | yes | no | |
| Juniperus chinensis 'Parsonii' | Parsons Juniper | 2' x 3' | 3' o.c. | yes | no | |
| Juniperus chinensis 'Sea Green' | Sea Green Juniper | 5' x 6' | 4' o.c. | yes | no | |
| Juniperus conferta | Shore Juniper | 1.5' x 8' | 6' o.c. | yes | no | |
| Juniperus horizontalis cultivars | Andorra Juniper | 2' x 4' | 3' o.c. | yes | no | |
| Leucophyllum frutescens* | Texas Sage | 5' x 4' | 4' o.c. | yes | yes | |
| Loropetalum spp. | Loropetalum | 8' x 5' | 4' o.c. | yes | no | |
| Mahonia bealei | Leatherleaf Mahonia | 4' x 3' | 3' o.c. | no | no | |
| Myrica pusilla | Dwarf Wax Myrtle | 4' x 4' | 3' o.c. | yes | yes | |
| Nandina domestica, dwarf varieties* | Nandina, dwarf varieties only | 3' x 2' | 3' o.c. | yes | no | 'Compacta Nana', 'Gulf Stream', 'Harbour Dwarf', 'Moonbay' |
| Nerium oleander* | Oleander | 15' x 10' | 6' o.c. | yes | no | |
| Nolina texana* | Sacahuista, Bear Grass | 2' x 3' | 3' o.c. | yes | yes | |
| Opuntia engelmannii var. lindheimeri* | Prickly Pear Cactus | 3' x 3' | 3' o.c. | yes | yes | |
| Raphiolepis indica | Indian Hawthorn | 4' x 4' | 3' o.c. | no | no | |
| Rhus virens* | Evergreen Sumac | 12' x 8' | 8' o.c. | yes | yes | |
| Rosa spp.* | Rose | varies | NA | yes | varies | |
| Rosmarinus officinalis* | Upright Rosemary | 4' x 5' | 3' o.c. | yes | no | |
| Rosmarinus officinalis 'prostratus' | Prostrate Rosemary | 2' x 5' | 3' o.c. | yes | no | |

*Green Grow Native and Adapted Landscape Plants

| Botanical Name | Common Name | Ht. x Spd. | Min. Size | Drought Tolerant | Native | Comments |
|---------------------------------------|--------------------|------------|-----------|------------------|--------|--------------------------------|
| <i>Sabal minor</i> * | Dwarf Palmetto | 5' x 5' | 4' o.c. | no | yes | Park wetland and pond use only |
| <i>Viburnum suspensum</i> * | Sandankwa Viburnum | 6' x 6' | 4' o.c. | no | no | |
| <i>Yucca pallida</i> * | Paleleaf Yucca | 1' x 2' | 2' o.c. | yes | yes | |
| <i>Yucca pendula / recurvifolia</i> * | Softleaf Yucca | 5' x 3' | 3' o.c. | yes | yes | |
| <i>Yucca rupicola</i> * | Twisted Leaf Yucca | 2' x 2' | 2' o.c. | yes | yes | |

Semi-evergreen Shrubs

| | | | | | | |
|---------------------------|--------------------|---------|---------|-----|-----|--|
| <i>Dalea bicolor</i> | Dalea | 3' x 3' | 3' o.c. | yes | yes | |
| <i>Malpighia glabra</i> * | Barbados Cherry | 3' x 2' | 2' o.c. | yes | yes | |
| <i>Salvia greggii</i> * | Cherry Sage | 3' x 3' | 3' o.c. | yes | yes | |
| <i>Salvia melissodora</i> | Grape-Scented Sage | 3' x 3' | 3' o.c. | yes | yes | |
| <i>Salvia x superba</i> | Blue Queen Sage | 3' x 3' | 3' o.c. | yes | yes | |

Deciduous Shrubs

| | | | | | | |
|--|------------------------------------|---------|---------|-----|-----|--------------------------|
| <i>Ageratina havanense</i> * | White Mistflower / Boneset | 5' x 3' | 3' o.c. | yes | yes | |
| <i>Anisacanthus quadrifidus</i> var. <i>wrightii</i> * | Flame Acanthus | 3' x 3' | 3' o.c. | yes | yes | |
| <i>Berberis thunbergii</i> | Japanese Barberry | 4' x 4' | 3' o.c. | yes | no | |
| <i>Berberis thunbergii</i> 'Atropurpurea' | Red Leaf Japanese Barberry | 5' x 5' | 4' o.c. | yes | no | |
| <i>Berberis thunbergii</i> , dwarf varieties | Japanese Barberry, dwarf varieties | 2' x 2' | 2' o.c. | yes | no | 'Crimson Pygmy', 'Aurea' |
| <i>Buddleja davidii</i> * | Butterfly Bush | 5' x 5' | 4' o.c. | yes | no | |
| <i>Buddleja marrubifolia</i> * | Wooly Butterfly Bush | 6' x 6' | 5' o.c. | yes | yes | |
| <i>Callicarpa americana</i> * | American Beautyberry | 6' x 6' | 5' o.c. | yes | yes | |

*Green Grow Native and Adapted Landscape Plants

| Botanical Name | Common Name | Ht. x Spd. | Min. Size | Drought Tolerant | Native | Comments |
|------------------------------------|---------------------|------------|-----------|------------------|--------|--------------------------------|
| Capsicum annuum* | Chile Pequin | 3' x 3' | 2' o.c. | yes | yes | |
| Cassia corymbosa* | Flowering Senna | 8' x 6' | 5' o.c. | yes | no | |
| Cassia lindheimeriana | Lindheimer's Cassia | 2' x 3' | 2' o.c. | yes | yes | |
| Cephalanthus occidentalis | Button Bush | 8' x 10' | 6' o.c. | yes | yes | Park wetland and pond use only |
| Chaenomeles speciosa | Flowering Quince | 6' x 6' | 5' o.c. | no | no | |
| Dalea frutescens* | Black Dalea | 2' x 4' | 3' o.c. | yes | yes | |
| Eupatorium coelestinum* | Blue Mistflower | 3' x 3' | 3' o.c. | yes | yes | |
| Eysenhardtia texana* | Kidneywood | 10' x 6' | 6' o.c. | yes | yes | |
| Hamamelis virginiana | Witch Hazel | 10' x 8' | 6' o.c. | yes | yes | |
| Hibiscus syriacus | Althea | 10' x 6' | 5' o.c. | no | no | |
| Lantana horrida* | Native Lantana | 4' x 4' | 3' o.c. | yes | yes | |
| Malvaviscus arboreus 'Drummondii'* | Turks Cap | 3' x 4' | 3' o.c. | yes | yes | |
| Mimosa borealis* | Fragrant Mimosa | 4' x 4' | 3' o.c. | yes | yes | |
| Pavonia lasiopetala* | Rock Rose Pavonia | 2' x 3' | 2' o.c. | yes | yes | |
| Philadelphus coronarius* | Mock Orange | 10' x 8' | 6' o.c. | yes | no | |
| Punica granatum* | Pomegranate | 10' x 6' | 4' o.c. | yes | no | |
| Rhus aromatica* | Aromatic Sumac | 6' x 4' | 5' o.c. | yes | yes | |
| Salvia regia* | Mountain Sage | 5' x 4' | 3' o.c. | yes | no | |
| Senna lindheimeriana* | Lindheimer Senna | 4' x 4' | 3' o.c. | yes | yes | |
| Symphoricarpos orbiculatus* | Coralberry | 2' x 3' | 3' o.c. | yes | yes | |
| Tecoma stans var. angustata* | Yellow Bells | 4' x 4' | 4' o.c. | yes | yes | |
| Teucrium fruticans* | Bush Germander | 5' x 5' | 5' o.c. | yes | no | |

*Green Grow Native and Adapted Landscape Plants

| Botanical Name | Common Name | Ht. x Spd. | Min. Size | Drought Tolerant | Native | Comments |
|--------------------------------|-----------------------|------------|-----------|------------------|--------|--------------------------------|
| Viburnum dentatum | Arrowwood | 15' x 10' | 8' o.c. | yes | yes | |
| Viburnum rufidulum* | Blackhaw Viburnum | 15' x 10' | 8' o.c. | yes | yes | |
| Evergreen Ground Covers | | | | | | |
| Aspidistra elatior* | Cast Iron Plant | 36" x 24" | 24" o.c. | no | no | |
| Calypocarpus vialis* | Horseherb | 8" ht. | 12" o.c. | yes | yes | |
| Carex perdentata* | Meadow Sedge | 18" x 18" | 12" o.c. | yes | yes | |
| Carex texensis* | Texas Sedge | 8" x 18" | 12" o.c. | yes | yes | |
| Carex tumulicola* | Berkeley Sedge | 12" x 12" | 12" o.c. | yes | no | |
| Chrysactinia mexicana* | Damianita | 24" x 18" | 18" o.c. | yes | yes | |
| Hypericum calycinum | St. John's Wort | 24" x 24" | 24" o.c. | yes | no | |
| Liriope gigantea | Giant Liriope | 24" ht. | 24" o.c. | no | no | |
| Liriope muscari* | Liriope and varieties | 18" ht. | 18" o.c. | no | no | |
| Ophiopogon japonicus* | Monkey Grass | 12" ht. | 12" o.c. | no | no | |
| Oreganum vulgare* | Oregano | 36" x 36" | 36" o.c. | yes | no | |
| Phyla incisa* | Frogfruit | 4" x 12" | 12" o.c. | yes | yes | |
| Rivina humilis* | Pigeonberry | 12" x 24" | 24" o.c. | yes | yes | |
| Ruellia brittoniana 'Katie'* | Katie Dwarf Ruellia | 12" x 12" | 12" o.c. | yes | no | |
| Santolina chamaecyparissus* | Santolina | 12" x 24" | 24" o.c. | yes | no | |
| Sedum nuttallianum* | Sedum | 6" ht. | 12" o.c. | yes | no | |
| Setcreasea pallida* | Purple Heart | 12" ht. | 12" o.c. | yes | no | Specimen or container use only |
| Trachelospermum asiaticum* | Asian Jasmine | 18" ht. | 24" o.c. | yes | no | |

*Green Grow Native and Adapted Landscape Plants

| Botanical Name | Common Name | Ht. x Spd. | Min. Size | Drought Tolerant | Native | Comments |
|--------------------------------|------------------------------|------------|-----------|------------------|--------|--------------------------------|
| Vinca minor* | Littleleaf Periwinkle | 12" ht. | 24" o.c. | yes | no | Do not plant in greenbelts |
| Deciduous Ground Covers | | | | | | |
| Ceratostigma plumbaginoides* | Leadwort Plumbago | 12" ht. | 18" o.c. | yes | no | |
| Dichondra argentea* | Silver Ponyfoot | 4" ht. | 24" o.c. | yes | no | |
| Lantana montevidensis* | Trailing Lantana | 12" x 48" | 36" o.c. | yes | no | |
| Plumbago auriculata* | Blue Plumbago | 36" x 60" | 36" o.c. | yes | no | |
| Stemodia tomentosa* | Wooly Stemodia | 6"x 36" | 24" o.c. | yes | yes | |
| Evergreen Vines | | | | | | |
| Bignonia capreolata* | Crossvine | 50' | NA | yes | yes | |
| Ficus pumila* | Fig Vine | 20' | NA | yes | no | |
| Gelsemium sempervirens* | Yellow Jessamine | 20' | NA | yes | yes | |
| Lonicera sempervirens* | Coral Honeysuckle | 12' | NA | yes | yes | |
| Rosa banksiae* | Lady Banksia Rose | 20' ht. | NA | yes | no | |
| Trachelospermum jasminoides | Confederate Jasmine | 10'-15' | NA | yes | no | |
| Deciduous Vines | | | | | | |
| Antigonon leptopus* | Coral Vine / Rose of Montana | NA | NA | yes | no | |
| Bougainvillea spp. | Bougainvillea | NA | NA | yes | no | Specimen or container use only |
| Campsis radicans* | Trumpet Vine | NA | NA | yes | yes | |
| Clematis spp. | Clematis | NA | NA | yes | yes | |

*Green Grow Native and Adapted Landscape Plants

| Botanical Name | Common Name | Ht. x Spd. | Min. Size | Drought Tolerant | Native | Comments |
|---|------------------------|------------|-----------|------------------|--------|--------------------------------|
| <i>Ipomoea quamoclit</i> | Cypress Vine | | NA | yes | no | |
| <i>Parthenocissus quinquefolia</i> * | Virginia Creeper | 20' | NA | yes | yes | |
| <i>Parthenocissus tricuspidata</i> 'Veitchii' | Boston Ivy | | NA | yes | no | |
| <i>Passiflora incarnata</i> * | Passionflower | 12' | NA | yes | yes | Specimen or container use only |
| <i>Vitis mustangensis</i> | Mustang Grape | 10' | NA | yes | yes | |
| <i>Wisteria macrostachya</i> | Texas Wisteria | 30' | NA | yes | yes | |
| Perennials | | | | | | |
| <i>Achillea millefolium</i> * | Yarrow | 1.5' x 3' | 2' o.c. | yes | no | |
| <i>Agapanthus africanus</i> | Agapanthus | 2' ht. | 2' o.c. | no | no | Specimen or container use only |
| <i>Aquilegia canadensis</i> * | Red Columbine | 3' x 2' | 1' o.c. | yes | yes | |
| <i>Aquilegia chrysantha</i> 'Texas Gold' | Yellow Columbine | 3' x 2' | 1' o.c. | yes | yes | |
| <i>Aquilegia chrysantha</i> x 'Hinkleyana' | Hinkley's Columbine | 3' x 2' | 1' o.c. | yes | yes | |
| <i>Asclepias curassivica</i> * | Mexican Butterfly Weed | 3' x 1' | 1' o.c. | yes | yes | |
| <i>Asclepias tuberosa</i> * | Butterfly Weed | 3' x 1' | 1' o.c. | yes | yes | |
| <i>Aster oblongifolius</i> * | Fall Aster | 3' x 2.5' | 2' o.c. | yes | yes | |
| <i>Bulbine frutescens</i> / <i>caulescens</i> * | Bulbine | 2' x 2.5' | 2' o.c. | yes | yes | |
| <i>Caesalpinia pulcherrima</i> * | Poinciana | 6' x 6' | 5' o.c. | ye | yes | Specimen or container use only |
| <i>Canna</i> spp. | Canna Lily | 4' x 4' | 4' o.c. | no | no | Specimen use only |
| <i>Chrysanthemum leucanthemum</i> | Oxeye Daisy | 3' x 3' | 3' o.c. | yes | yes | |
| <i>Coreopsis lanceolata</i> * | Coreopsis | 2' x 2' | 2' o.c. | yes | yes | |
| <i>Cuphea hyssopifolia</i> | Mexican Heather | 2' x 2' | 2' o.c. | yes | no | |

*Green Grow Native and Adapted Landscape Plants

| Botanical Name | Common Name | Ht. x Spd. | Min. Size | Drought Tolerant | Native | Comments |
|-----------------------------------|----------------------|------------|-----------|------------------|--------|----------|
| Cuphea micropetala* | Cigar Plant | 4' x 3' | 3' o.c. | yes | no | |
| Dalea greggii* | Gregg Dalea | 1' x 3' | 3' o.c. | no | yes | |
| Dietes spp.* | Butterfly Iris | 4' x 3' | 3' o.c. | yes | no | |
| Echinacea purpurea* | Purple Coneflower | 2' x 1.5' | 2' o.c. | yes | yes | |
| Eupatorium wrightii | White Mistflower | 2' x 2' | 2' o.c. | yes | yes | |
| Gaura lindheimeri* | Whirling Butterflies | 3' x 3' | 3' o.c. | yes | yes | |
| Hamelia patens* | Firebush | 2.5' x 3' | 3' o.c. | no | no | |
| Helianthus maximiliana | Maximilian Sunflower | 6' ht. | 3' o.c. | yes | yes | |
| Hemerocallis spp. | Daylilies | 3' ht. | 2' o.c. | yes | no | |
| Hibiscus cardiophyllus | Heartleaf Hibiscus | 1' x 1' | 1' o.c. | yes | yes | |
| Hibiscus coccineus / moscheutos * | Perennial Hibiscus | 4' x 4' | 4' o.c. | yes | no | |
| Hymenoxys / Tetraneuris scaposa* | Hymenoxys | 1' x 1' | 1' o.c. | yes | yes | |
| Ipomoea fistulosa / leptophylla* | Bush Morning Glory | 7' x 7' | 6' o.c. | yes | yes | |
| Iris albicans* | Bearded Iris | 1' x 3' | 3' o.c. | yes | no | |
| Iris spp. | Iris | 2'-5' ht. | 2' o.c. | yes | varies | |
| Justicia brandegeana* | Shrimp Plant | 3' x 4' | 2' o.c. | yes | no | |
| Justicia spicigera* | Mexican Honeysuckle | 2' x 4' | 3' o.c. | yes | no | |
| Lantana x hybrida* | Lantana | 2' x 4' | 3' o.c. | yes | no | |
| Liatris mucronata* | Gayfeather | 2' x 2' | 2' o.c. | yes | yes | |
| Linum pratense | Meadow Flax | 1.5' x 1' | 1.5' o.c. | yes | yes | |
| Lisianthus russelianus | Texas Bluebells | 1' x 1' | 1' o.c. | yes | yes | |
| Lobelia cardinalis | Cardinal Flower | 3' x 2' | 2' o.c. | yes | yes | |

*Green Grow Native and Adapted Landscape Plants

| Botanical Name | Common Name | Ht. x Spd. | Min. Size | Drought Tolerant | Native | Comments |
|--------------------------------------|----------------------|------------|-----------|------------------|--------|----------|
| Melampodium leucanthum* | Blackfoot Daisy | 1' x 2' | 2' o.c. | yes | yes | |
| Monarda fistulosa | Bee Balm | 3' x 4' | 3' o.c. | yes | yes | |
| Nepeta x faassenii 'Six Hills Giant' | Catmint | 4' x 3' | 3' o.c. | yes | yes | |
| Oenothera missouriensis* | Missouri Primrose | 1.5' x 3' | 2' o.c. | yes | yes | |
| Oenothera speciosa | Evening Primrose | 1.5' x 3' | 2' o.c. | yes | yes | |
| Penstemon baccharifolius | Rock Penstemon | 1.5' x 1' | 1' o.c. | yes | yes | |
| Penstemon tenuis | Gulf Coast Penstemon | 1.5' x 1' | 1' o.c. | yes | yes | |
| Penstemon triflorus* | Scarlet Penstemon | 2' x 1.5' | 1' o.c. | yes | yes | |
| Perovskia atriplicifolia* | Russian Sage | 3' x 3' | 3' o.c. | yes | no | |
| Phlomis fruticosa* | Jerusalem Sage | 3' x 3' | 3' o.c. | yes | no | |
| Phlox paniculata* | Garden Phlox | 3' x 2' | 3' o.c. | yes | no | |
| Physostegia virginiana* | Fall Obedient Plant | 3' x 2' | 3' o.c. | yes | yes | |
| Poliomntha longiflora* | Mexican Oregano | 3' x 3' | 3' o.c. | yes | no | |
| Rudbeckia hirta* | Black-eyed Susan | 2' x 2' | 2' o.c. | yes | yes | |
| Salvia coccinea* | Tropical Sage | 3' x 2' | 2' o.c. | yes | yes | |
| Salvia farinacea* | Mealy Blue Sage | 2' x 1.5' | 1.5' o.c. | yes | yes | |
| Salvia guaranitica* | Majestic Sage | 4' x 5' | 4' o.c. | yes | no | |
| Salvia leucantha* | Mexican Bush Sage | 4' x 4' | 4' o.c. | yes | yes | |
| Salvia penstemonoides* | Big Red Sage | 4' x 2' | 2' o.c. | yes | yes | |
| Salvia roemeriana* | Cedar Sage | 2' x 3' | 3' o.c. | yes | yes | |
| Salvia x 'Indigo Spires'* | Indigo Spires Salvia | 3' x 5' | 4' o.c. | yes | no | |
| Scutellaria suffrutescens* | Pink Skullcap | 1' x 2' | 2' o.c. | yes | no | |

*Green Grow Native and Adapted Landscape Plants

| Botanical Name | Common Name | Ht. x Spd. | Min. Size | Drought Tolerant | Native | Comments |
|-----------------------------|-----------------------|------------|-----------|------------------|--------|----------|
| Stachys byzantina* | Lamb's Ear | 2' x 4' | 3' o.c. | yes | no | |
| Stachys coccinea* | Texas Betony | 1' x 3' | 3' o.c. | yes | no | |
| Tagetes lemmonii* | Copper Canyon Daisy | 3' x 4' | 3' o.c. | yes | no | |
| Tagetes lucida* | Mexican Mint Marigold | 2' x 3' | 3' o.c. | yes | no | |
| Thelypteris kunthii* | River Fern | 3' x 3' | 3' o.c. | no | yes | |
| Tradescantia x Andersoniana | Spiderwort | 2' x 2' | 2' o.c. | yes | no | |
| Verbena bipinnatifida* | Prairie Verbena | 1' x 2' | 1.5' o.c. | yes | yes | |
| Verbena peruviana | Peruvian Verbena | 1' x 2' | 1.5' o.c. | yes | no | |
| Verbena tenuisectum | Moss Verbena | 1' x 2' | 1.5' o.c. | yes | yes | |
| Wedelia texana / hispida* | Zexmenia | 2' x 3' | 2' o.c. | yes | yes | |

Ornamental Grasses

| | | | | | | |
|------------------------------|--------------------|-----------|---------|-----|-----|-------------------------|
| Andropogon gerardii* | Big Bluestem | 5' x 3' | 3' o.c. | yes | yes | |
| Andropogon glomeratus* | Bushy Bluestem | 4' x 2' | 3' o.c. | yes | yes | |
| Bambusa spp. | Bamboo | | | no | no | Clumping varieties only |
| Bouteloua curtipendula* | Side Oats Grama | 3' x 2' | 3' o.c. | yes | yes | |
| Bouteloua gracilis | Blue Grama | 1' x 1' | Seed | yes | yes | |
| Chasmanthium latifolium* | Inland Sea Oats | 4' x 8' | 5' o.c. | yes | yes | |
| Cortaderia selloana 'Pumila' | Dwarf Pampas Grass | 6' x 6' | 4' o.c. | yes | no | |
| Elymus canadensis* | Wild Rye | 4' x 4' | 4' o.c. | yes | yes | |
| Muhlenbergia capillaris* | Gulf Muhly | 2.5' x 2' | 2' o.c. | yes | yes | |
| Muhlenbergia dumosa* | Bamboo Muhly | 5' x 4' | 4' o.c. | yes | yes | |

*Green Grow Native and Adapted Landscape Plants

| Botanical Name | Common Name | Ht. x Spd. | Min. Size | Drought Tolerant | Native | Comments |
|---------------------------|-----------------------|------------|-----------|------------------|--------|----------|
| Muhlenbergia lindheimeri* | Big Muhly | 5' x 3' | 5' o.c. | yes | yes | |
| Muhlenbergia reverchonii* | Seep Muhly | 3' x 2' | 2' o.c. | yes | yes | |
| Muhlenbergia rigens* | Deer Muhly | 1' x 1' | 1' o.c. | yes | yes | |
| Pennisetum alopecuroides* | Fountain Grass | 3' x 3' | 3' o.c. | yes | no | |
| Schizachyrium scoparium* | Little Bluestem | 3' x 1.5' | 1.5' o.c. | yes | yes | |
| Sorghastrum nutans* | Indian Grass | 4' x 5' | 4' o.c. | yes | yes | |
| Stipa tenuissima* | Mexican Feather Grass | 2' x 1.5' | 2' o.c. | yes | no | |

Turf Grasses

| | | | | | | |
|--------------------------|-------------------|-------------|--|-----|-----|-------------------|
| Buchloe dactyloides* | Buffalograss | Seed or Sod | | yes | yes | |
| Cynodon dactylon* | Common Bermuda | Seed or Sod | | yes | no | |
| Cynodon spp.* | Bermuda varieties | Sod | | yes | no | |
| Stenotaphrum secundatum* | St. Augustine | Sod | | no | no | Shaded areas only |
| Zoysia japonica* | Zoysia | Seed or Sod | | yes | no | |

*Green Grow Native and Adapted Landscape Plants

| Common Name | Recommended Varieties | Ht. x Spd. | Drought Tolerant | Native | Comments |
|--------------------------|--|------------|------------------|--------|---|
| Edible Plants | | | | | |
| Agarita* | no named varieties | 4' x 4' | yes | yes | |
| Apple | Anna, Dorsette Golden, Ein Shemer, Stark Gala, Mollies Delicious | 30' ht. | no | no | |
| Black Walnut | Thomas | 50' ht. | yes | no | Arizona Walnut or Little Walnut are easy care native alternatives |
| Blackberry | Brazos, Brison, Navaho, Rosborough, Womack, Cheyenne | 4' x 3' | no | no | |
| Escarpment Black Cherry* | no named varieties | 20' x 30' | yes | yes | |
| Fig | Alma, Celeste, Texas Everbearing | 15' ht. | no | no | |
| Grape | Champanel, Black Spanish, Siebel 9110, Fredonia, Mars, Reliance, Suffolk Red | 8' x 8' | no | no | Mustang Grape is easy care native alternative |
| Jujube | Lang, Li | 30' ht. | no | no | |
| Kumquat | Meiwa | 15' ht. | no | no | |
| Loquat | Early Red, Oliver, Advance, Champagne | 20' ht. | no | no | |

**Green Grow Native and Adapted Landscape Plants*

| Common Name | Recommended Varieties | Ht. x Spd. | Drought Tolerant | Native | Comments |
|----------------------|---|------------|------------------|--------|--|
| Mexican Plum* | no named varieties | 20' x 15' | yes | yes | |
| Mulberry | Paradise, Shangri La, Texas Mulberry, White Mulberry, Red Mulberry | 45' ht. | yes | varies | Paper Mulberry is non-native and invasive - do not plant |
| Paw Paw | Mitchell, Overleese, Prolific, Taytoo | 20' ht. | no | no | |
| Peach | Sentinel, Harvester, Redglobe, Redskin, Dixiland, Springgold, Bicentennial, June Gold | 10' ht. | no | no | |
| Pear | Moonglow, Magness, Seckel, Orient, Keiffer, Garber, Leconte, Warran | 20' ht. | no | no | |
| Pecan* | Cheyenne, Choctaw, Sioux, Caddo, Desirable, Kiowa, Podsednik, Shawnee, Western, Wichita | 50' x 50' | yes | yes | |
| Persimmon | Eureka, Fuyu, Hachiya, Tamopan, Tane-nashi | 25' ht. | yes | no | |
| Plum | Allred, Bruce, Methley, Morris, Ozark Premier, Santa Rosa | 15' ht. | no | no | |
| Pomegranate* | Wonderful | 15' x 10' | yes | no | |
| Prickly Pear Cactus* | spineless varieties are easier to handle | 3' x 3' | yes | yes | |
| Strawberry | Sequoia, Tioga, Cardinal | 12" x 12" | no | no | best grown as annual in Texas heat |

*Green Grow Native and Adapted Landscape Plants

