

BASE ASSEMBLY

- 1.) INSTALL BASE ASSEMBLY "A" AROUND POLE BASE.
2.) CENTER POLE WITHIN BASE ASSEMBLY AND MARK
GROUND SURFACE FOR ANCHORING. (BY OTHERS)
3.) RE-INSTALL BASE ASSEMBLIES.
4.) ATTACH BASE ASSEMBLIES TOGETHER USING 4ea:
1/4" FLAT WASHER
1/4" SPLIT LOCK WASHER.
1/4-20 HEX NUT
5.) LEVEL BASE AS REQUIRED USING LEVELING FEET "B"
AND TIGHTEN JAM NUTS.
6.) INSTALL MOUNTING ANCHORS AND PROCEED TO NEXT STEP.

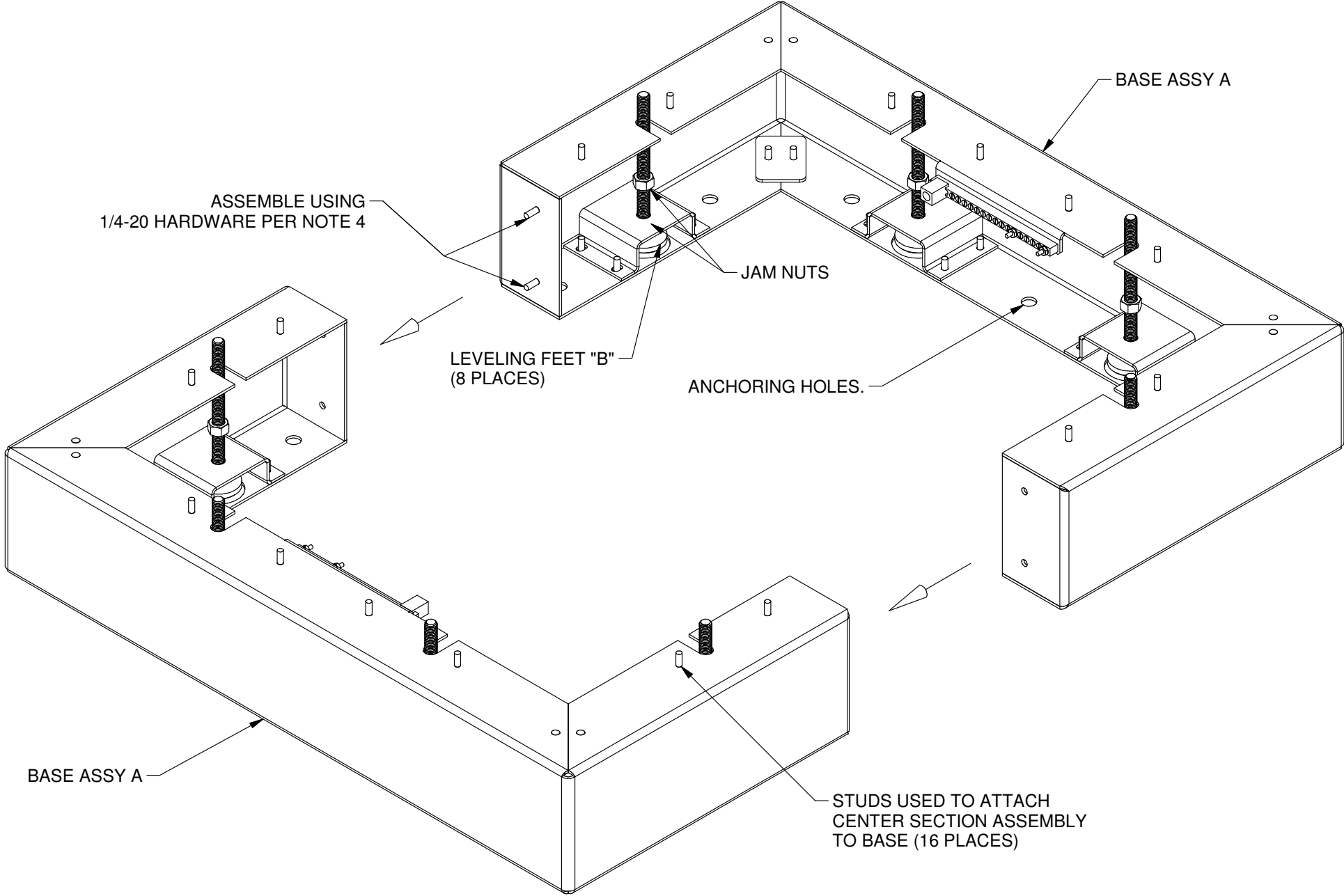

HARDWARE REQUIREMENTS



(4ea) 1/4 STEEL FLAT WASHER



(4ea) 1/4" STEEL SPLIT LOCK WASHER



(4ea) 1/4-20 STEEL HEX NUT

DRAWN RP	5/15/2017	008281 IG		
CHECKED JM	5/15/2017			
QA		TITLE		
MFG RP	5/15/2017	ASSEMBLY, WRAP AROUND, PEDESTAL, INSTALLATION GUIDE		
APPROVED TR	5/15/2017			
		SIZE B	DWG NO ASSEMBLY PROCEDURE	REV A
		SCALE	SHEET 1 OF 5	

CENTER SECTION ASSEMBLY

- 1.) PRE-ASSEMBLE TWO SETS CONSISTING OF THE FOLLOWING PARTS:
2ea CORNER POST "A", 1ea FRAME "B" 1ea FRAME "C"
- 2.) LEAVE LOOSE 2ea FRAME "B" AND FRAME "C" TO BE ASSEMBLED
ON PAGE 3.

HARDWARE REQUIREMENTS

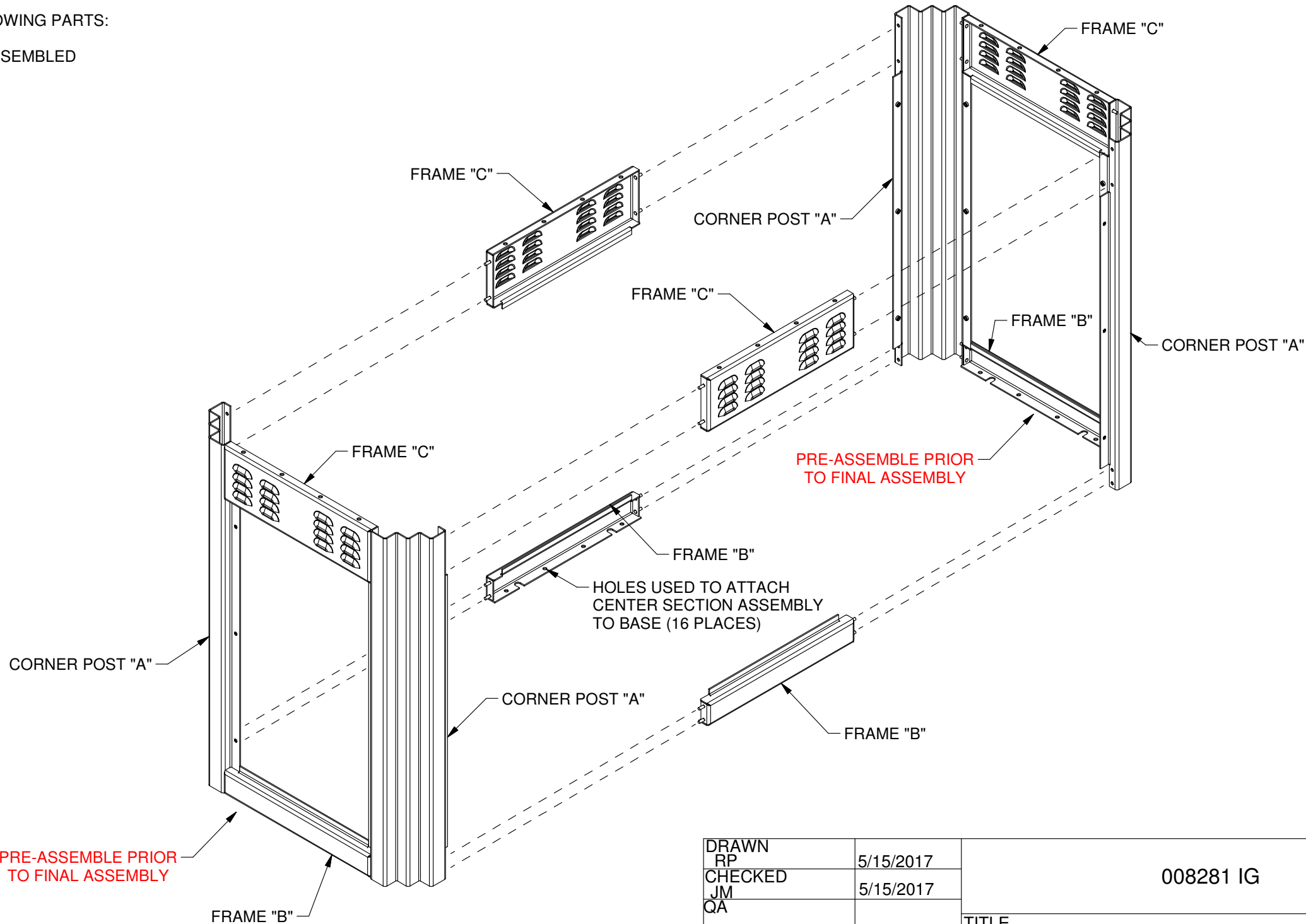
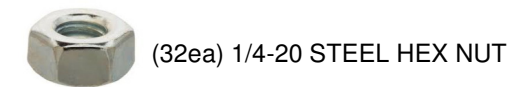
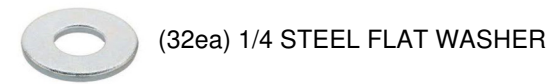

DRAWN	RP	5/15/2017	008281 IG		
CHECKED	JM	5/15/2017			
QA			TITLE		
MFG	RP	5/15/2017	ASSEMBLY, WRAP AROUND, PEDESTAL, INSTALLATION GUIDE		
APPROVED	TR	5/15/2017			
			SIZE	DWG NO	REV
			B	ASSEMBLY PROCEDURE	A
			SCALE	SHEET 2 OF 5	

CENTER SECTION TO BASE ASSEMBLY

- 1.) INSTALL ONE PRE-ASSEMBLE CENTER SECTION FROM PAGE 2 AROUND POLE TO INSTALLED BASE ASSEMBLY (LEAVE LOOSE)
- 2.) INSTALL 2ea FRAME "B" TO BASE ASSEMBLY (LEAVE LOOSE)
- 3.) INSTALL FRAME "C" TO PRE-ASSEMBLED CENTER SECTION AND SECURE IN PLACE.
- 4.) INSTALL REMAINING PRE-ASSEMBLED CENTER SECTION TO BASE AND TO AND TO FRAME "B" AND FRAME "C".
- 5.) USING HARDWARE FROM HARDWARE LIST SECURE ALL FRAME MEMBERS TOGETHER AND TO BASE ASSEMBLY.

HARDWARE REQUIREMENTS



(16ea) 1/4 STEEL FLAT WASHER



(16ea) 1/4" STEEL SPLIT LOCK WASHER



(16ea) 1/4-20 STEEL HEX NUT

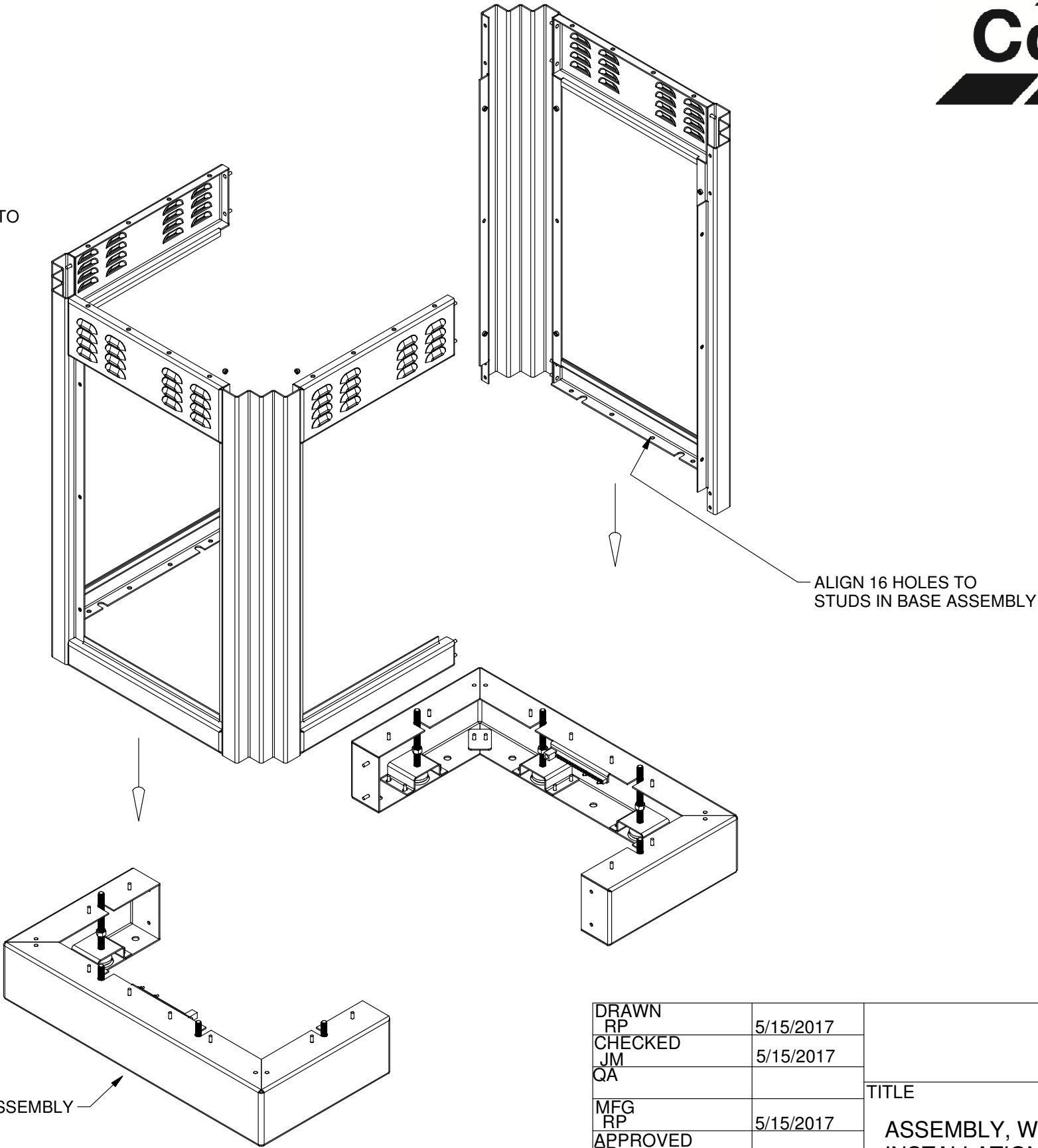

DRAWN RP	5/15/2017	008281 IG		
CHECKED JM	5/15/2017	TITLE ASSEMBLY, WRAP AROUND, PEDESTAL, INSTALLATION GUIDE		
QA				
MFG RP	5/15/2017	SIZE B		
APPROVED TR	5/15/2017			
		SCALE	DWG NO ASSEMBLY PROCEDURE	REV A
		SHEET 3 OF 5		

SLOPE HOOD ASSEMBLY

(TWO HALVES REQUIRED)
(REFERENCE LOCAL CONTRACTOR FOR TOP HOLE DIAMETER)

- 1.) INSERT SLOPE TOP INTO TRIM RING AS SHOWN
LEAVE LOOSE UNTILL FINAL ASSEMBLY ON PAGE 5
(NO HARDWARE REQUIREMENTS NEEDED AT THIS TIME)
- 2.) "HOLE DIAMETER MODIFICATION INSTRUCTIONS (AS REQUIRED)
- HOLE SIZE TO BE CUT TO FIT BASED ON FIELD VERIFICATION OF POLE DIAMETER.
TO FIT, MASK THE ENTIRE TOP SURFACE OF THE SHROUD WITH
MULTIPLE LAYERS OF QUALITY MASKING TAPE.
MARK THE HOLE DIAMETER AND CUT WITH A BI-METAL JIGSAW BLADE.
USE AN ABRASIVE WHEEL OR SANDING WHEEL TO CLEAN AND DEBURR THE EDGE
OF THE HOLE.
PAINT EDGE OF RAW ALUMINUM WITH TOUCH UP PAINT PRIOR TO INSTALLATION."

HARDWARE REQUIREMENTS



(22ea) 1/4 STEEL FLAT WASHER



(22ea) 1/4" STEEL SPLIT LOCK WASHER



(22ea) 1/4-20 STEEL HEX NUT

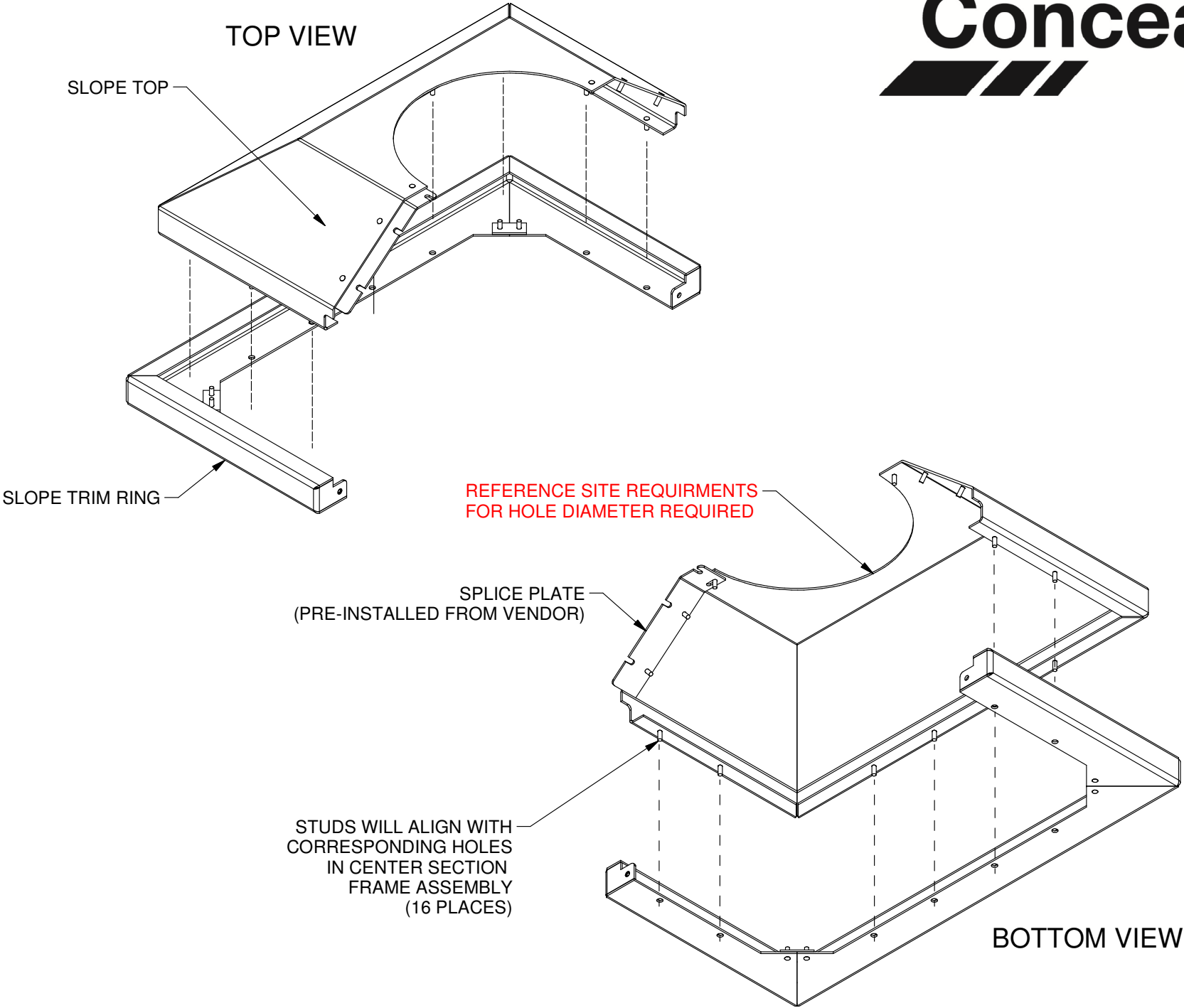

DRAWN RP	5/15/2017	008281 IG			
CHECKED JM	5/15/2017				
QA		TITLE ASSEMBLY, WRAP AROUND, PEDESTAL, INSTALLATION GUIDE			
MFG RP	5/15/2017				
APPROVED TR	5/15/2017	SIZE B			
		DWG NO		REV	
		ASSEMBLY PROCEDURE		A	
		SCALE		SHEET 4 OF 5	

FINAL ASSEMBLY

- 1.) INSTALL BOTH HALVES OF SLOPE TOP ASSEMBLIES
AROUND POLE, ALIGNING SPLICE TABS TO APPOSING STUDS,
THEN DROP DOWN AS AN ASSEMBLY ONTO
CENTER SECTION ASSEMBLY.
- 2.) SECURE USING HARDWARE FROM LIST.
- 3.) INSTALL (4) PRE- ASSEMBLED COVERS TO CENTER SECTION ASSEMBLY.
1/4-20 x 2" lg SECURITY SCREWS ARE PROVIDED IN COVERS FOR ATTACHMENT.
- 4.) WHEN INSTALLING COVERS, MAKE SURE TO HAVE RUBBER STOPS
POSITIONED DOWNWARD.

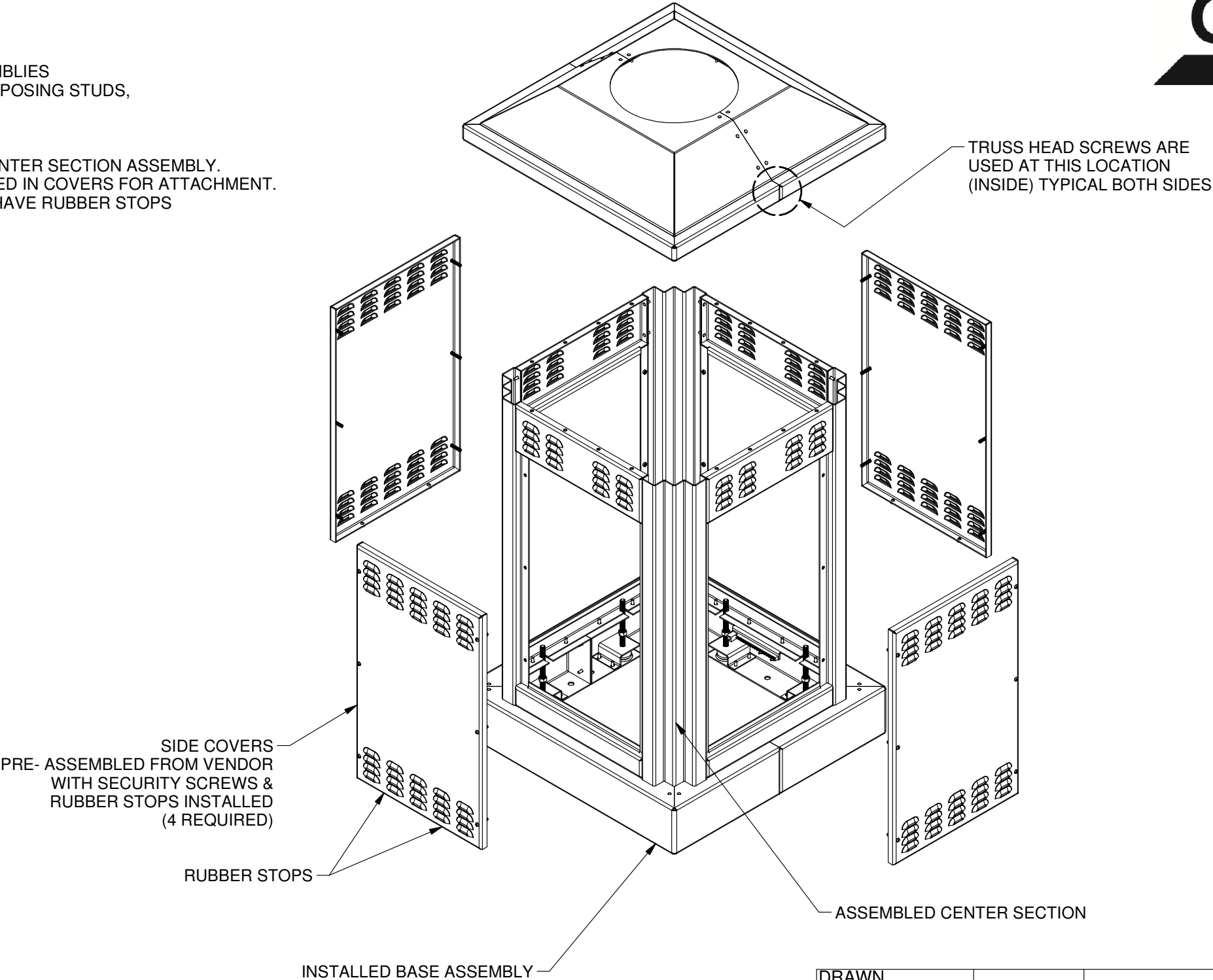

(2ea) 1/4-20 STEEL TRUSS HEAD SCREW 3/4" lg

DRAWN RP	5/15/2017	008281 IG		
CHECKED JM	5/15/2017			
QA		TITLE		
MFG RP	5/15/2017	ASSEMBLY, WRAP AROUND, PEDESTAL, INSTALLATION GUIDE		
APPROVED TR	5/15/2017			
		SIZE B	DWG NO ASSEMBLY PROCEDURE	REV A
		SCALE	SHEET 5 OF 5	

VARIABLE DIAMETER,
SOME ON-SITE
MODIFICATION MAY
BE REQUIRED

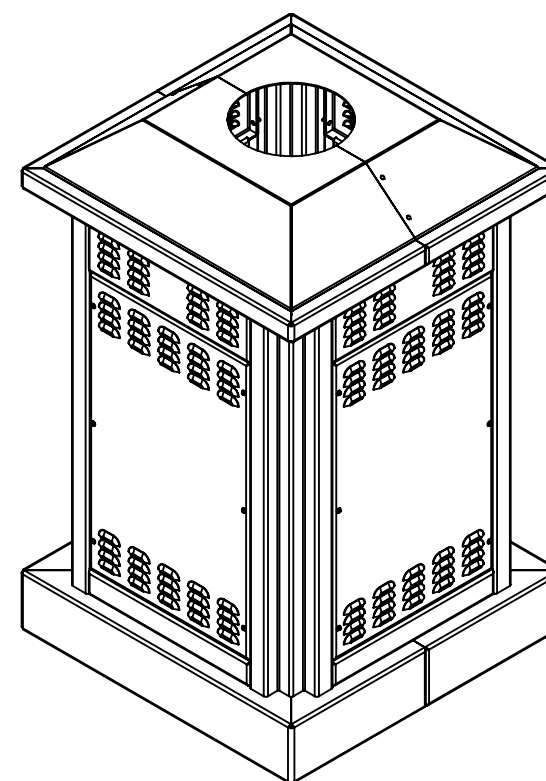
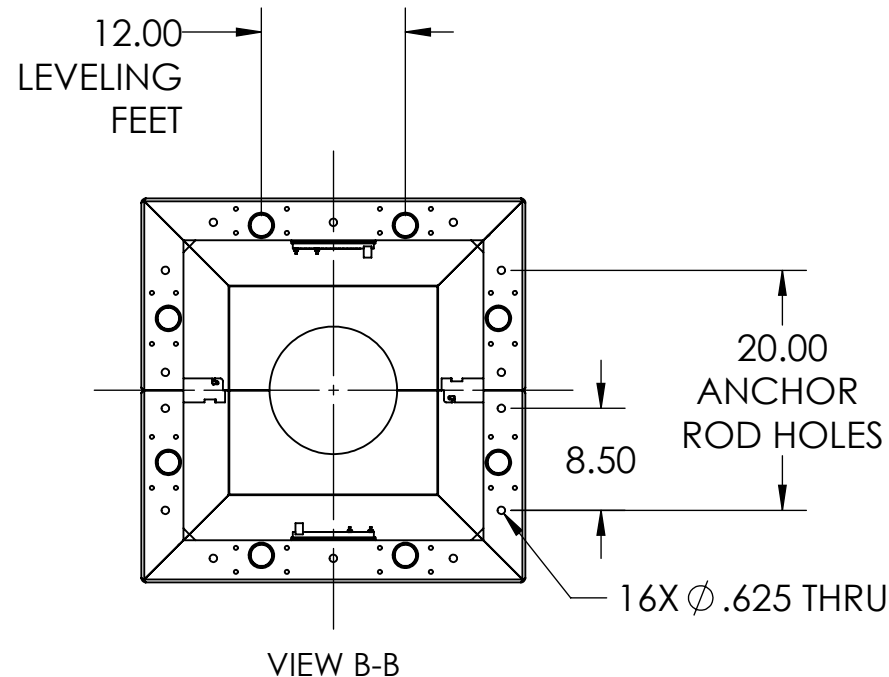
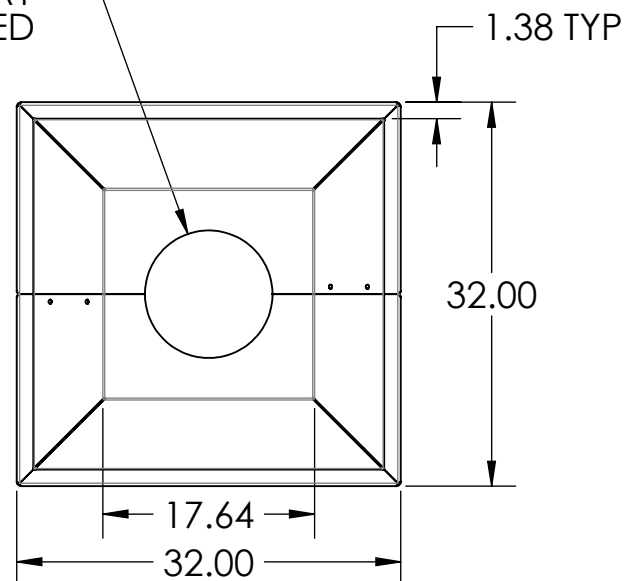

ISOMETRIC VIEW

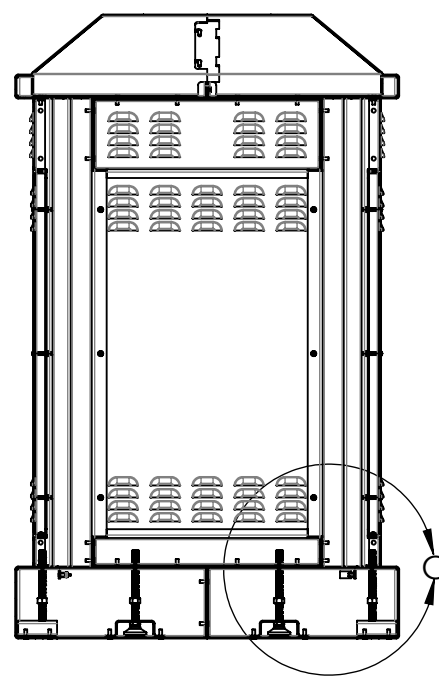
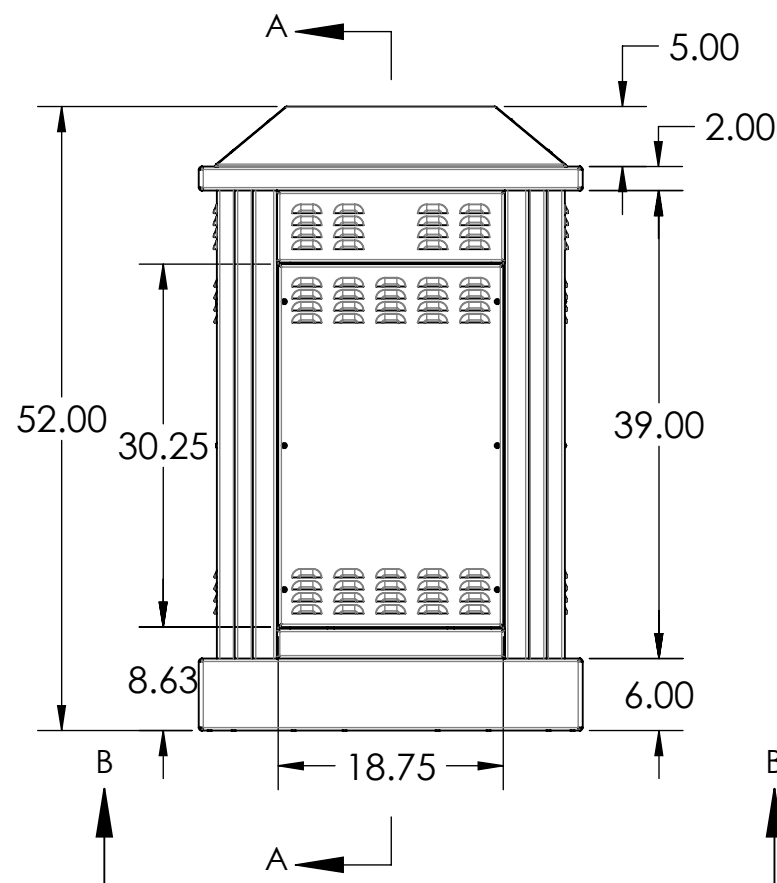

SECTION A-A

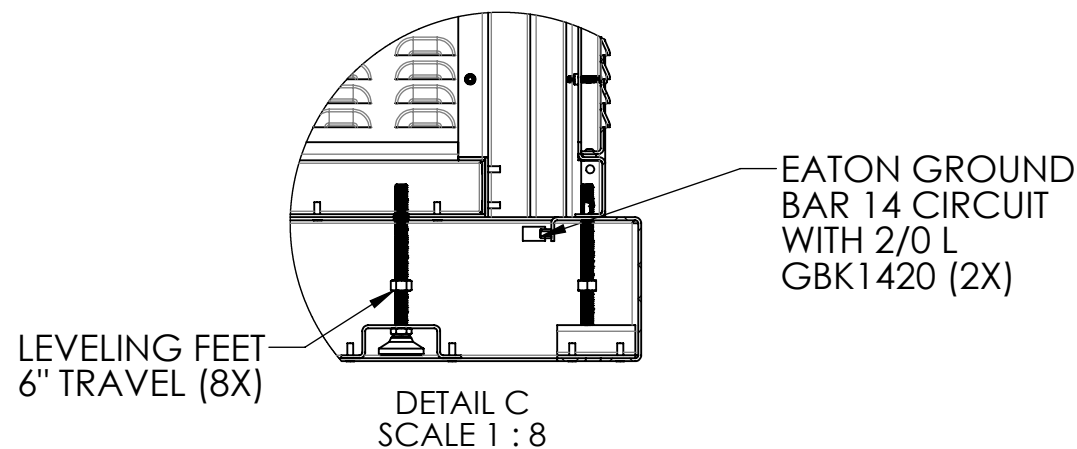

PART NUMBER KEY		
008281-AABCC-DDD		
SUFFIX: AABCC FINISH	01105	BLACK
	02105	BROWN
	03505	GRAY
	04205	SILVER
SUFFIX: DDD POLE DIAMETER	EXAMPLE: POLE DIA = 7.5", DDD = 075	

- NOTES:
1. APPROX. WEIGHT: 132.47 LBS.
 2. MATERIAL: .125 5052 ALUMINUM.
 3. POWDER COAT FINISH APPLIED TO INTERIOR AND EXTERIOR.

ConcealFab
Corporation
3525 NORTH CASCADE AVENUE
COLORADO SPRINGS, CO 80907
PH: 719-599-3400 FX: 719-599-0057

PROPRIETARY INFORMATION
USE, REPRODUCTION, OR DISCLOSURE
IS SUBJECT TO RESTRICTIONS SET FORTH
IN NON-DISCLOSURE AGREEMENTS AND
PERTINENT CONTRACTUAL DOCUMENTS.
© 2017 ConcealFab Corp - All Rights Reserved

Drawn By: JAM Date: 04/28/17 Ckd By: WWE Date: 04/28/17

Rev: A Date: 04/28/17 Description: NEW RELEASE Apd: JAM

DO NOT
SCALE DWG

DIMENSIONS ARE IN INCHES

DECIMAL	ANGLE	FRACTION
X.X ± 0.050	X ± 1°	± 1/16"
X.XX ± 0.020	X.X ± 0.5°	
X.XXX ± 0.010		

DIMENSIONS AND TOLERANCES
PER ASME Y14.5-2009

X.XX DENOTES CRITICAL TO
FUNCTION DIMENSION

Consultant:

Sheet Title:

ASSY, WRAP AROUND
PEDESTAL AUSTIN,
MECHANICAL OUTLINE

Sheet Scale: 1:16 Sheet Size: B Sheet: 1 OF 1

Drawing Number:

008281MO