

ORDINANCE NO. _____

1 AN ORDINANCE ESTABLISHING INITIAL PERMANENT ZONING FOR THE
2 PROPERTY GENERALLY KNOWN AS GREENSHORES ON LAKE AUSTIN
3 LOCATED AT SMOKY RIDGE AND FRIJOLITA AND CHANGING THE
4 ZONING MAP FROM INTERIM-LAKE AUSTIN RESIDENCE (I-LA) DISTRICT
5 AND INTERIM-SINGLE FAMILY RESIDENCE LARGE LOT (I-SF-1) DISTRICT
6 TO LAKE AUSTIN RESIDENCE (LA) DISTRICT AND SINGLE FAMILY
7 RESIDENCE LARGE LOT (SF-1) DISTRICT.
8

9 BE IT ORDAINED BY THE CITY COUNCIL OF THE CITY OF AUSTIN:

10
11 **PART 1.** The zoning map established by Section 25-2-191 of the City Code is amended to
12 change the base districts on the property described in Zoning Case No. C14-2010-0109, on
13 file at the Planning and Development Review Department, as follows:
14

15 Tract One: From interim-Lake Austin residence (I-LA) district to Lake Austin
16 residence (LA) district.
17

18 A 1.246 acre tract of land, more or less, out of the James Spillman Survey No.
19 Two, in Travis County, Texas, the tract of land more particularly described by
20 metes and bounds in Document No. 2001094191 and recorded in the Office Public
21 Records, Travis County, Texas; and
22

23 Tract Two: From interim-single family residence large lot (I-SF-1) district to single
24 family residence large lot (SF-1) district.
25

26 Lot C, Smoky Ridge Annex Subdivision, a subdivision recorded in Volume 75,
27 Page 369, of the Travis County Plat Records,
28

29 locally known as the property located at Smoky Ridge and Frijolita, in the City of Austin,
30 Travis County, Texas, and generally identified in the map attached as Exhibit "A".
31
32
33
34
35
36
37

1 **PART 2.** This ordinance takes effect on _____, 2010.

2
3
4 **PASSED AND APPROVED**

5
6
7
8 _____, 2010

§
§
§

9 Lee Leffingwell
10 Mayor

11
12
13 **APPROVED:** _____



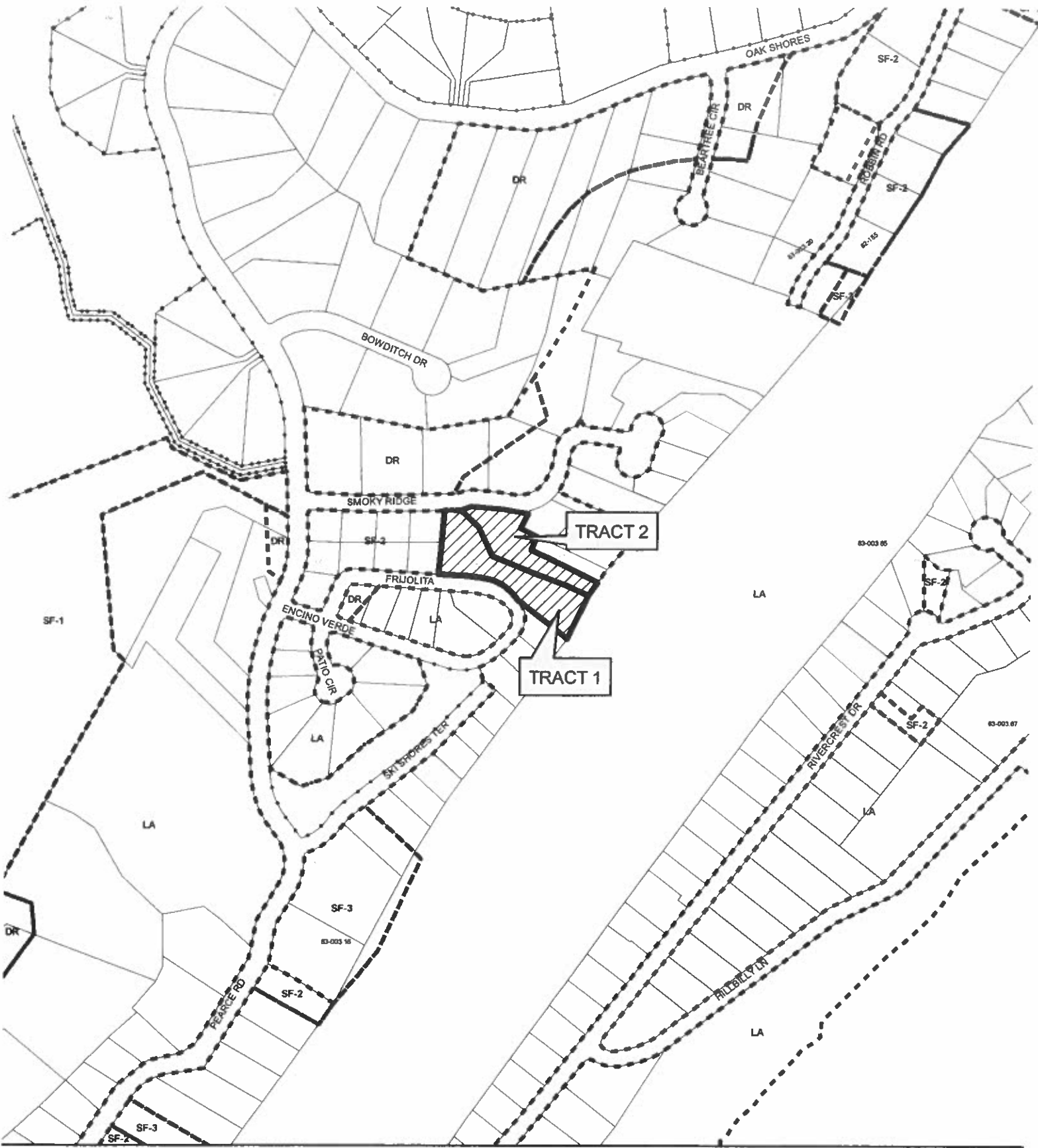

14 Karen M. Kennard
15 Acting City Attorney

ATTEST: _____

Shirley A. Gentry
City Clerk



ZONING EXHIBIT A

-  N
-  SUBJECT TRACT
-  PENDING CASE
-  ZONING BOUNDARY

ZONING CASE#: C14-2010-0109
 LOCATION: SMOKY RIDGE
 SUBJECT AREA: 0.00 ACRES
 GRID: E29
 MANAGER: CLARK PATTERSON

