

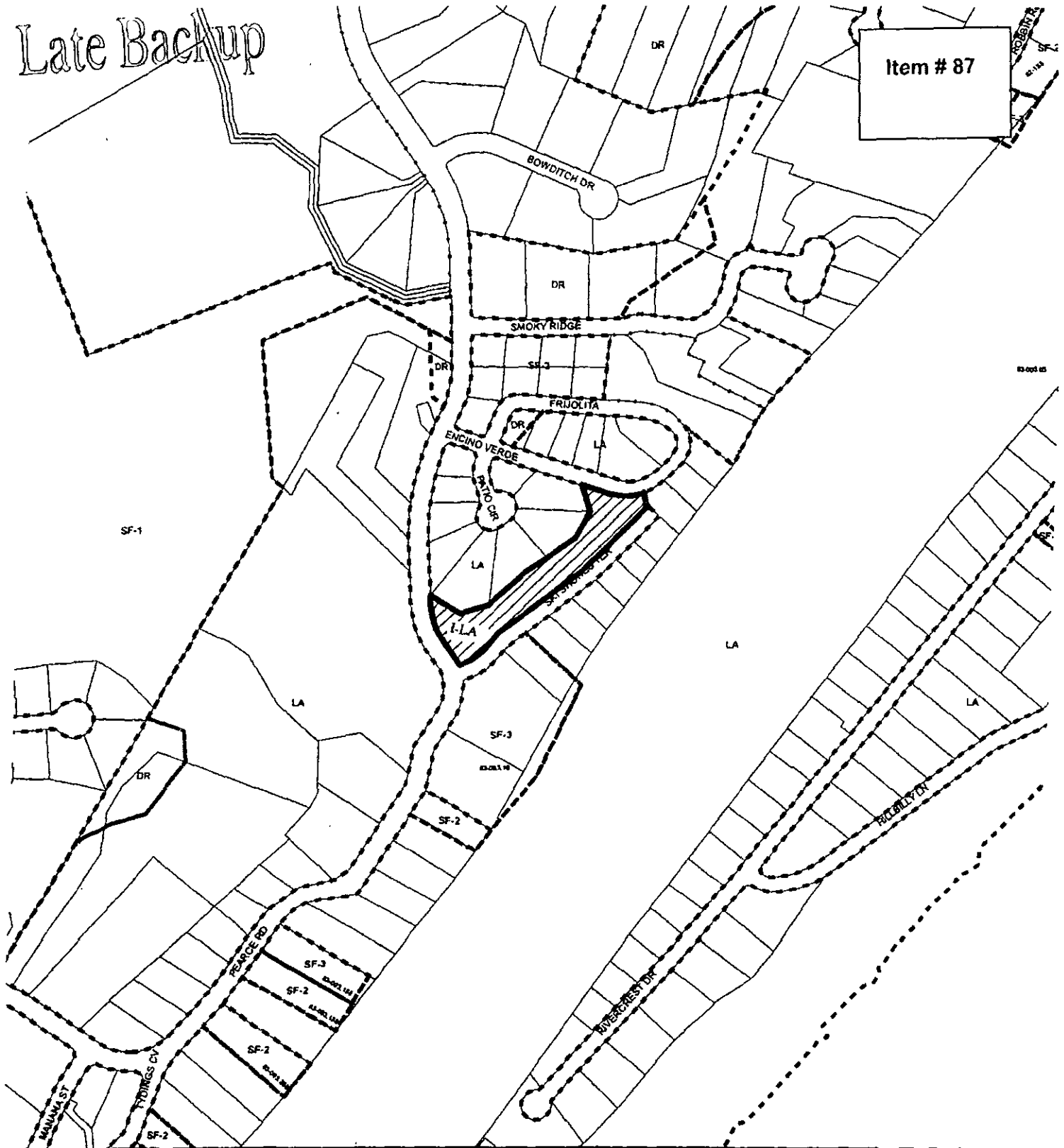



Late Backup

Item # 87

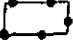

ZONING

- N
-  SUBJECT TRACT
 -  PENDING CASE
 -  ZONING BOUNDARY

ZONING CASE#: C14-2010-0110
 LOCATION: SKI SHORES TERRACE & PEARCE RD
 SUBJECT AREA: 0.000 ACRES
 GRID: E28
 MANAGER: CLARK PATTERSON



" = 400'

This map has been produced by the Communications Technology Management Dept. on behalf of the Planning Development Review Dept. for the sole purpose of geographic reference. No warranty is made by the City of Austin regarding specific accuracy or completeness.