

- 1
- 2
- 3
- 4
- 5
- 6
- 7
- 8
- 9
- 10
- 11
- 12
- 13
- 14
- 15
- 16
- 17
- 18
- 19
- 20
- 21
- 22
- 23
- 24
- 25
- 26
- 27
- 28
- 29
- 30

31 **PART 3.** This ordinance takes effect on \_\_\_\_\_, 2016.

32  
33 **PASSED AND APPROVED**

34  
35 §  
36 §  
37 \_\_\_\_\_, 2016 § \_\_\_\_\_

38 Steve Adler  
39 Mayor

40  
41 **APPROVED:** \_\_\_\_\_ **ATTEST:** \_\_\_\_\_  
42 Anne L. Morgan Jannette S. Goodall  
43 City Attorney City Clerk

DRAFT

# LOCATION MAP

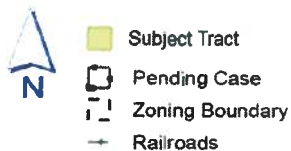

50 100 Feet

1" = 100'

## ZONING

ZONING CASE#: C14H-2016-0005



This product is for informational purposes and may not have been prepared for or be suitable for legal, engineering, or surveying purposes. It does not represent an on-the-ground survey and represents only the approximate relative location of property boundaries.

This product has been produced by CTM for the sole purpose of geographic reference. No warranty is made by the City of Austin regarding specific accuracy or completeness.