

ORDINANCE NO. \_\_\_\_\_

**AN ORDINANCE REZONING AND CHANGING THE ZONING MAP FOR THE PROPERTY LOCATED AT 2401 AND 2405 DAISY DRIVE FROM GENERAL COMMERCIAL SERVICES (CS) DISTRICT TO GENERAL COMMERCIAL SERVICES-MIXED USE-CONDITIONAL OVERLAY (CS-MU-CO) COMBINING DISTRICT.**

**BE IT ORDAINED BY THE CITY COUNCIL OF THE CITY OF AUSTIN:**

**PART 1.** The zoning map established by Section 25-2-191 of the City Code is amended to change the base district from general commercial services (CS) district to general commercial services-mixed use-conditional overlay (CS-MU-CO) combining district on the property described in Zoning Case No. C14-2017-0147, on file at the Planning and Zoning Department, as follows:

Lots 11 and 12, Kings Village, Section Two Part 1, a subdivision in Travis County, Texas, according to the map or plat thereof recorded in Volume 7, Page 51, of the Plat Records of Travis County, Texas (the "Property"),

locally known as 2401 and 2405 Daisy Drive in the City of Austin, Travis County, Texas, generally identified in the map attached as **Exhibit "B"**.

**PART 2.** The Property within the boundaries of the conditional overlay combining district established by this ordinance is subject to the following conditions:

Development of the Property is limited to one residential unit.

**PART 3.** Except as specifically restricted under this ordinance, the Property may be developed and used in accordance with the regulations established for the general commercial services (CS) district and other applicable requirements of the City Code.

**PART 4.** This ordinance takes effect on \_\_\_\_\_, 2018.

**PASSED AND APPROVED**

\_\_\_\_\_, 2018      § \_\_\_\_\_  
                                         § \_\_\_\_\_  
                                         § \_\_\_\_\_  
Steve Adler  
Mayor

**APPROVED:** \_\_\_\_\_ **ATTEST:** \_\_\_\_\_  
Anne L. Morgan                      Jannette S. Goodall  
City Attorney                      City Clerk

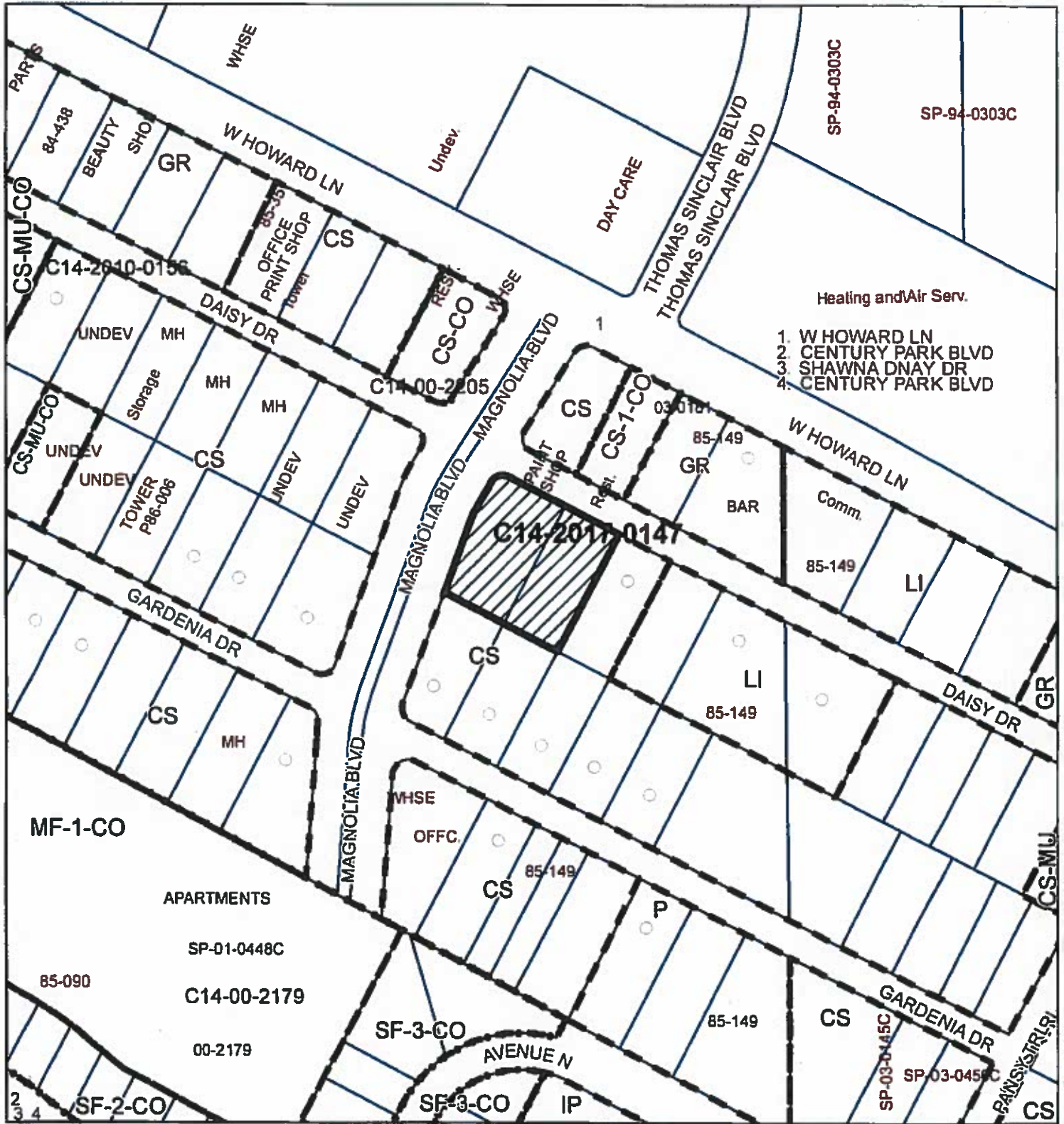

## ZONING

Case#: C14-2017-0147

Exhibit A

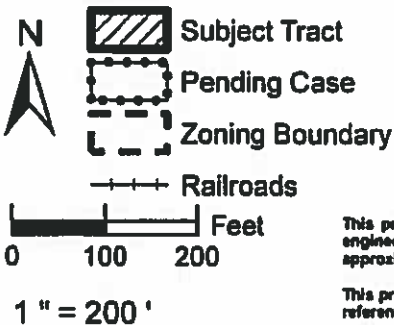

This product is for informational purposes and may not have been prepared for or be suitable for legal, engineering, or surveying purposes. It does not represent an on-the-ground survey and represents only the approximate relative location of property boundaries.

This product has been produced by the Planning and Zoning Department for the sole purpose of geographic reference. No warranty is made by the City of Austin regarding specific accuracy or completeness.



Created: 12/5/2017