

ORDINANCE NO. \_\_\_\_\_

AN ORDINANCE REZONING AND CHANGING THE ZONING MAP FOR THE  
STRUCTURE GENERALLY KNOWN AS THE WEST SIXTH STREET BRIDGE  
OVER SHOAL CREEK LOCATED IN THE 800 BLOCK OF 6<sup>TH</sup> STREET FROM  
PUBLIC (P) DISTRICT TO PUBLIC-HISTORIC LANDMARK (P-H)  
COMBINING DISTRICT.

BE IT ORDAINED BY THE CITY COUNCIL OF THE CITY OF AUSTIN:

**PART 1.** The zoning map established by Section 25-2-191 of the City Code is amended to change the base district from public (P) district to public-historic landmark (P-H) combining district on the structure described in Zoning Case No. C14H-2018-0014, on file at the Planning and Zoning Department, generally known as the West Sixth Street Bridge over Shoal Creek, locally known as 800 block of West 6<sup>th</sup> Street in the City of Austin, Travis County, Texas, generally identified in the map attached as **Exhibit "A"**.

**PART 2.** This ordinance takes effect on \_\_\_\_\_, 2018.

**PASSED AND APPROVED**

§  
§  
§

\_\_\_\_\_, 2018

Steve Adler  
Mayor

**APPROVED:** \_\_\_\_\_ **ATTEST:** \_\_\_\_\_

Anne L. Morgan  
City Attorney



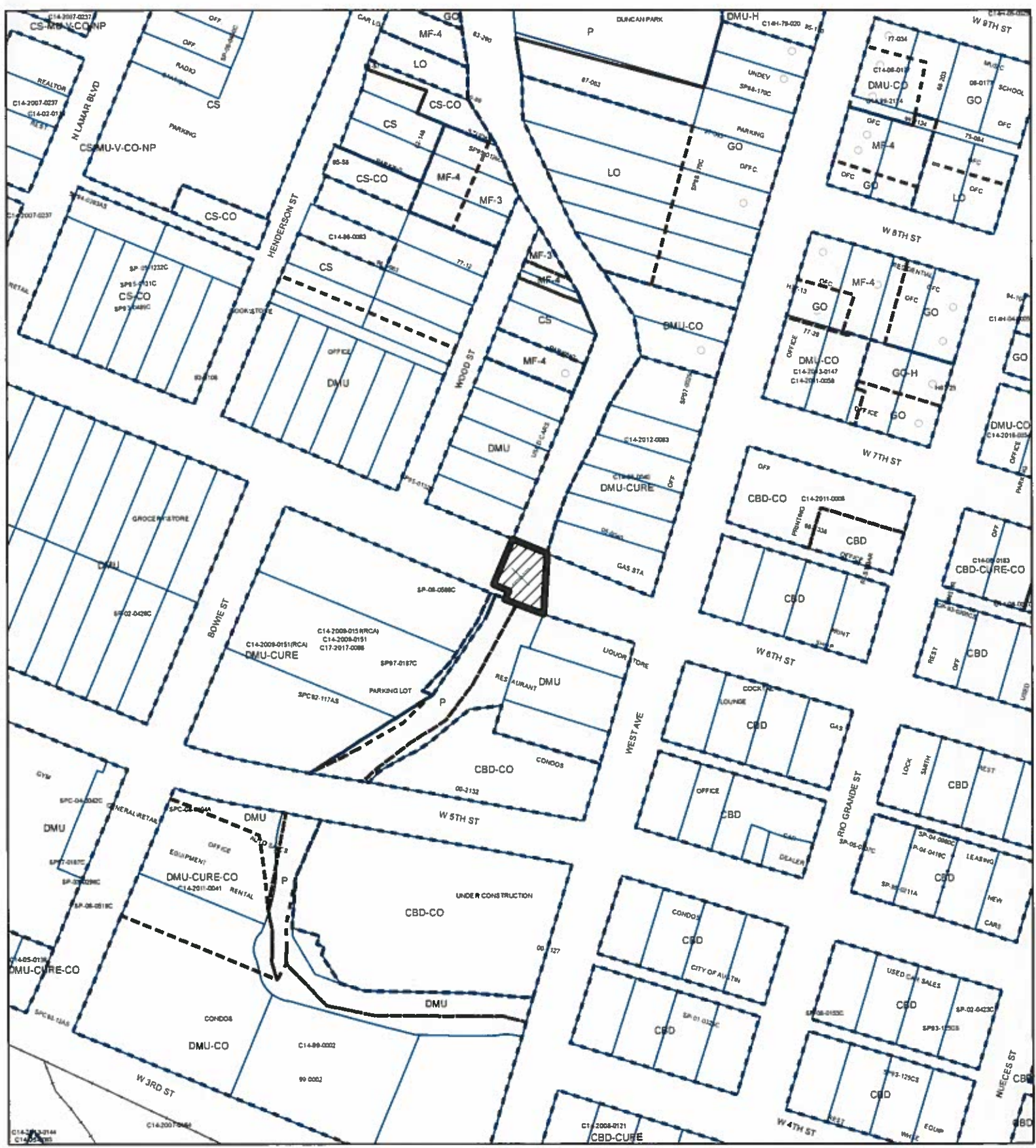

Jannette S. Goodall  
City Clerk



# HISTORIC ZONING

ZONING CASE#: C14H-2018-0014

Exhibit A

-  N
-  SUBJECT TRACT
-  PENDING CASE
-  ZONING BOUNDARY

1" = 200'

This product is for informational purposes and may not have been prepared for or be suitable for legal, engineering, or surveying purposes. It does not represent an on-the-ground survey and represents only the approximate relative location of property boundaries.

This product has been produced by CTM for the sole purpose of geographic reference. No warranty is made by the City of Austin regarding specific accuracy or completeness.

