

ORDINANCE NO. _____

AN ORDINANCE REZONING AND CHANGING THE ZONING MAP FOR THE PROPERTY LOCATED AT 13708, 13710, 13800 AND 13802 IDA RIDGE DRIVE FROM GENERAL COMMERCIAL SERVICES-CONDITIONAL OVERLAY (CS-CO) COMBINING DISTRICT TO COMMUNITY COMMERCIAL-MIXED USE GR-MU) COMBINING DISTRICT.

BE IT ORDAINED BY THE CITY COUNCIL OF THE CITY OF AUSTIN:

PART 1. The zoning map established by Section 25-2-191 of the City Code is amended to change the base district from general commercial services-conditional overlay (CS-CO) combining district to community commercial-mixed use (GR-MU) combining district on the property described in Zoning Case No. C14-2017-0121, on file at the Planning and Zoning Department, as follows:

Lots 4, 5, 6 and 7, Kings Village Sec 3 Subdivision, a subdivision in Travis County, Texas, as recorded in Volume 66, Page 83, of the Plat Records of Travis County, Texas (the "Property"),

locally known as 13708, 13710, 13800 and 13802 Ida Ridge Drive in the City of Austin, Travis County, Texas, generally identified in the map attached as **Exhibit "A"**.

PART 2. This ordinance takes effect on _____, 2018.

PASSED AND APPROVED

_____, 2018 § _____
§ _____
§ _____

Steve Adler
Mayor

APPROVED: _____ **ATTEST:** _____

Anne L. Morgan
City Attorney

Jannette S. Goodall
City Clerk

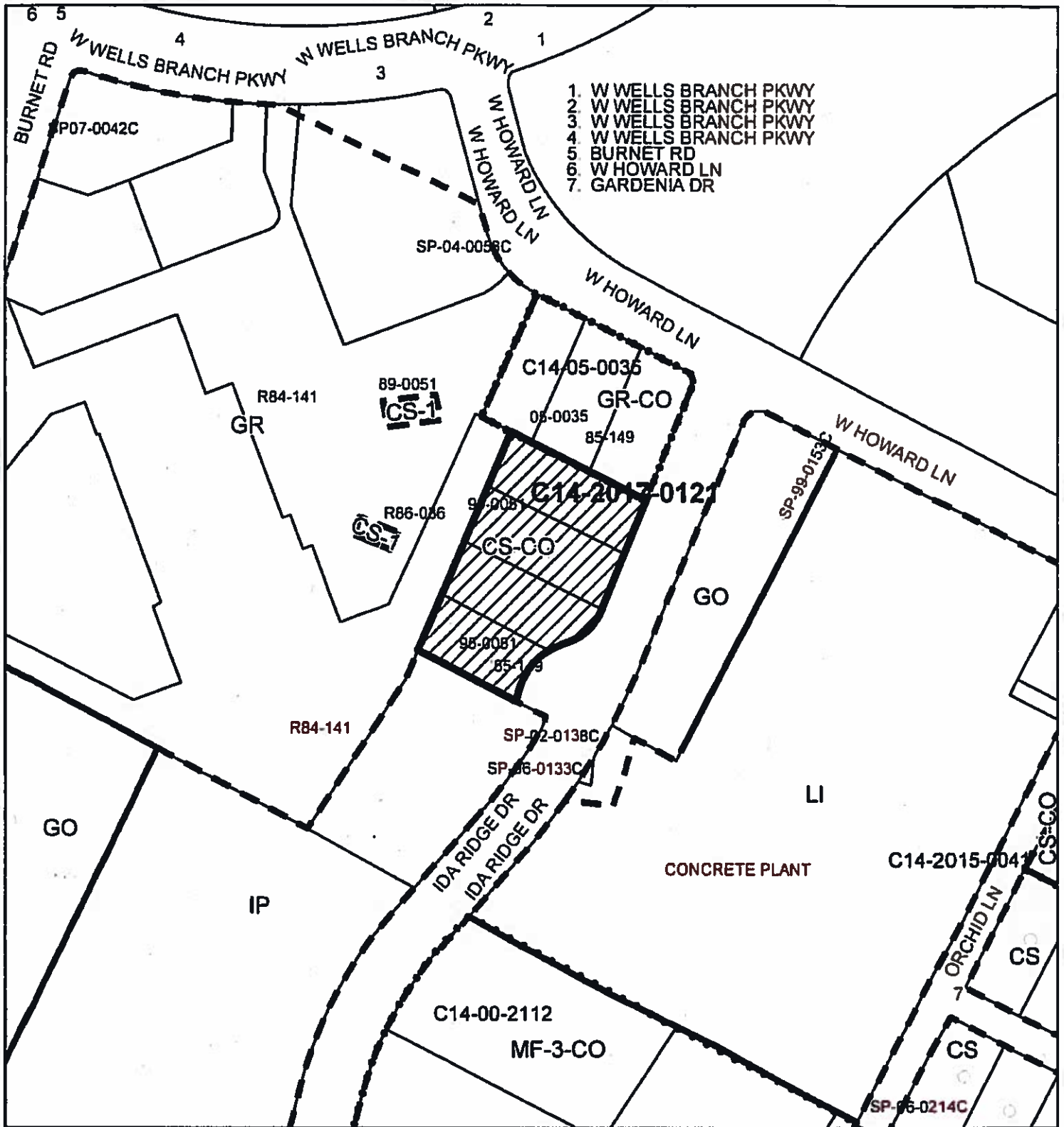

ZONING

Case#: C14-2017-0121

Exhibit A

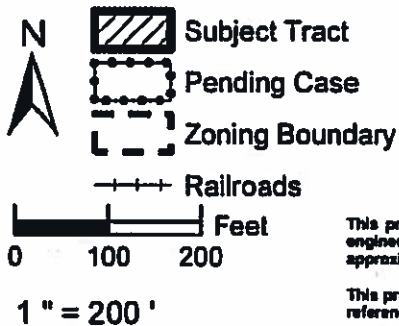

This product is for informational purposes and may not have been prepared for or be suitable for legal, engineering, or surveying purposes. It does not represent an on-the-ground survey and represents only the approximate relative location of property boundaries.

This product has been produced by the Planning and Zoning Department for the sole purpose of geographic reference. No warranty is made by the City of Austin regarding specific accuracy or completeness.



Created: 2/27/2018