



AUSTIN-BERGSTROM INTERNATIONAL AIRPORT 2040 MASTER PLAN



Austin-Bergstrom
International Airport

WHY A MASTER PLAN?

- FAA requires a Master Plan for regulation and to monitor grant assurances
- Execution of competitive strategy
- Prepare for nation-leading growth



ABIA PASSENGER SERVICE AREA

ABIA serves 21+
counties

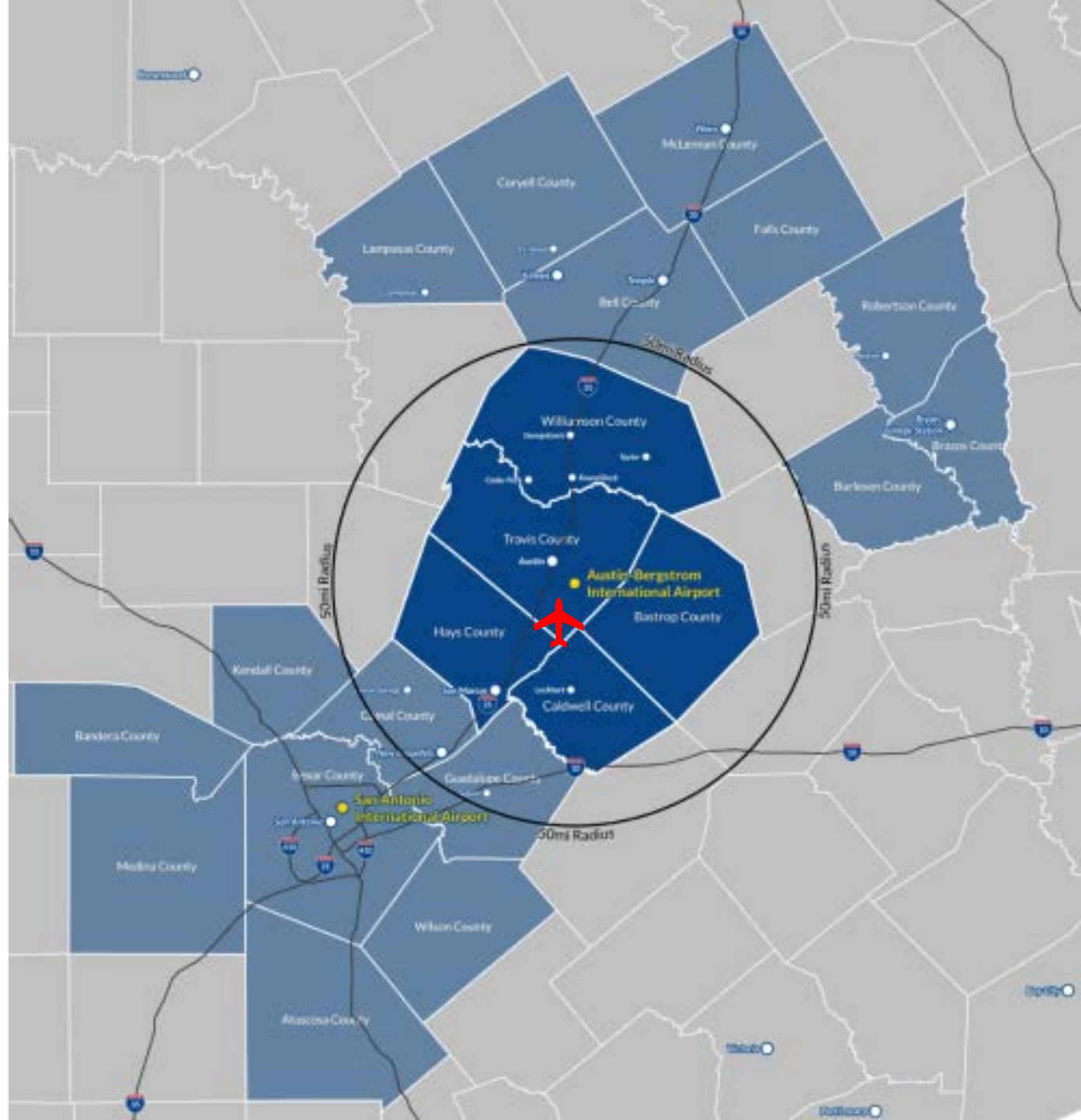

ABIA ECONOMIC IMPACT

Recent economic study measures impact
ABIA creates

- \$7.605 Billion Impact
- 212% Increase since Previous Study in 2010
- 74,148 Jobs
- In 2018, more than 2000 construction jobs

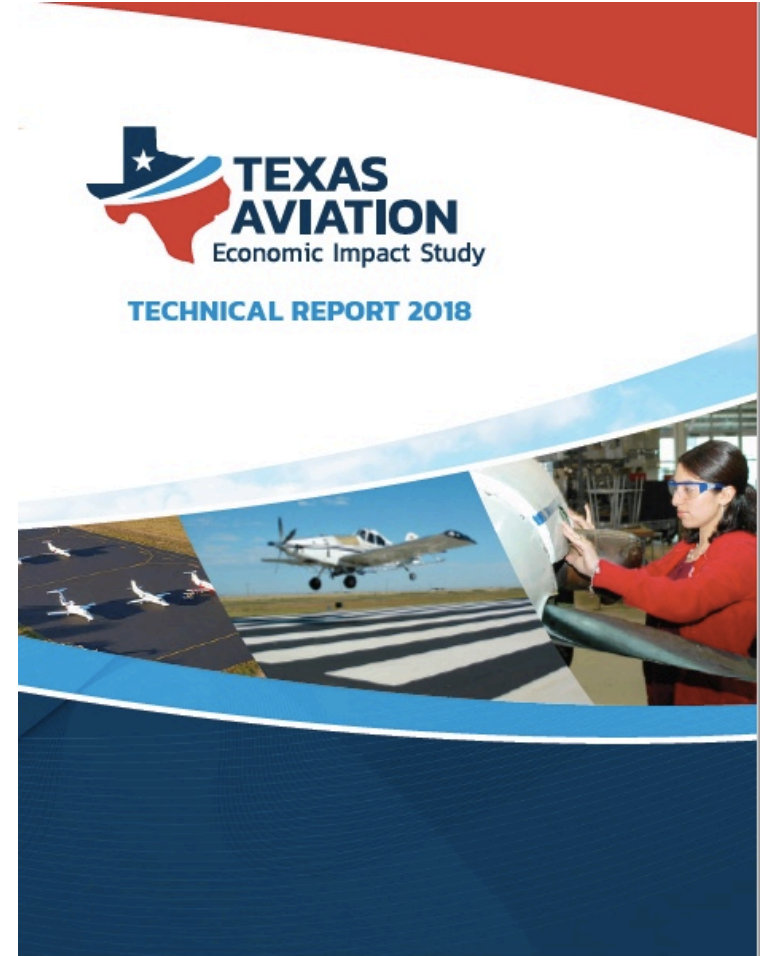

Texas Aviation Economic Impact Study Technical Report 2018 (TxDOT)

ABIA FAA APPROVED FORECAST

4.5% COMPOUND ANNUAL GROWTH RATE

Million Annual Passengers (MAP)

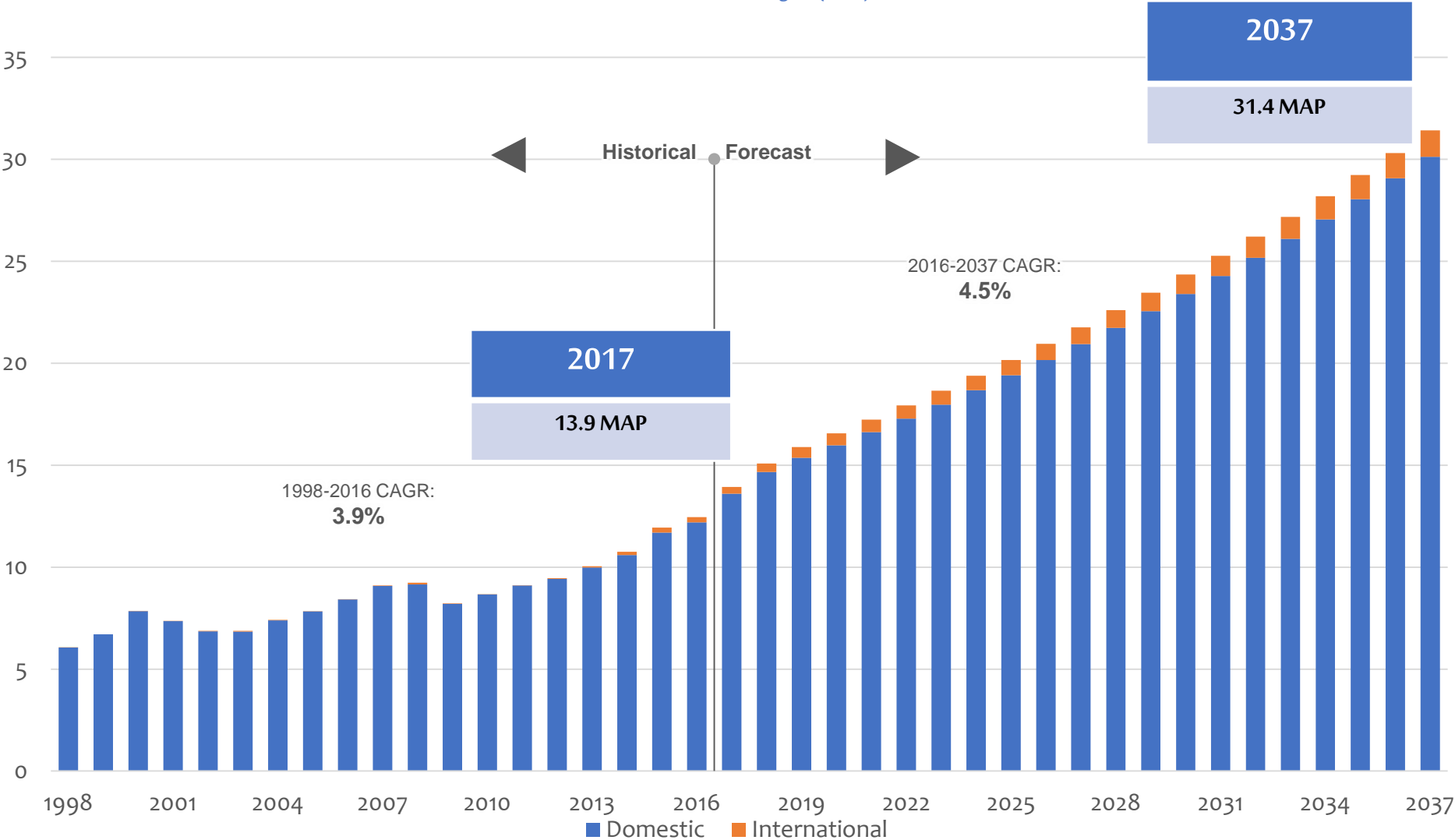

Source: Austin-Bergstrom International Airport

ABIA ANTICIPATED PASSENGER GROWTH

Master Plan forecasts 8% annual growth rate, based on 5-year average

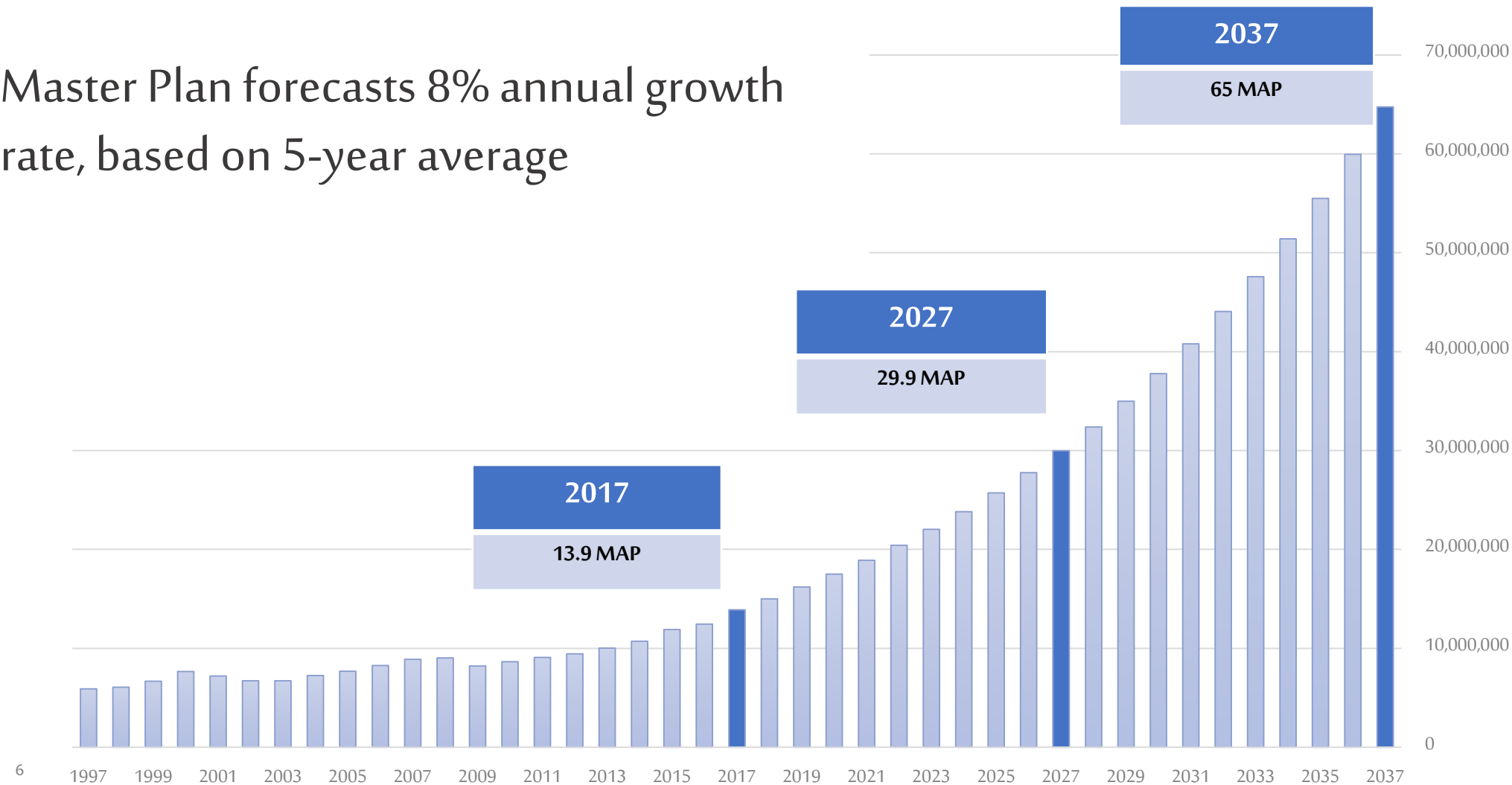

ABIA PUBLIC INPUT OPPORTUNITIES



4 Public Workshops

4 Technical Advisory
Committee

4 Project Advisory
Committee

4 Airport Advisory
Commission

1 Online/Live Survey

City Council

ABIA PUBLIC INPUT SUMMARY

Keep the 'Austin' experience

Improve mobility on campus

Plan for future needs beyond 2037

Include rail & multimodal options

Introduce more innovative technology

Improve wayfinding & signage

Engage with community on ongoing basis



ABIA RISING TO MEET ANTICIPATED GROWTH

**TERMINAL
NEEDS**

**AIRFIELD
NEEDS**

**LANDSIDE
NEEDS**



ABIA **TERMINAL NEEDS**

2019-2029

- Additional ticketing space
- Additional baggage space
- Additional security space
- Upgrades to Barbara Jordan Terminal
- 20 new gates in the new midfield concourse
- 2 million square feet of new terminal and concourse space



ABIA **TERMINAL NEEDS**

2030-2040

- 12 new gates (66 total gates)
- Ground Transportation Center
- Upgrades to Barbara Jordan Terminal



ABIA NEW TERMINAL SPACE

NEW
MIDFIELD
CONCOURSE
AND WEST
INFILL



- OLD
- NEW
- 1 CONRAC
- 2 PARKING
- 3 EXISTING BJT

ABIA **NEW TERMINAL**

**NEW
ARRIVALS &
DEPARTURES
CURB**



ABIA NEW TERMINAL

NEW
TICKETING,
SCREENING,
BAGGAGE
CLAIM



ABIA PREFERRED TERMINAL CONCEPT

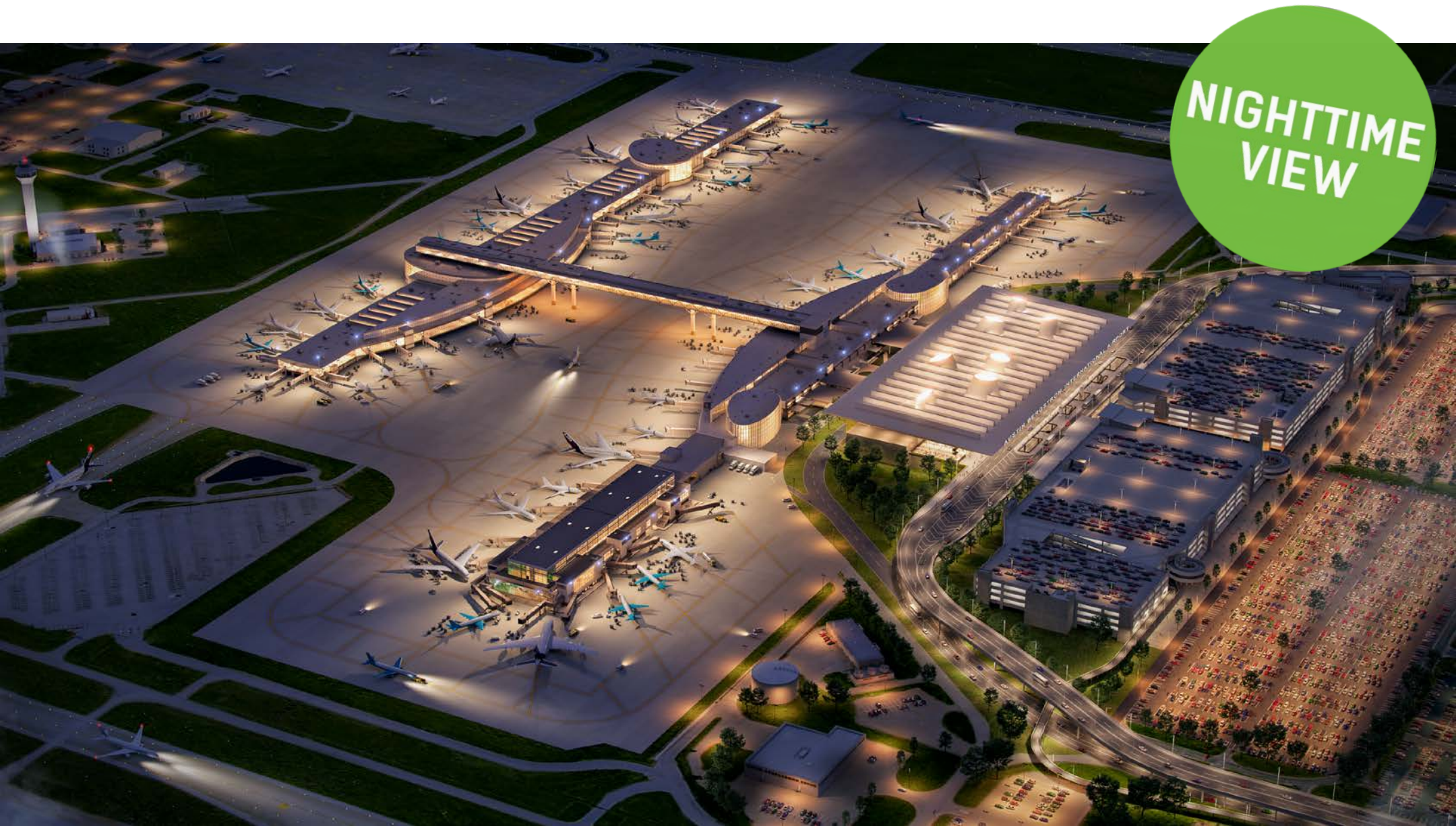

NIGHTTIME
VIEW

ABIA **AIRFIELD** **IMPROVEMENTS**

- New Midfield Taxiway
- New Taxiway Delta
- Expanded Aircraft Apron
- New Aircraft Remain Over Night Parking
- Taxiway Charlie Realignment



**AIRFIELD
IMPROVEMENTS
2019-2029**

ABIA AIRFIELD IMPROVEMENTS

- New West Cargo Complex
- Upgrades to Taxiways and Apron
- Additional Remain Overnight Aircraft Parking
- Fuel Farm Relocation
- New Center Runway
 - Needed for Maintenance Repairs to Existing Runways to Maintain Capacity (2032-2040)



AIRFIELD
IMPROVEMENTS
2030-2040

ABIA AIRFIELD IMPROVEMENTS

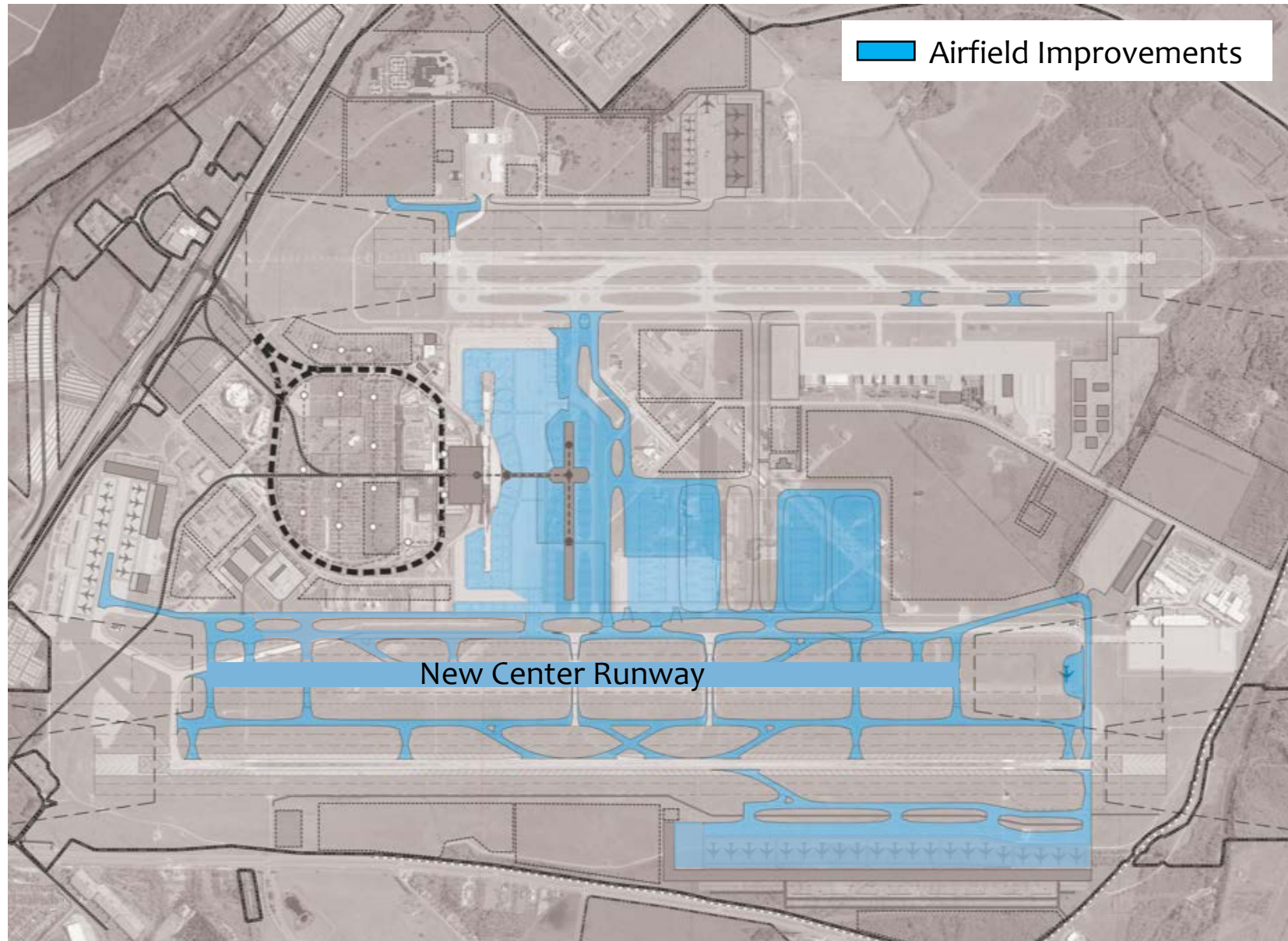

ABIA LANDSIDE IMPROVEMENTS

- 11,000 New Parking Spaces
- New Braided Interchange at Presidential Blvd/
- Provides Free Flow into and out of the airport
- Campus Roadway Improvements and Upgrades
- Expansion and Upgrades of Support Facilities
- Upgrade and Expand Electrical and Water Utilities

LANDSIDE
IMPROVEMENTS
2019-2029

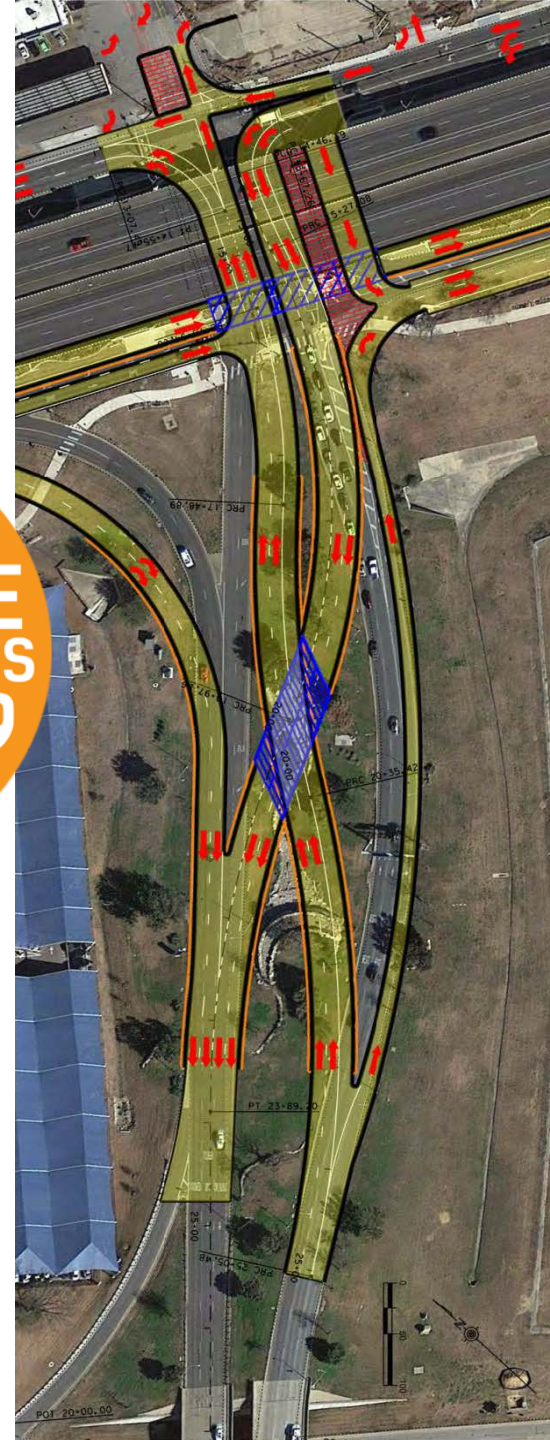

ABIA **LANDSIDE** **IMPROVEMENTS**

- New Ground Transportation Center
- High Capacity Transit Integration
- Relocation of SH 71 Providing New Entry to Airport
- Enhanced Parking Shuttle Network



**LANDSIDE
IMPROVEMENTS
2030-2040**

ABIA MOBILITY & SUSTAINABILITY

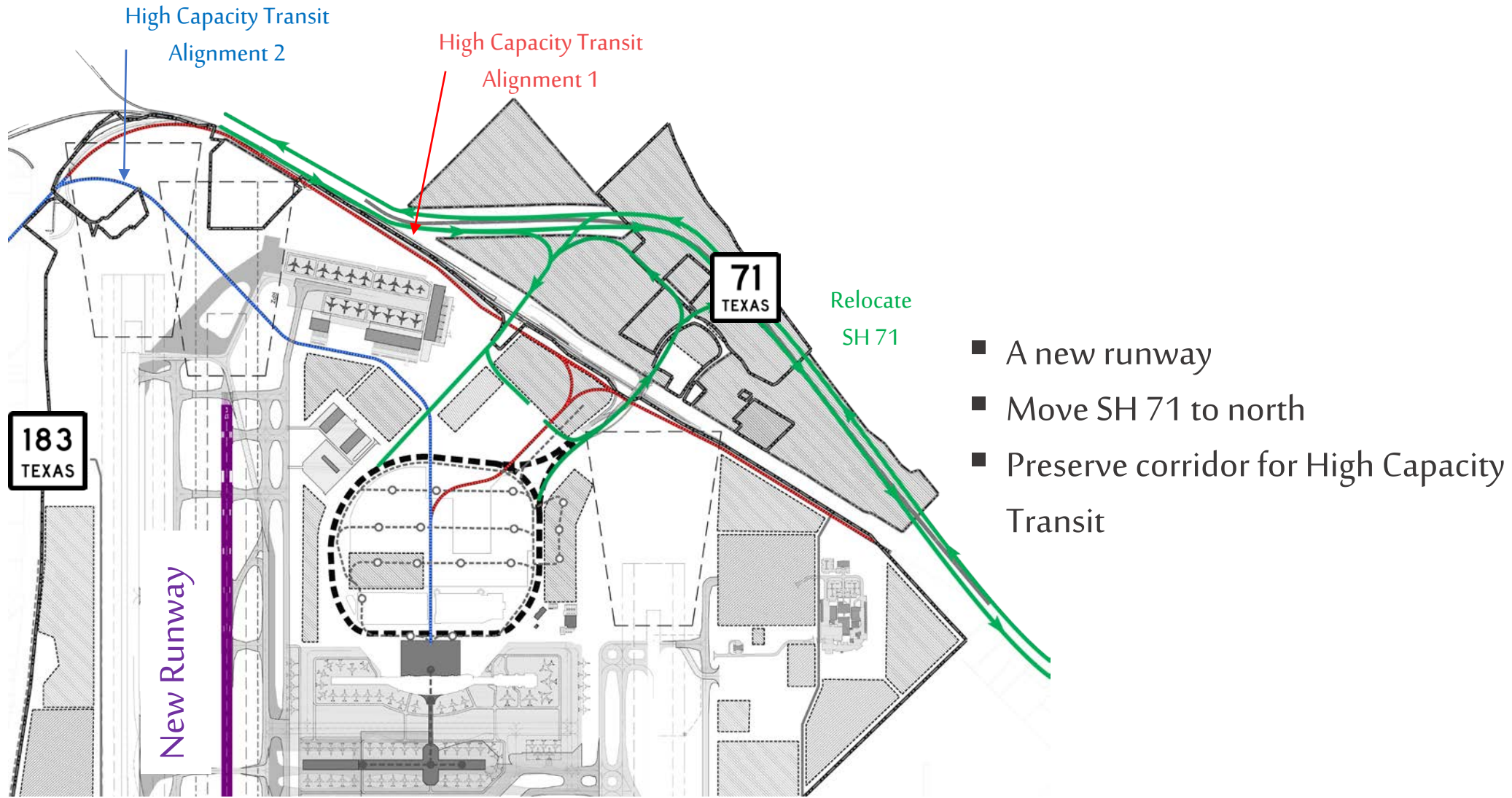

ULTIMATE AIRPORT LAYOUT

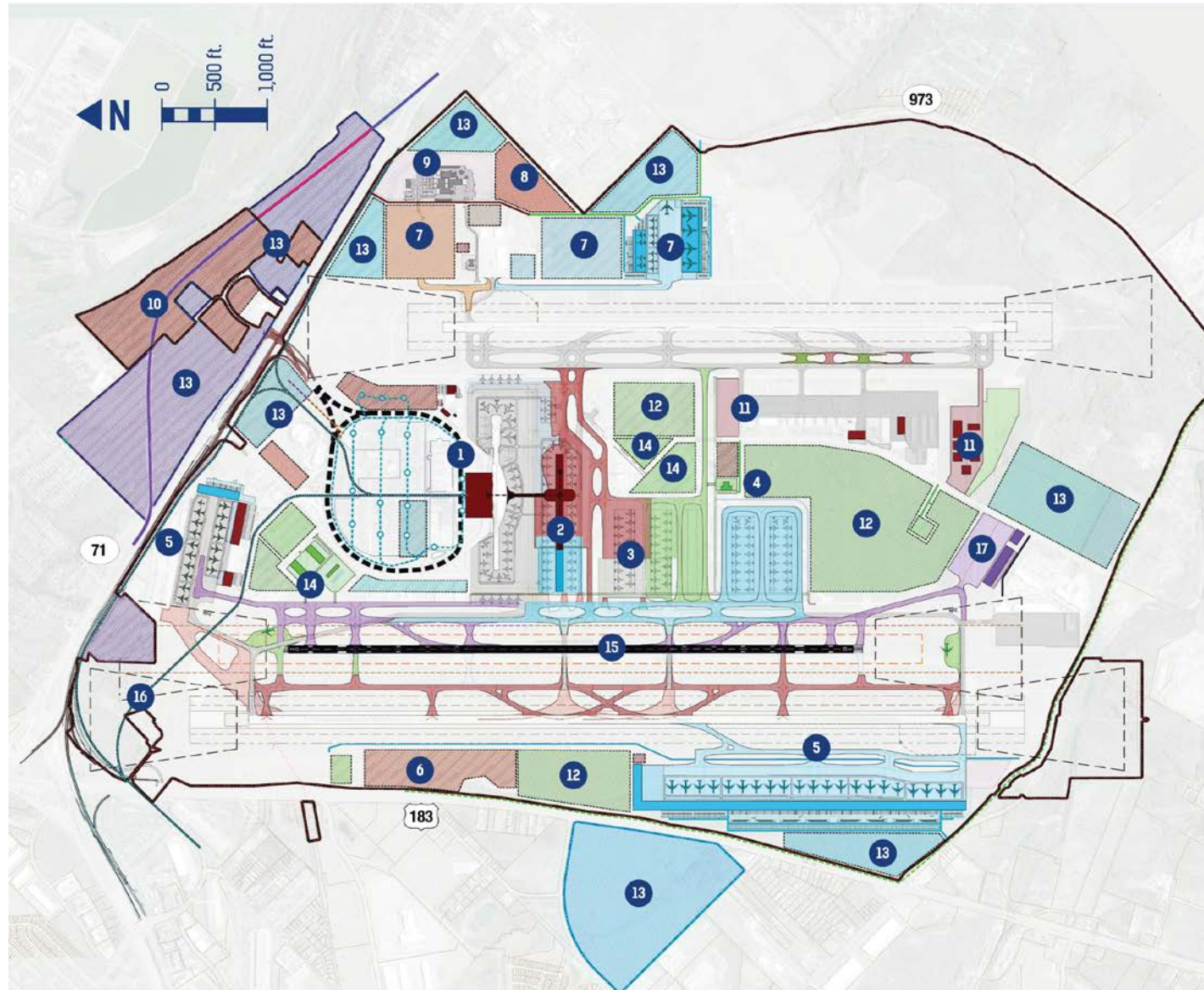

- 1 North Terminal & Central Bag System
- 2 32-Gate Midfield Concourse
- 3 Remain Overnight Parking Positions
- 4 Airport Firefighting Station
- 5 Cargo Development
- 6 Fuel Farm
- 7 Aircraft Maintenance
- 8 Central Warehouse
- 9 Airport Maintenance
- 10 Relocated SH 71
- 11 General Aviation
- 12 Aeronautical Development Areas
- 13 Non-Aeronautical Development Areas
- 14 Support Facility Areas
- 15 New Runway 17C-35C
- 16 High Capacity Transit
- 17 U.S. Army Reserve

ABIA PROPOSED FUNDING PLAN

- Potential Sources of Funding
 - FAA AIP Grants
 - Local ABIA Funds
 - Passenger Facility Charges (PFC)
 - Rental Car Customer Facility Charges (CFC)
 - ABIA Capital Fund
 - Private/Public Partnerships
 - General Airport Revenue Bonds (GARBs)

Cost Center	Phase 1 2019-2029
Airfield	\$653,991,362
Terminal	\$3,372,784,943
Landside	\$289,605,711

ABIA 60-70 MILLION ANNUAL PASSENGERS

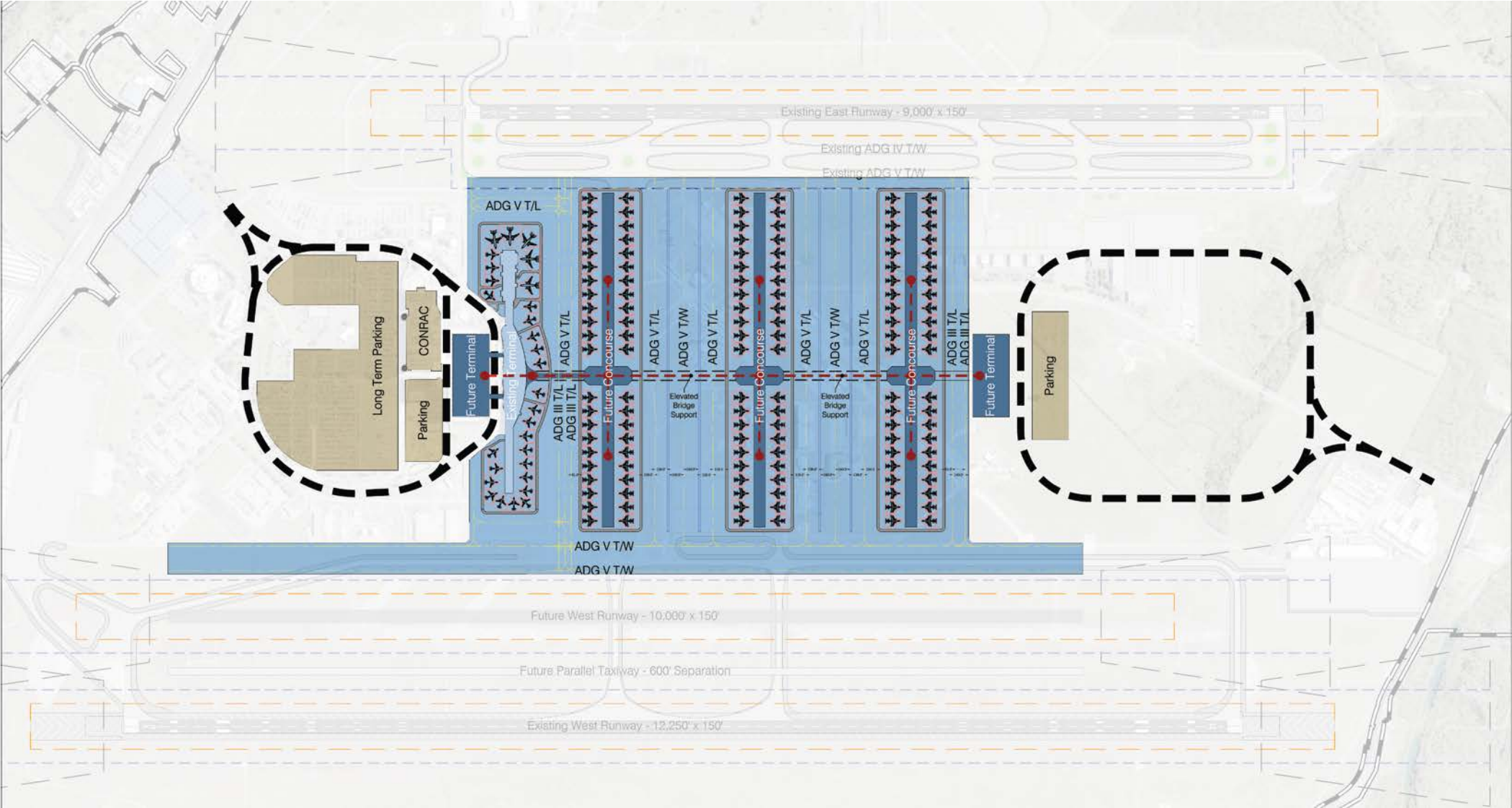



QUESTIONS?

