

ORDINANCE NO. _____

AN ORDINANCE AMENDING ORDINANCE NO. 20061116-055 WHICH ADOPTED THE EAST RIVERSIDE/OLTORF COMBINED NEIGHBORHOOD PLAN AS AN ELEMENT OF THE IMAGINE AUSTIN COMPREHENSIVE PLAN, TO CHANGE THE LAND USE DESIGNATION ON THE FUTURE LAND USE MAP FOR PROPERTY LOCATED AT 5107 EAST RIVERSIDE DRIVE.

BE IT ORDAINED BY THE CITY COUNCIL OF THE CITY OF AUSTIN:

PART 1. Ordinance No. 20061116-055 adopted the East Riverside/Oltorf Combined Neighborhood Plan as an element of the Imagine Austin Comprehensive Plan.

PART 2. Ordinance No. 20061116-055 is amended to change the land use designation from single family use to mixed use/office use for the property located at 5107 East Riverside Drive on the future land use map attached as **Exhibit "A"** and incorporated in this ordinance, and described in File NPA-2018-0021.03 at the Planning and Zoning Department.

PART 3. This ordinance takes effect on _____, 2019.

PASSED AND APPROVED

_____, 2019 § _____
§ _____
§ _____

Steve Adler
Mayor

APPROVED: _____ **ATTEST:** _____
Anne L. Morgan Jannette S. Goodall
City Attorney City Clerk

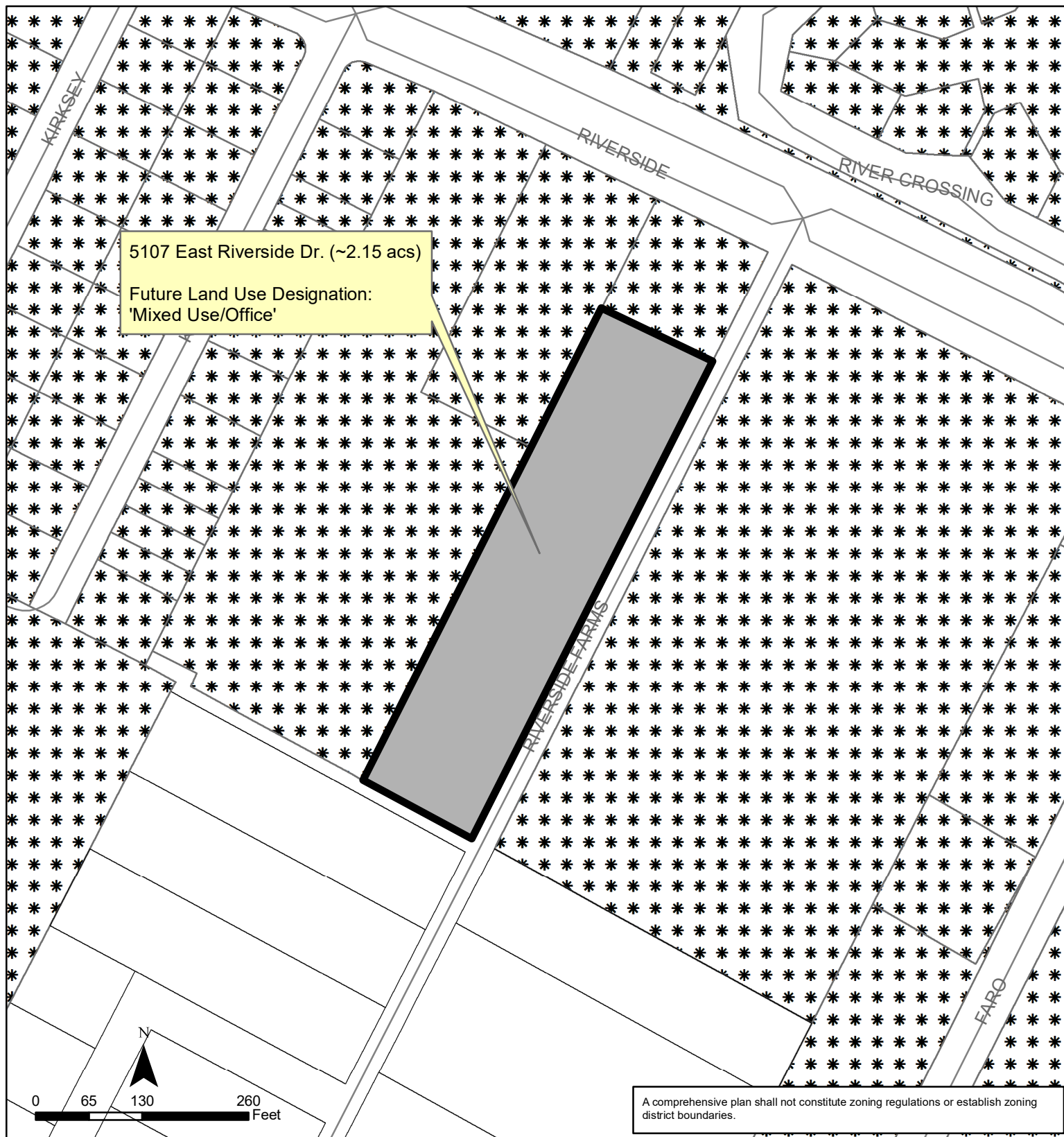

Exhibit A

East Riverside/Oltorf Combined Neighborhood Planning Area

Amendment NPA-2018-0021.03

This product is for informational purposes and may not have been prepared for or be suitable for legal, engineering, or surveying purposes. It does not represent an on-the-ground survey and represents only the approximate relative location of property boundaries.

This product has been produced by the Planning and Zoning Department for the sole purpose of geographic reference. No warranty is made by the City of Austin regarding specific accuracy or completeness.

Future Land Use

	Mixed Use/Office		Specific Regulating District
	Rural Residential		Recreation & Open Space
	Single-Family		Excluded from FLUM
	Multi-Family		

