

ORDINANCE NO. _____

AN ORDINANCE REZONING AND CHANGING THE ZONING MAP FOR THE PROPERTY LOCATED AT 12411 LIMERICK AVENUE FROM SINGLE-FAMILY RESIDENCE LARGE LOT (SF-1) DISTRICT TO NEIGHBORHOOD OFFICE-MIXED USE (NO-MU) COMBINING DISTRICT.

BE IT ORDAINED BY THE CITY COUNCIL OF THE CITY OF AUSTIN:

PART 1. The zoning map established by Section 25-2-191 of the City Code is amended to change the base district from single-family residence large lot (SF-1) district to neighborhood office-mixed use (NO-MU) combining district on the property described in Zoning Case No. C14-2019-0160, on file at the Planning and Zoning Department, as follows:

Lot 2A, Block C, Resubdivision of No. 1 Parmer Lane Heights Section 1, a subdivision in Travis County Texas, according to the map or plat thereof recorded in Book 45, Page 1, Plat Records, Travis County, Texas (the “Property”),

locally known as 12411 Limerick Avenue in the City of Austin, Travis County, Texas, generally identified in the map attached as **Exhibit “A”**.

PART 2. This ordinance takes effect on _____, 2020.

PASSED AND APPROVED

§
§
§

Steve Adler
Mayor



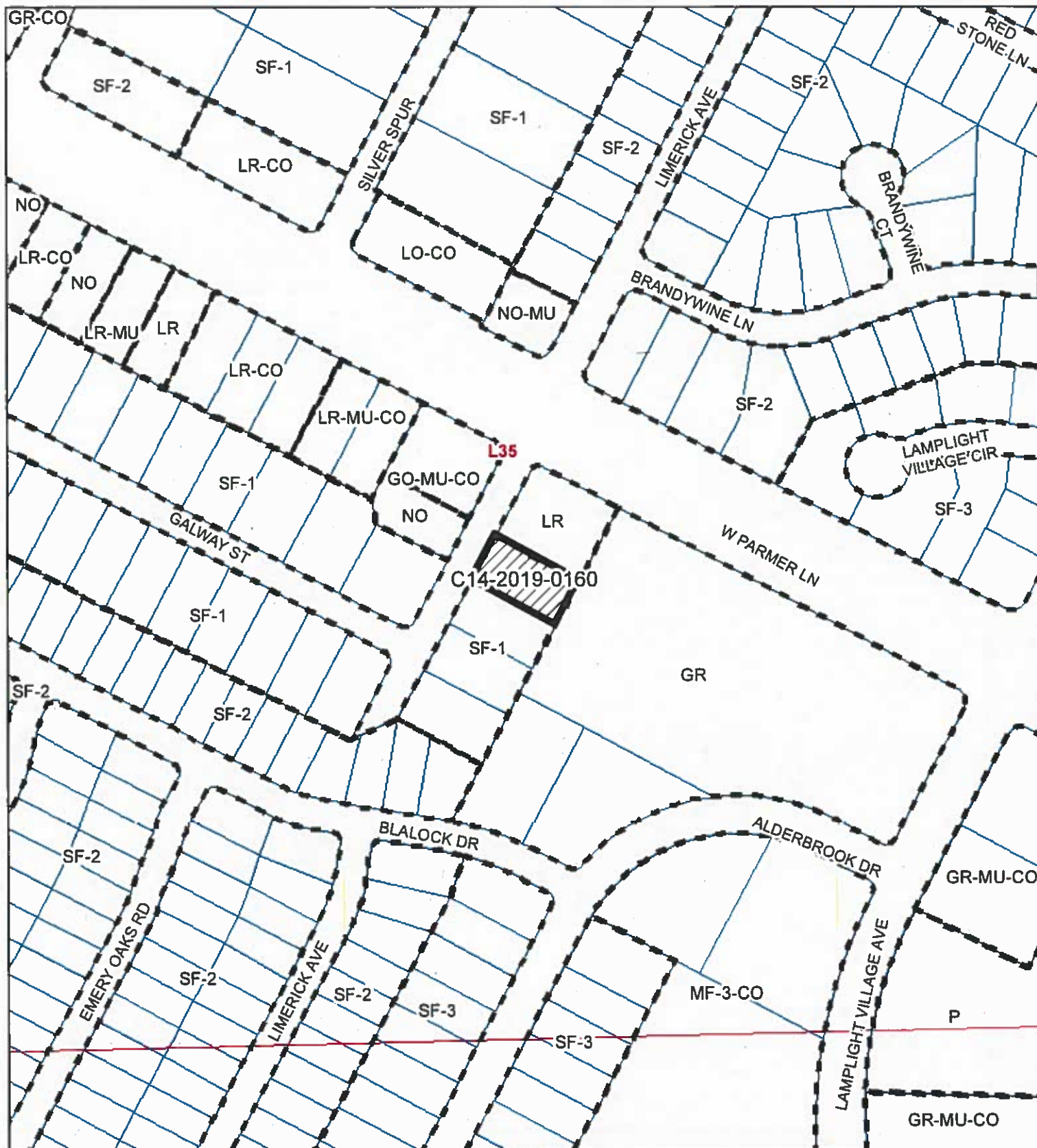

APPROVED: _____ **ATTEST:** _____

Anne L. Morgan
City Attorney

Jannette S. Goodall
City Clerk



1" = 200'

-  SUBJECT TRACT
-  ZONING BOUNDARY
-  PENDING CASE
-  CREEK BUFFER

Limerick Avenue Rezoning **EXHIBIT "A"**

ZONING CASE#: C14-2019-0160
 LOCATION: 12411 Limerick Ave
 SUBJECT AREA: .2747 ACRES
 GRID: L35
 MANAGER: Sherri Sirwaitis



This map has been produced by the Communications Technology Management Dept. on behalf of the Planning Development Review Dept. for the sole purpose of geographic reference. No warranty is made by the City of Austin regarding specific accuracy or completeness.