

Below is a list of questions and concerns that community leaders have received in regards to the development of the tank farm site development known as Springdale Green.

Answers to these questions should be made public and included in the background for this case.

1. When was the last environmental impact assessment of the “tank farm” property at the NE corner of Springdale and Airport?
2. Can you provide the EPA type 1 assessment? Can someone provide an assessment that was performed for the TCEQ?
3. Will the location of the retention pond be specifically tested for contamination? Will there be remediation of the retention pond site? How contaminated is the area where the retention pond will be located?
4. What standards will have to be met for water quality of water leaving the retention pond going downstream?
5. Has there been periodic testing of the water quality around this site? If not, why hasn't there been an established agreement to periodically test and publish the water quality or pay to have WPD do it?
6. Has there been periodic testing of the ground water on and around this site?
7. What will happen to the water quality of the water leaving this site if a 100 year flood comes and overwhelms the system?
8. What is the current toxicity levels of the land? Are there any updated contamination maps like this one?

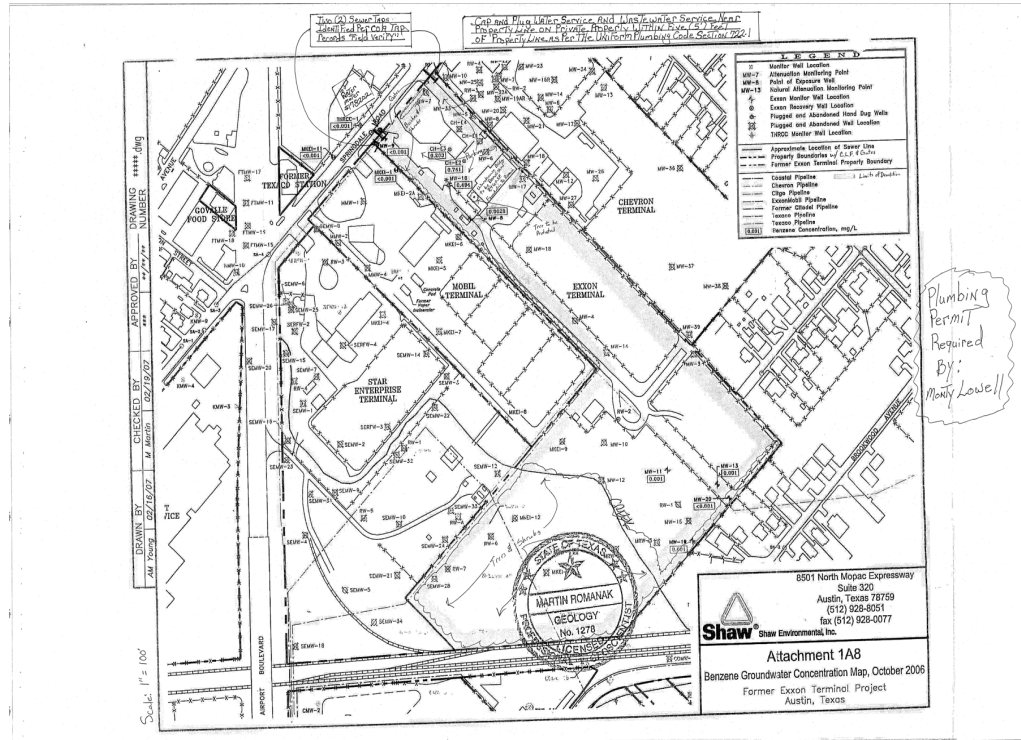

9. What level of environmental remediation has been achieved for this site? Are their plans with the redevelopment to do more remediation?
10. According to TCEQ, this site is withdrawn from voluntary remediation. Why?
11. Will COA Tier 1 requirement of at least a fifty percent increase in setback delineation be met?
12. The water quality measures proposed for this project are not considered to be superior by City of Austin staff. Will these be changed to demonstrate superiority?
13. Proposed development as it relates to Floodplain mitigation is not equal to nor superior to COA Floodplain Modification rules, will this be remedied?
14. Are there any native or any endemic species of this area that we need to consider or plan for?