

**ORDINANCE NO. 20210930-146**

**AN ORDINANCE AMENDING ORDINANCE NO. 20061116-055, WHICH ADOPTED THE EAST RIVERSIDE/OLTORF COMBINED NEIGHBORHOOD PLAN AS AN ELEMENT OF THE IMAGINE AUSTIN COMPREHENSIVE PLAN, TO CHANGE THE LAND USE DESIGNATION ON THE FUTURE LAND USE MAP FOR PROPERTY LOCATED AT 1829 SOUTH IH-35 SERVICE ROAD NORTHBOUND.**

**BE IT ORDAINED BY THE CITY COUNCIL OF THE CITY OF AUSTIN:**

**PART 1.** Ordinance No. 20061116-055 adopted the East Riverside/Oltorf Combined Neighborhood Plan as an element of the Imagine Austin Comprehensive Plan.

**PART 2.** Ordinance No. 20061116-055 is amended to change the land use designation from commercial use to multifamily use for the property located at 1829 South IH-35 Service Road Northbound on the future land use map attached as **Exhibit "A"** and incorporated in this ordinance and described in File NPA-2020-0021.01 at the Housing and Planning Department.

**PART 3.** This ordinance takes effect on October 11, 2021.

**PASSED AND APPROVED**

\_\_\_\_\_, September 30, 2021

§  
§  
§

  
\_\_\_\_\_  
Steve Adler  
Mayor

**APPROVED:**

  
\_\_\_\_\_  
Anne L. Morgan  
City Attorney

**ATTEST:**

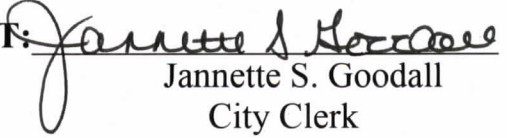
  
\_\_\_\_\_  
Jannette S. Goodall  
City Clerk

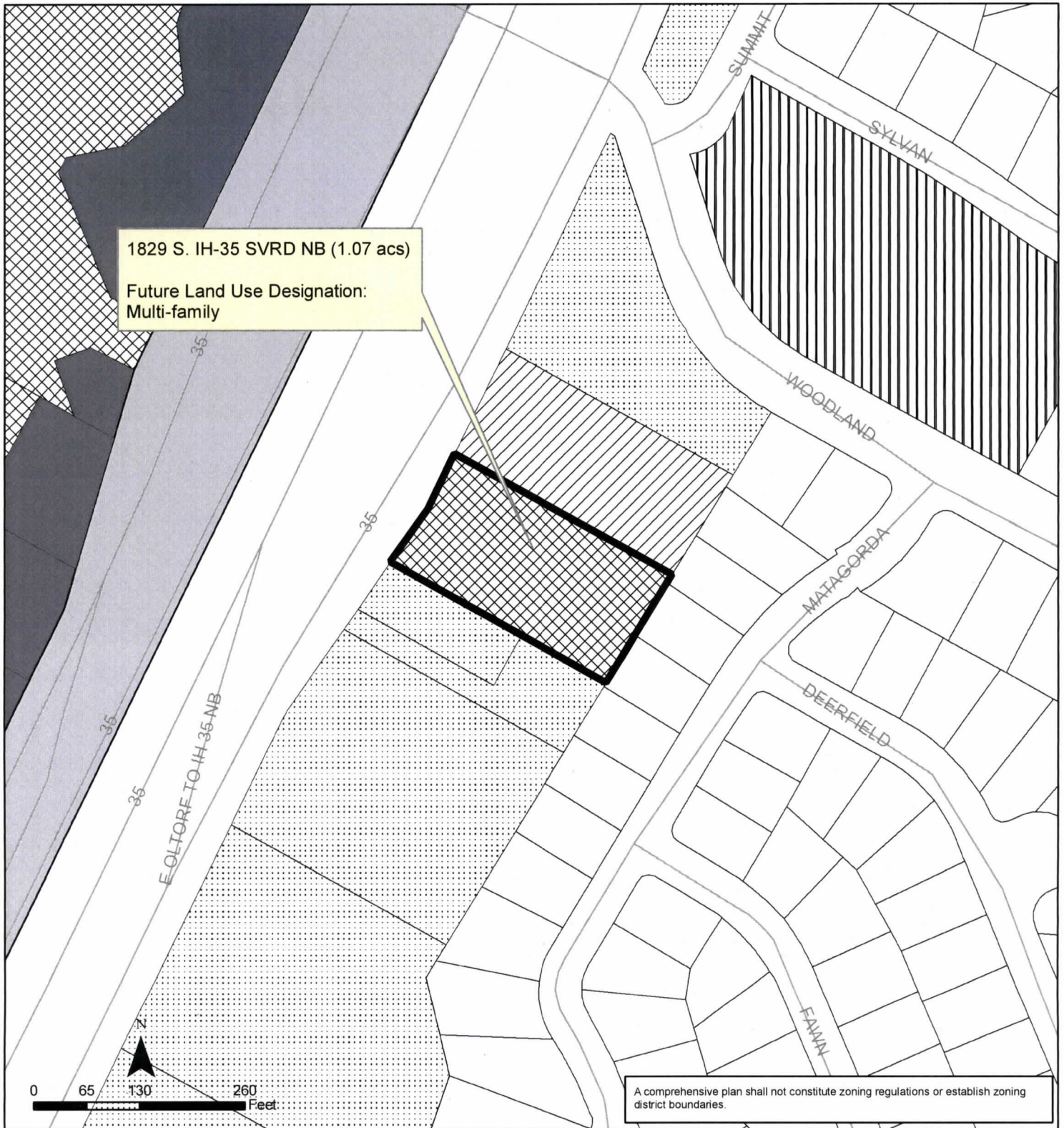

## Exhibit A

### East Riverside/Oltorf Combined (Riverside) Neighborhood Planning Area Amendment NPA-2020-0021.01

This product is for informational purposes and may not have been prepared for or be suitable for legal, engineering, or surveying purposes. It does not represent an on-the-ground survey and represents only the approximate relative location of property boundaries.

This product has been produced by the Planning and Zoning Department for the sole purpose of geographic reference. No warranty is made by the City of Austin regarding specific accuracy or completeness.

#### Future Land Use

|  |                              |  |                         |
|--|------------------------------|--|-------------------------|
|  | Subject Property             |  | Office                  |
|  | Single-Family                |  | Mixed Use/Office        |
|  | Higher-Density Single-Family |  | Civic                   |
|  | Multi-Family                 |  | Recreation & Open Space |
|  | Commercial                   |  | Transportation          |
|  | Mixed Use                    |  | Excluded from FLUM      |
|  | Specific Regulating District |  |                         |

