

ORDINANCE NO. 20211014-089

AN ORDINANCE REZONING AND CHANGING THE ZONING MAP FOR THE PROPERTY LOCATED AT 300 PRESSLER STREET, AND 1409 AND 1501 WEST 3RD STREET IN THE OLD WEST AUSTIN NEIGHBORHOOD PLAN AREA FROM GENERAL COMMERCIAL SERVICES-CONDITIONAL OVERLAY-NEIGHBORHOOD PLAN (CS-CO-NP) COMBINING DISTRICT TO LIMITED INDUSTRIAL SERVICES-PLANNED DEVELOPMENT AREA-NEIGHBORHOOD PLAN (LI-PDA-NP) COMBINING DISTRICT.

BE IT ORDAINED BY THE CITY COUNCIL OF THE CITY OF AUSTIN:

PART 1. The zoning map established by Section 25-2-191 of the City Code is amended to change the base district from general commercial services-conditional overlay-neighborhood plan (CS-CO-NP) combining district to limited industrial services-planned development area-neighborhood plan (LI-PDA-NP) combining district on the property described in Zoning Case No. C14-2021-0112, on file at the Housing and Planning Department, as follows:

1.170 acres (approximately 50,963 square feet) in Outlot 1, Division “Z” of Original City of Austin, Texas in Travis County, Texas, said 1.170 acres of land being more particularly described by metes and bounds in **Exhibit “A”** incorporated into this ordinance (the “Property”),

locally known as 300 Pressler Street, and 1409 and 1501 West 3rd Street, in the City of Austin, Travis County, Texas and generally identified in the map attached as **Exhibit “B”**.

PART 2. Except as specifically provided in Part 3 and Part 4 of this ordinance, the Property may be developed and used in accordance with the regulations established for the limited industrial services (LI) base district and other applicable requirements of the City Code.

PART 3. Development of the Property shall comply with Section 25-2-648 (*Planned Development Area Performance Standards*) of the City Code.

PART 4. Development of the Property is subject to the regulations set forth in this part:

(A) The following uses are additional permitted uses of the Property:

Alternative financial services
Bed and Breakfast (Group 2)

Bed and Breakfast (Group 1)
Cocktail lounge

Consumer repair services	Family home
Guidance services	Hospital services (limited)
Pawn shop services	Pet services
Private primary educational facilities	Private secondary educational facilities
Public primary educational facilities	Public secondary educational facilities

(B) The following uses are prohibited uses on the Property:

Adult-oriented businesses	Basic Industry
Drop-off recycling collection facility	Exterminating services
General warehousing and distribution	Light manufacturing
Liquor sales	Scrap and salvage
Railroad facilities	Recycling center
Resource extraction	Vehicle storage

(C) The following uses are conditional uses of the Property:

Automotive rentals	Automotive repair services
Automotive sales	Automotive washing (of any type)
Commercial blood plasma center	Construction sales and services
Convenience storage	Equipment repair services
Equipment sales	Hospital services (general)
Laundry services	Maintenance and service facilities
Service station	

(D) The following site development standards and regulations apply to the Property.

1. The maximum height of a building or structure on the Property shall not exceed 75 feet.
2. The minimum setbacks are: 5 feet for front yard,
0 feet for street side yard,
0 feet for interior side yard, and
0 feet for rear yard.
3. The maximum building coverage on the Property is 95 percent.
4. The maximum impervious cover for the Property is 95 percent.

5. The maximum floor-to-area ratio (FAR) on the Property is 2:1.
6. The minimum site area for multifamily residential use on the Property does not apply.
7. The minimum parking requirements on the Property are reduced by twenty (20) spaces for every dedicated and reserved car-sharing parking space, bicycle-sharing station, scooter-sharing station, or 3 Transportation Network Company vehicle parking spaces provided in connection with a program approved by the Director.
8. The maximum percentage of compact parking on the Property shall not exceed 26.5%.

PART 5. Except as otherwise specifically provided by this ordinance, the Property is subject to all other rules, regulations, and ordinances of the City, including Ordinance No. 020926-26 that established zoning for the Old West Austin Neighborhood Plan.

PART 6. This ordinance takes effect on October 25, 2021.

PASSED AND APPROVED

_____, 2021

§
§
§

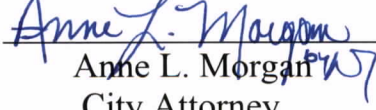

Steve Adler
Mayor

APPROVED: 

Anne L. Morgan
City Attorney

ATTEST: 

Jannette S. Goodall
City Clerk



**Professional Land Surveying, Inc.
Surveying and Mapping**

Office: 512-443-1724
Fax: 512-389-0943

3500 McCall Lane
Austin, Texas 78744

**1.170 ACRES
TRAVIS COUNTY, TEXAS**

A DESCRIPTION OF 1.170 ACRES (APPROXIMATELY 50,963 SQUARE FEET) IN OUTLOT 1, DIVISION "Z" OF ORIGINAL CITY OF AUSTIN, TEXAS, IN TRAVIS COUNTY, TEXAS, BEING ALL OF A 1.170 ACRE TRACT CONVEYED TO PRESSLER RRI, LP, IN A SPECIAL WARRANTY DEED EXECUTED APRIL 19, 2017 AND RECORDED IN DOCUMENT NO. 2017068325 OF THE OFFICIAL PUBLIC RECORDS OF TRAVIS COUNTY, TEXAS; SAID 1.170 ACRES BEING MORE PARTICULARLY DESCRIBED BY METES AND BOUNDS AS FOLLOWS:

BEGINNING at a 1/2" rebar with "Terra Firma" cap found at the intersection of the southwest right-of-way line of the International and Great Northern Railroad (aka Missouri Pacific Railroad) (right-of-way width varies) and the northwest right-of-way line of Pressler Street (right-of-way width varies), being the easternmost corner of the said 1.170 acre tract, from which a 1/2" rebar found at the intersection of the southwest right-of-way line of the International and Great Northern Railroad (aka Missouri Pacific Railroad) and the southeast right-of-way line of Pressler Street, being the northernmost corner of a 1.072 acre tract described in Document No. 2017068325 of the Official Public Records of Travis County, Texas, bears South 66°06'29" East, a distance of 51.04 feet;

THENCE South 24°18'01" West with the northwest right-of-way line of Pressler Street and the southeast line of the said 1.170 acre tract, a distance of 131.28 feet to a 1/2" rebar with "Chaparral" cap set for the southernmost corner of the said 1.170 acre tract, being on the northeast line of a 77 acre tract called the "Reserve" Tract in Division Z of The City Of Austin (aka Sand Beach Reserve) and conveyed to the City Of Austin in Volume 769, Page 57 of the Deed Records of Travis County, Texas, from which a cotton spindle found in the base of a chinaberry tree for an angle point in the northeast line of the Sand Beach Reserve, bears South 65°35'15" East, a distance of 1020.26 feet and a 1/2" rebar with "Terra Firma" cap found, bears South 24°18'01" West, a distance of 3.35 feet;

THENCE North 65°35'15" West with the southwest line of the said 1.170 acre tract and the northeast line of the Sand Beach Reserve, a distance of 394.93 feet to a 1/2" rebar with "Chaparral" cap set for the westernmost corner of the said 1.170 acre tract, from which a 1/2" rebar with "MWM" aluminum cap found for the northernmost corner of the Sand Beach Reserve, bears North 65°35'15" West, a distance of 459.85 feet;

THENCE with the northwest line of the said 1.170 acre tract and the southeast line of a tract of land (no acreage given) described in Volume 10870, Page 35 of the Real

Property Records of Travis County, Texas, the following two (2) courses and distances:

1. North 22°13'51" East, a distance of 2.11 feet to a 1/2" rebar found
2. North 22°13'51" East, a distance of 110.45 feet to a 1/2" rebar found in the southwest right-of-way line of the International and Great Northern Railroad (aka Missouri Pacific Railroad), being a northern corner of the said 1.170 acre tract, being also the easternmost corner of the tract of land (no acreage given) described in Volume 10870, Page 35 of the Real Property Records of Travis County, Texas, from which a an old 6" diameter cedar fence post found in the southwest right-of-way line of the International and Great Northern Railroad (aka Missouri Pacific Railroad), being the northernmost corner of the tract of land (no acreage given) described in Volume 10870, Page 35 of the Real Property Records of Travis County, Texas, bears North 66°12'47" West, a distance of 50.00 feet;

THENCE with the southwest right-of-way line of the International and Great Northern Railroad (aka Missouri Pacific Railroad) and the northeast line of the said 1.170 acre tract, the following four (4) courses and distances:

1. South 65°41'13" East, a distance of 49.91 feet to a 1/2" rebar found
2. North 24°17'27" East, a distance of 17.29 feet to a cotton spindle found
3. South 65°49'07" East, a distance of 248.89 feet to a 5/8" rebar found
4. South 65°50'01" East, a distance of 100.20 feet to the **POINT OF BEGINNING**, containing 1.170 acres of land, more or less.

Surveyed on the ground on February 8, 2017.

Bearing Basis: The Texas Coordinate System of 1983 (NAD83), Central Zone, based on GPS solutions from The National Geodetic Survey (NGS) on-line positioning user service (OPUS).



Joe Ben Early, Jr.
Registered Professional Land Surveyor
State of Texas No. 6016
T.B.P.L.S. Firm No. 10124500

Date

10/5/17

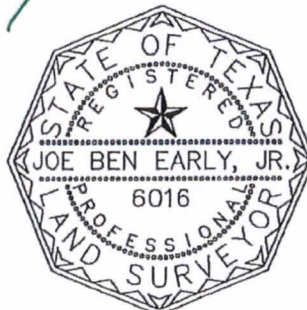

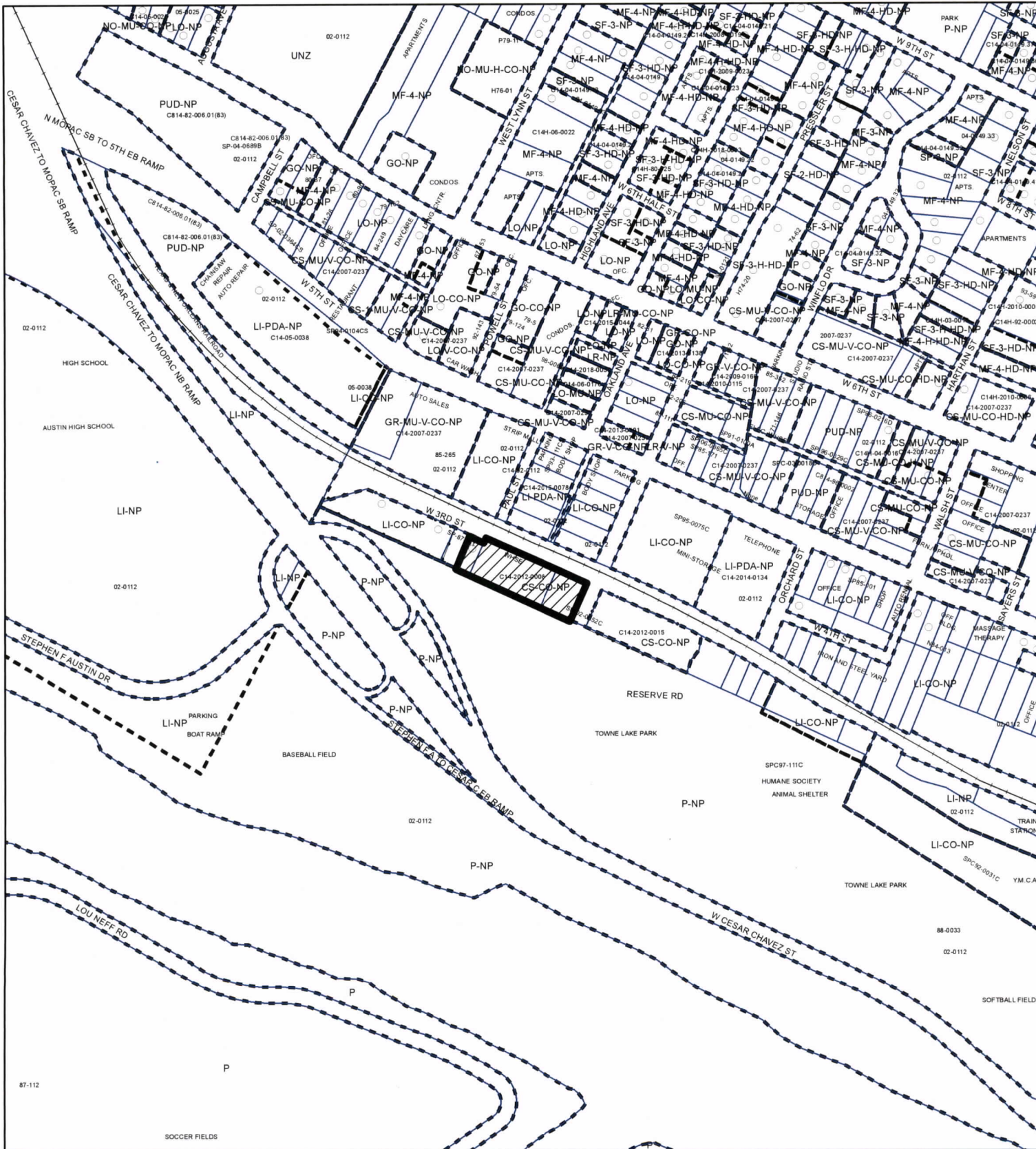

SUBJECT TRACT



PENDING CASE



ZONING BOUNDARY

ZONING

ZONING CASE#: C14-2021-0112

Exhibit B



This product is for informational purposes and may not have been prepared for or be suitable for legal, engineering, or surveying purposes. It does not represent an on-the-ground survey and represents only the approximate relative location of property boundaries.

This product has been produced by the Housing and Planning Department for the sole purpose of geographic reference. No warranty is made by the City of Austin regarding specific accuracy or

Created: 7/1/2021

1" = 400'