

ORDINANCE NO. 20050609-Z004

AN ORDINANCE ESTABLISHING INITIAL PERMANENT ZONING FOR THE PROPERTY LOCATED AT 2206, 2208, 2300, 2306, 2308, AND 2310 CINDY LANE AND CHANGING THE ZONING MAP FROM INTERIM RURAL RESIDENCE (I-RR) DISTRICT TO SINGLE FAMILY RESIDENCE LARGE LOT (SF-1) DISTRICT.

BE IT ORDAINED BY THE CITY COUNCIL OF THE CITY OF AUSTIN:

PART 1. The zoning map established by Section 25-2-191 of the City Code is amended to change the base district from interim rural residence (I-RR) district to single family residence large lot (SF-1) district on the property described in Zoning Case No. C14-05-0054, on file at the Neighborhood Planning and Zoning Department, as follows:

Lots 1-6, Block E, Tomanet Estates Section 1 Subdivision, a subdivision in the City of Austin, Travis County, Texas, according to the map or plat of record in Plat Book 16, Page 4, of the Plat Records of Travis County, Texas,

locally known as 2206, 2208, 2300, 2306, 2308, and 2310 Cindy Lane, in the City of Austin, Travis County, Texas, and generally identified in the map attached as Exhibit "A".

PART 2. This ordinance takes effect on June 20, 2005.

PASSED AND APPROVED

_____, June 9 _____, 2005

§
§
§

Will Wynn
Mayor

APPROVED:

David Allan Smith
City Attorney

ATTEST:

Shirley A. Brown
City Clerk

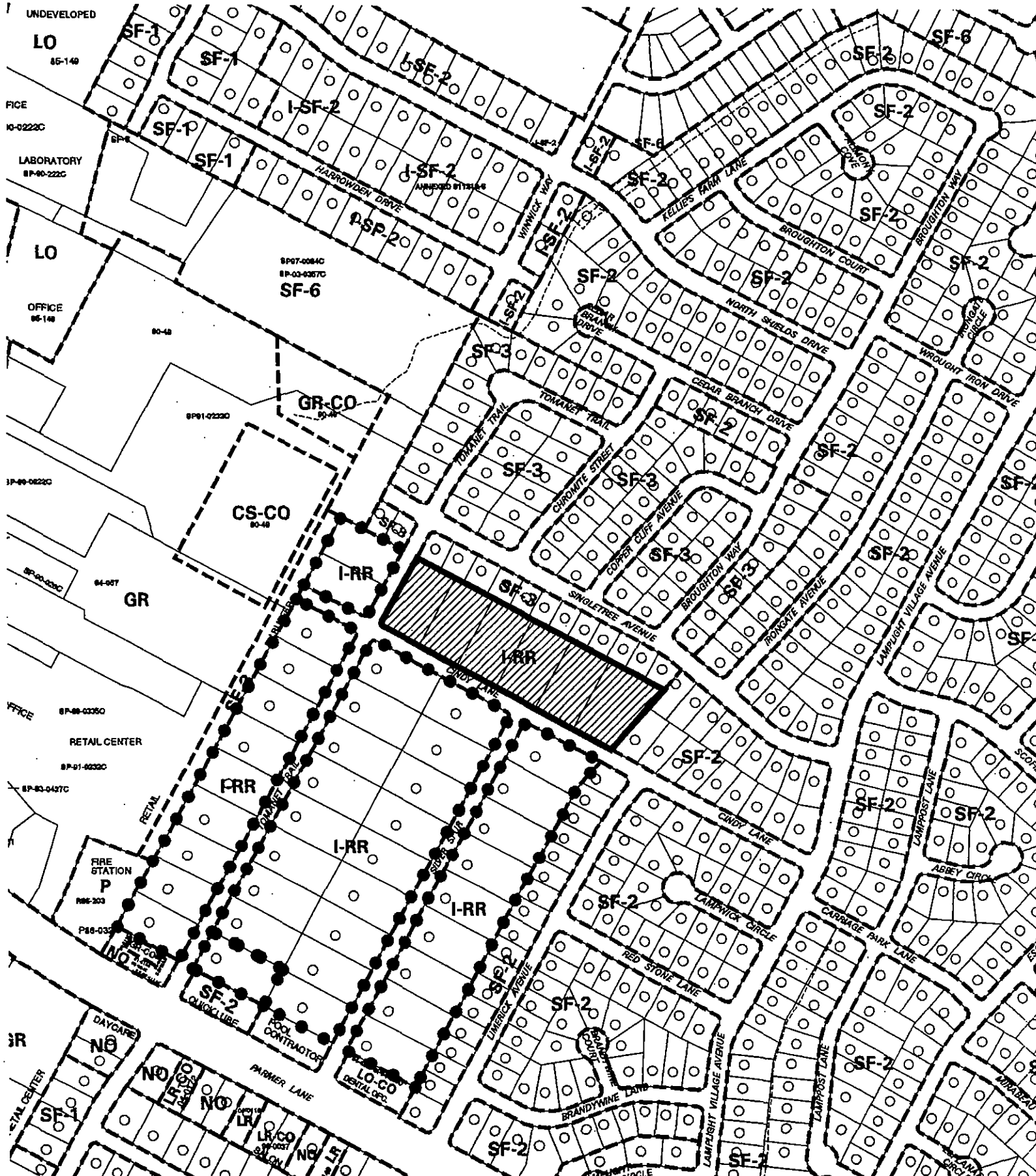

SUBJECT TRACT
PENDING CASE
ZONING BOUNDARY
CASE MGR: S. GAGER

CASE #: C14-05-0054
ADDRESS: TOMANET TRL BETWEEN
CINDY LN & SILVER SPUR
SUBJECT AREA (acres): 4.848

ZONING EXHIBIT A

DATE: 05-04
INTLS: SM

CITY GRID
REFERENCE
NUMBER
L35