



LIMBACHER & GODFREY
ARCHITECTS

A Conversation with Key Stakeholders Barton Springs Bathhouse Interpretive Experience

November 14, 2019

Project Summary

Provide interpretive planning and exhibit design services for the new iteration of the *Splash!* exhibit to be installed in the Bathhouse Rehabilitation project.

Research and Programming

- Initial scoping exercise, working with PARD, partners and stakeholders, to define the quantity, content, and locations for interpretive planning elements
- Interpretive planning design brief and exhibit space program
- Stakeholder meetings and public engagement

Meeting Goals

- Share *draft* interpretive planning goals, objectives, audiences, content themes, and design vocabulary for feedback
- Develop approach for upcoming community meeting

Introductions

Hello, we're



fd2s

Independently owned since 1985

Based in Austin, Texas

*Focused on brand development, wayfinding consulting,
placemaking, and donor recognition*



SEA SCOUT BASE GALVESTON

Sea Scout Base Galveston *Galveston, Texas*



Sea Scout Base Galveston *Galveston, Texas*





SHANGRI LA BOTANICAL GARDENS

Shangri La Botanical Gardens and Nature Center *Orange, Texas*





HEADWATERS AT THE COMAL

Headwaters at the Comal *New Braunfels, Texas*





AUSTIN CENTRAL LIBRARY

Austin Central Library *Austin, Texas*



Austin Central Library *Austin, Texas*

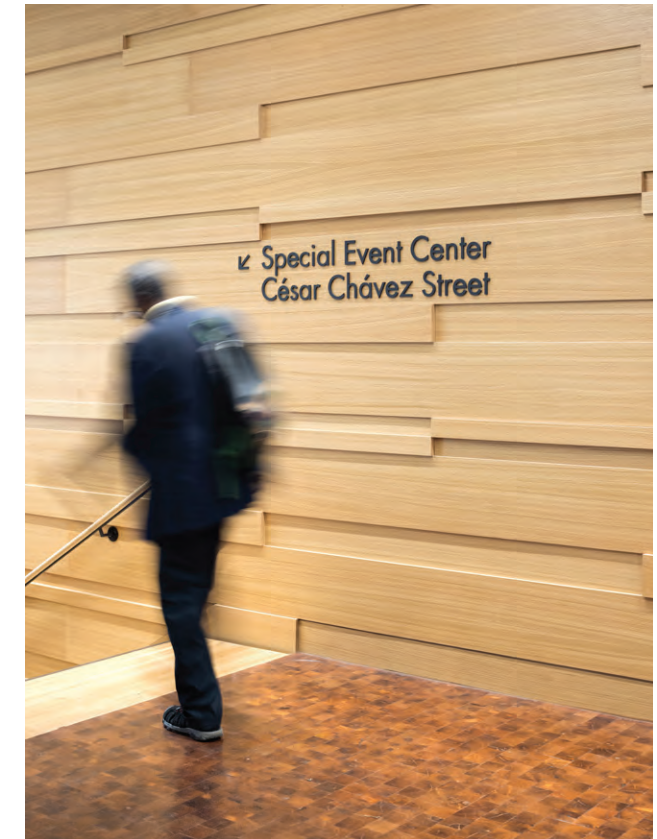

Context

Project Schedule

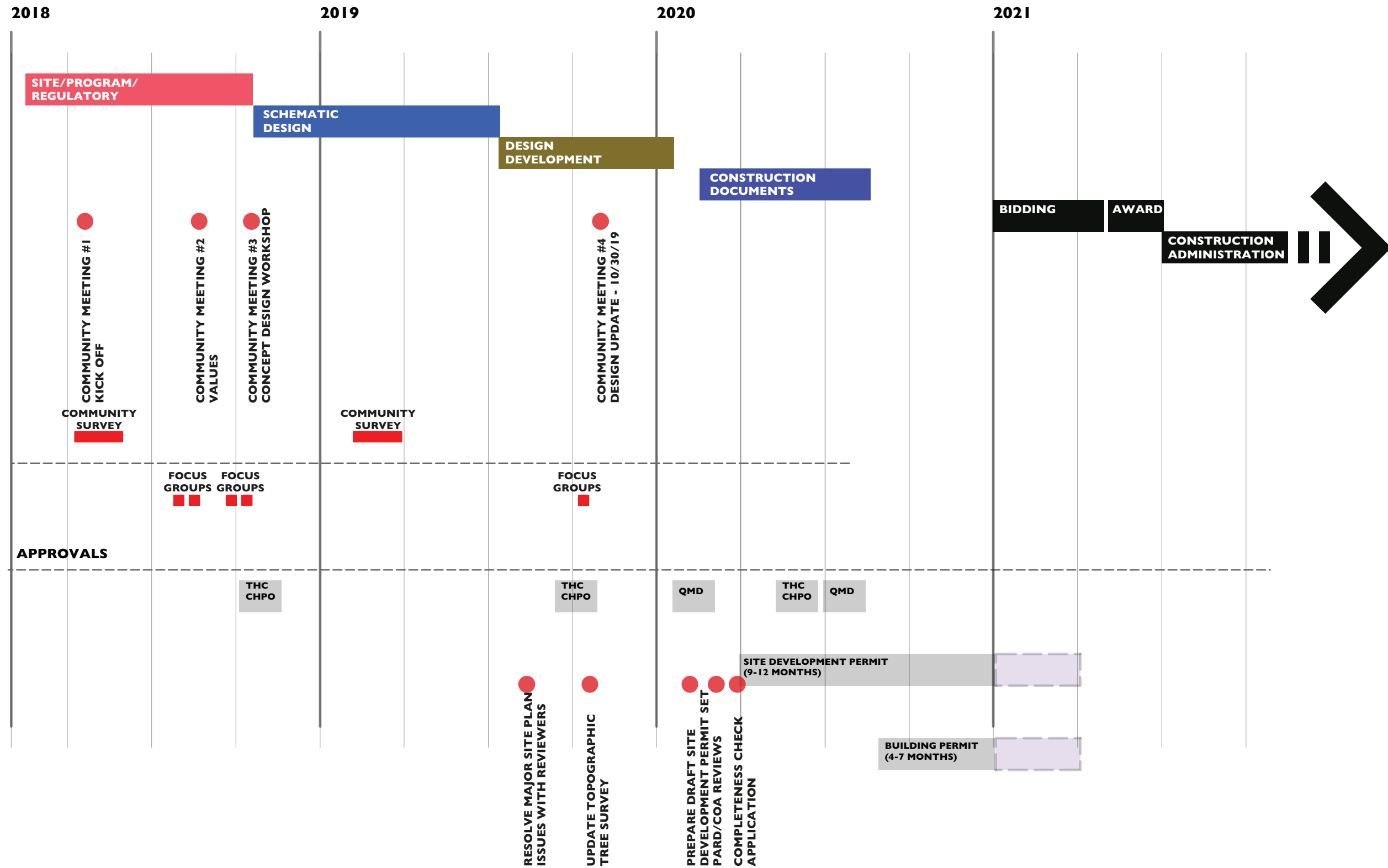

Barton Springs Bathhouse Values

*Based on input from the Community Meeting and Values Workshop
August 14, 2018*

Clarify the Mission — Simplify

- It's a bathhouse – focus on the visitors
- Open to the public as much as possible

Improve the User Experience

- Better, cleaner, possibly more restrooms
- Better privacy for families
- More solar showers
- Better arrival and departure experience

Barton Springs Bathhouse Values *(continued)*

Education

- Education for all users
- Expand the mission to include education in the building and on the grounds
- Educate users to the fragility of the spring complex

Historic Architecture

- Respect the original architecture
- Celebrate the Rotunda. Use it as the main entry
- Enjoy the two-story, naturally-ventilated volumes

Green

- Amplify the green/natural features in the dressing areas
- Consider efforts to reduce the impervious cover and improve stormwater quality

Barton Springs Bathhouse Values *(continued)*

Limit Impact on Ongoing Facility Operation

- One-phase project preferred
- Minimize disruption of Bathhouse and Pool operation
- Maintain ongoing use by swimmers

Bathhouse

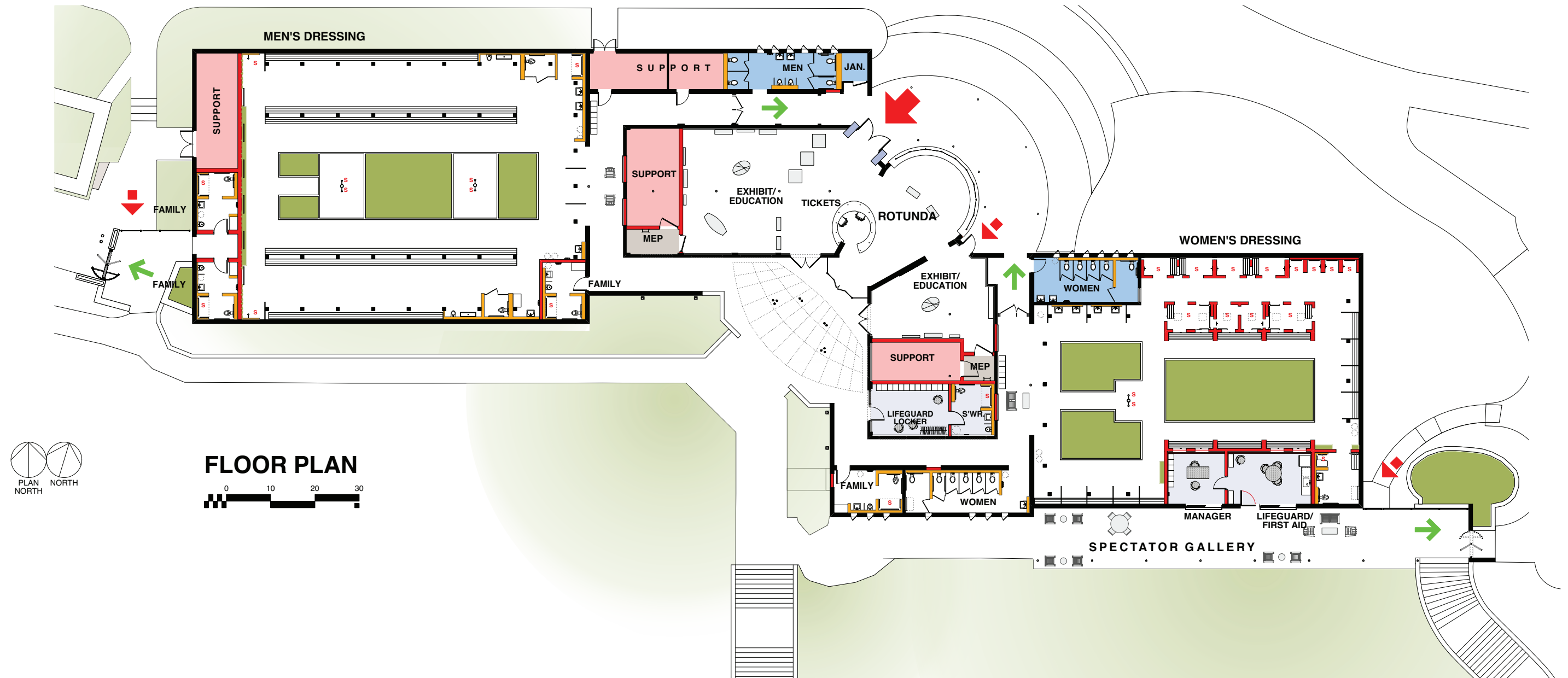

Site

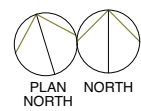

Exhibit/Education Space



Confirmations

Goals

- Continue to provide educational programs to enhance public awareness and community support for *Eurycea sosorum* and *Eurycea waterlooensis*, Barton Springs, and the Edwards Aquifer
- Commit no less than \$45,000 annually to salamander education efforts
- *Other?*

Objectives

Learning

- Visitors will understand the importance of protecting groundwater resources
- Visitors will learn what types of activities negatively affects groundwater and Barton Springs
- Visitors will be provided with information about what they can do to preserve this amazing natural resource
- *Other?*

Objectives

Emotional

- The majority of visitors will want to preserve Barton Springs
- The majority of visitors will feel a connection to groundwater issues
- The majority of visitors will experience the joy of discovery while visiting this exhibit
- *Other?*

Objectives

Behavioral

- Visitors will return to Barton Springs more often
- Visitors will become groundwater stewards
- *Other?*

Audiences

- School groups (all grades)
- Visitors, walk-ins and international
- Families
- Teachers/educators
- Master naturalists
- Pool users
- Flexibility in exhibit to accomodate different groups in a multi-use space
- *Other?*

Content Themes

- Barton Springs is a part of a unique and fragile groundwater system
- The aquifer provides water for both humans and animals
- Groundwater is a finite and critical resource
- The quantity and quality of groundwater can be impacted by human behavior
- History of Park and Pool
- Inspiring stewardship
- *Other?*

Design Vocabulary

- Defining Level of Interactivity

Level 1

Static imagery and text, physical objects for interactive exhibits. Built for durability and designed for permanent placement; i.e. little to no changes anticipated to content over time.



Level 2

Combination of static and digital displays with emphasis on large-scale static. Digital components often leveraged for dynamic content that will be updated over time, requires a content management system.



Level 3

Emphasis on technology-based, mixed-media exhibits with interactive components that allow for ongoing content renewal. Significant investment in hardware, software, and data management.



Design Vocabulary

- Level of Interactivity: Level 1 / **Level 2 / Level 3**

Level 2



The Alamo Wall of History, San Antonio, Texas

Combination of static and digital displays, with emphasis on large-scale static displays. Digital components often leveraged for dynamic content that will also be updated over time, which involves a content management system.



The Story of Texas | Texas State History Museum, Austin, Texas

Level 3



Morgan Stanley Clinical Building, Mittal Children's Medical Centre, London, UK

Emphasis on technology-based, mixed-media exhibits with interactive components that allow for ongoing content renewal. Significant investment required in hardware, software, and data management.



Heineken promotional installation

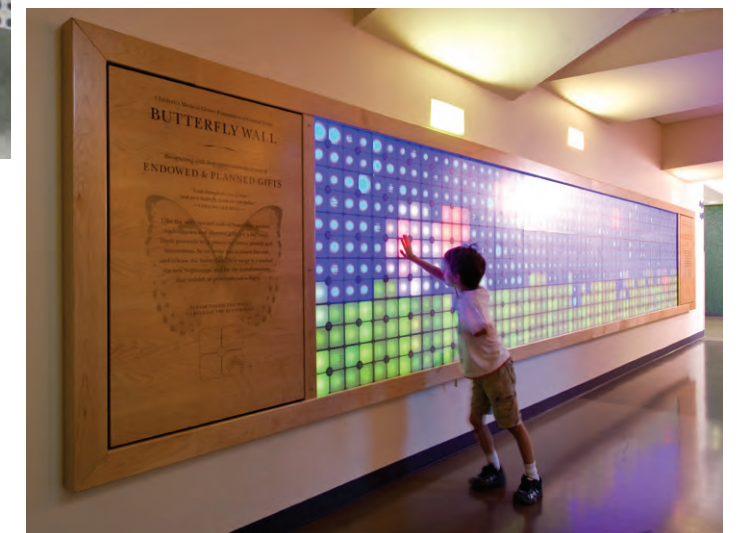

Dell Children's Medical Center, Austin, Texas

Design Vocabulary

- Level of Interactivity: **Level 2.5**

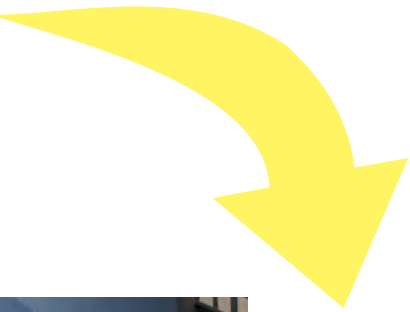

Level 2



The Alamo Wall of History, San Antonio, Texas



The Story of Texas | Texas State History Museum, Austin, Texas

Combination of static and digital displays, with emphasis on large-scale static displays. Digital components often leveraged for dynamic content that will also be updated over time, which involves a content management system.

Level 3



Morgan Stanley Clinical Building, Mittal Children's Medical Centre, London, UK

Emphasis on technology-based, mixed-media exhibits with interactive components that allow for ongoing content renewal. Significant investment required in hardware, software, and data management.



Heineken promotional installation



Dell Children's Medical Center, Austin, Texas

Design Vocabulary

- Form factors and ideas
 - *Salamander*
 - *Manipulatives*
 - *Videos for updatable content*
 - *Virtual reality*
 - *Water feature*
 - *Real-time pool information: water temperature, turbidity*
- What's the most impactful element of the current Splash exhibit?
- Image sorting exercise

Next Steps

Community Engagement

- **Community Meeting #1: Reflection and Vision**

Thursday, December 5, 2019, 5:30-7:30pm

2201 William Barton Drive

Austin, TX 78746

(per City webpage)

The purpose of this meeting is to gather input from the community about what *Splash!* has meant to you and to help PARD identify how a revitalized exhibit space can continue to educate the next generation of visitors to Barton Springs.

- Potential format: Presentation followed by Q&A
- Anticipate and recommend questions and issues to be presented at public meeting.

Schedule

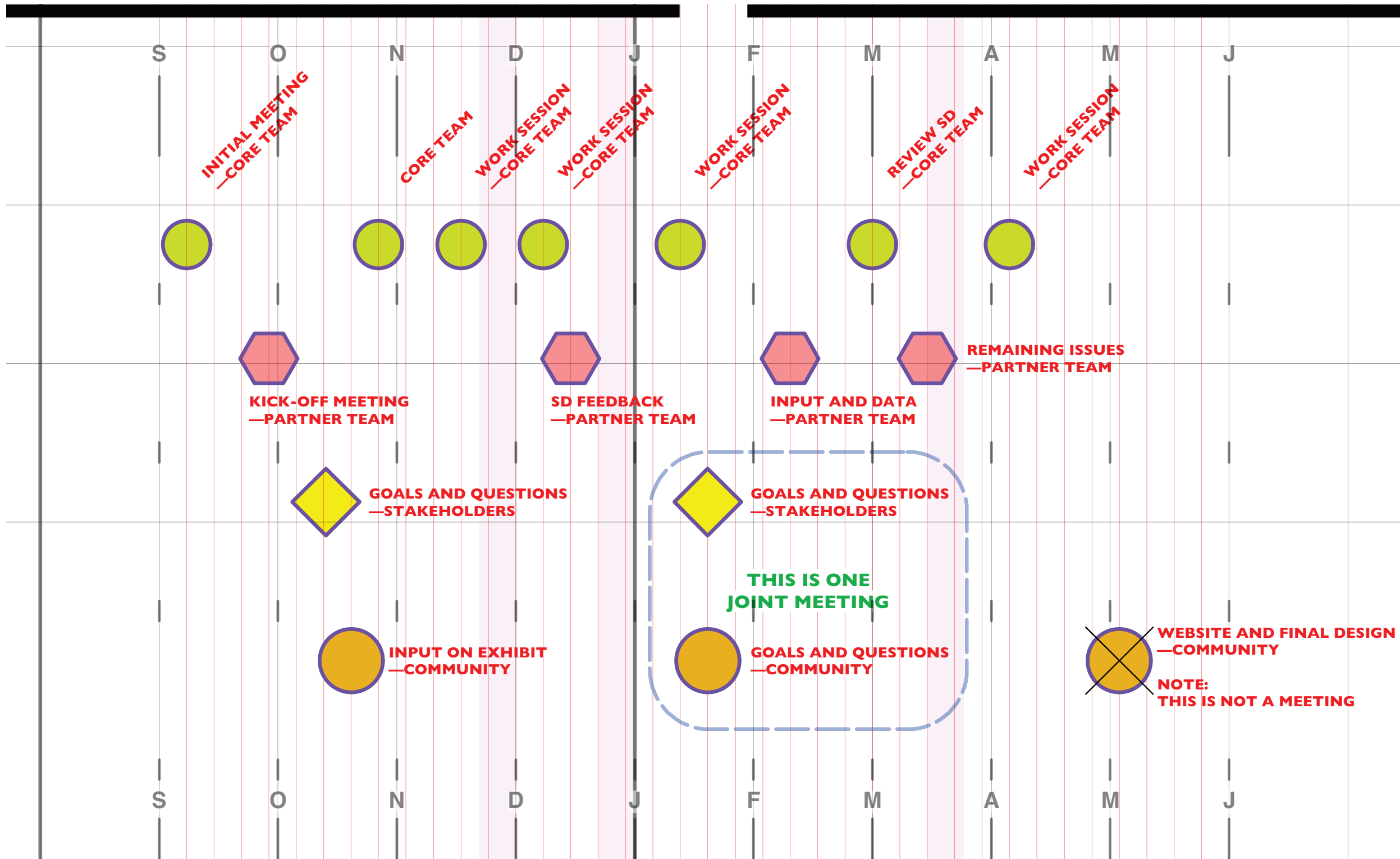

LIMBACHER & GODFREY
ARCHITECTS

