

WOOLDRIDGE SQUARE_public meeting #2
2016/08/04

AGENDA

INTRODUCTION

SURVEY ANALYSIS

VISION

DESIGN REVIEW

BREAKOUT

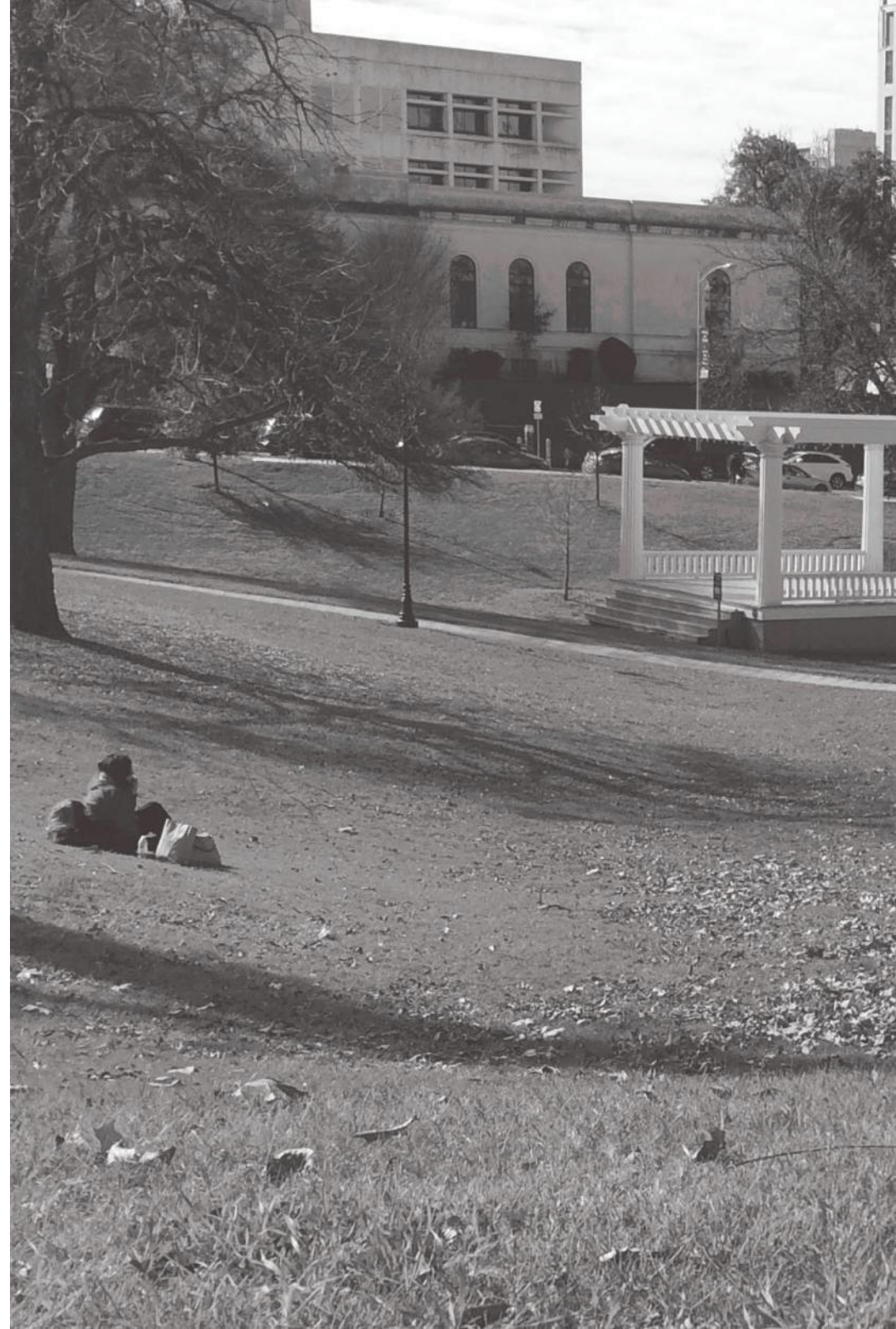

PROJECT SCHEDULE

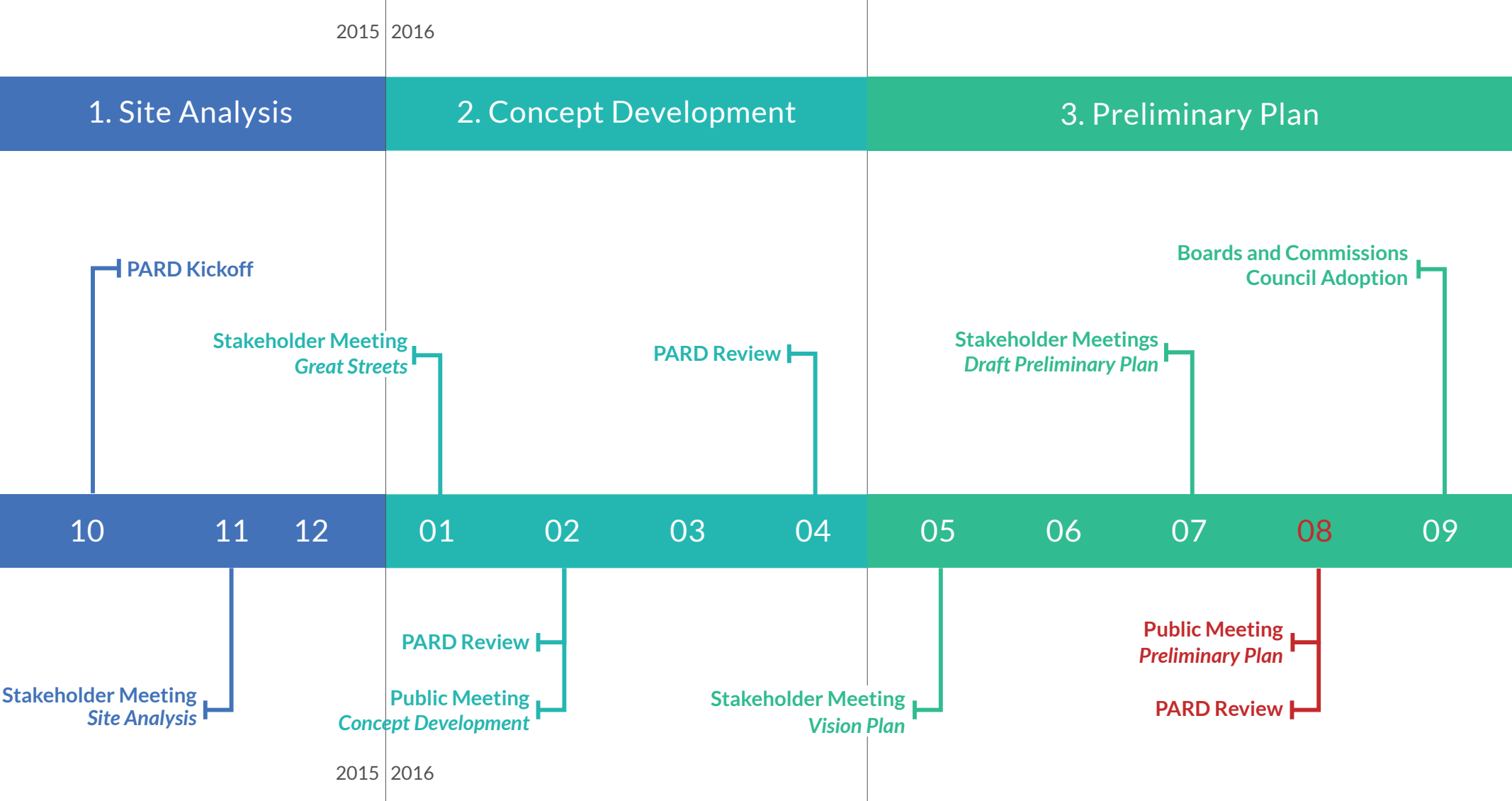

SURVEY ANALYSIS

Existing Conditions



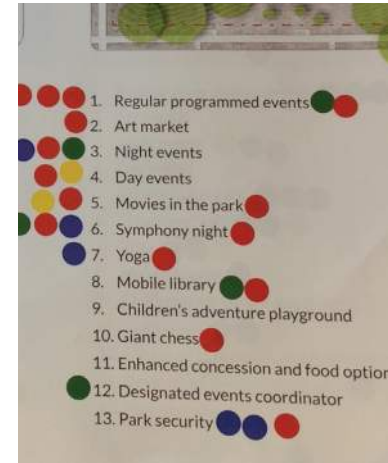
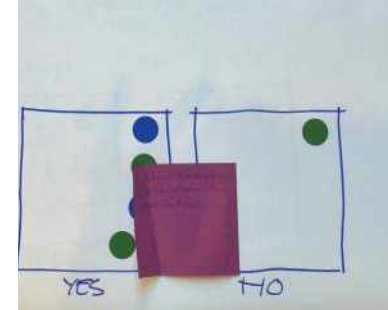

Wooldridge Square is an historically significant place. These findings tell us how to preserve its history as we improve other aspects of the Square.

AREAS OF CONSENSUS

- The existing walk (A) and Bandstand (B) must retain their historical alignment and character.

AREAS FOR IMPROVEMENT

- There is an opportunity to reveal the historical location of Little Shoal Creek (C).

SURVEY RESPONSES

HISTORIC WALK

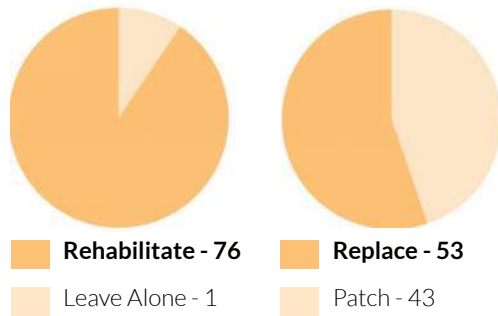

LITTLE SHOAL CREEK

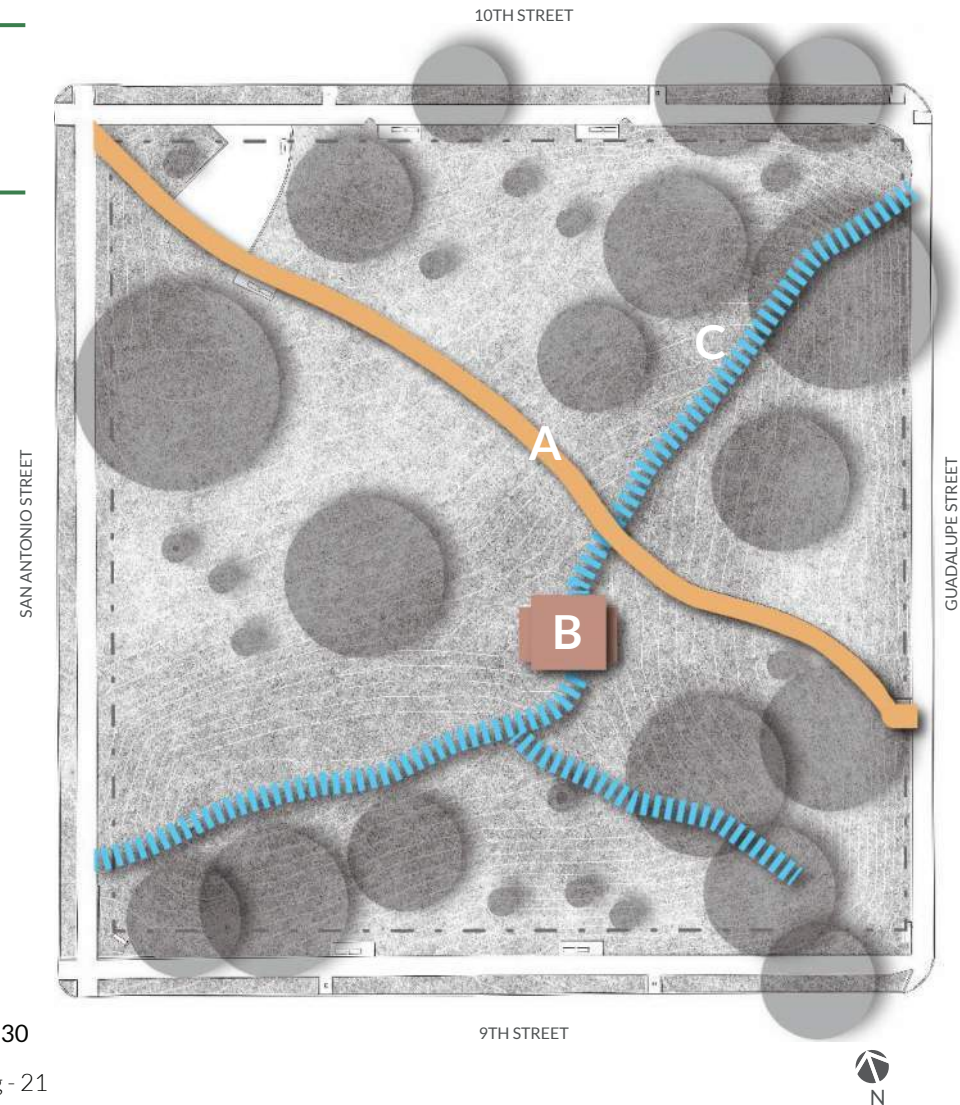
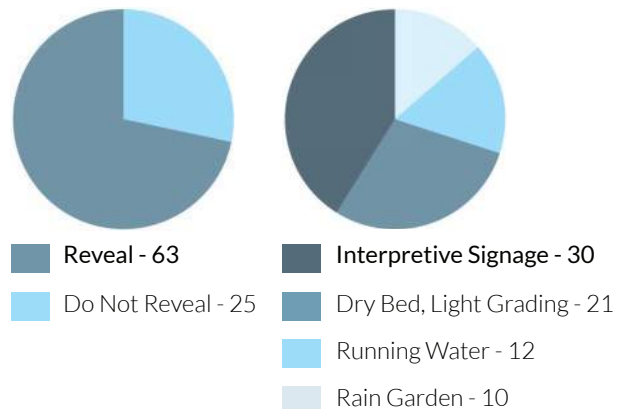



ACCESSIBILITY

Wooldridge Square does not meet current ADA standards. These findings confirm that better access should be considered in a sensitive and appropriate approach.

AREAS OF CONSENSUS

- Surveyed constituents do not want accessibility to dominate historic features.

AREAS FOR IMPROVEMENT

- Surveyed constituents strongly preferred the proposal of an additional accessible path - shown right - over proposals to realign the existing walk.
- ADA access to and onto the Bandstand was voted by constituents as *one of the top five desired infrastructure upgrades*.
- Constituents also voiced a desire for ADA compliant parking.

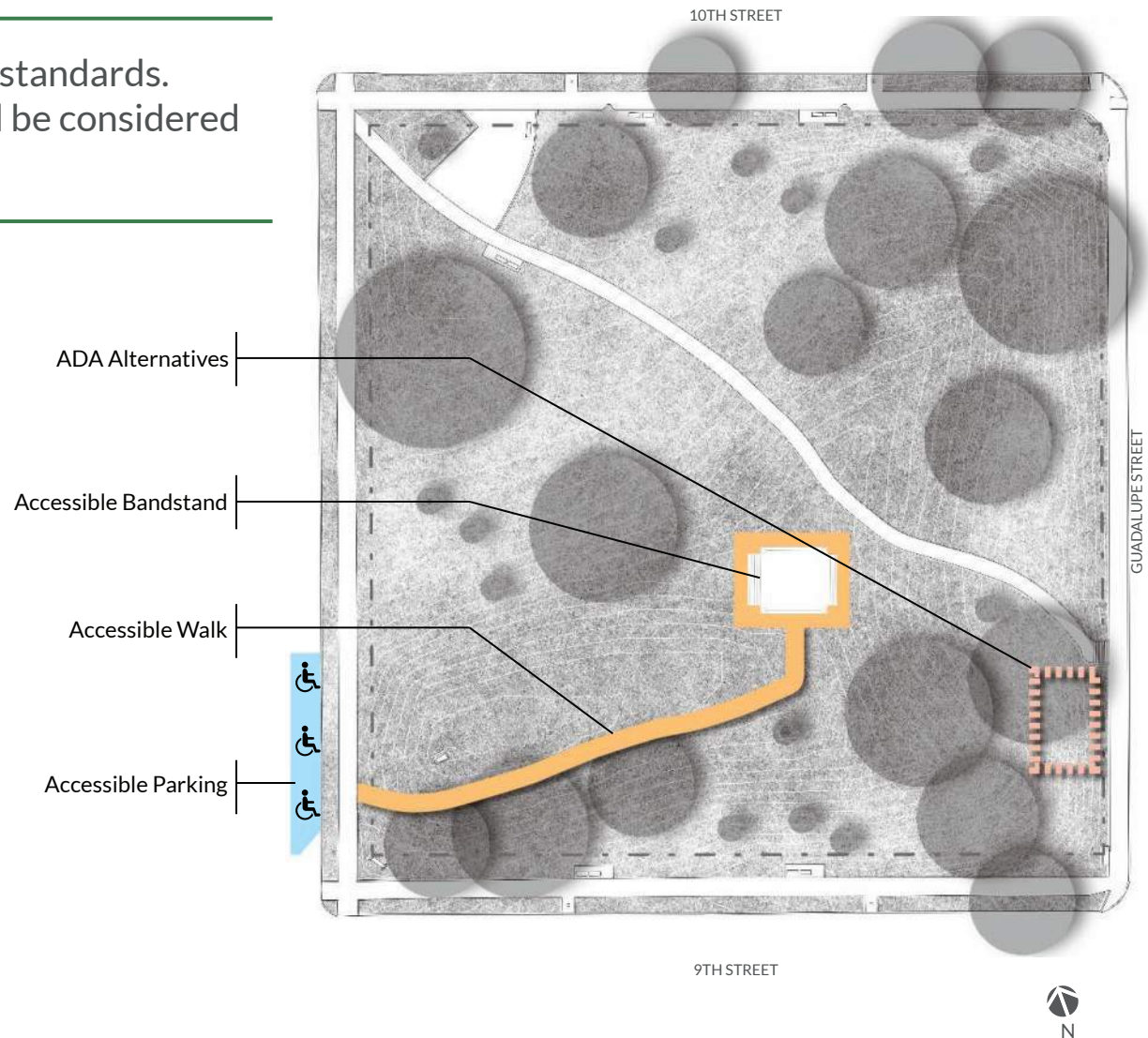

GREAT STREETS

The Great Streets Program serves to improve the quality of downtown streetscape. These findings tell us which unique aspects of this block to acknowledge as we implement Great Streets.

AREAS OF CONSENSUS

- Preserve landmark viewsheds. (A, B, & C)
- Great Streets improvements should “push” into the ROW from edge of existing curb.

AREAS FOR IMPROVEMENT

- Adapt Great Streets to fit the needs of the Square.
- Improve visual connections to neighboring civic institutions on 9th and 10th street.
- Current limitations include narrow sidewalks and not enough street trees.

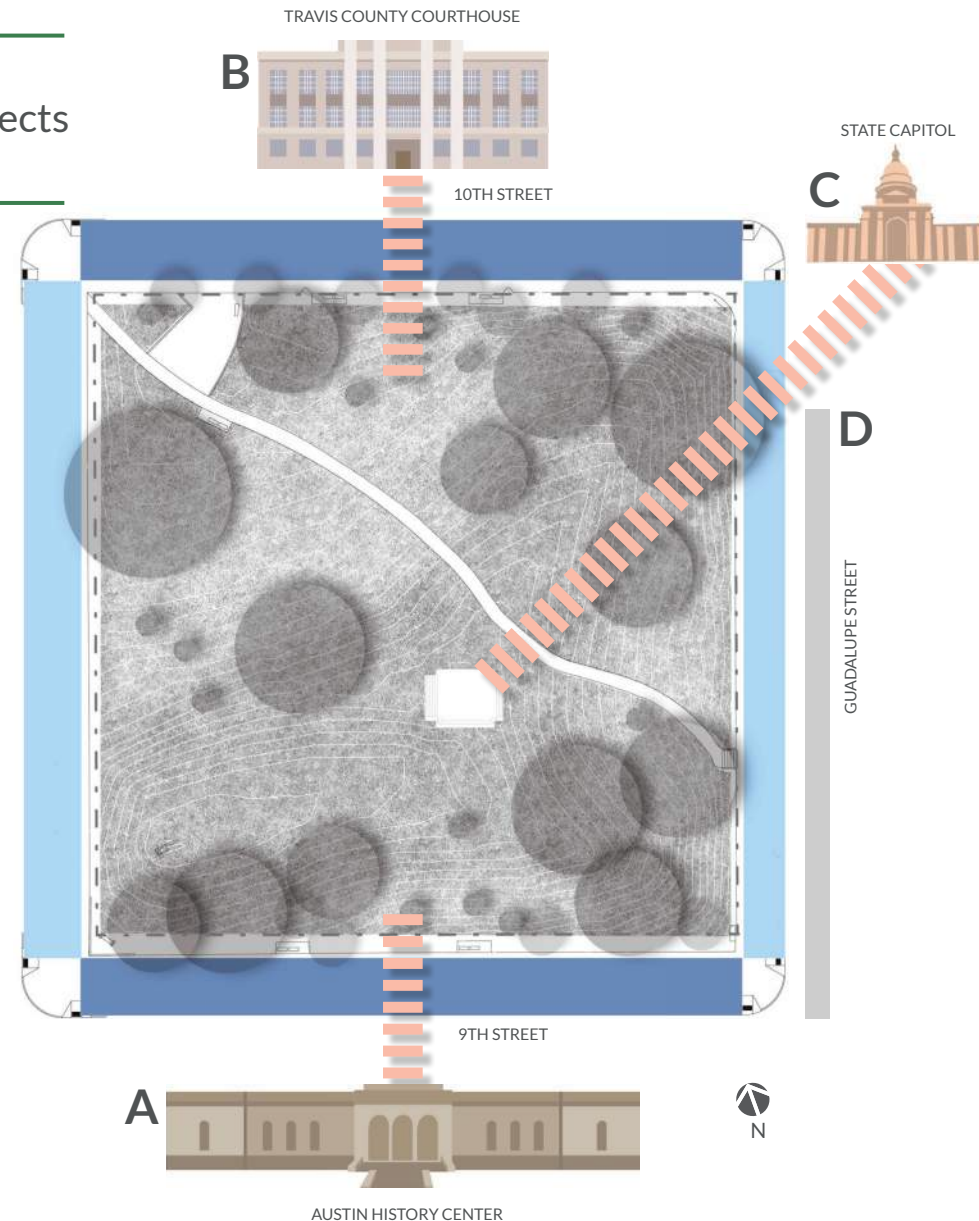

VISION

Constituent feedback tells us how people want to use the Square and how they think it should function. These findings tell us what functions to support when changing areas of the Square.

AREAS OF CONSENSUS

- Wooldridge should have a role among downtown Austin's open spaces.



AREAS FOR IMPROVEMENT

- Wooldridge Square must be able to support appropriate programming - if it is not used, it will not be successful.
- Close 10th Street for festivals and special events
- Additional amenities including restrooms, drinking fountains, and flexible space.

CIVIC PROGRAMMING

1. Movies in the Park
2. Night Events
3. Day Events
4. Symphony Night
5. Art Market

INFRASTRUCTURE UPGRADES

1. Better Shade
2. Lighting Upgrades
3. Drinking Fountain
4. Better Seating
5. ADA Bandstand access

ENVIRONMENTAL PERFORMANCE

1. Enhanced Tree Planting
2. Transplanted Heritage Trees
3. Reclaimed Water for Planting
4. Native Meadows
5. Reduced Maintenance

In a survey listing elements of Civic Programming, Infrastructure Upgrades, and Environmental Performance, constituents chose these as their Top 5 in each category.



ACHIEVE ACCESS

achieve universal access to give everyone in the community the opportunity to experience the historic Bandstand



ELEVATE THE PEDESTRIAN

activate the perimeter to create a safe and inviting experience



REINFORCE CONNECTION

invest in critical infrastructure to support the Square's presence in the community



INVEST IN OUR PAST

use the Square's historic defining features to guide low impact design

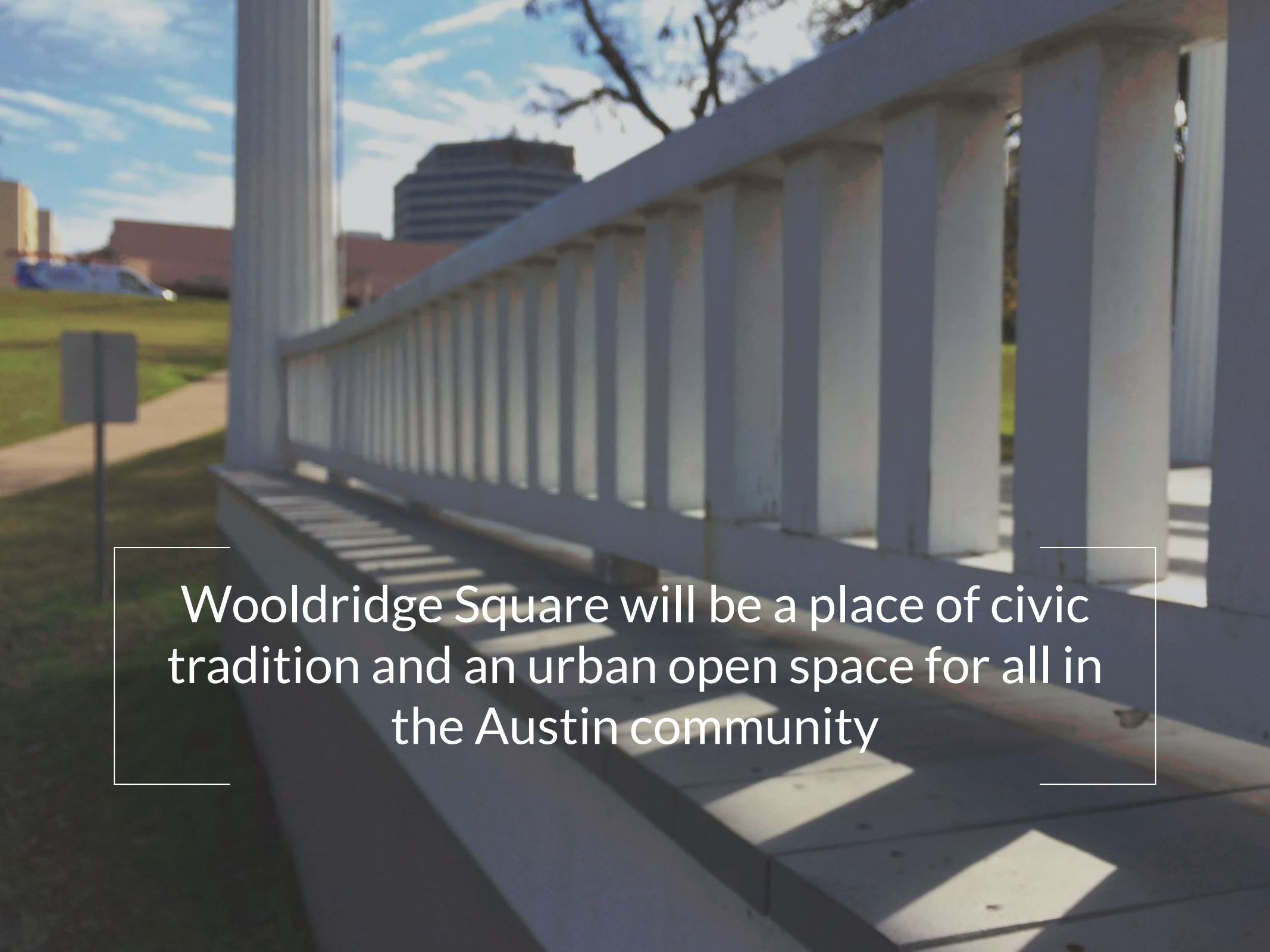

Wooldridge Square will be a place of civic tradition and an urban open space for all in the Austin community