

**LAND USE LEGEND**  
**LAND USE ON AIRPORT**

- AIRPORT SUPPORT
- AVIATION
- AVIATION INDUSTRIAL
- CARGO
- COMMERCIAL
- COMMUNITY
- FLOOD PLAIN
- GENERAL AVIATION/FBO
- GOVERNMENT
- RECREATION
- RESTRICTED

**LAND USE OFF AIRPORT**

- AGRICULTURE
- AVIATION
- COMMERCIAL
- COMMUNITY
- EDUCATIONAL
- GOVERNMENT
- INDUSTRIAL
- RECREATION
- RESIDENTIAL
- RESTRICTED
- UNDEVELOPED

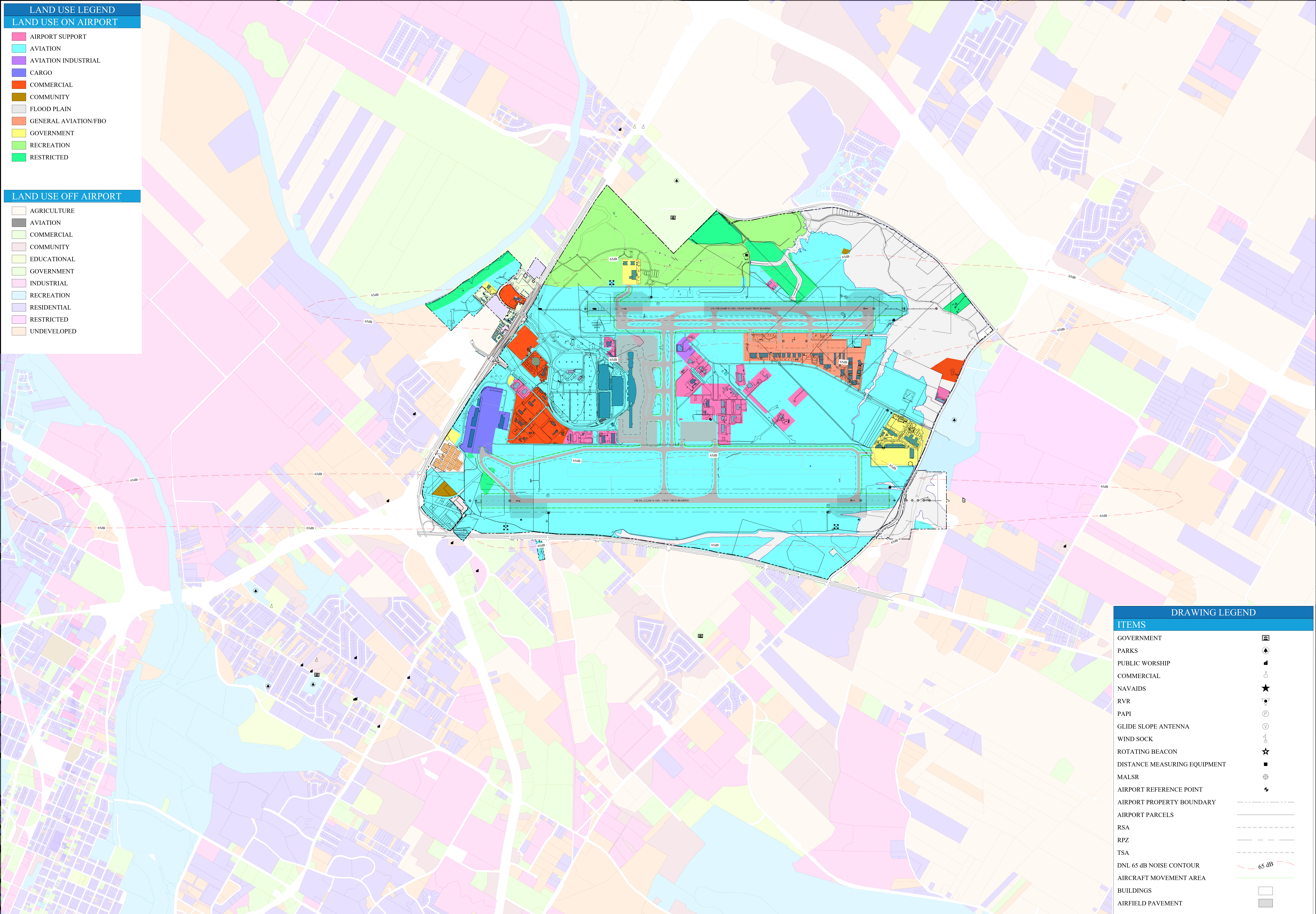

**DRAWING LEGEND**

ITEMS	
GOVERNMENT	
PARKS	
PUBLIC WORSHIP	
COMMERCIAL	
NAVAIDS	
RVR	
PAPI	
GLIDE SLOPE ANTENNA	
WIND SOCK	
ROTATING BEACON	
DISTANCE MEASURING EQUIPMENT	
MALS/R	
AIRPORT REFERENCE POINT	
AIRPORT PROPERTY BOUNDARY	
AIRPORT PARCELS	
RSA	
RPZ	
TSA	
DNL 65 dB NOISE CONTOUR	
AIRCRAFT MOVEMENT AREA	
BUILDINGS	
AIRFIELD PAVEMENT	

**DISCLAIMER**  
 1. THE PREPARATION OF THIS DOCUMENT MAY HAVE BEEN SUPPORTED, IN PART, THROUGH A PLANNING GRANT FROM THE FEDERAL AVIATION ADMINISTRATION AS PROVIDED UNDER SECTION 505 OF THE AIRPORT AND AIRWAY IMPROVEMENT ACT. THE CONTENTS DO NOT NECESSARILY REFLECT THE OFFICIAL VIEWS OR POLICY OF THE FAA. ACCEPTANCE OF THIS REPORT BY THE FAA DOES NOT IN ANY WAY CONSTITUTE A COMMITMENT ON THE PART OF THE UNITED STATES TO PARTICIPATE IN ANY WAY IN THE DEVELOPMENT OF THIS REPORT NOR DOES IT INDICATE THAT THE PROPOSED DEVELOPMENT IS ENVIRONMENTALLY ACCEPTABLE WITH APPROPRIATE PUBLIC LAWS.  
 2. THE FINAL APPROVAL OF THIS REPORT (AVIATION PLAN) REPRESENTS ACCEPTANCE OF THE GENERAL LOCATION OF FUTURE FACILITIES DEPICTED, DURING THE PRELIMINARY DESIGN PHASE. THE AIRPORT OWNER SHALL BE RESPONSIBLE FOR THE APPROVAL, FINAL LOCATIONS, HEIGHTS, AND EXTERIOR FINISH OF ALL STRUCTURES. THE FAA'S CONCERN IS OBSTRUCTION IMPACT ON ELECTRONIC FACILITIES, AND ADVISES IMPACT ON CONTROLLER VIEW OF AIRCRAFT APPROACHES AND GROUND MOVEMENT AREAS WHICH COULD ADVERSELY AFFECT THE SAFETY, EFFICIENCY, OR UTILITY OF THE AIRPORT.



**NOTES**  
 1. USED NAD 83 STATE PLANE COORDINATE SYSTEM  
 2. NAVD83 VERTICAL CONTROL DATUM USED FOR ELEVATION  
 3. WAIVER OF DESIGN STANDARDS FOR PAVED OVERLAP AREA OF RUNWAY 17R ISSUED JUNE 15, 1998  
 4. AIRPORT ELEVATION: 545' NAVD83 (AMSL)  
 5. THE COLORED HATCH LINES DEPICTED ON THIS DRAWING CORRESPOND TO THE AIR FORCE BASE LAND TRANSFER LINES (SEE LEGEND FOR LINE TYPE). THEY DO NOT CORRESPOND TO THE TCAD BASE MAP LINES.

MAGNETIC DECLINATION  
 3° 44' E  
 SEPTEMBER 21, 2018  
 ANNUAL CHANGE OF 7' W

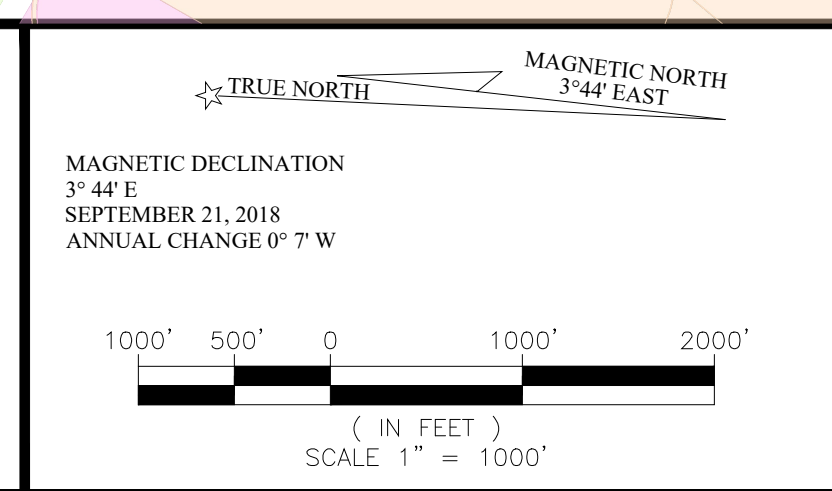

**APPROVAL**  
 AUSTIN-BERGSTRÖM INTERNATIONAL AIRPORT  
 CITY OF AUSTIN AVIATION DEPARTMENT

JENNIFER WILLIAMS, PROJECT MANAGER DATE

**FAA ASW-ADO APPROVAL BLOCK:**  
 FEDERAL AVIATION ADMINISTRATION  
 FORT WORTH AIRPORTS DISTRICT OFFICE

CONDITIONALLY APPROVED: MARCELO SANCHEZ, P.E. MANAGER, ASW-ADO  
 DATE: MARCH 4, 2020

SUBJECT TO COMMENTS IN LETTER DATED: 03/04/2020 (NO COMMENTS)  
 AIRSPACE STUDY NUMBER: 1 04MAR20 4910-8107-3343

JOB NO.:  
 DRAWN BY: CS  
 CHECKED BY: TSP  
 COORD. CHECK:  
 FILE NAME: M3343-RC-1-02.dwg  
 DATE: 04MAR20  
 SCALE: 1" = 1000'

**RC-1-02**

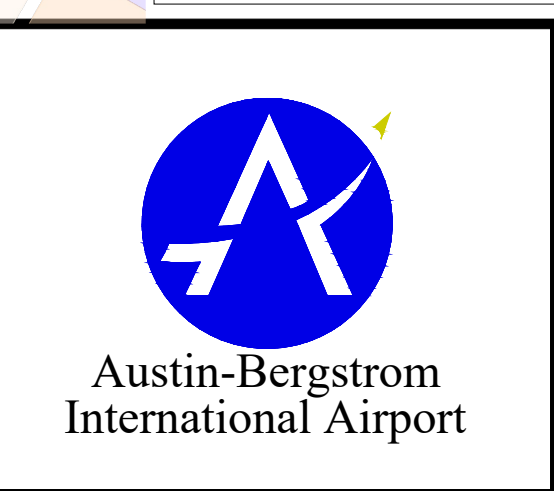

**AIRPORT LAND USE PLAN (EXISTING)**

16 OF 18